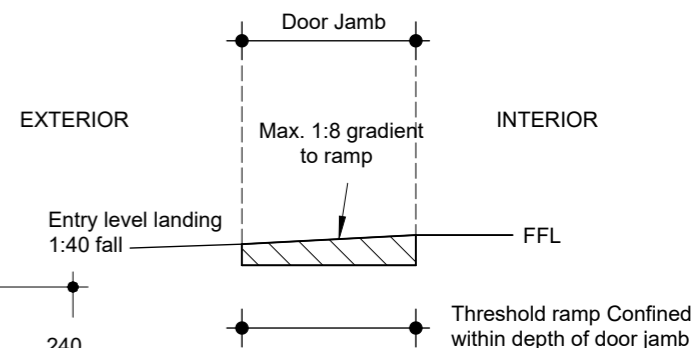

Figure 4.4 Option 3: Threshold ramp (Confined within depth of door jamb)

ALL SMOKE ALARMS TO BE HARDWIRED & INTERCONNECTED.
SMOKE ALARMS TO BE PHOTOELECTRIC TYPE IN ACCORDANCE WITH NCC 2022 PART 9.5 & AS 3786



DOWNPIPE LOCATIONS ARE APPROXIMATE ONLY. PLUMBER TO CONFIRM LOCATION BEFORE CONSTRUCTION

Waterproofing Compliance as per ABCB Housing Provisions, Section 10.2

The fall of the floor surface to a floor waste must be:
a- between 1:60 and 1:80 in the shower area
b- between 1:80 and 1:100 in other areas

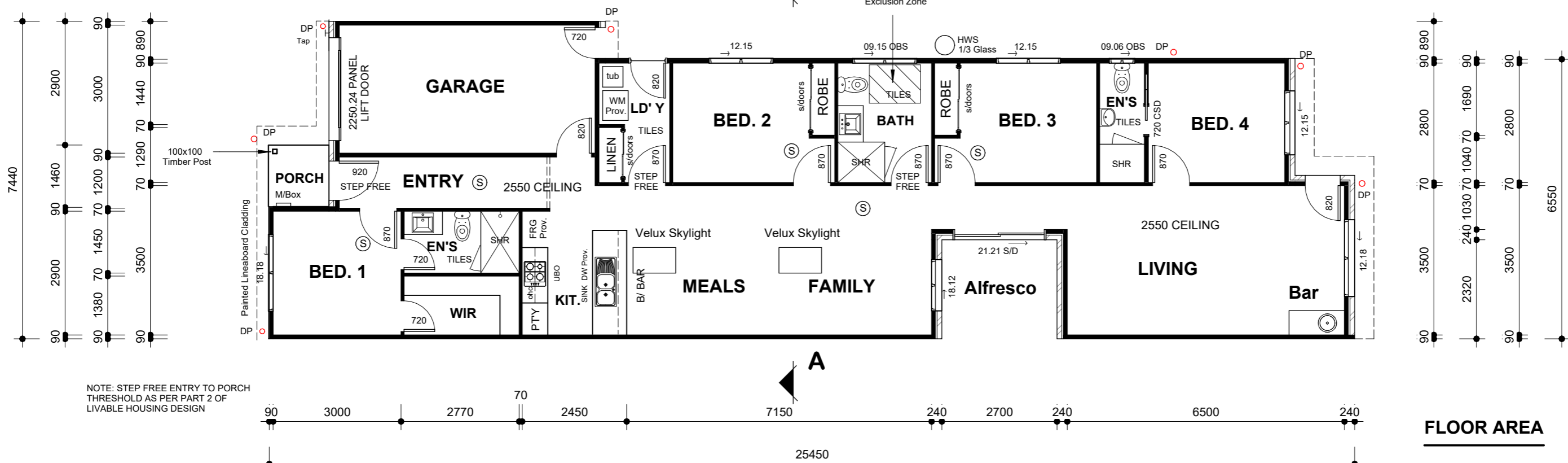

FLOOR AREA

LIVING	= 137.5 m2
GARAGE	= 20.0 m2
PORCH	= 2.0 m2
ALFRESCO	= 6.2 m2
TOTAL	= 165.7 m2

W33 N2

FLOOR PLAN
1:100

REVISION SCHEDULE	
A Draft Plans	5/11/2024

Draft Plans 5/11/2024



MOB: 0432 034 543
Email: hello@letswork.com.au
100 Harris Street, Pyrmont NSW 2009

All rights reserved under the "Copyright" act, no part may be used, reproduced or copied in any form other than for the specific use on the site for which it has been prepared for, or without written permission of Letswork

Proposed New Dwelling
CLIENT:
Letswork

DWG No.
24/902
DATE: Nov. 2024