

THE HILLS SHIRE COUNCIL
APPROVED
DEVELOPMENT CONSENT
DA 245/2022/ZB
 Please refer to conditions of Development Consent for details of matters which must be complied with.

PLAN NOT FOR NSW LRS INVESTIGATION

PRELIMINARY PLAN ONLY LOT DIMENSIONS AND AREAS SUBJECT TO SURVEY & REGISTRATION OF THE FINAL PLAN AT NSW LRS

PROPOSED EASEMENT LOCATIONS ARE INDICATIVE ONLY & SUBJECT TO DEVELOPMENT CONSENT, DETAILED DESIGN, CONSTRUCTION, SURVEY & REGISTRATION OF THE FINAL PLAN AT NSW LRS

NOTE:
 1. ALL BOUNDARIES OF EASEMENT 'NA' ARE PARALLEL & PERPENDICULAR TO THE INTERSECTING LOT BOUNDARIES
 'A' - EASEMENT FOR DRAINAGE OF WATER 1.5 WIDE
 'AA' - EASEMENT FOR DRAINAGE OF WATER 1.5 WIDE (STAGE 7A)
 'NA' - EASEMENT FOR MAINTENANCE, ACCESS & OTHER PURPOSES 0.9 WIDE (STAGE 7A)

SURVEYOR Name: MATHEW JOHN HYNES Date: T.B.C. Reference: 108-20-STAGE 7 CL	PLAN OF SUBDIVISION OF LOTS 7005, 7006, 7010, 7017, 7020, 7029, 7032, 7040, 7043, 7054, 7101, 7111, 7114, 7126, 7129, 7139, 7142, 7154, 7301, 7304, 7325, 7357 D.P....	LGA: THE HILLS SHIRE Locality: BOX HILL Reduction Ratio: 1: 500 Lengths are in metres	AMEND. No.: 00 DATE: 11/06/2021 DETAILS: ORIGINAL ISSUE Registered	D.P. DRAFT REVISION [00] DATE: 16/06/2021
--	--	--	---	---

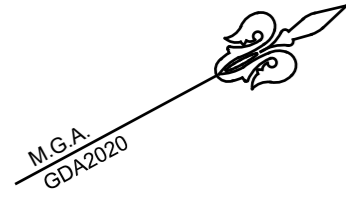

ADJOINS

4

SHEET

SHEET

WAY

(18 WIDE)

NEWFOUNDLAND

7534	7533	7138	7137	7136	7135	3	7134	7133	7132	7131	7130	7531	7532
------	------	------	------	------	------	---	------	------	------	------	------	------	------

ADJOINS

CAMARGUE STREET (18 WIDE)

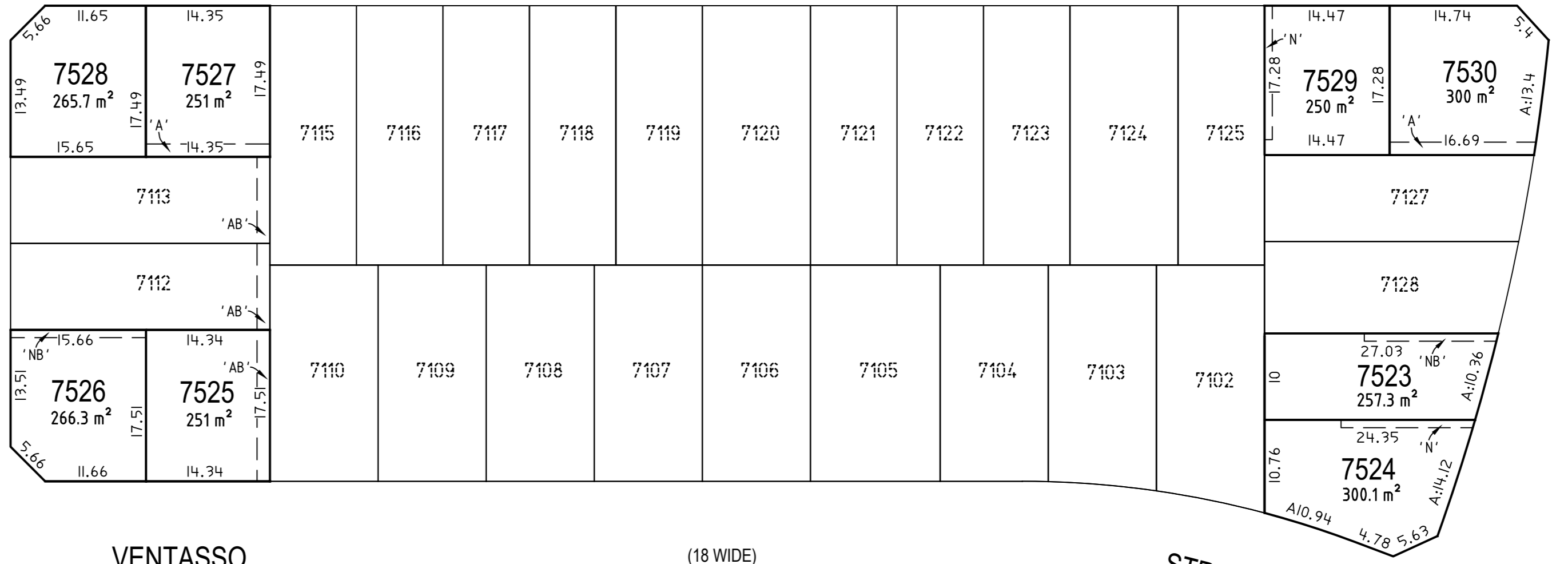

VENTASSO STREET (18 WIDE)

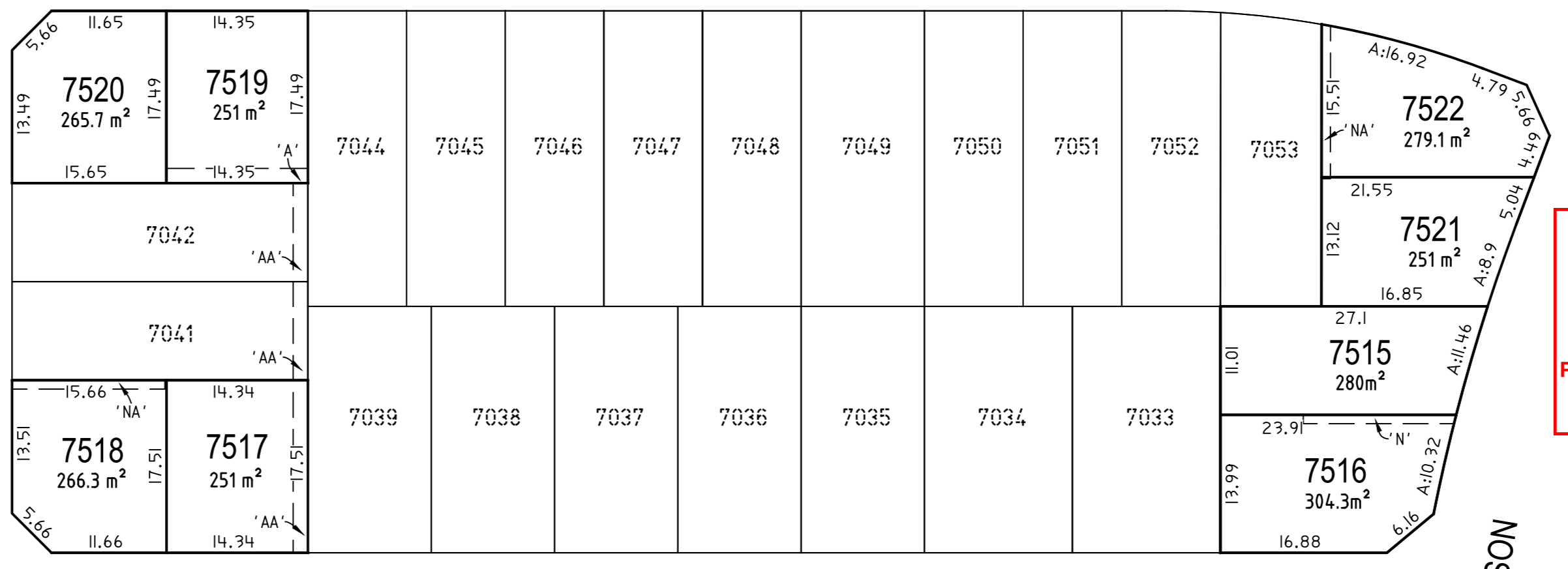

SARDINIAN STREET (18 WIDE)

SHEET	7511	7021	7022	7023	7024	1	7025	7026	7027	7028	7513	7514
-------	------	------	------	------	------	---	------	------	------	------	------	------

ADJOINS

THE HILLS SHIRE COUNCIL

APPROVED DEVELOPMENT CONSENT
DA 245/2022/ZB

Please refer to conditions of Development Consent for details of matters which must be complied with.



PLAN NOT FOR NSW LRS INVESTIGATION

PRELIMINARY PLAN ONLY LOT DIMENSIONS AND AREAS SUBJECT TO SURVEY & REGISTRATION OF THE FINAL PLAN AT NSW LRS

PROPOSED EASEMENT LOCATIONS ARE INDICATIVE ONLY & SUBJECT TO DEVELOPMENT CONSENT, DETAILED DESIGN, CONSTRUCTION, SURVEY & REGISTRATION OF THE FINAL PLAN AT NSW LRS

NOTE: 1. ALL BOUNDARIES OF EASEMENTS 'N', 'NA' & 'NB' ARE PARALLEL & PERPENDICULAR TO THE INTERSECTING LOT BOUNDARIES

- 'A' - EASEMENT FOR DRAINAGE OF WATER 1.5 WIDE
- 'AA' - EASEMENT FOR DRAINAGE OF WATER 1.5 WIDE (STAGE 7A)
- 'AB' - EASEMENT FOR DRAINAGE OF WATER 1.5 WIDE (STAGE 7B)
- 'N' - EASEMENT FOR MAINTENANCE, ACCESS & OTHER PURPOSES 0.9 WIDE
- 'NA' - EASEMENT FOR MAINTENANCE, ACCESS & OTHER PURPOSES 0.9 WIDE (STAGE 7A)
- 'NB' - EASEMENT FOR MAINTENANCE, ACCESS & OTHER PURPOSES 0.9 WIDE (STAGE 7B)

SURVEYOR
Name: MATHEW JOHN HYNES
Date: T.B.C.
Reference: 108-20-STAGE 7 CL

PLAN OF
SUBDIVISION OF LOTS 7005, 7006, 7010, 7017, 7020, 7029, 7032, 7040, 7043, 7054, 7101, 7111, 7114, 7126, 7129, 7139, 7142, 7154, 7301, 7304, 7325, 7357 D.P....

LGA: THE HILLS SHIRE
Locality: BOX HILL
Reduction Ratio: 1: 500
Lengths are in metres

Registered

D.P. DRAFT
REVISION [00] DATE: 16/06/2021

AMEND No: 00 DATE: 16/06/2021 DETAILS: ORIGINAL ISSUE

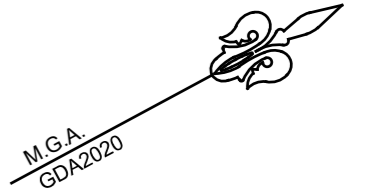

ADJOINS	7341
	7342
	7343
	7344
	7345
	7346
	7347
	7348
	7349
	7350
SHEET	7351
	7352

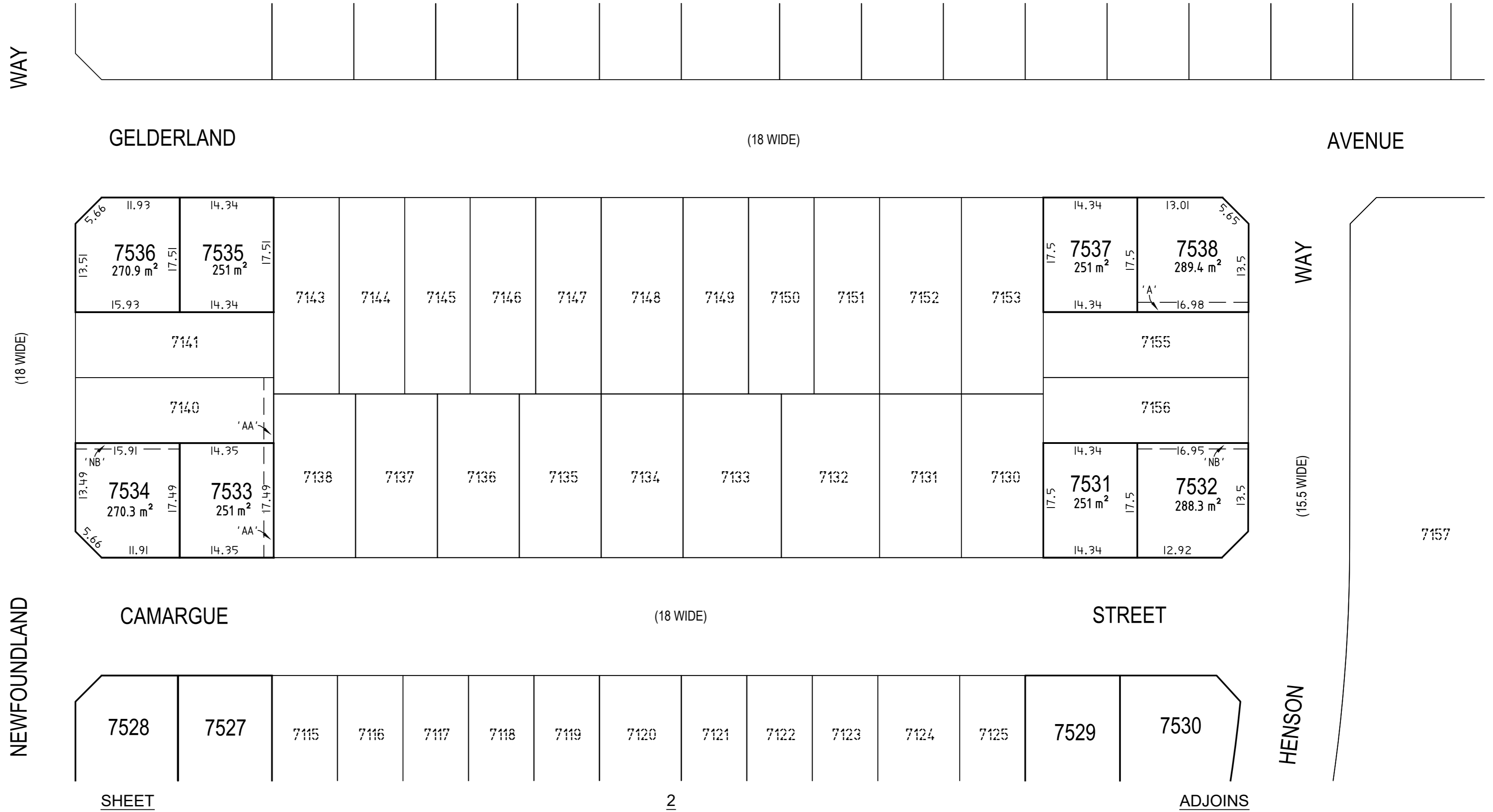

PLAN NOT FOR NSW LRS INVESTIGATION

PRELIMINARY PLAN ONLY LOT DIMENSIONS AND AREAS SUBJECT TO SURVEY & REGISTRATION OF THE FINAL PLAN AT NSW LRS

PROPOSED EASEMENT LOCATIONS ARE INDICATIVE ONLY & SUBJECT TO DEVELOPMENT CONSENT, DETAILED DESIGN, CONSTRUCTION, SURVEY & REGISTRATION OF THE FINAL PLAN AT NSW LRS

NOTE:
1. ALL BOUNDARIES OF EASEMENT 'NB' ARE PARALLEL & PERPENDICULAR TO THE INTERSECTING LOT BOUNDARIES

'AA' - EASEMENT FOR DRAINAGE OF WATER 1.5 WIDE (STAGE 7B)
'NB' - EASEMENT FOR MAINTENANCE, ACCESS & OTHER PURPOSES 0.9 WIDE (STAGE 7B)

THE HILLS SHIRE COUNCIL
APPROVED
DEVELOPMENT CONSENT
DA 245/2022/ZB
Please refer to conditions of Development Consent for details of matters which must be complied with.



SURVEYOR
Name: MATHEW JOHN HYNES
Date: T.B.C.
Reference: 108-20-STAGE 7 CL

PLAN OF
SUBDIVISION OF LOTS 7005, 7006, 7010, 7017, 7020, 7029, 7032, 7040, 7043, 7054, 7101, 7111, 7114, 7126, 7129, 7139, 7142, 7154, 7301, 7304, 7325, 7357 D.P....

LGA: THE HILLS SHIRE
Locality: BOX HILL
Reduction Ratio: 1: 500
Lengths are in metres

AMEND. No.: 00 DATE: 16/06/2021 DETAILS: ORIGINAL ISSUE
Registered

D.P. DRAFT
REVISION [00] DATE: 16/06/2021

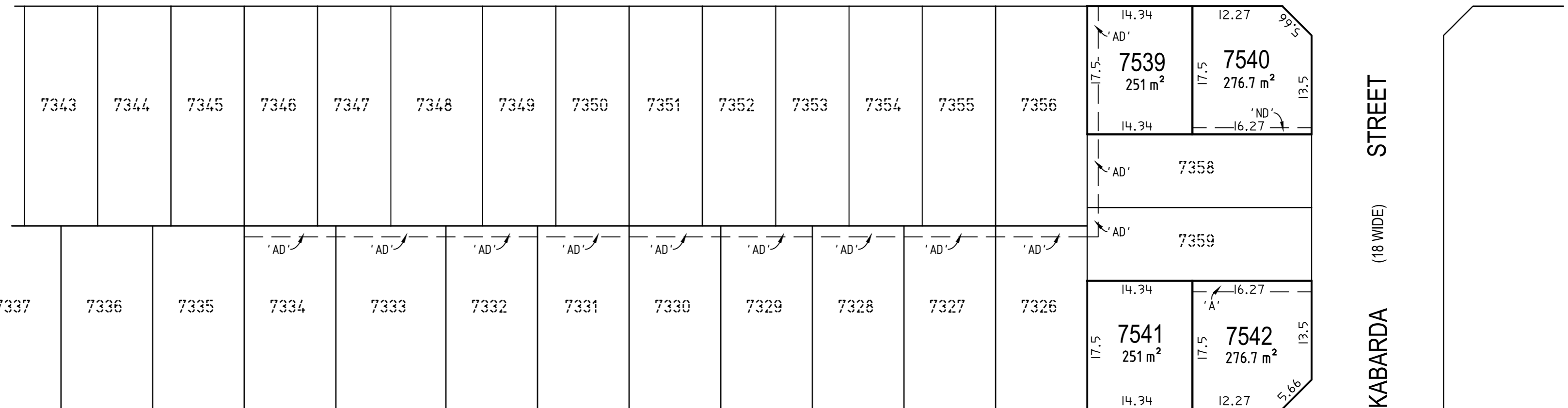
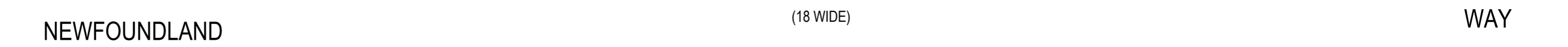
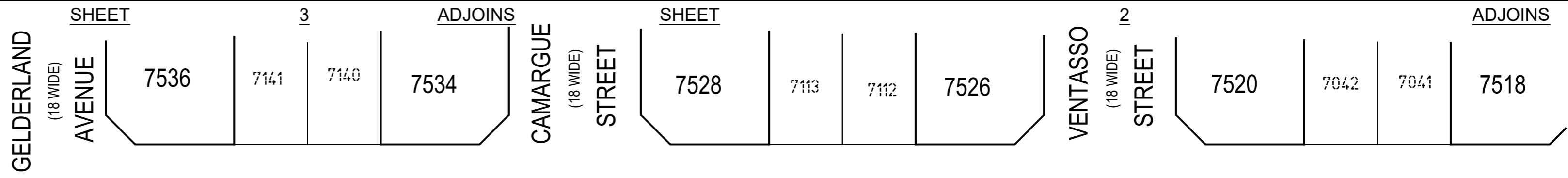
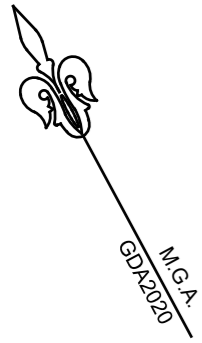

NOTE:
 1. ALL BOUNDARIES OF EASEMENT 'ND' ARE PARALLEL & PERPENDICULAR TO THE INTERSECTING LOT BOUNDARIES

'A' - EASEMENT FOR DRAINAGE OF WATER 1.5 WIDE
 'AD' - EASEMENT FOR DRAINAGE OF WATER 1.5 WIDE (STAGE 7D)
 'ND' - EASEMENT FOR MAINTENANCE, ACCESS & OTHER PURPOSES 0.9 WIDE (STAGE 7D)

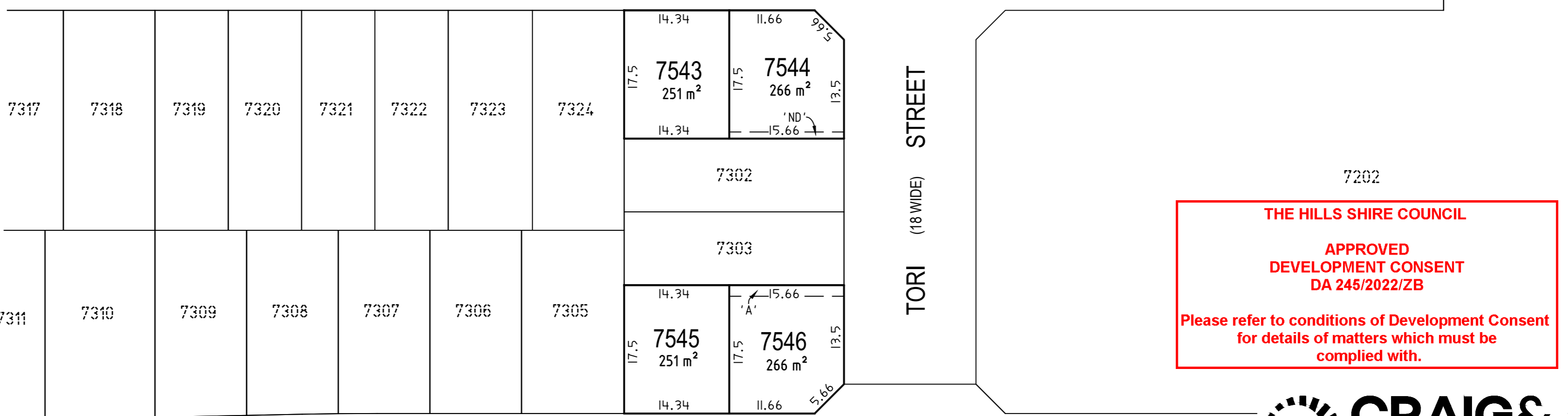

THE HILLS SHIRE COUNCIL
APPROVED
DEVELOPMENT CONSENT
DA 245/2022/ZB

Please refer to conditions of Development Consent for details of matters which must be complied with.



PLAN NOT FOR NSW LRS INVESTIGATION

PRELIMINARY PLAN ONLY LOT DIMENSIONS AND AREAS SUBJECT TO SURVEY & REGISTRATION OF THE FINAL PLAN AT NSW LRS

PROPOSED EASEMENT LOCATIONS ARE INDICATIVE ONLY & SUBJECT TO DEVELOPMENT CONSENT, DETAILED DESIGN, CONSTRUCTION, SURVEY & REGISTRATION OF THE FINAL PLAN AT NSW LRS

SURVEYOR Name: MATHEW JOHN HYNES Date: T.B.C. Reference: 108-20-STAGE 7 CL	PLAN OF SUBDIVISION OF LOTS 7005, 7006, 7010, 7017, 7020, 7029, 7032, 7040, 7043, 7054, 7101, 7111, 7114, 7126, 7129, 7139, 7142, 7154, 7301, 7304, 7325, 7357 D.P....	LGA: THE HILLS SHIRE Locality: BOX HILL Reduction Ratio: 1: 500 Lengths are in metres	AMEND. No.: 00 DATE: 16/06/2021 DETAILS: ORIGINAL ISSUE Registered	D.P. DRAFT REVISION [00] DATE: 16/06/2021
---	---	--	---	---