

## ESTATE LAYOUT

Not to Scale



### LEGEND

- S — Sewer
- D — Stormwater
- W — Water
- T — Comms
- E — Electricity

Scale 1:300 - Lengths are in Metres.

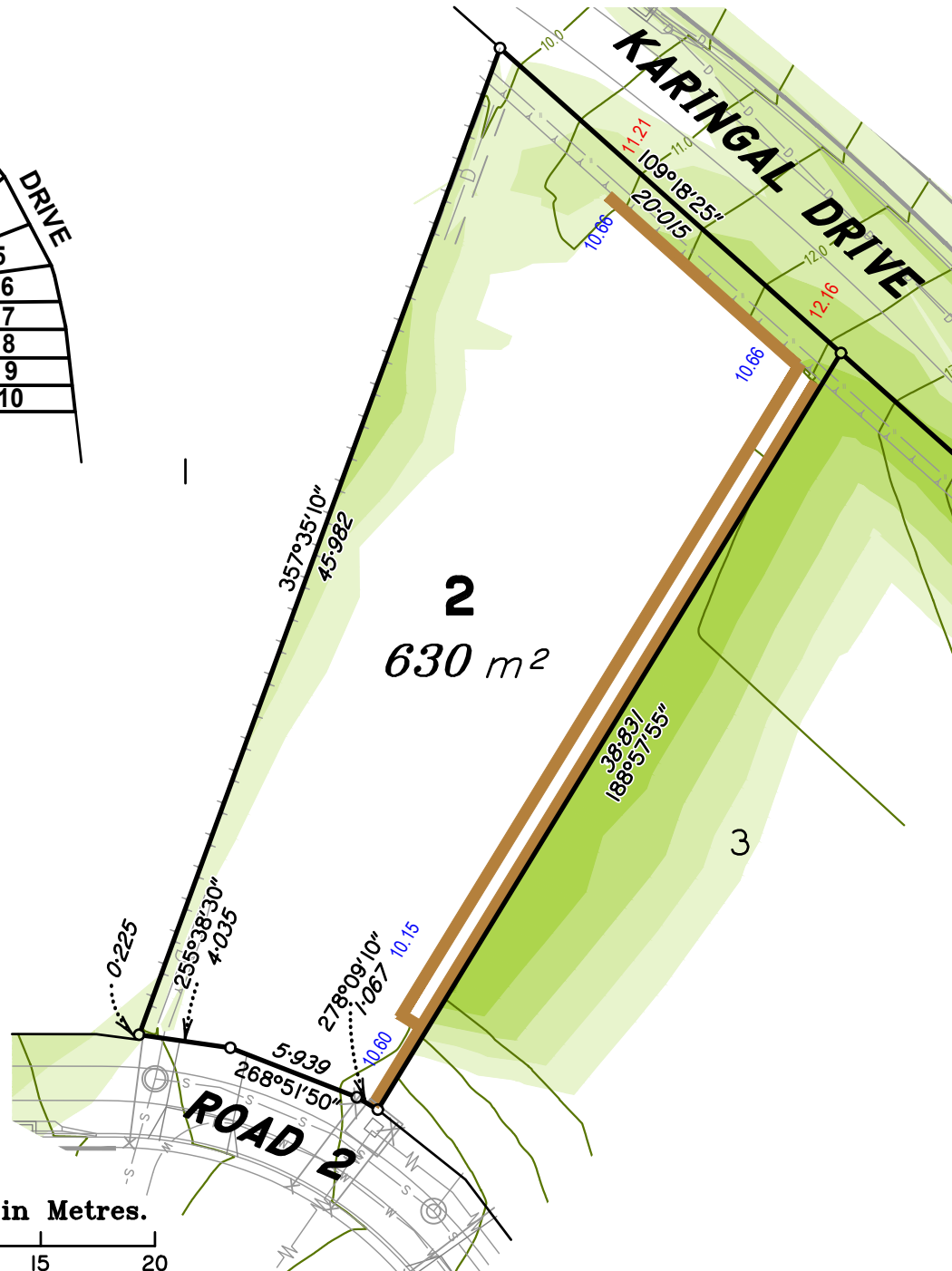
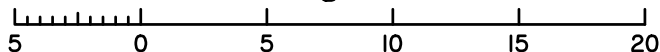

Brisbane P. 07 3161 1501  
Gold Coast P. 07 5594 4469  
admin@bsurveyed.com.au

TOWN PLANNING  
SURVEYING  
DEVELOPMENT  
CONSULTANTS

## DISCLOSURE PLAN

Proposed Lot 2

on SP347477

Described as Part of

Lot 20 on RP152380

Locality: PIMPAMA

Local Authority: GOLD COAST C. C.

### NOTE:

Areas and dimensions are subject to survey and registration of the survey plan by the Department of Natural Resources and Mines.

The effective development permit for Reconfiguring a Lot (1 Lots into 22 Lots) for the allotment, being Development Permit - approved by Gold Coast City Council on 1/08/2017 App No: ROL201700005 and is subject to conditions.

All fill shall be placed and compacted in a controlled manner so that Level (1) level of responsibility may be achieved and certified as per AS3798-2007.

### LEGEND

- 10 — Design Surface Contour
- Proposed Kerb Alignment
- Proposed Retaining Wall
- Depth of Fill 0.0m - 0.2m
- Depth of Fill 0.2m - 0.4m
- Depth of Fill 0.4m - 0.6m
- Depth of Fill 0.6m - 0.8m
- Depth of Fill 0.8m - 1.0m
- Depth of Fill 1.0m - 1.2m
- Depth of Fill 1.2m - 1.4m
- Depth of Fill > 1.4m
- 44.44 Top Wall 44.44 Bottom Wall

Scale @ A4 1:300 Meridian: MGA Zone 56

Height Datum: AHD Origin: OPM154879 RL 4.003m

This plan has been prepared by B Planned and Surveyed P/L (ACN 607 422 293), Cadastral Surveyor.  
Date: 14/03/2025

Plan Number: 002259\_2\_DP Rev E

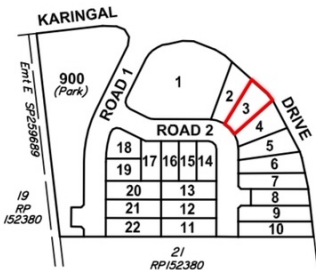

## ESTATE LAYOUT

Not to Scale



### LEGEND

- S — Sewer
- D — Stormwater
- W — Water
- T — Comms
- E — Electricity

Scale 1:300 - Lengths are in Metres.



Brisbane P. 07 3161 1501  
Gold Coast P. 07 5594 4469  
admin@bsurveyed.com.au

TOWN PLANNING  
SURVEYING  
DEVELOPMENT  
CONSULTANTS

## DISCLOSURE PLAN

Proposed Lot 3

on SP347477

Described as Part of

Lot 20 on RP152380

Locality: PIMPAMA

Local Authority: GOLD COAST C. C.

### NOTE:

Areas and dimensions are subject to survey and registration of the survey plan by the Department of Natural Resources and Mines.

The effective development permit for Reconfiguring a Lot (1 Lots into 22 Lots) for the allotment, being Development Permit - approved by Gold Coast City Council on 1/08/2017 App No: ROL201700005 and is subject to conditions.

All fill shall be placed and compacted in a controlled manner so that Level (1) level of responsibility may be achieved and certified as per AS3798-2007.

### LEGEND

- 10 — Design Surface Contour
- Proposed Kerb Alinment
- Proposed Retaining Wall
- Depth of Fill 0.0m - 0.2m
- Depth of Fill 0.2m - 0.4m
- Depth of Fill 0.4m - 0.6m
- Depth of Fill 0.6m - 0.8m
- Depth of Fill 0.8m - 1.0m
- Depth of Fill 1.0m - 1.2m
- Depth of Fill 1.2m - 1.4m
- Depth of Fill > 1.4m
- 44.44 Top Wall 44.44 Bottom Wall

Scale @ A4 1:300 Meridian: MGA Zone 56

Height Datum: AHD Origin: OPM154879 RL 4.003m

This plan has been prepared by B Planned and Surveyed P/L (ACN 607 422 293), Cadastral Surveyor.  
Date: 10/05/2024

Plan Number: 002259\_3\_DP Rev B

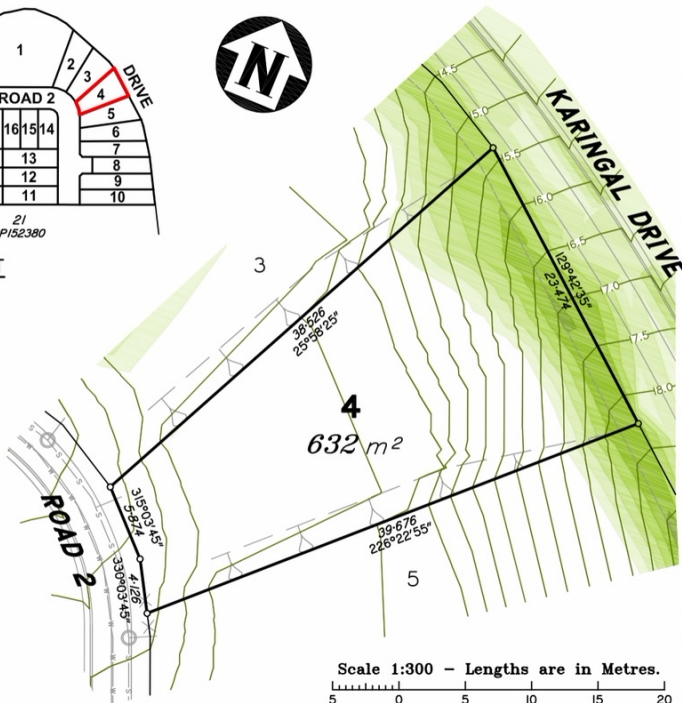
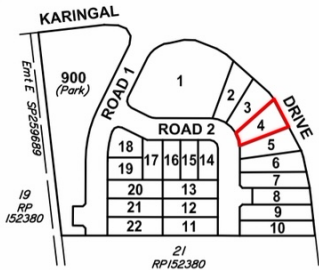

## DISCLOSURE PLAN

Proposed Lot 4  
on SP347477

Described as Part of

Lot 20 on RP152380

Locality: PIMPAMA

Local Authority: GOLD COAST C. C.

### NOTE:

Areas and dimensions are subject to survey and registration of the survey plan by the Department of Natural Resources and Mines.

The effective development permit for Reconfiguring a Lot (1 Lots into 22 Lots) for the allotment, being Development Permit - approved by Gold Coast City Council on 1/08/2017 App No: ROL201700005 and is subject to conditions.

All fill shall be placed and compacted in a controlled manner so that Level (1) level of responsibility may be achieved and certified as per AS3798-2007.

### LEGEND

	Design Surface Contour
	Proposed Kerb Alignment
	Proposed Retaining Wall
	Depth of Fill 0.0m - 0.2m
	Depth of Fill 0.2m - 0.4m
	Depth of Fill 0.4m - 0.6m
	Depth of Fill 0.6m - 0.8m
	Depth of Fill 0.8m - 1.0m
	Depth of Fill 1.0m - 1.2m
	Depth of Fill 1.2m - 1.4m
	Depth of Fill > 1.4m
	44.44 Top Wall
	44.44 Bottom Wall

Scale @ A4 1:300 Meridian: MGA Zone 56

Height Datum: AHD Origin: OPM154879 RL 4.003m

This plan has been prepared by B Planned and Surveyed P/L (ACN 607 422 293). Cadastral Surveyor.  
Date: 10/05/2024

Plan Number: 002259\_4\_DP Rev B

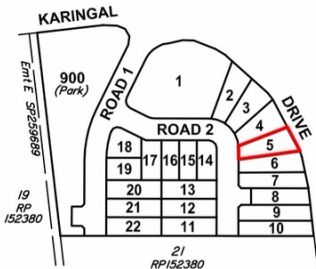

#### LEGEND

- S — Sewer
- D — Stormwater
- W — Water
- T — Comms
- E — Electricity



#### ESTATE LAYOUT

Not to Scale

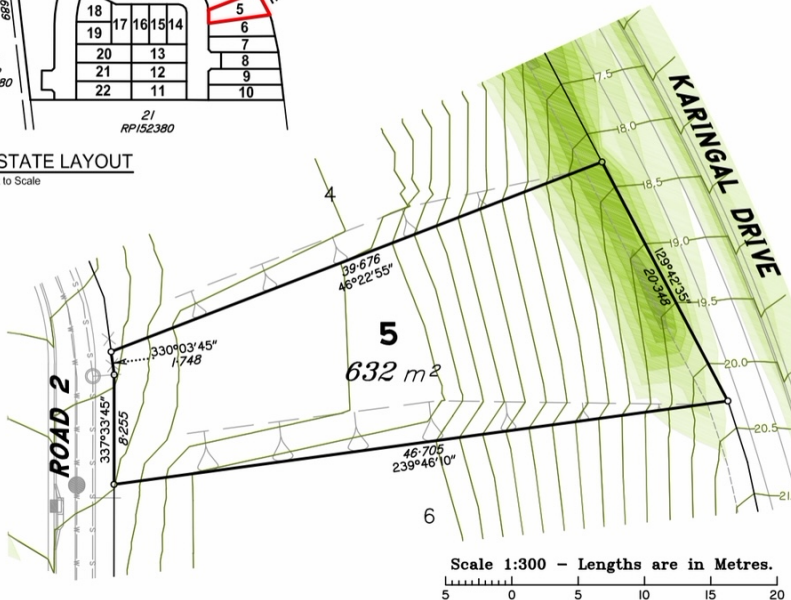

Scale 1:300 - Lengths are in Metres.



Brisbane P. 07 3161 1501  
Gold Coast P. 07 5594 4469  
admin@bsurveyed.com.au

TOWN PLANNING  
SURVEYING  
DEVELOPMENT  
CONSULTANTS

## DISCLOSURE PLAN

Proposed Lot 5

on SP347477

Described as Part of

Lot 20 on RP152380

Locality: PIMPAMA

Local Authority: GOLD COAST C. C.

#### NOTE:

Areas and dimensions are subject to survey and registration of the survey plan by the Department of Natural Resources and Mines.

The effective development permit for Reconfiguring a Lot (1 Lots into 22 Lots) for the allotment, being Development Permit - approved by Gold Coast City Council on 1/08/2017 App No: ROL201700005 and is subject to conditions.

All fill shall be placed and compacted in a controlled manner so that Level (1) level of responsibility may be achieved and certified as per AS3798-2007.

#### LEGEND

- 10 — Design Surface Contour
- Proposed Kerb Alinment
- Proposed Retaining Wall
- Depth of Fill 0.0m - 0.2m
- Depth of Fill 0.2m - 0.4m
- Depth of Fill 0.4m - 0.6m
- Depth of Fill 0.6m - 0.8m
- Depth of Fill 0.8m - 1.0m
- Depth of Fill 1.0m - 1.2m
- Depth of Fill 1.2m - 1.4m
- Depth of Fill > 1.4m
- 44.44 Top Wall 44.44 Bottom Wall

Scale @ A4 1:300 Meridian: MGA Zone 56

Height Datum: AHD Origin: OPM154879 RL 4.003m

This plan has been prepared by B Planned and Surveyed P/L (ACN 607 422 293), Cadastral Surveyor.  
Date: 10/05/2024

Plan Number: 002259\_5\_DP Rev B

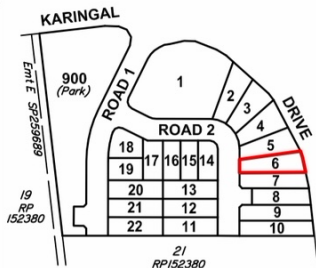

## ESTATE LAYOUT

Not to Scale

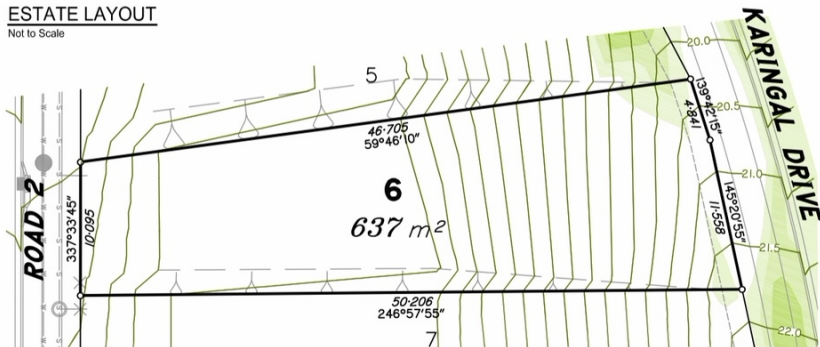

Scale 1:300 - Lengths are in Metres.



Brisbane P. 07 3161 1501  
Gold Coast P. 07 5594 4469  
admin@bsurveyed.com.au

TOWN PLANNING  
SURVEYING  
DEVELOPMENT  
CONSULTANTS

## DISCLOSURE PLAN

Proposed **Lot 6**  
on **SP347477**  
Described as Part of  
**Lot 20 on RP152380**  
Locality: **PIMPAMA**  
Local Authority: **GOLD COAST C. C.**

### NOTE:

Areas and dimensions are subject to survey and registration of the survey plan by the Department of Natural Resources and Mines.

The effective development permit for Reconfiguring a Lot (1 Lots into 22 Lots) for the allotment, being Development Permit - approved by Gold Coast City Council on 1/08/2017 App No: ROL201700005 and is subject to conditions.

All fill shall be placed and compacted in a controlled manner so that Level (1) level of responsibility may be achieved and certified as per AS3798-2007.

### LEGEND

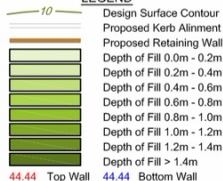

Scale @ A4 1:300 Meridian: MGA Zone 56

Height Datum: AHD Origin: OPM154879 RL 4.003m

This plan has been prepared by B Planned and Surveyed P/L (ACN 607 422 293), Cadastral Surveyor.  
Date: 10/05/2024

Plan Number: 002259\_6\_DP Rev B



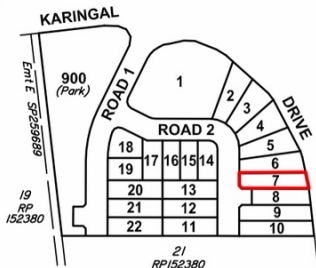

#### LEGEND

- S — Sewer
- D — Stormwater
- W — Water
- T — Comms
- W — Electricity



#### ESTATE LAYOUT

Not to Scale

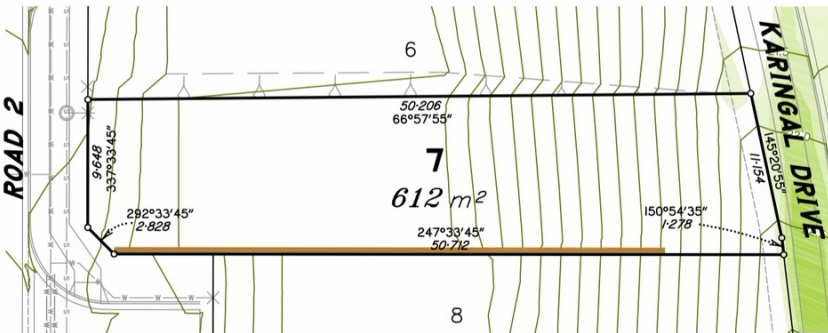

Scale 1:300 - Lengths are in Metres.



Brisbane P. 07 3161 1501  
Gold Coast P. 07 5594 4469  
admin@bsurveyed.com.au

TOWN PLANNING  
SURVEYING  
DEVELOPMENT  
CONSULTANTS

## DISCLOSURE PLAN

Proposed Lot 7  
on SP347477  
Described as Part of  
Lot 20 on RP152380  
Locality: PIMPAMA  
Local Authority: GOLD COAST C. C.

#### NOTE:

Areas and dimensions are subject to survey and registration of the survey plan by the Department of Natural Resources and Mines.

The effective development permit for Reconfiguring a Lot (1 Lots into 22 Lots) for the allotment, being Development Permit - approved by Gold Coast City Council on 1/08/2017 App No: ROL201700005 and is subject to conditions.

All fill shall be placed and compacted in a controlled manner so that Level (1) level of responsibility may be achieved and certified as per AS3796-2007.

#### LEGEND

- 10 — Design Surface Contour
- Proposed Kerb Alinment
- Proposed Retaining Wall
- Depth of Fill 0.0m - 0.2m
- Depth of Fill 0.2m - 0.4m
- Depth of Fill 0.4m - 0.6m
- Depth of Fill 0.6m - 0.8m
- Depth of Fill 0.8m - 1.0m
- Depth of Fill 1.0m - 1.2m
- Depth of Fill 1.2m - 1.4m
- Depth of Fill > 1.4m
- 44.44 Top Wall 44.44 Bottom Wall

Scale @ A4 1:300 Meridian: MGA Zone 56

Height Datum: AHD Origin: OPM154879 RL 4.003m

This plan has been prepared by B Planned and Surveyed P/L (ACN 607 422 293), Cadastral Surveyor.  
Date: 28/06/2024

Plan Number: 002259\_7\_DP Rev C

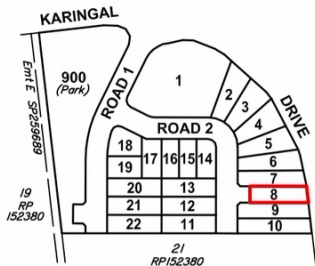

## ESTATE LAYOUT

Not to Scale

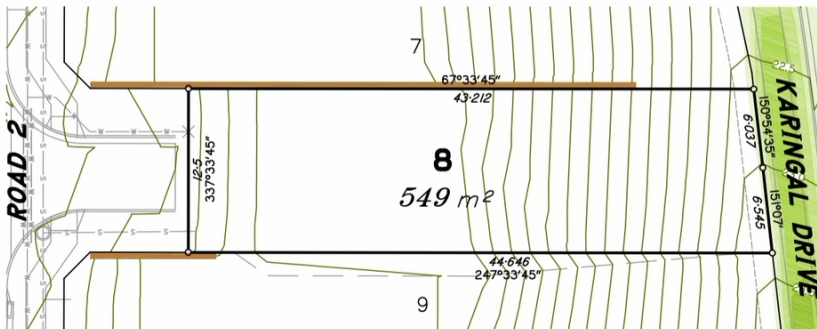

Scale 1:300 - Lengths are in Metres.



## DISCLOSURE PLAN

Proposed Lot 8  
on SP347477  
Described as Part of  
Lot 20 on RP152380

Locality: PIMPAMA  
Local Authority: GOLD COAST C. C.

### NOTE:

Areas and dimensions are subject to survey and registration of the survey plan by the Department of Natural Resources and Mines.

The effective development permit for Reconfiguring a Lot (1 Lots into 22 Lots) for the allotment, being Development Permit - approved by Gold Coast City Council on 1/08/2017 App No: ROL201700005 and is subject to conditions.

All fill shall be placed and compacted in a controlled manner so that Level (1) level of responsibility may be achieved and certified as per AS3798-2007.

**LEGEND**

	Design Surface Contour
	Proposed Kerb Alignment
	Proposed Retaining Wall
	Depth of Fill 0.0m - 0.2m
	Depth of Fill 0.2m - 0.4m
	Depth of Fill 0.4m - 0.6m
	Depth of Fill 0.6m - 0.8m
	Depth of Fill 0.8m - 1.0m
	Depth of Fill 1.0m - 1.2m
	Depth of Fill 1.2m - 1.4m
	Depth of Fill > 1.4m
44.44	Top Wall
44.44	Bottom Wall

Scale @ A4 1:300 Meridian: MGA Zone 56

Height Datum: AHD Origin: OPM154879 RL 4.003m

This plan has been prepared by B Planned and Surveyed P/L (ACN 607 422 293), Cadastral Surveyor.  
Date: 28/06/2024

Plan Number: 002259\_8\_DP Rev C

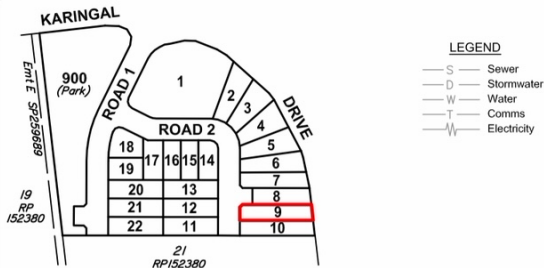

## ESTATE LAYOUT

Not to Scale

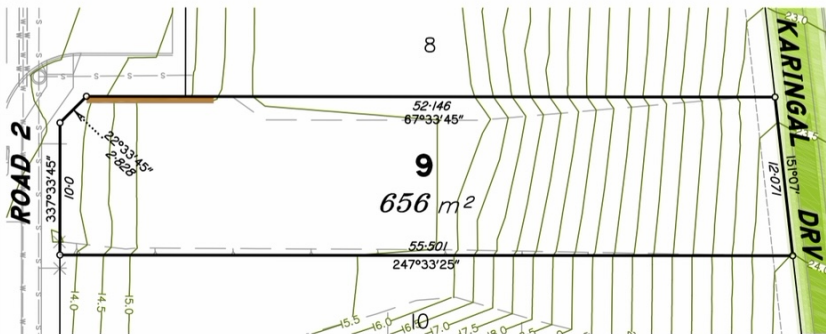



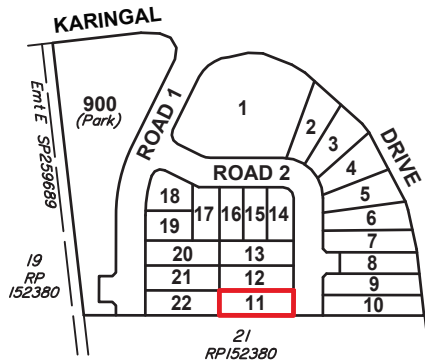

LEGEND

- S — Sewer
- D — Stormwater
- W — Water
- T — Comms
- W — Electricity



ESTATE LAYOUT

Not to Scale

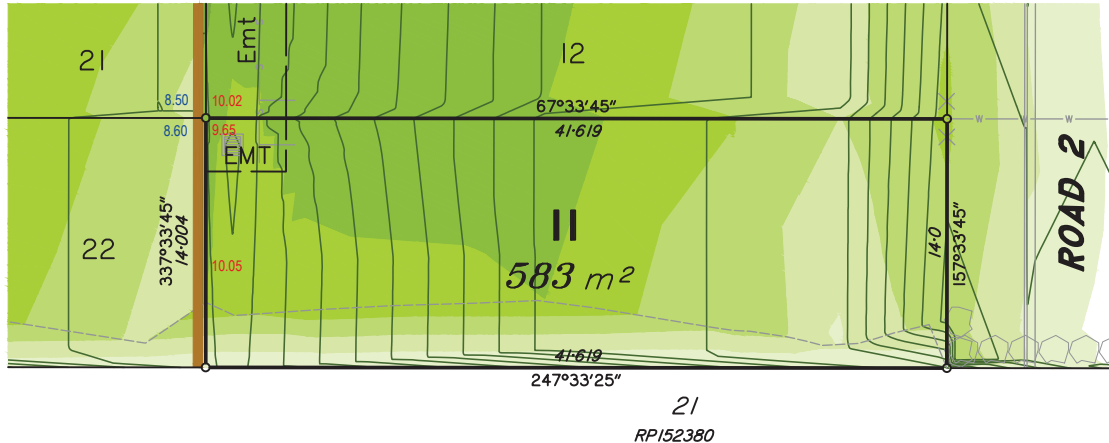

Scale 1:300 - Lengths are in Metres.

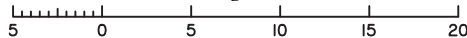

Brisbane P. 07 3161 1501  
Gold Coast P. 07 5594 4469  
admin@bsurveyed.com.au

TOWN PLANNING  
SURVEYING  
DEVELOPMENT  
CONSULTANTS

DISCLOSURE PLAN

Proposed Lot 11  
on SP347477  
Described as Part of  
Lot 20 on RP152380  
Locality: PIMPAMA  
Local Authority: GOLD COAST C. C.

NOTE:

Areas and dimensions are subject to survey and registration of the survey plan by the Department of Natural Resources and Mines.

The effective development permit for Reconfiguring a Lot (1 Lots into 22 Lots) for the allotment, being Development Permit - approved by Gold Coast City Council on 1/08/2017 App No: ROL201700005 and is subject to conditions.

All fill shall be placed and compacted in a controlled manner so that Level (1) level of responsibility may be achieved and certified as per AS3798-2007.

LEGEND

- 10 Design Surface Contour
- Proposed Retaining Wall
- Depth of Fill 0.0m - 0.5m
- Depth of Fill 0.5m - 1.0m
- Depth of Fill 1.0m - 1.5m
- Depth of Fill 1.5m - 2.0m
- Depth of Fill 2.0m - 2.5m
- Depth of Fill 2.5m - 3.0m
- Depth of Fill 3.0m - 3.5m
- Depth of Fill > 3.5m
- 44.44 Top Wall 44.44 Bottom Wall

Scale @ A4 Meridian: MGA Zone 56  
Height D200: AHD Origin: OPM154879 RL 4.003m

This plan has been prepared by B Planned and Surveyed P/L (ACN 607 422 293), Cadastral Surveyor.  
Date: 10/05/2024

Plan Number: 002259\_11\_DP Rev A



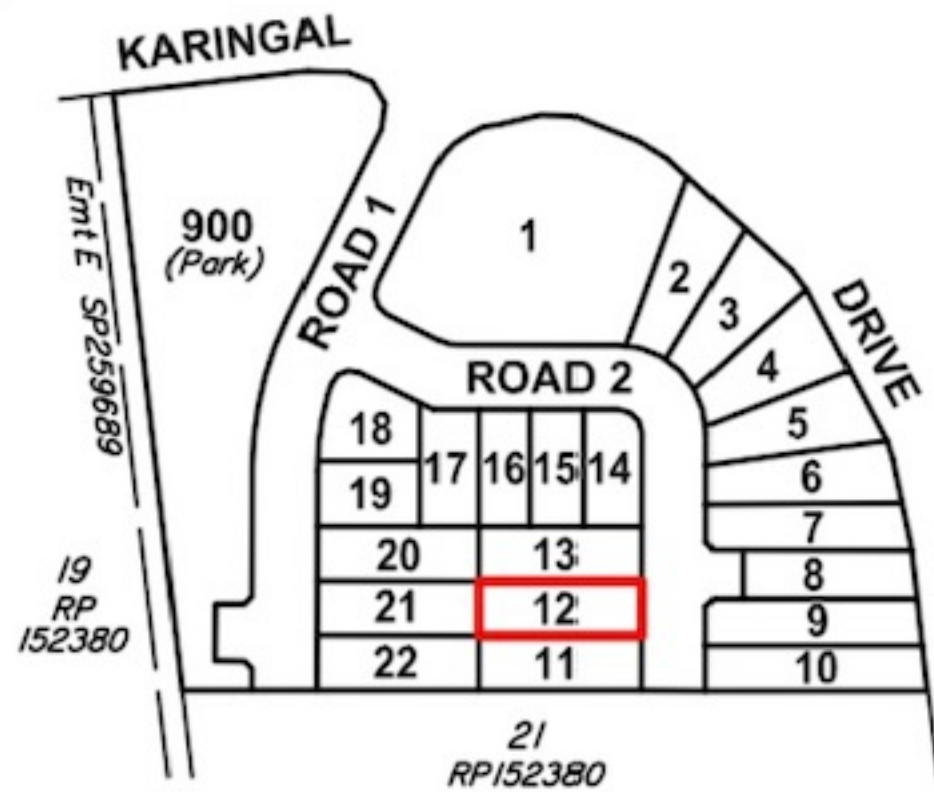

### ESTATE LAYOUT

Not to Scale

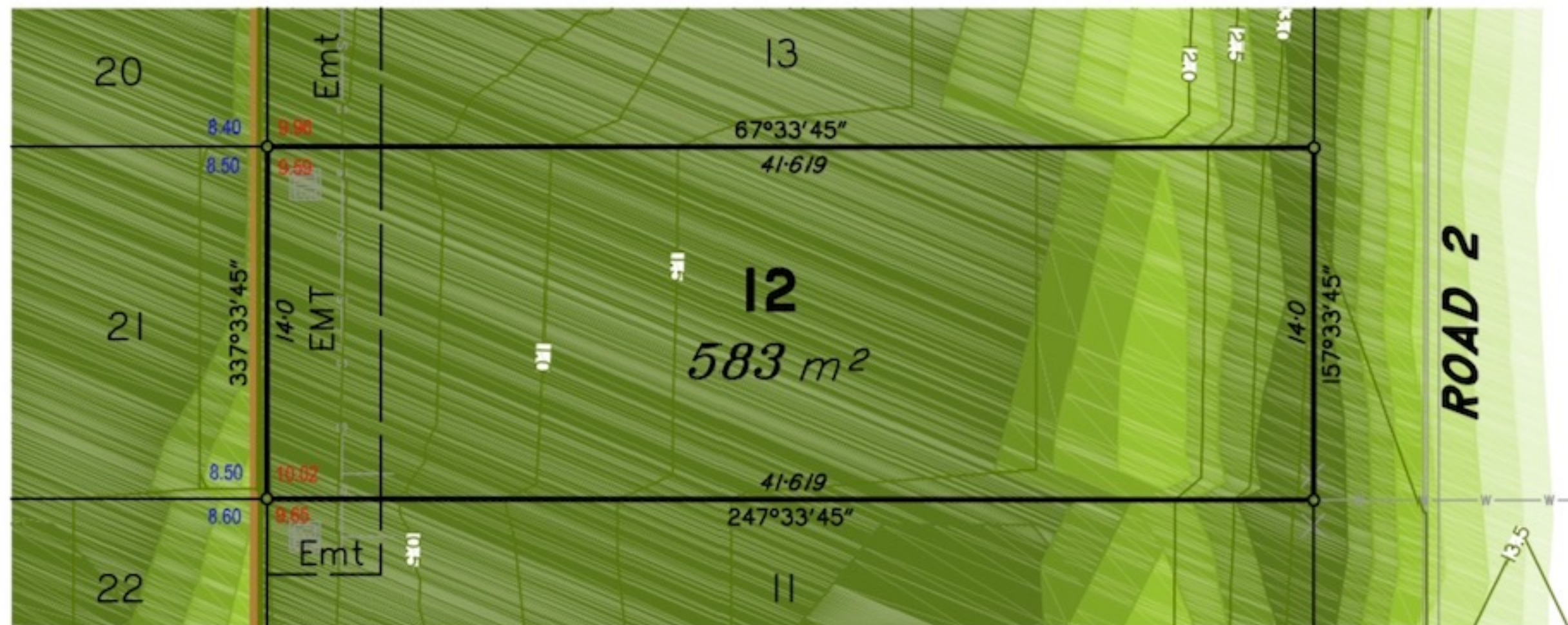

Scale 1:300 – Lengths are in Metres.

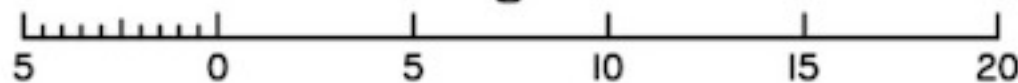

Brisbane P. 07 3161 1501  
Gold Coast P. 07 5594 4469  
admin@bsurveyed.com.au

TOWN PLANNING  
SURVEYING  
DEVELOPMENT  
CONSULTANTS

### DISCLOSURE PLAN

Proposed Lot 12

on SP347477

Described as Part of  
Lot 20 on RP152380

Locality: PIMPAMA

Local Authority: GOLD COAST C. C.

#### NOTE:

Areas and dimensions are subject to survey and registration of the survey plan by the Department of Natural Resources and Mines.

The effective development permit for Reconfiguring a Lot (1 Lots into 22 Lots) for the allotment, being Development Permit - approved by Gold Coast City Council on 1/08/2017 App No: ROL201700005 and is subject to conditions.

All fill shall be placed and compacted in a controlled manner so that Level (1) level of responsibility may be achieved and certified as per AS3798-2007.

#### LEGEND

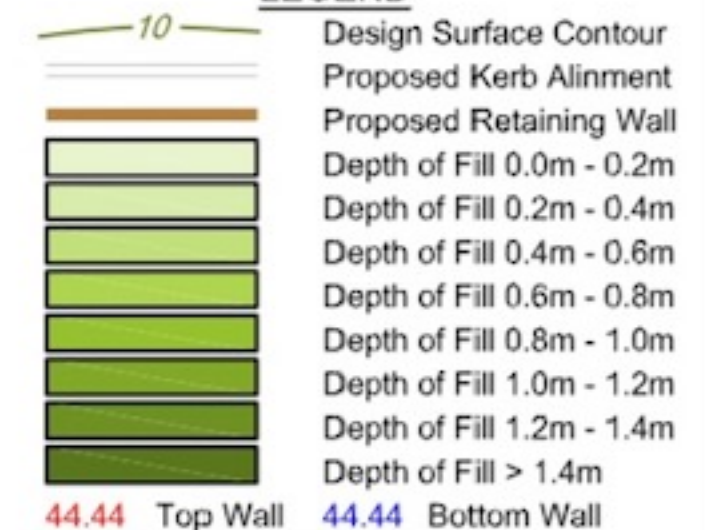

Scale @ A4 1:300 Meridian: MGA Zone 56

Height Datum: AHD Origin: OPM154879 RL 4.003m

This plan has been prepared by B Planned and Surveyed P/L (ACN 607 422 293), Cadastral Surveyor.  
Date: 10/05/2024

Plan Number: 002259\_12\_DP Rev B



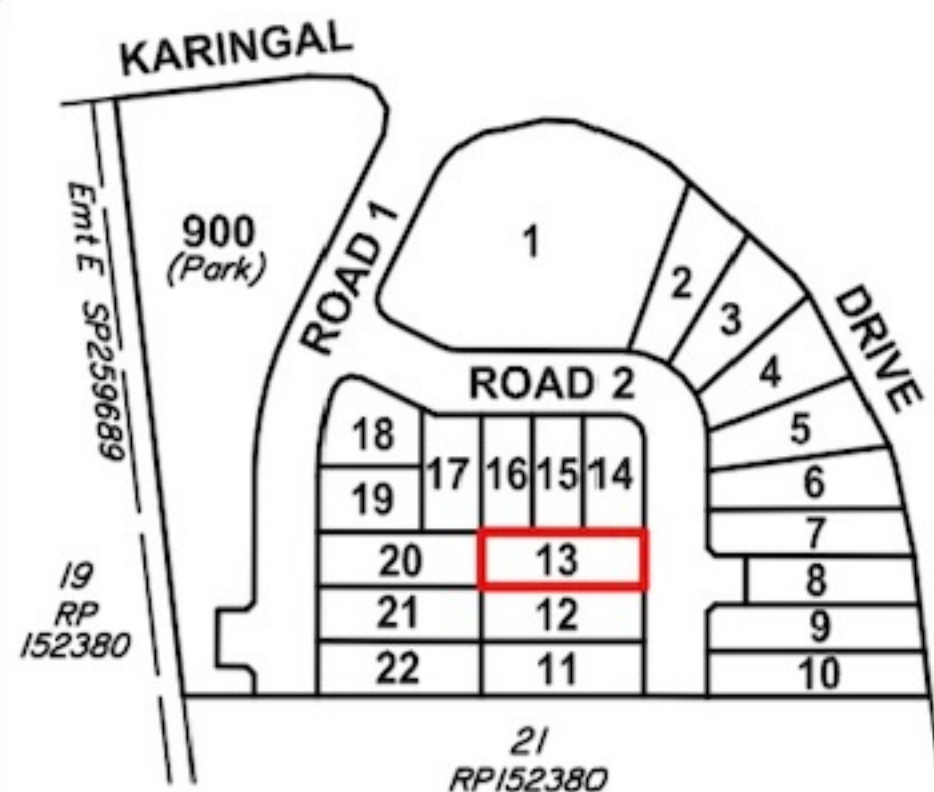

## ESTATE LAYOUT

Not to Scale

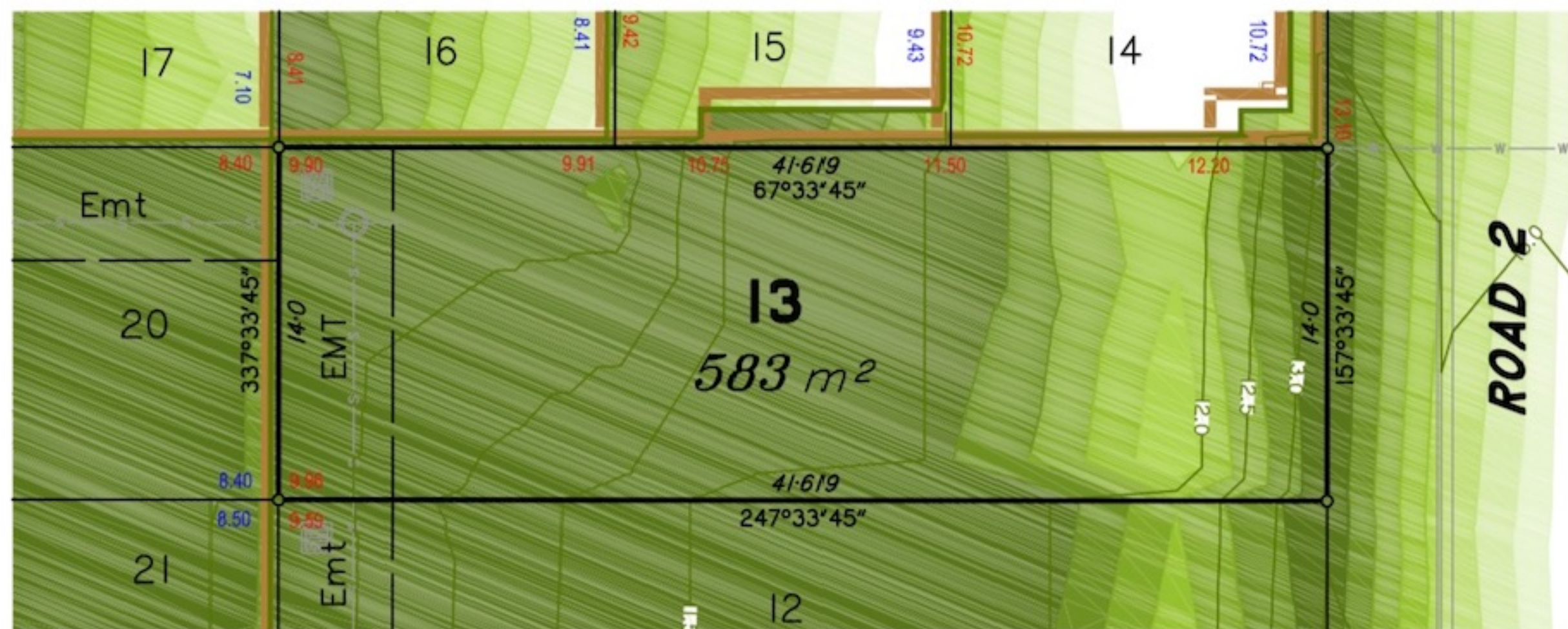

Scale 1:300 - Lengths are in Metres.

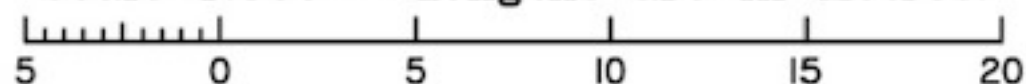

Brisbane P. 07 3161 1501  
Gold Coast P. 07 5594 4469  
admin@bsurveyed.com.au

TOWN PLANNING  
SURVEYING  
DEVELOPMENT  
CONSULTANTS

## DISCLOSURE PLAN

Proposed Lot 13

on SP347477

Described as Part of  
Lot 20 on RP152380

Locality: PIMPAMA

Local Authority: GOLD COAST C. C.

### NOTE:

Areas and dimensions are subject to survey and registration of the survey plan by the Department of Natural Resources and Mines.

The effective development permit for Reconfiguring a Lot (1 Lots into 22 Lots) for the allotment, being Development Permit - approved by Gold Coast City Council on 1/08/2017 App No: ROL201700005 and is subject to conditions.

All fill shall be placed and compacted in a controlled manner so that Level (1) level of responsibility may be achieved and certified as per AS3798-2007.

### LEGEND

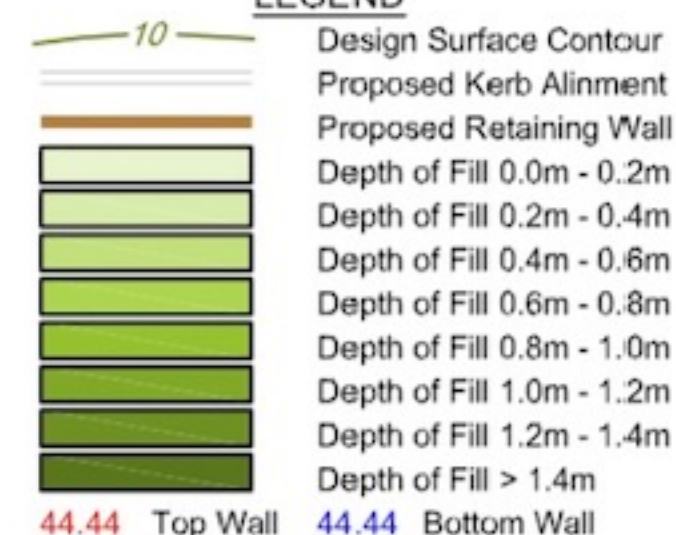

Scale @ A4 1:300 Meridian: MGA Zone 56

Height Datum: AHD Origin: OPM154879 RL 4.003m

This plan has been prepared by B Planned and Surveyed P/L (ACN 607 422 293), Cadastral Surveyor.  
Date: 10/05/2024

Plan Number: 002259\_13\_DP Rev B





**ESTATE LAYOUT**

Not to Scale

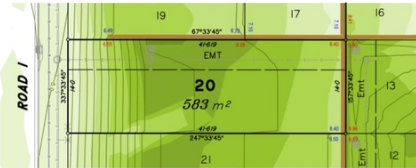

Scale 1:300 - Lengths are in Metres.



**B**  
bplanned & surveyed

Brisbane P. 07 3161 1501  
Gold Coast P. 07 5594 4469  
admin@bplanned.com.au

TOWN PLANNING  
SURVEYING  
DEVELOPMENT  
CONSULTANTS

**DISCLOSURE PLAN**

Proposed **Lot 20**  
on **SP347477**  
Described as Part of  
Lot 20 on RP152380  
Locality: **PIMPAMA**  
Local Authority: **GOLD COAST C. C.**

**NOTE:**  
Areas and dimensions are subject to survey and registration of the survey plan by the Department of Natural Resources and Mines.  
The effective development permit for Reconfiguring a Lot (1 Lots into 22 Lots) for the allotment, being Development Permit - approved by Gold Coast City Council on 1/08/2017 App No: RDL201700005 and is subject to conditions.  
All fill shall be placed and compacted in a controlled manner so that Level (1) level of responsibility may be achieved and certified as per AS3798-2007.



Scale @ A4	Metric: MGA Zone 56
Height datum: AHD	Origin: GPM154879 RL 4.000m
This plan has been prepared by B Planned and Surveyed P/L (ACN 607 422 293), Cadastral Surveyor.	
Date: 10/05/2024	
Plan Number: 002259_20_DP Rev A	

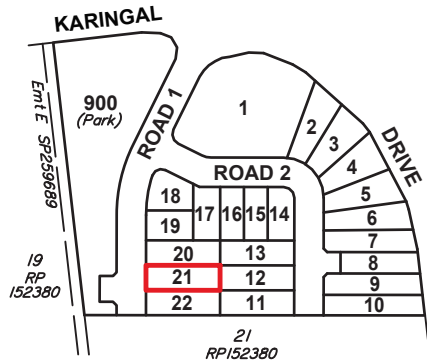

#### LEGEND

- S — Sewer
- D — Stormwater
- W — Water
- T — Comms
- Electricity



#### ESTATE LAYOUT

Not to Scale

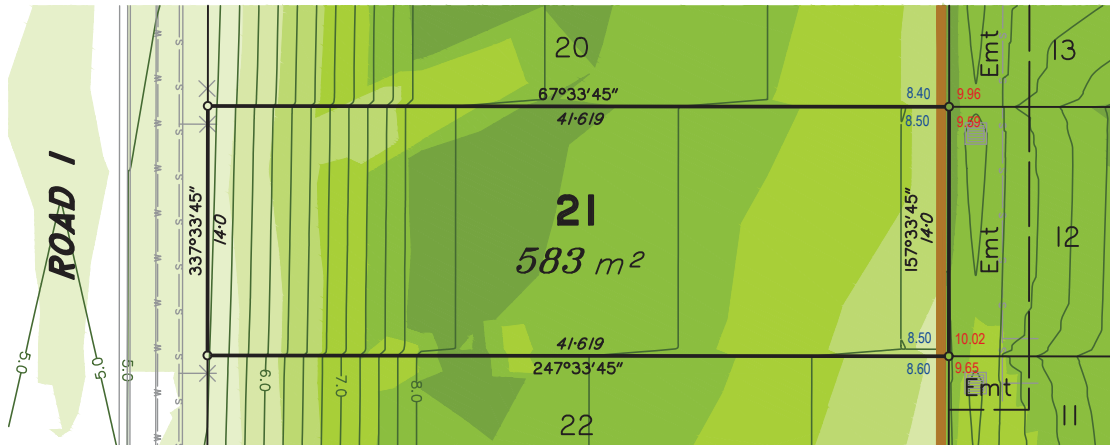

Scale 1:300 - Lengths are in Metres.



Brisbane P. 07 3161 1501  
Gold Coast P. 07 5594 4469  
admin@bsurveyed.com.au

TOWN PLANNING  
SURVEYING  
DEVELOPMENT  
CONSULTANTS

## DISCLOSURE PLAN

Proposed Lot 21

on SP347477

Described as Part of

Lot 20 on RP152380

Locality: PIMPAMA

Local Authority: GOLD COAST C. C.

#### NOTE:

Areas and dimensions are subject to survey and registration of the survey plan by the Department of Natural Resources and Mines.

The effective development permit for Reconfiguring a Lot (1 Lots into 22 Lots) for the allotment, being Development Permit - approved by Gold Coast City Council on 1/08/2017 App No. ROL201700005 - is subject to conditions.

All fill shall be placed and compacted in a controlled manner so that Level (1) level of responsibility may be achieved and certified as per AS3798-2007.

#### LEGEND

- 10 — Design Surface Contour
- Proposed Kerb Alignment
- Proposed Retaining Wall
- Depth of Fill 0.0m - 0.5m
- Depth of Fill 0.5m - 1.0m
- Depth of Fill 1.0m - 1.5m
- Depth of Fill 1.5m - 2.0m
- Depth of Fill 2.0m - 2.5m
- Depth of Fill 2.5m - 3.0m
- Depth of Fill 3.0m - 3.5m
- Depth of Fill > 3.5m
- 44.44 Top Wall
- 44.44 Bottom Wall

Scale @ A4 Meridian: MGA Zone 56

Height 0.000: AHD Origin: OPM154879 RL 4.003m

This plan has been prepared by B Planned and Surveyed P/L (ACN 607 422 293), Cadastral Surveyor.  
Date: 10/05/2024

Plan Number: 002259\_21\_DP Rev A

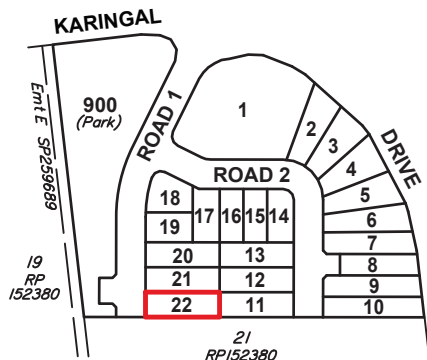

#### LEGEND

- S — Sewer
- D — Stormwater
- W — Water
- T — Comms
- E — Electricity



#### ESTATE LAYOUT

Not to Scale

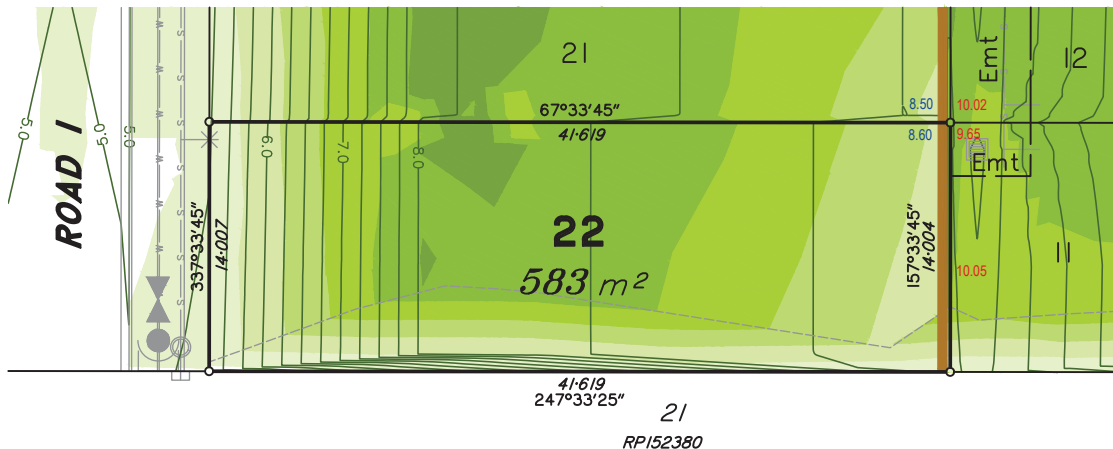

Scale 1:300 - Lengths are in Metres.

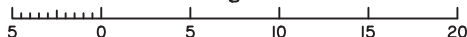

Brisbane P. 07 3161 1501  
Gold Coast P. 07 5594 4469  
admin@bsurveyed.com.au

TOWN PLANNING  
SURVEYING  
DEVELOPMENT  
CONSULTANTS

## DISCLOSURE PLAN

Proposed Lot 22

on SP347477

Described as Part of

Lot 20 on RP152380

Locality: PIMPAMA

Local Authority: GOLD COAST C. C.

#### NOTE:

Areas and dimensions are subject to survey and registration of the survey plan by the Department of Natural Resources and Mines.

The effective development permit for Reconfiguring a Lot (1 Lots into 22 Lots) for the allotment, being Development Permit - approved by Gold Coast City Council on 1/08/2017 App No: ROL201700005 and is subject to conditions.

All fill shall be placed and compacted in a controlled manner so that Level (1) level of responsibility may be achieved and certified as per AS3798-2007.

#### LEGEND

- 10 — Design Surface Contour
- Proposed Kerb Alinement
- Proposed Retaining Wall
- Depth of Fill 0.0m - 0.5m
- Depth of Fill 0.5m - 1.0m
- Depth of Fill 1.0m - 1.5m
- Depth of Fill 1.5m - 2.0m
- Depth of Fill 2.0m - 2.5m
- Depth of Fill 2.5m - 3.0m
- Depth of Fill 3.0m - 3.5m
- Depth of Fill > 3.5m
- 44.44 Top Wall 44.44 Bottom Wall

Scale @ A4 Meridian: MGA Zone 56

Height D200: AHD Origin: OPM154879 RL 4.003m

This plan has been prepared by B Planned and Surveyed P/L (ACN 607 422 293), Cadastral Surveyor.  
Date: 10/05/2024

Plan Number: 002259\_22\_DP Rev A