



#### LEGEND

- S — Sewer
- D — Stormwater
- W — Water
- T — Comms
- Electricity



#### ESTATE LAYOUT

Not to Scale

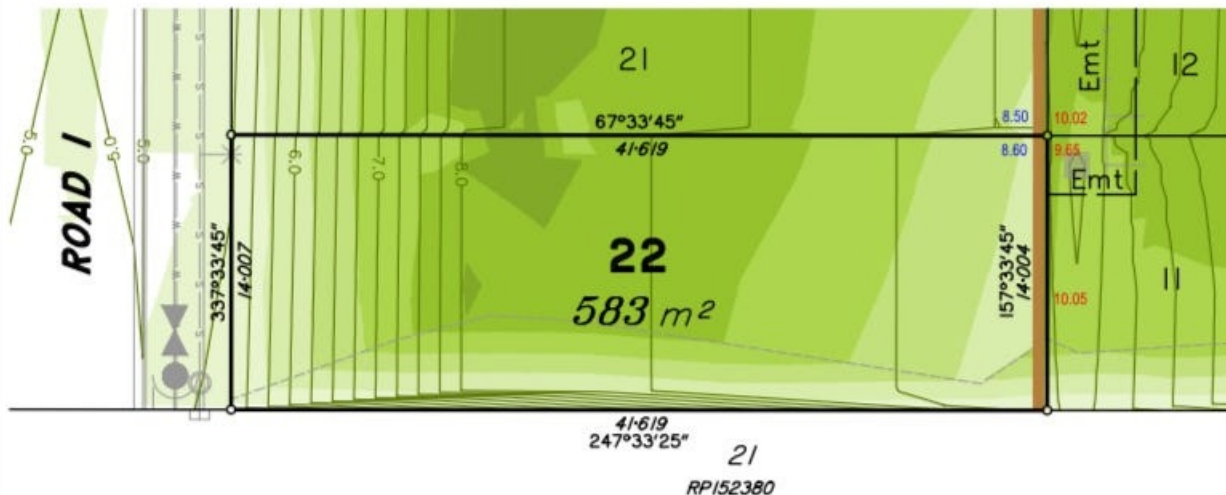

Scale 1:300 - Lengths are in Metres.



Brisbane P. 07 3161 1501  
Gold Coast P. 07 5594 4469  
admin@bsurveyed.com.au

TOWN PLANNING  
SURVEYING  
DEVELOPMENT  
CONSULTANTS

#### DISCLOSURE PLAN

Proposed Lot 22

on SP347477

Described as Part of

Lot 20 on RP152380

Locality: PIMPAMA

Local Authority: GOLD COAST C. C.

#### NOTE:

Areas and dimensions are subject to survey and registration of the survey plan by the Department of Natural Resources and Mines.

The effective development permit for Reconfiguring a Lot (1 Lots into 22 Lots) for the allotment, being Development Permit - approved by Gold Coast City Council on 1/08/2017 App No: ROL201700005 and is subject to conditions.

All fill shall be placed and compacted in a controlled manner so that Level (1) level of responsibility may be achieved and certified as per AS3798-2007.

#### LEGEND

- 10 — Design Surface Contour
- Proposed Kerb Alignment
- Proposed Retaining Wall
- Depth of Fill 0.0m - 0.5m
- Depth of Fill 0.5m - 1.0m
- Depth of Fill 1.0m - 1.5m
- Depth of Fill 1.5m - 2.0m
- Depth of Fill 2.0m - 2.5m
- Depth of Fill 2.5m - 3.0m
- Depth of Fill 3.0m - 3.5m
- Depth of Fill > 3.5m
- 44.44 Top Wall 44.44 Bottom Wall

Scale @ A4 Meridian: MGA Zone 56

Height Datum: AHD Origin: OPM154879 RL 4.003m

This plan has been prepared by B Planned and Surveyed P/L (ACN 607 422 293), Cadastral Surveyor.  
Date: 10/05/2024

Plan Number: 002259\_22\_DP Rev A