

This Disclosure Plan is prepared for the sole purpose of satisfying the disclosure requirements of the Land Sales Act and SHOULD NOT be used for any other purpose, particularly as-constructed purposes. This information is compiled from design plans only, unless otherwise stated, and therefore is subject to final survey and construction of operational works.

Proposed Lot 3 Restricted to a depth of 21.336m from the surface. (See RPI32756)

LEGEND

-----	Existing Contours	— E —	Electricity
— W —	Water	— T —	Telstra
— SW —	Stormwater	=====	Kerb & Channel
— S —	Sewer		

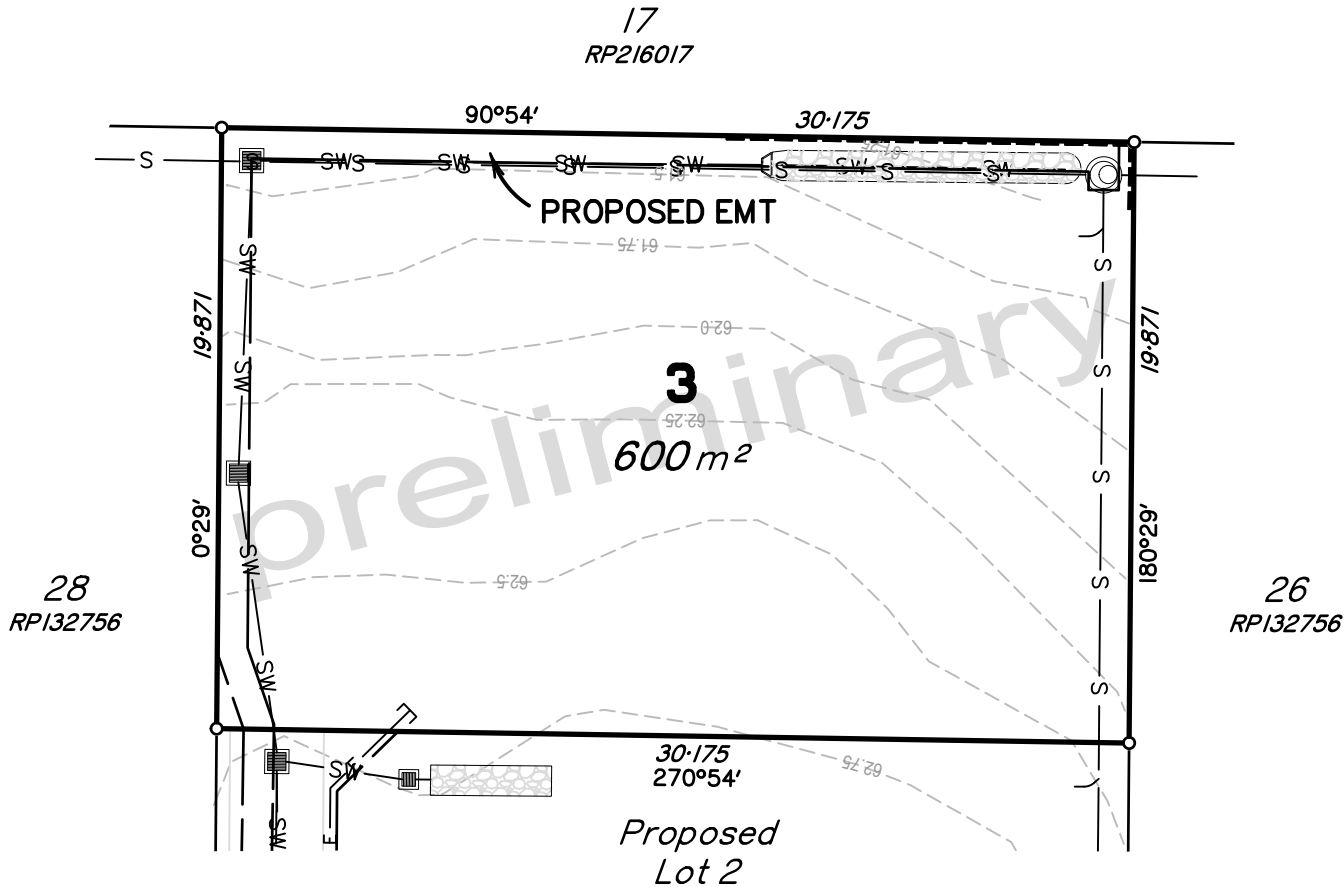

Scale 1:250 - Lengths are in Metres.

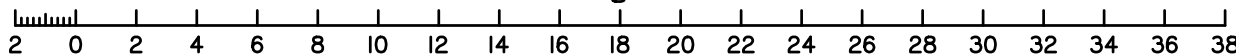

**DISCLOSURE PLAN
PROPOSED LOT 3**

Described as Part of Lot 27 on RPI32756
11 Shanahan Parade,
REDBANK PLAINS, QLD 4301

Surveyors Note:
This plan has been prepared by AXIS SURVEYS PTY LTD (ACN 010 743 174), which is registered with the Surveyors Board of Queensland as a Cadastral Surveyor.

Builders Note:
Builders shall not build off the design levels shown; a site survey is required. This note is an intergral part of this plan.

Engineers Note:
These plans have been prepared by using Engineering design information supplied digitally by Meliora Consulting Engineers. Feb 2023.

Compaction Statement:
Refer to Earthworks / Geotech parameters on Meliora Consulting Engineers Earthworks Layout Plan DWG C20 Rev 01 Dated Feb 2023.

Client **BRENDAN JAMES BROPHY**

Scale **1 : 250 (A4)**

Level Datum **AHD (Derived)**

Height Origin **GNSS**

Design Contour Interval **0.10 m**

Exiting Contour Interval **0.25 m**

Local Authority **Ipswich City Council**

Date **19 June 2023** | Drawn **AD**

Axis Surveys Pty Ltd ABN 94 010 743 174
Trading as: ACN 010 743 174



Unit 5, 23 Overlord Place, ACACIA RIDGE, QLD, 4110
Ph (07) 3363 8100, www.axisurveys.com.au

DWG No. **I563955 - DP 03**