



www.lemottee.com

www.lemottee.com

NOTES_G

DRAFT ONLY

0 10 20 30 40 50 75m
SCALE 1:2000 @ A1

Surveyed

Title

**PRELIMINARY CONCEPT PLAN
WITH AERIAL**
EDEN LAND FUND PTY LTD

Our Ref:

8235 CONCEPT-V6

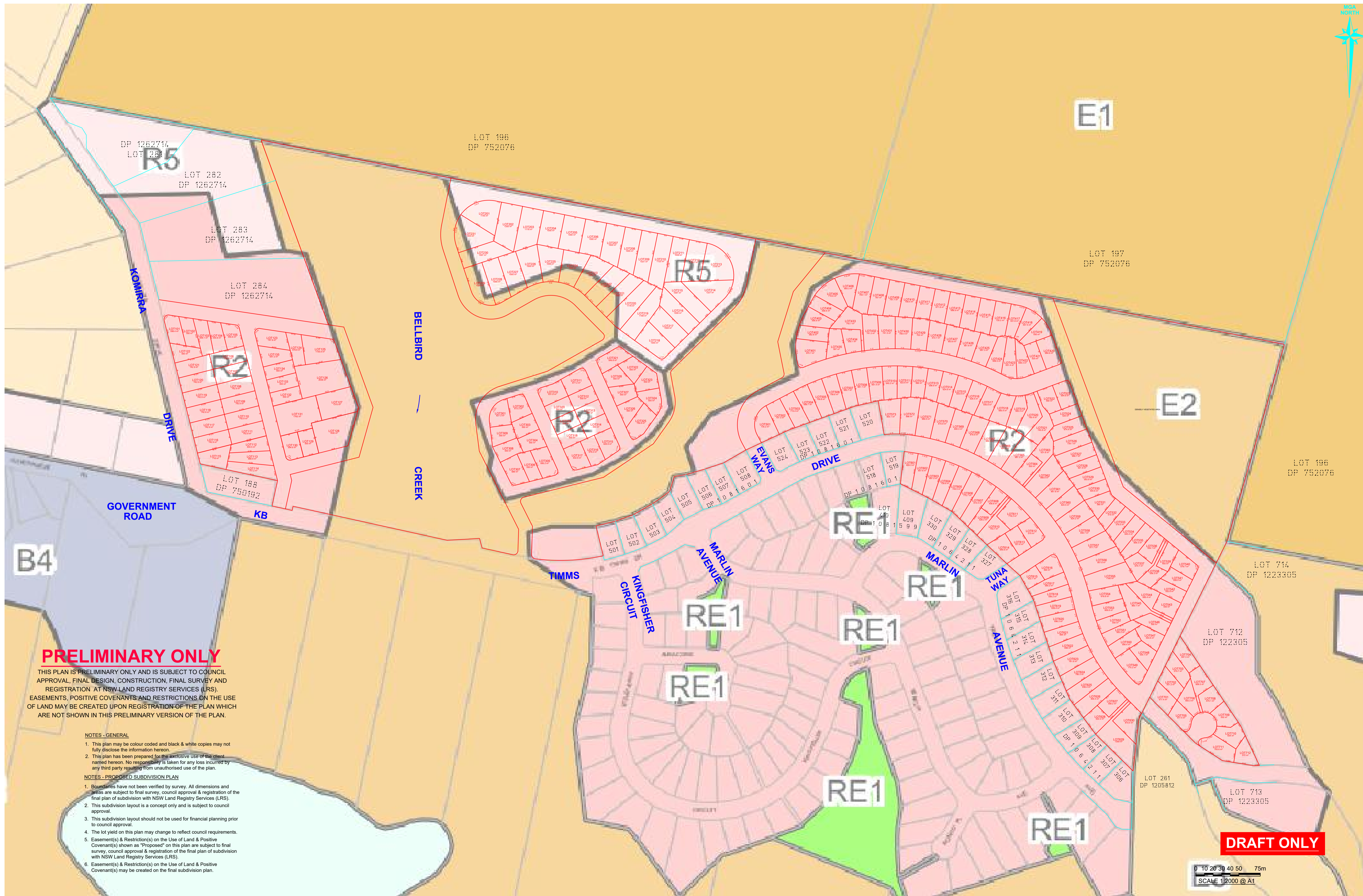

PRELIMINARY ONLY

THIS PLAN IS PRELIMINARY ONLY AND IS SUBJECT TO COUNCIL APPROVAL, FINAL DESIGN, CONSTRUCTION, FINAL SURVEY AND REGISTRATION AT NSW LAND REGISTRY SERVICES (LRS). EASEMENTS, POSITIVE COVENANTS AND RESTRICTIONS ON THE USE OF LAND MAY BE CREATED UPON REGISTRATION OF THE PLAN WHICH ARE NOT SHOWN IN THIS PRELIMINARY VERSION OF THE PLAN.

NOTES - GENERAL

- 1. This plan may be colour coded and black & white copies may not fully disclose the information herein.
- 2. This plan has been prepared for the exclusive use of the client named herein. No responsibility is taken for any loss incurred by any third party resulting from unauthorised use of the plan.

NOTES - PROPOSED SUBDIVISION PLAN

- 1. Boundaries have not been verified by survey. All dimensions and areas are subject to final survey, council approval & registration of the final plan of subdivision with NSW Land Registry Services (LRS).
- 2. This subdivision layout is a concept only and is subject to council approval.
- 3. This subdivision layout should not be used for financial planning prior to council approval.
- 4. The lot yield on this plan may change to reflect council requirements.
- 5. Easement(s) & Restriction(s) on the Use of Land & Positive Covenant(s) shown as "Proposed" on this plan are subject to final survey, council approval & registration of the final plan of subdivision with NSW Land Registry Services (LRS).
- 6. Easement(s) & Restriction(s) on the Use of Land & Positive Covenant(s) may be created on the final subdivision plan.

DRAFT ONLY

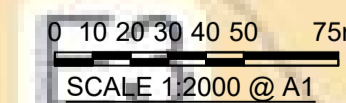

Technical Details:
Azimuth - MGA

Northing -

Contour Int. -

Surveyed

Drafted
24/05/2022

Checked
PLM 25/05/2022

Title

Client

Site

Locality

**PRELIMINARY CONCEPT PLAN
WITH ZONING**
EDEN LAND FUND PTY LTD
LOT 285 DP 1262714 & LOT 711 DP 1223305 - KB TIMMS DRIVE
LGA BEGA VALLEY

Our Ref.

8235 CONCEPT-V6

Original Size

A1

Sheet No.

2 of 10

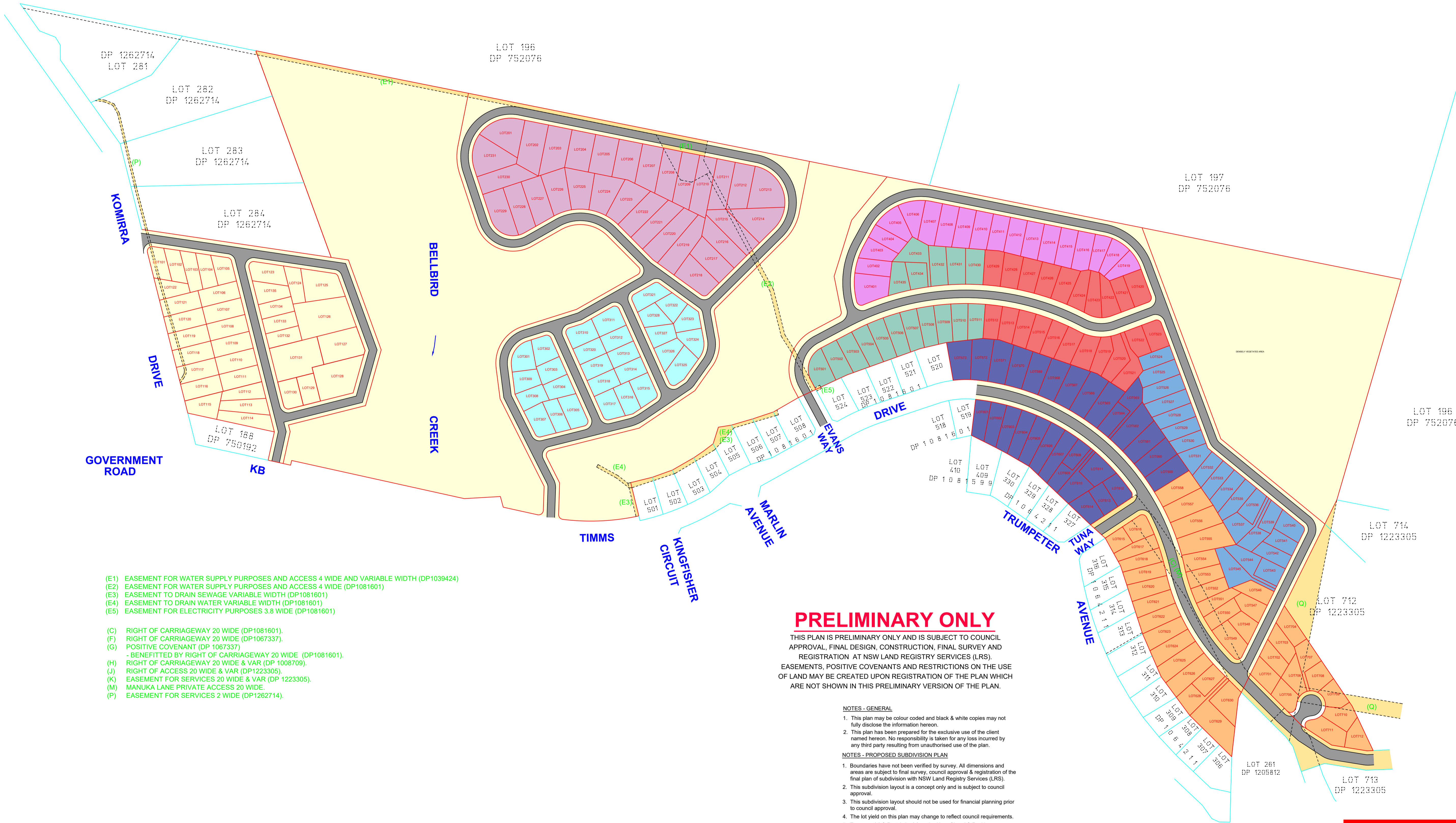

- (E1) EASEMENT FOR WATER SUPPLY PURPOSES AND ACCESS 4 WIDE AND VARIABLE WIDTH (DP1039424)
- (E2) EASEMENT FOR WATER SUPPLY PURPOSES AND ACCESS 4 WIDE (DP1081601)
- (E3) EASEMENT TO DRAIN SEWAGE VARIABLE WIDTH (DP1081601)
- (E4) EASEMENT TO DRAIN WATER VARIABLE WIDTH (DP1081601)
- (E5) EASEMENT FOR ELECTRICITY PURPOSES 3.8 WIDE (DP1081601)
- (C) RIGHT OF CARRIAGEWAY 20 WIDE (DP1081601)
- (F) RIGHT OF CARRIAGEWAY 20 WIDE (DP1067337)
- (G) POSITIVE COVENANT (DP 1067337)
- BENEFITTED BY RIGHT OF CARRIAGEWAY 20 WIDE (DP1081601)
- (H) RIGHT OF CARRIAGEWAY 20 WIDE & VAR (DP 1008709)
- (J) RIGHT OF ACCESS 20 WIDE & VAR (DP1223305)
- (K) EASEMENT FOR SERVICES 20 WIDE & VAR (DP 1223305)
- (M) MANUKA LANE PRIVATE ACCESS 20 WIDE
- (P) EASEMENT FOR SERVICES 2 WIDE (DP1262714)

PRELIMINARY ONLY
 THIS PLAN IS PRELIMINARY ONLY AND IS SUBJECT TO COUNCIL APPROVAL, FINAL DESIGN, CONSTRUCTION, FINAL SURVEY AND REGISTRATION AT NSW LAND REGISTRY SERVICES (LRS). EASEMENTS, POSITIVE COVENANTS AND RESTRICTIONS ON THE USE OF LAND MAY BE CREATED UPON REGISTRATION OF THE PLAN WHICH ARE NOT SHOWN IN THIS PRELIMINARY VERSION OF THE PLAN.

- NOTES - GENERAL**
- This plan may be colour coded and black & white copies may not fully disclose the information herein.
 - This plan has been prepared for the exclusive use of the client named herein. No responsibility is taken for any loss incurred by any third party resulting from unauthorised use of the plan.
- NOTES - PROPOSED SUBDIVISION PLAN**
- Boundaries have not been verified by survey. All dimensions and areas are subject to final survey, council approval & registration of the final plan of subdivision with NSW Land Registry Services (LRS).
 - This subdivision layout is a concept only and is subject to council approval.
 - This subdivision layout should not be used for financial planning prior to council approval.
 - The lot yield on this plan may change to reflect council requirements.
 - Easement(s) & Restriction(s) on the Use of Land & Positive Covenant(s) shown as "Proposed" on this plan are subject to final survey, council approval & registration of the final plan of subdivision with NSW Land Registry Services (LRS).
 - Easement(s) & Restriction(s) on the Use of Land & Positive Covenant(s) may be created on the final subdivision plan.

DRAFT ONLY

0 10 20 30 40 50 75m
SCALE 1:2000 @ A1

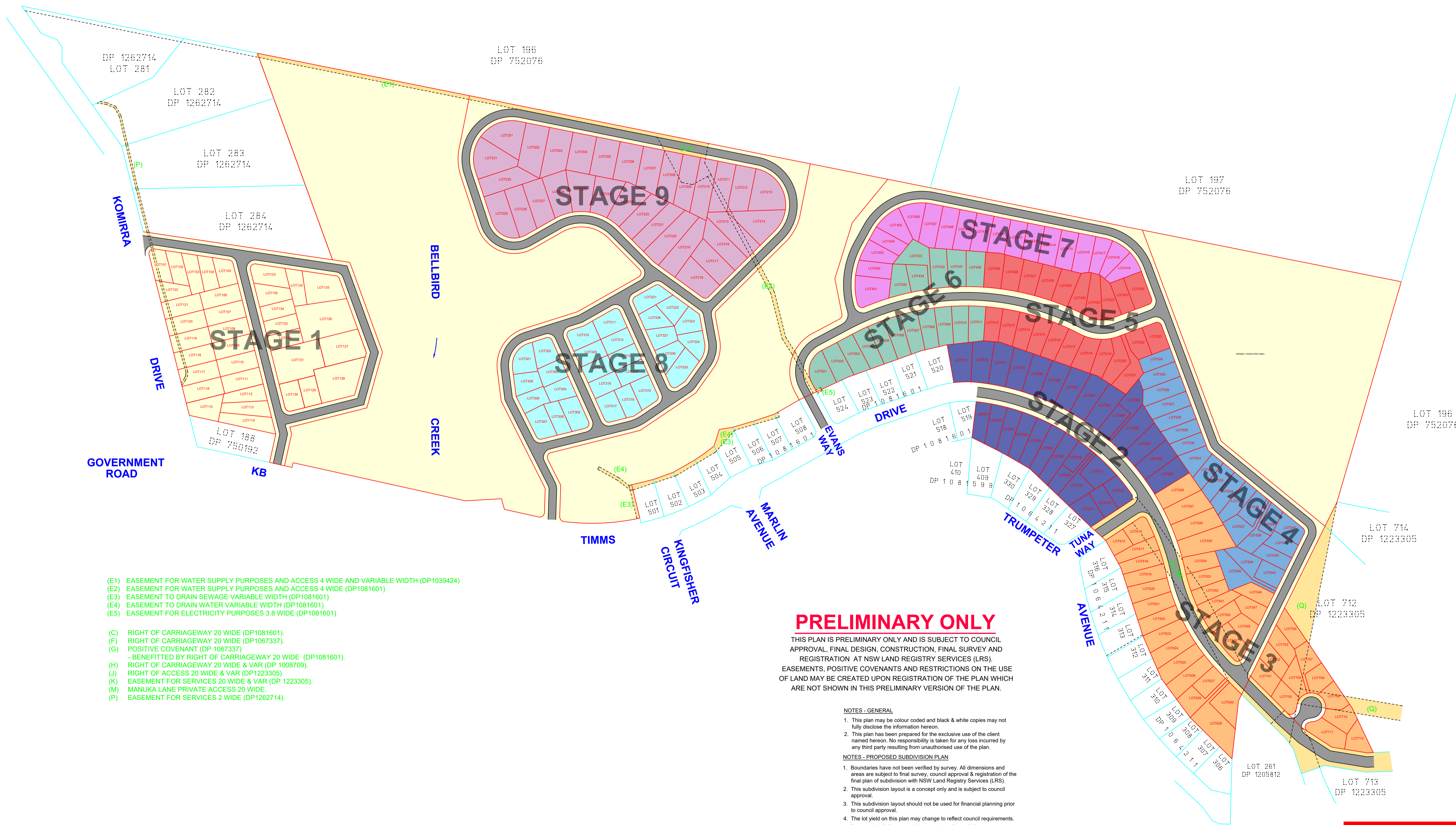
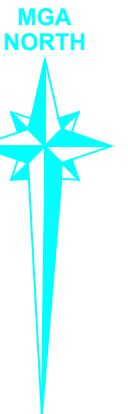

- (E1) EASEMENT FOR WATER SUPPLY PURPOSES AND ACCESS 4 WIDE AND VARIABLE WIDTH (DP1039424)
- (E2) EASEMENT FOR WATER SUPPLY PURPOSES AND ACCESS 4 WIDE (DP1081601)
- (E3) EASEMENT TO DRAIN SEWAGE VARIABLE WIDTH (DP1081601)
- (E4) EASEMENT TO DRAIN WATER VARIABLE WIDTH (DP1081601)
- (E5) EASEMENT FOR ELECTRICITY PURPOSES 3.8 WIDE (DP1081601)
- (C) RIGHT OF CARRIAGEWAY 20 WIDE (DP1081601)
- (F) RIGHT OF CARRIAGEWAY 20 WIDE (DP1067337)
- (G) POSITIVE COVENANT (DP 1067337)
- BENEFITTED BY RIGHT OF CARRIAGEWAY 20 WIDE (DP1081601)
- (H) RIGHT OF CARRIAGEWAY 20 WIDE & VAR (DP 1008709)
- (J) RIGHT OF ACCESS 20 WIDE & VAR (DP1223305)
- (K) EASEMENT FOR SERVICES 20 WIDE & VAR (DP 1223305)
- (M) MANUKA LANE PRIVATE ACCESS 20 WIDE
- (P) EASEMENT FOR SERVICES 2 WIDE (DP1262714)

PRELIMINARY ONLY
 THIS PLAN IS PRELIMINARY ONLY AND IS SUBJECT TO COUNCIL APPROVAL, FINAL DESIGN, CONSTRUCTION, FINAL SURVEY AND REGISTRATION AT NSW LAND REGISTRY SERVICES (LRS). EASEMENTS, POSITIVE COVENANTS AND RESTRICTIONS ON THE USE OF LAND MAY BE CREATED UPON REGISTRATION OF THE PLAN WHICH ARE NOT SHOWN IN THIS PRELIMINARY VERSION OF THE PLAN.

- NOTES - GENERAL**
- This plan may be colour coded and black & white copies may not fully disclose the information herein.
 - This plan has been prepared for the exclusive use of the client named herein. No responsibility is taken for any loss incurred by any third party resulting from unauthorised use of the plan.
- NOTES - PROPOSED SUBDIVISION PLAN**
- Boundaries have not been verified by survey. All dimensions and areas are subject to final survey, council approval & registration of the final plan of subdivision with NSW Land Registry Services (LRS).
 - This subdivision layout is a concept only and is subject to council approval.
 - This subdivision layout should not be used for financial planning prior to council approval.
 - The lot yield on this plan may change to reflect council requirements.
 - Easement(s) & Restriction(s) on the Use of Land & Positive Covenant(s) shown as "Proposed" on this plan are subject to final survey, council approval & registration of the final plan of subdivision with NSW Land Registry Services (LRS).
 - Easement(s) & Restriction(s) on the Use of Land & Positive Covenant(s) may be created on the final subdivision plan.

DRAFT ONLY

0 10 20 30 40 50 75m
SCALE 1:2000 @ A1

Technical Details:
 Azimuth - MGA
 Northing -

Datum -
 Origin -
 R.L. -
 Contour Int. -

Surveyed
 Drafted 24/05/2022
 Checked PLM 25/05/2022

Title
 Client
 Site
 Locality EDEN

**PRELIMINARY CONCEPT PLAN
 STAGING PLAN**
 EDEN LAND FUND PTY LTD
 LOT 285 DP 1262714 & LOT 711 DP 1223305 - KB TIMMS DRIVE
 LGA BEGA VALLEY

Our Ref:
8235 CONCEPT-V6
 Original Size Sheet No.
A1 4 of 10

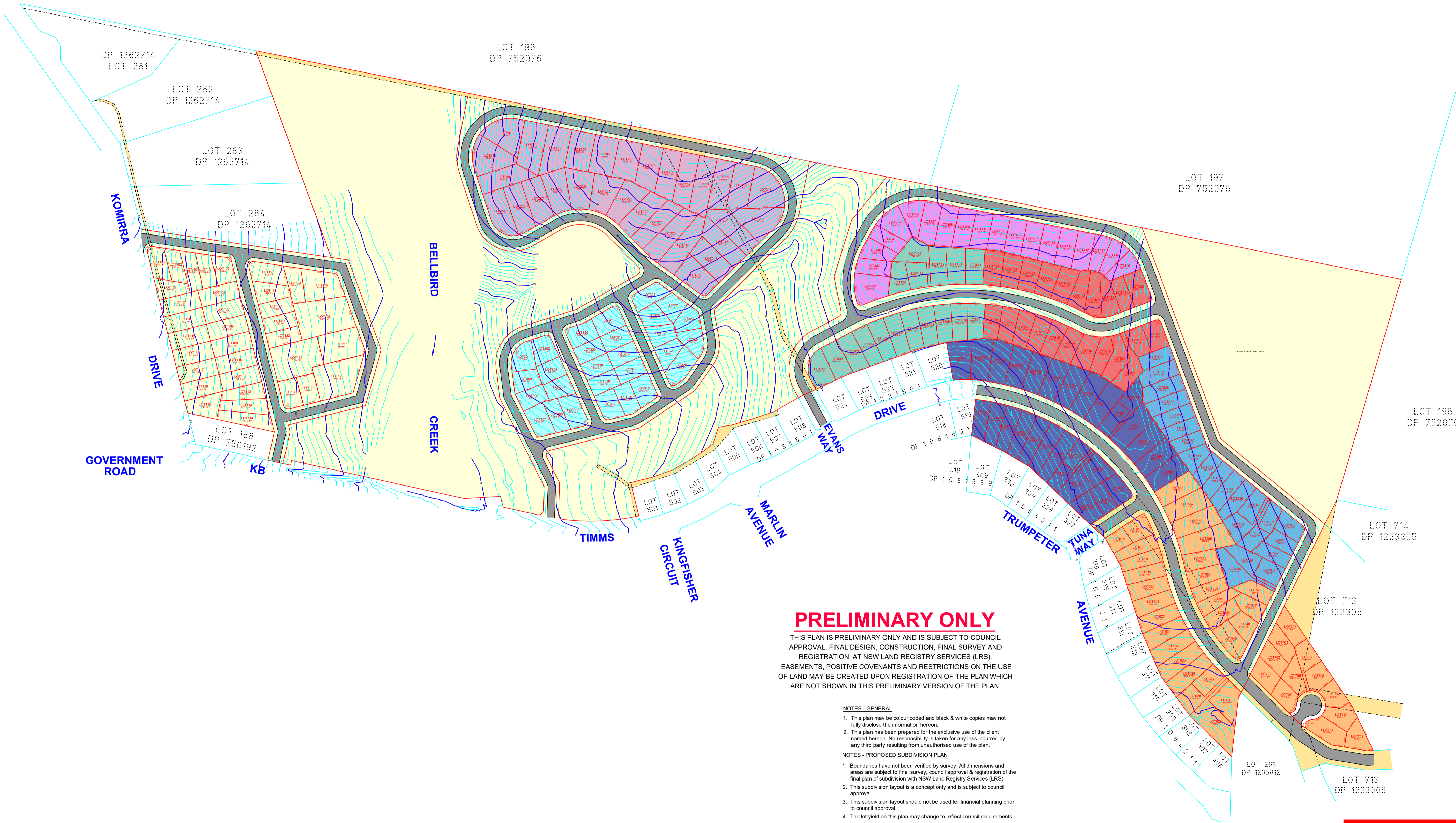

PRELIMINARY ONLY

THIS PLAN IS PRELIMINARY ONLY AND IS SUBJECT TO COUNCIL APPROVAL, FINAL DESIGN, CONSTRUCTION, FINAL SURVEY AND REGISTRATION AT NSW LAND REGISTRY SERVICES (LRS). EASEMENTS, POSITIVE COVENANTS AND RESTRICTIONS ON THE USE OF LAND MAY BE CREATED UPON REGISTRATION OF THE PLAN WHICH ARE NOT SHOWN IN THIS PRELIMINARY VERSION OF THE PLAN.

- NOTES - GENERAL**
- This plan may be colour coded and black & white copies may not fully disclose the information herein.
 - This plan has been prepared for the exclusive use of the client named herein. No responsibility is taken for any loss incurred by any third party resulting from unauthorised use of the plan.
- NOTES - PROPOSED SUBDIVISION PLAN**
- Boundaries have not been verified by survey. All dimensions and areas are subject to final survey, council approval & registration of the final plan of subdivision with NSW Land Registry Services (LRS).
 - This subdivision layout is a concept only and is subject to council approval.
 - This subdivision layout should not be used for financial planning prior to council approval.
 - The lot yield on this plan may change to reflect council requirements.
 - Easement(s) & Restriction(s) on the Use of Land & Positive Covenant(s) shown as "Proposed" on this plan are subject to final survey, council approval & registration of the final plan of subdivision with NSW Land Registry Services (LRS).
 - Easement(s) & Restriction(s) on the Use of Land & Positive Covenant(s) may be created on the final subdivision plan.

DRAFT ONLY

0 10 20 30 40 50 75m
SCALE 1:2000 @ A1

www.lemottee.com

www.lemottee.com

COPYRIGHT
THIS DRAWING REMAINS THE PROPERTY OF LE MOTTEE GROUP PTY LTD. IT MAY ONLY BE USED FOR THE PURPOSE FOR WHICH IT WAS COMMISSIONED AND IN ACCORDANCE WITH THE TERMS OF ENGAGEMENT FOR THE COMMISSION. UNAUTHORISED USE OF THIS DRAWING IS PROHIBITED.
Liability limited by a scheme approved under Professionals Standards Legislation

Technical Details:
Azimuth - **MGA**
Origin -
Easting -
Northing -

Datum - **AHD**
Origin - **SSM 60726**
R.L. - **52.705 (AHD)**
Contour Int. - **0.5 METRE**

Surveyed
Drafted
Checked
PLM 25/05/2022

Title
Client
Site
Locality **EDEN**

**PRELIMINARY CONCEPT PLAN
SITE WITH CONTOURS**
EDEN LAND FUND PTY LTD
LOT 285 DP 1262714 & LOT 711 DP 1223305 - KB TIMMS DRIVE
LGA **BEGA VALLEY**

Our Ref. **8235 CONCEPT-V6**
Original Size **A1**
Sheet No. **5 of 10**

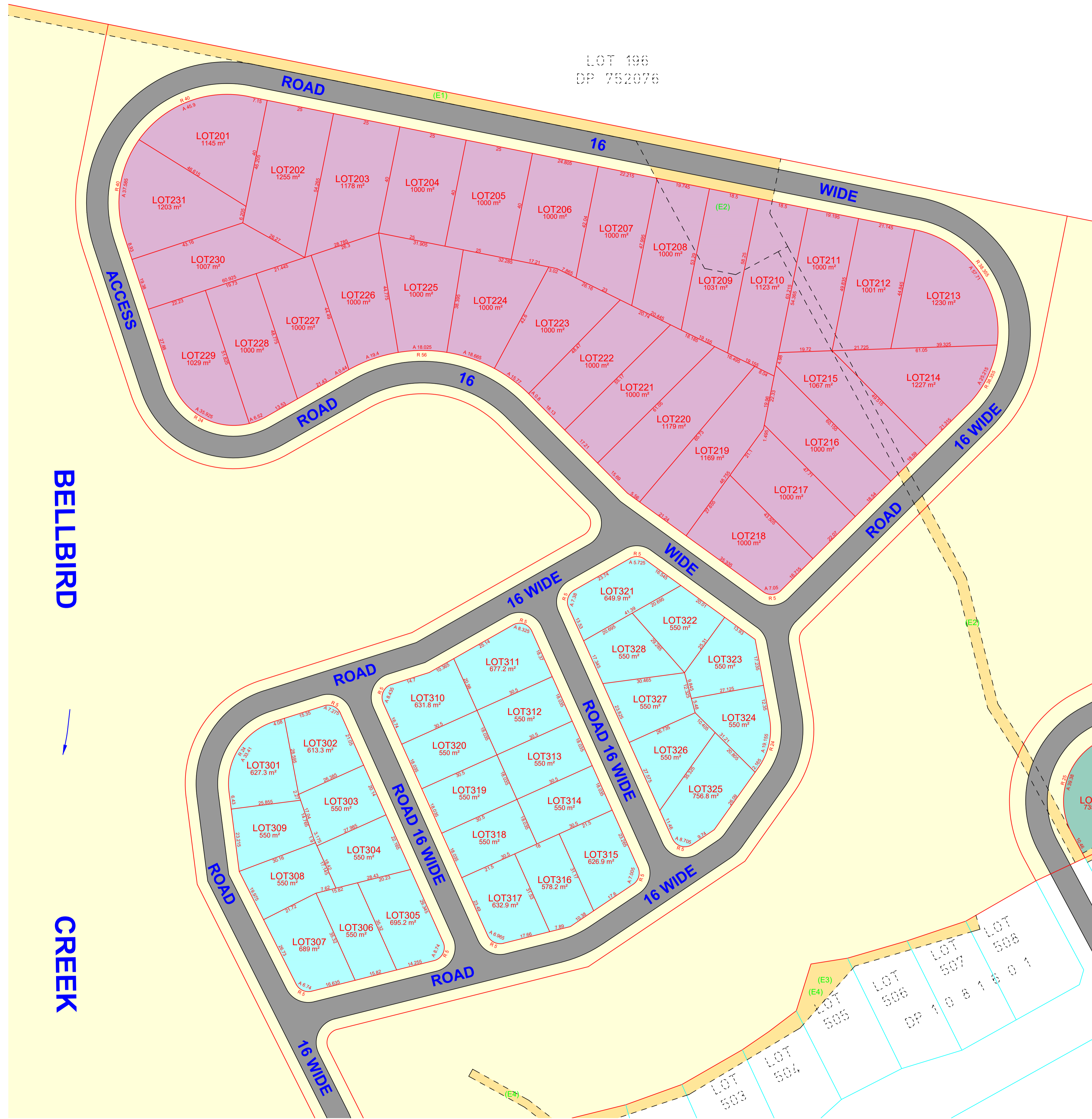

- (E1) EASEMENT FOR WATER SUPPLY PURPOSES AND ACCESS 4 WIDE AND VARIABLE WIDTH (DP1039424)
- (E2) EASEMENT FOR WATER SUPPLY PURPOSES AND ACCESS 4 WIDE (DP1081601)
- (E3) EASEMENT TO DRAIN SEWAGE VARIABLE WIDTH (DP1081601)
- (E4) EASEMENT TO DRAIN WATER VARIABLE WIDTH (DP1081601)

PRELIMINARY ONLY

THIS PLAN IS PRELIMINARY ONLY AND IS SUBJECT TO COUNCIL APPROVAL, FINAL DESIGN, CONSTRUCTION, FINAL SURVEY AND REGISTRATION AT NSW LAND REGISTRY SERVICES (LRS). EASEMENTS, POSITIVE COVENANTS AND RESTRICTIONS ON THE USE OF LAND MAY BE CREATED UPON REGISTRATION OF THE PLAN WHICH ARE NOT SHOWN IN THIS PRELIMINARY VERSION OF THE PLAN.

NOTES - GENERAL

1. This plan may be colour coded and black & white copies may not fully disclose the information hereon.
2. This plan has been prepared for the exclusive use of the client named hereon. No responsibility is taken for any loss incurred by any third party resulting from unauthorised use of the plan.

NOTES - PROPOSED SUBDIVISION PLAN

1. Boundaries have not been verified by survey. All dimensions and areas are subject to final survey, council approval & registration of the final plan of subdivision with NSW Land Registry Services (LRS).
2. This subdivision layout is a concept only and is subject to council approval.
3. This subdivision layout should not be used for financial planning prior to council approval.
4. The lot yield on this plan may change to reflect council requirements.
5. Easement(s) & Restriction(s) on the Use of Land & Positive Covenant(s) shown as "Proposed" on this plan are subject to final survey, council approval & registration of the final plan of subdivision with NSW Land Registry Services (LRS).
6. Easement(s) & Restriction(s) on the Use of Land & Positive Covenant(s) may be created on the final subdivision plan.

DRAFT ONLY

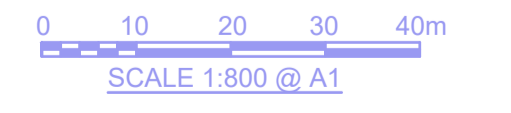

COPYRIGHT
 THIS DRAWING REMAINS THE PROPERTY OF LE MOTTEE GROUP PTY LTD. IT MAY ONLY BE USED FOR THE PURPOSE FOR WHICH IT WAS COMMISSIONED AND IN ACCORDANCE WITH THE TERMS OF ENGAGEMENT. FOR THE COMMISSION. UNAUTHORISED USE OF THIS DRAWING IS PROHIBITED.
 Liability limited by a scheme approved under Professionals Standards Legislation

Technical Details:
 Azimuth - MGA
 Origin -
 Easting -
 Northing -

Datum -
 Origin -
 R.L. -
 Contour Int. -

Surveyed
 Drafted 24/05/2022
 Checked PLM 25/05/2022

Title
 Client
 Site
 Locality EDEN

PRELIMINARY CONCEPT PLAN
STAGES 8 & 9
 EDEN LAND FUND PTY LTD
 LOT 285 DP 1262714 & LOT 711 DP 1223305 - KB TIMMS DRIVE
 LGA BEGA VALLEY

Our Ref: **8235 CONCEPT-V6**
 Original Size Sheet No.
A1 7 of 10

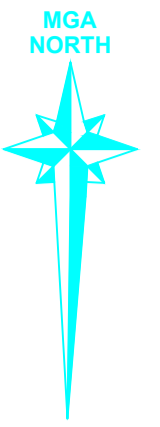

PRELIMINARY ONLY

THIS PLAN IS PRELIMINARY ONLY AND IS SUBJECT TO COUNCIL APPROVAL, FINAL DESIGN, CONSTRUCTION, FINAL SURVEY AND REGISTRATION AT NSW LAND REGISTRY SERVICES (LRS). EASEMENTS, POSITIVE COVENANTS AND RESTRICTIONS ON THE USE OF LAND MAY BE CREATED UPON REGISTRATION OF THE PLAN WHICH ARE NOT SHOWN IN THIS PRELIMINARY VERSION OF THE PLAN.

NOTES - GENERAL

1. This plan may be colour coded and black & white copies may not fully disclose the information herein.
2. This plan has been prepared for the exclusive use of the client named herein. No responsibility is taken for any loss incurred by any third party resulting from unauthorised use of the plan.

NOTES - PROPOSED SUBDIVISION PLAN

1. Boundaries have not been verified by survey. All dimensions and areas are subject to final survey, council approval & registration of the final plan of subdivision with NSW Land Registry Services (LRS).
2. This subdivision layout is a concept only and is subject to council approval.
3. This subdivision layout should not be used for financial planning prior to council approval.
4. The lot yield on this plan may change to reflect council requirements.
5. Easement(s) & Restriction(s) on the Use of Land & Positive Covenant(s) shown as "Proposed" on this plan are subject to final survey, council approval & registration of the final plan of subdivision with NSW Land Registry Services (LRS).
6. Easement(s) & Restriction(s) on the Use of Land & Positive Covenant(s) may be created on the final subdivision plan.

(E2) EASEMENT FOR WATER SUPPLY PURPOSES AND ACCESS 4 WIDE (DP1081601)

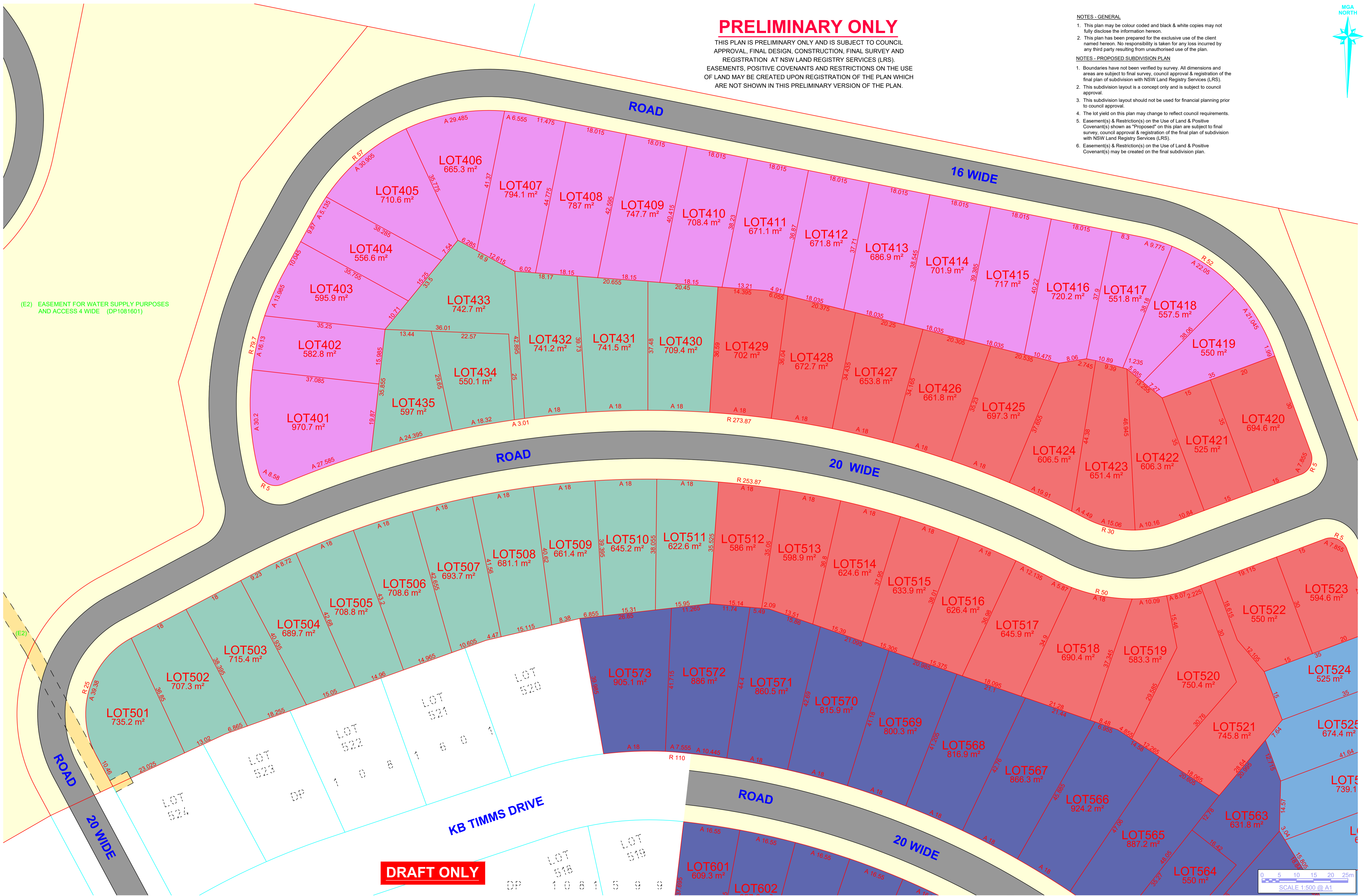

www.lemottee.com

www.lemottee.com

DRAFT ONLY

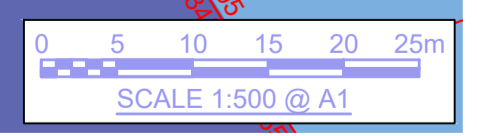



PRELIMINARY ONLY

THIS PLAN IS PRELIMINARY ONLY AND IS SUBJECT TO COUNCIL APPROVAL, FINAL DESIGN, CONSTRUCTION, FINAL SURVEY AND REGISTRATION AT NSW LAND REGISTRY SERVICES (LRS). EASEMENTS, POSITIVE COVENANTS AND RESTRICTIONS ON THE USE OF LAND MAY BE CREATED UPON REGISTRATION OF THE PLAN WHICH ARE NOT SHOWN IN THIS PRELIMINARY VERSION OF THE PLAN.

NOTES - GENERAL

1. This plan may be colour coded and black & white copies may not fully disclose the information hereon.
2. This plan has been prepared for the exclusive use of the client named hereon. No responsibility is taken for any loss incurred by any third party resulting from unauthorised use of the plan.

NOTES - PROPOSED SUBDIVISION PLAN

1. Boundaries have not been verified by survey. All dimensions and areas are subject to final survey, council approval & registration of the final plan of subdivision with NSW Land Registry Services (LRS).
2. This subdivision layout is a concept only and is subject to council approval.
3. This subdivision layout should not be used for financial planning prior to council approval.
4. The lot yield on this plan may change to reflect council requirements.
5. Easement(s) & Restriction(s) on the Use of Land & Positive Covenant(s) shown as "Proposed" on this plan are subject to final survey, council approval & registration of the final plan of subdivision with NSW Land Registry Services (LRS).
6. Easement(s) & Restriction(s) on the Use of Land & Positive Covenant(s) may be created on the final subdivision plan.

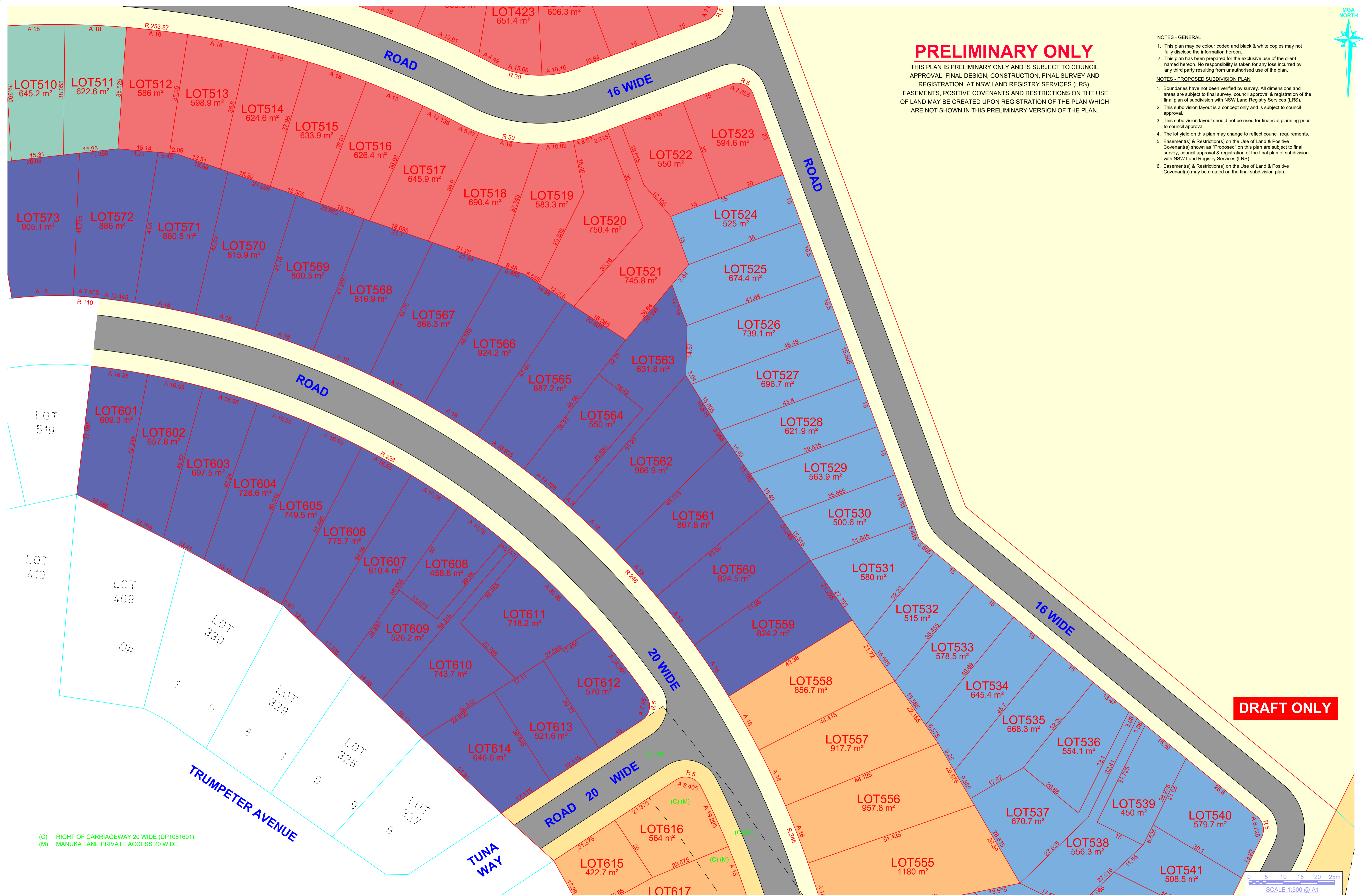

DRAFT ONLY

(C) RIGHT OF CARRIAGEWAY 20 WIDE (DP1081601).
 (M) MANUKA LANE PRIVATE ACCESS 20 WIDE

COPYRIGHT

THIS DRAWING REMAINS THE PROPERTY OF LE MOTTEE GROUP PTY LTD. IT MAY ONLY BE USED FOR THE PURPOSE FOR WHICH IT WAS COMMISSIONED AND IN ACCORDANCE WITH THE TERMS OF ENGAGEMENT. FOR THE COMMISSION. UNAUTHORISED USE OF THIS DRAWING IS PROHIBITED.

Liability limited by a scheme approved under Professionals Standards Legislation

Technical Details:

Azimuth - **MGA**
 Origin -
 Easting -
 Northing -

Datum -
 Origin -
 R.L. -
 Contour Int. -

Surveyed

Drafted
 24/05/2022
 Checked
 PLM 25/05/2022

Title

Client
 Site
 Locality **EDEN**

PRELIMINARY CONCEPT PLAN

STAGES 2, 3 & 4

EDEN LAND FUND PTY LTD

LOT 285 DP 1262714 & LOT 711 DP 1223305 - KB TIMMS DRIVE

LGA BEGA VALLEY

Our Ref:

8235 CONCEPT-V6

Original Size Sheet No.

A1 9 of 10

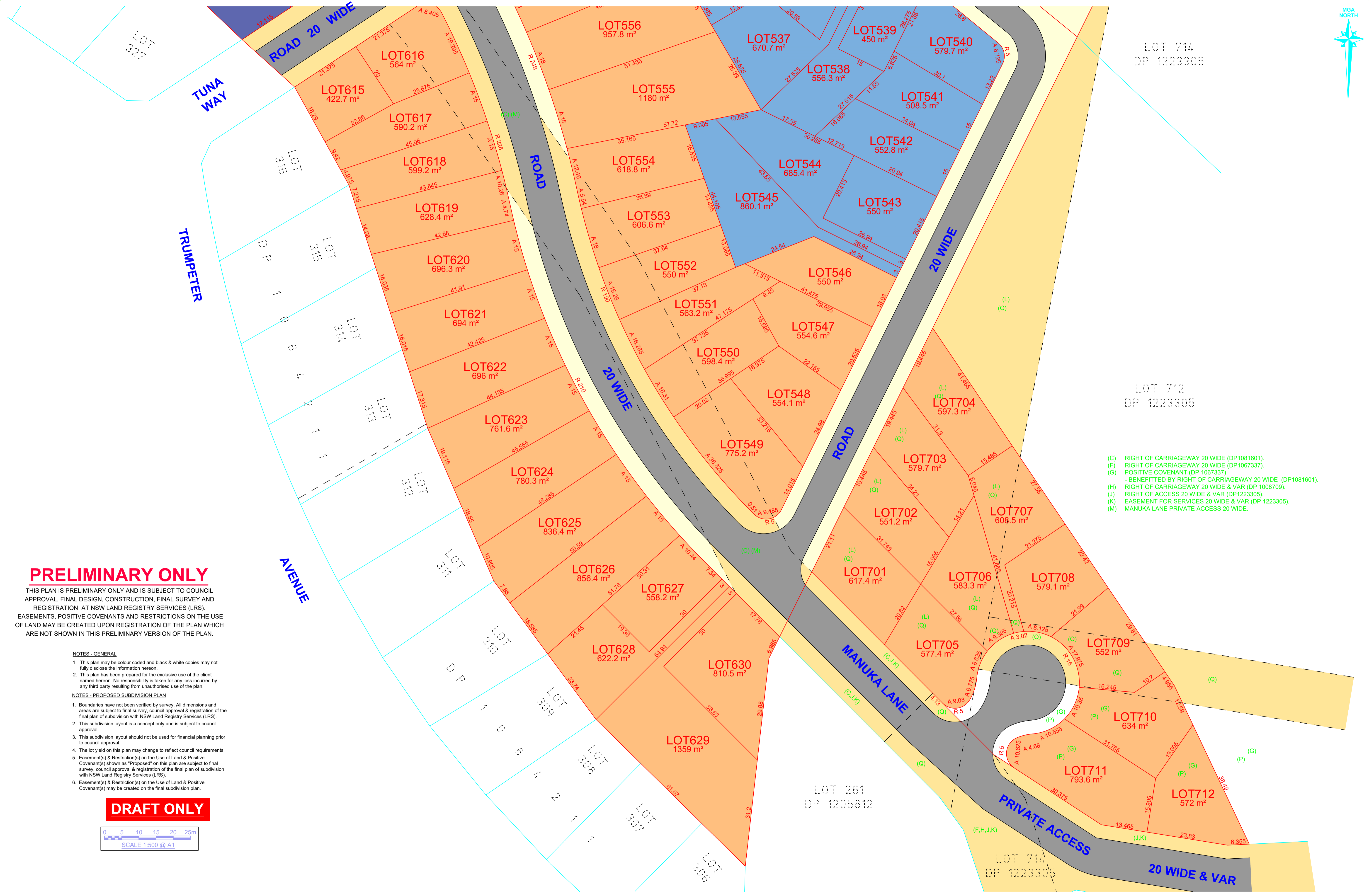

- (C) RIGHT OF CARRIAGEWAY 20 WIDE (DP1081601).
- (F) RIGHT OF CARRIAGEWAY 20 WIDE (DP1067337).
- (G) POSITIVE COVENANT (DP 1067337) - BENEFITTED BY RIGHT OF CARRIAGEWAY 20 WIDE (DP1081601).
- (H) RIGHT OF CARRIAGEWAY 20 WIDE & VAR (DP 1008709).
- (J) RIGHT OF ACCESS 20 WIDE & VAR (DP1223305).
- (K) EASEMENT FOR SERVICES 20 WIDE & VAR (DP 1223305).
- (M) MANUKA LANE PRIVATE ACCESS 20 WIDE.

PRELIMINARY ONLY

THIS PLAN IS PRELIMINARY ONLY AND IS SUBJECT TO COUNCIL APPROVAL, FINAL DESIGN, CONSTRUCTION, FINAL SURVEY AND REGISTRATION AT NSW LAND REGISTRY SERVICES (LRS). EASEMENTS, POSITIVE COVENANTS AND RESTRICTIONS ON THE USE OF LAND MAY BE CREATED UPON REGISTRATION OF THE PLAN WHICH ARE NOT SHOWN IN THIS PRELIMINARY VERSION OF THE PLAN.

NOTES - GENERAL

1. This plan may be colour coded and black & white copies may not fully disclose the information hereon.
2. This plan has been prepared for the exclusive use of the client named hereon. No responsibility is taken for any loss incurred by any third party resulting from unauthorised use of the plan.

NOTES - PROPOSED SUBDIVISION PLAN

1. Boundaries have not been verified by survey. All dimensions and areas are subject to final survey, council approval & registration of the final plan of subdivision with NSW Land Registry Services (LRS).
2. This subdivision layout is a concept only and is subject to council approval.
3. This subdivision layout should not be used for financial planning prior to council approval.
4. The lot yield on this plan may change to reflect council requirements.
5. Easement(s) & Restriction(s) on the Use of Land & Positive Covenant(s) shown as "Proposed" on this plan are subject to final survey, council approval & registration of the final plan of subdivision with NSW Land Registry Services (LRS).
6. Easement(s) & Restriction(s) on the Use of Land & Positive Covenant(s) may be created on the final subdivision plan.

DRAFT ONLY

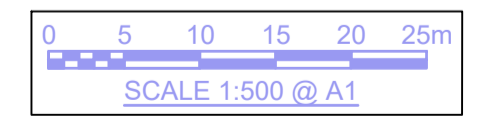

Technical Details:

Azimuth -	MGA
Origin -	
Easting -	
Northing -	

Datum -	
Origin -	
R.L. -	
Contour Int. -	

Surveyed	
Drafted	24/05/2022
Checked	PLM 25/05/2022

Title	
Client	
Site	
Locality	EDEN

**PRELIMINARY CONCEPT PLAN
STAGE 3**
EDEN LAND FUND PTY LTD
LOT 285 DP 1262714 & LOT 711 DP 1223305 - KB TIMMS DRIVE
LGA BEGA VALLEY

Our Ref:	8235 CONCEPT-V6
Original Size	Sheet No.
A1	10 of 10