

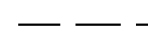

# DRAFT



## DISCLOSURE PLAN

### LEGEND:

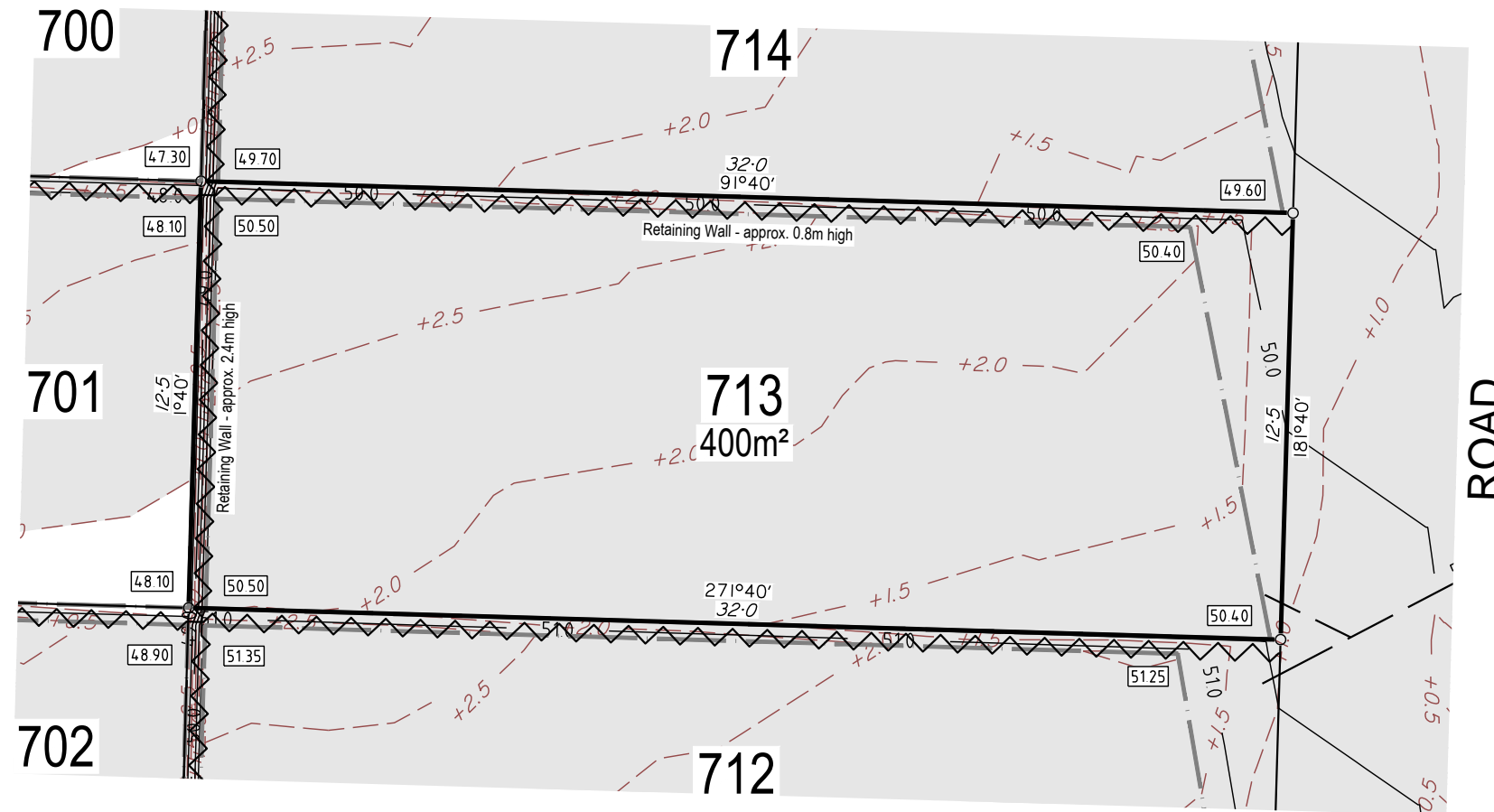
-  Stormwater Line
-  Sewer Line
-  Batter Line
-  Retaining Wall  
(Retaining Wall height defined in the Disclosure Plan is measured as Top of Wall to surface level at Toe of Wall at time of subdivision)

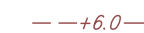
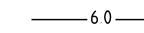

### LEGEND

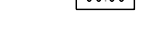
-  +6.0 DESIGN FILL DEPTH CONTOUR (0.5m INTERVAL)
-  6.0 DESIGN F.S.L. SURFACE LEVEL CONTOUR (0.5m INTERVAL)
-  AREA OF FILL
-  DESIGN LEVEL AT LIMIT OF USEABLE BUILDING PAD
-  FOR RETAINING WALL CONSTRUCTION DETAIL SEE ENGINEERING CIVIL O.P.W. PLANS

### Builders Note:

Builders shall not build off the design levels shown; a site survey is required. This note is an integral part of this plan.

### Engineering Note:

Engineering design information supplied by KN Group. May 2021.

### Compaction Statement:

Earthworks fill on the subject allotment will be undertaken and compacted in accordance with the provisions of AS3798-2007 Tables 5.1 and 8.1 under Level 1 supervision



Local Authority : Logan City Council
Height Datum : AHD
Height Origin : PM59068, RL 46.04
Contour Interval : 0.5 m
Fill Contours : P BE CONT FILL RPS
ENG : x21-134base
BDY : 7952-BDY-P4-20210507 (RPS)
Surveyor : RAS
Drawn : PAR
Scale : 1:200 @ A3
Date : 21 May 2021
Dwg No : 7952-DISC-711/713

### Note:

This plan has been prepared by RPS Australia East Pty Ltd (ACN 140 292 762), which is registered with the Surveyors Board of Queensland as a Cadastral Surveyor.