

- LEGEND**
- xw EXISTING WATER MAIN
 - xwr EXISTING RECYCLED WATER MAIN
 - xe EXISTING UNDERGROUND ELECTRICITY
 - xeloh EXISTING OVERHEAD ELEC & POLE
 - x1 EXISTING TELSTRA & SERVICE PIT
 - xof EXISTING OPTIC FIBRE
 - xg EXISTING GAS MAIN
 - xs EXISTING FENCE
 - xs EXISTING SEWER & MANHOLE
 - xsfm EXISTING SEWER RISING MAIN
 - Ex 4500 EXISTING STORMWATER DRAIN & PIT
 - H EXISTING HOUSE DRAIN
 - 168.90 EXISTING SURFACE CONTOUR MINOR
 - 169.00 EXISTING SURFACE CONTOUR MAJOR
 - EF180.915 EXISTING FILL LEVEL
 - EX158.664 EXISTING SIGN AND POST
 - EXISTING PERMANENT SURVEY MARK
 - ROAD RESERVE
 - LOT BOUNDARY
 - EASEMENT
 - SM2 KERB & CHANNEL + TYPE
 - CONCRETE EDGE STRIP
 - 52 ALLOTMENT NUMBER
 - 168.90 FINISHED SURFACE CONTOUR MINOR
 - 169.00 FINISHED SURFACE CONTOUR MAJOR
 - FS158.385 FINISHED SURFACE LEVEL
 - T167.15 TOP/TOE OF BATTER LEVEL
 - W PROPOSED WATER MAIN
 - E PROPOSED ELECTRICITY
 - T PROPOSED TELSTRA
 - OF PROPOSED OPTIC FIBRE CONDUIT
 - G PROPOSED GAS MAIN
 - S PROPOSED SEWER
 - 4500 PROPOSED STORMWATER DRAIN & PIT
 - H PROPOSED HOUSE DRAIN
 - PROPOSED DRAINAGE INLET
 - AUTHORITY DRAIN & PIT
 - PROPOSED FOOTPATH
 - PROPOSED DRIVEWAY
 - GAS & WATER CONDUIT
 - PROPOSED BOLLARD
 - PROPOSED LIGHT & POLE
 - PROPOSED TOP OF BATTER
 - PROPOSED TOE OF BATTER
 - RIDGE / CHANGE OF GRADE
 - EXISTING TREE TO BE RETAINED (SURVEYED CANOPY)
 - PARKING BAY/PAVED AREA
 - EXCAVATION GREATER THAN 300mm
 - FILLING GREATER THAN 300mm
 - CONCRETE PAVEMENT

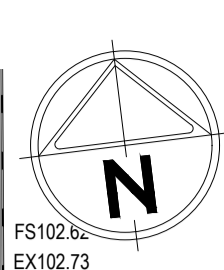

WARNING
 BEWARE OF UNDERGROUND/OVERHEAD SERVICES
 THE LOCATION OF SERVICES ARE APPROXIMATE ONLY AND THEIR EXACT POSITION SHOULD BE PROVEN ON SITE. NO GUARANTEE IS GIVEN THAT ALL EXISTING SERVICES ARE SHOWN. SPECIAL CONSIDERATION SHOULD BE GIVEN TO CONSTRUCTION PROCEDURES UNDER OVERHEAD ELECTRICITY TRANSMISSION LINES.

REV.	AMENDMENTS	APP'D	DATE
C	ISSUED TO CLIENT	M.MILLIER	24.11.2020
B	LOT FALLS AMENDED	M.MILLIER	29.05.2020
A	ISSUED TO CLIENT	M.MILLIER	13.05.2020



PM	M.MILLIER
DESIGNED	26.04.2019
CHECKED	R.SINGH
	01.05.2019
AUTHORISED	M.MILLIER
	03.05.2019
MELBURNS	K.ROGERS
POS No.	355 ES
STATUS	PS838801R

MAJESTY ESTATE
 STAGE 1
 CITY OF MELTON
 FINISHED SURFACE LEVEL PLAN - 1

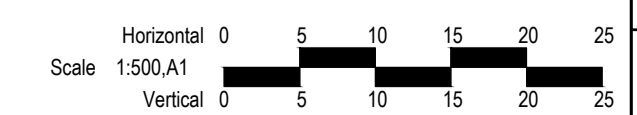

PRELIMINARY 113401FL01 REV. C

© 2019 LD Eng Pty Ltd
 FILE: J1245 - work\p\melb\majesty\stage1\13401_289\PM02 DESIGN\G01 DESIGN\ACAD\113401FL00.dwg LAYOUT: FL-01 PLOTTED BY: Michael Miller PLOT DATE: 24/11/2020 4:38 PM

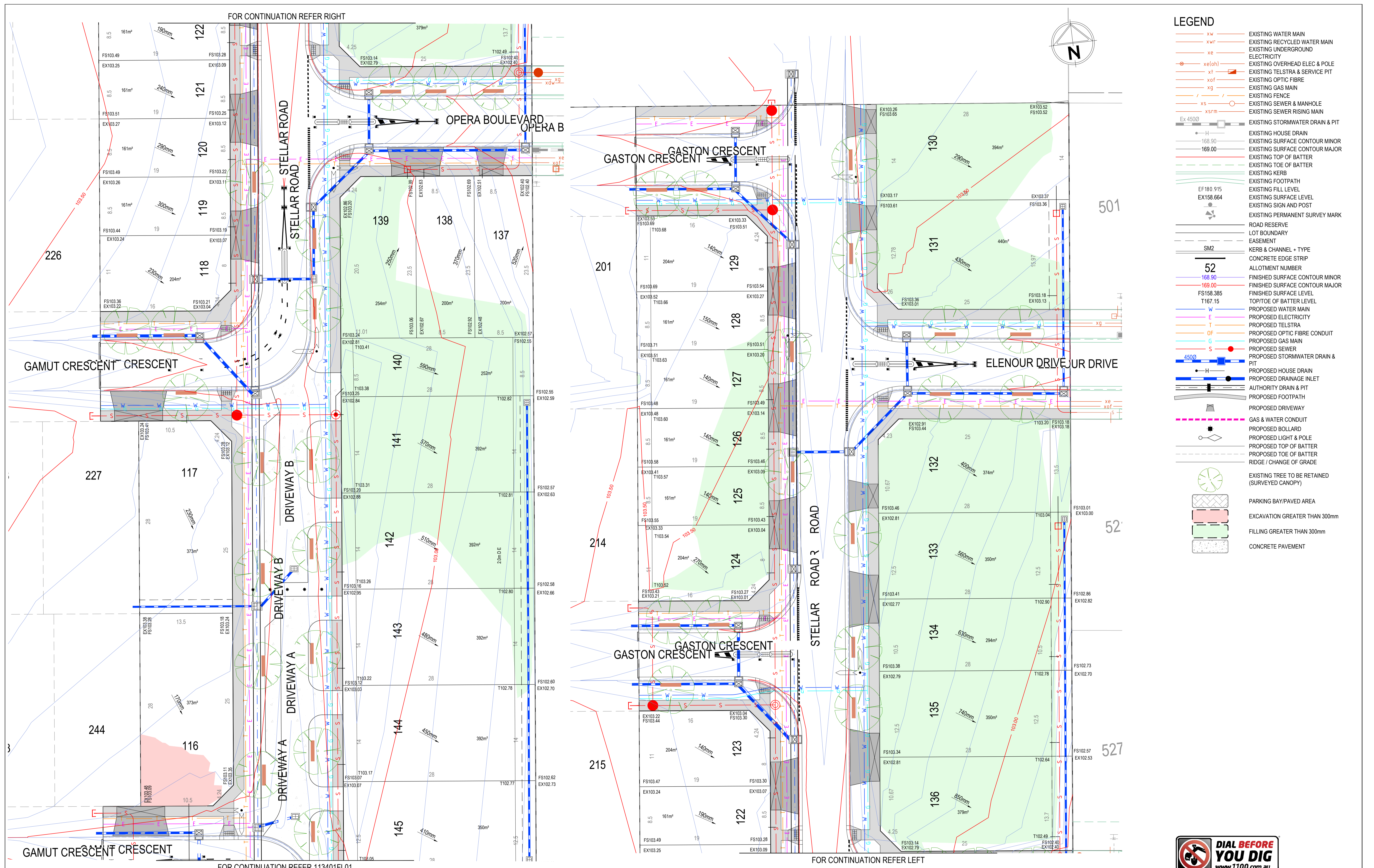

- LEGEND**
- xw EXISTING WATER MAIN
 - xwr EXISTING RECYCLED WATER MAIN
 - xe EXISTING UNDERGROUND ELECTRICITY
 - xeloh EXISTING OVERHEAD ELEC & POLE
 - xt EXISTING TELSTRA & SERVICE PIT
 - xof EXISTING OPTIC FIBRE
 - xg EXISTING GAS MAIN
 - xf EXISTING FENCE
 - xs EXISTING SEWER & MANHOLE
 - xstm EXISTING SEWER RISING MAIN
 - Ex 4500 EXISTING STORMWATER DRAIN & PIT
 - H EXISTING HOUSE DRAIN
 - 168.90 EXISTING SURFACE CONTOUR MINOR
 - 169.00 EXISTING SURFACE CONTOUR MAJOR
 - EXISTING TOP OF BATTER
 - EXISTING TOE OF BATTER
 - EXISTING KERB
 - EXISTING FOOTPATH
 - EF180.915 EXISTING FILL LEVEL
 - EX158.664 EXISTING SURFACE LEVEL
 - EXISTING SIGN AND POST
 - EXISTING PERMANENT SURVEY MARK
 - ROAD RESERVE
 - LOT BOUNDARY
 - EASEMENT
 - SM2 KERB & CHANNEL + TYPE
 - CONCRETE EDGE STRIP
 - 52 ALLOTMENT NUMBER
 - 168.90 FINISHED SURFACE CONTOUR MINOR
 - 169.00 FINISHED SURFACE CONTOUR MAJOR
 - FS158.385 FINISHED SURFACE LEVEL
 - T167.15 TOP/TOE OF BATTER LEVEL
 - W PROPOSED WATER MAIN
 - T PROPOSED TELSTRA
 - OF PROPOSED OPTIC FIBRE CONDUIT
 - G PROPOSED GAS MAIN
 - S PROPOSED SEWER
 - 4500 PROPOSED STORMWATER DRAIN & PIT
 - H PROPOSED HOUSE DRAIN
 - PROPOSED DRAINAGE INLET
 - AUTHORITY DRAIN & PIT
 - PROPOSED FOOTPATH
 - PROPOSED DRIVEWAY
 - GAS & WATER CONDUIT
 - PROPOSED BOLLARD
 - PROPOSED LIGHT & POLE
 - PROPOSED TOP OF BATTER
 - PROPOSED TOE OF BATTER
 - RIDGE / CHANGE OF GRADE
 - EXISTING TREE TO BE RETAINED (SURVEYED CANOPY)
 - PARKING BAY/PAVED AREA
 - EXCAVATION GREATER THAN 300mm
 - FILLING GREATER THAN 300mm
 - CONCRETE PAVEMENT

REV.	AMENDMENTS	APP'D	DATE
C	ISSUED TO CLIENT	M.MILLIER	24.11.2020
B	LOT FALLS AMENDED	M.MILLIER	29.05.2020
A	ISSUED TO CLIENT	M.MILLIER	13.05.2020

WARNING
BEWARE OF UNDERGROUND/OVERHEAD SERVICES
 THE LOCATION OF SERVICES ARE APPROXIMATE ONLY AND THEIR EXACT POSITION SHOULD BE PROVEN ON SITE. NO GUARANTEE IS GIVEN THAT ALL EXISTING SERVICES ARE SHOWN. SPECIAL CONSIDERATION SHOULD BE GIVEN TO CONSTRUCTION PROCEDURES UNDER OVERHEAD ELECTRICITY TRANSMISSION LINES.

REV.	AMENDMENTS	APP'D	DATE
C	ISSUED TO CLIENT	M.MILLIER	24.11.2020
B	LOT FALLS AMENDED	M.MILLIER	29.05.2020
A	ISSUED TO CLIENT	M.MILLIER	13.05.2020

© 2019 L3 Eng Pty Ltd
 FILE: J:\1245 - work\residential\majesty\113401_289\PM02 DESIGN\G01 DESIGN\ACAD\113401FL02.dwg LAYOUT: FL1-02 PLOTTED BY: Michael Miller PLOT DATE: 24/11/2020 4:38 PM

MAJESTY ESTATE
STAGE 1
 CITY OF MELTON
FINISHED SURFACE LEVEL PLAN - 2

PM M.MILLIER
 DESIGNED 26.04.2019
 R.SINGH
 CHECKED 01.05.2019
 M.MILLIER
 AUTHORISED 03.05.2019
 K.ROGERS
 MELB/MS 355 ES
 PDS No: PS838801R
 STATUS:

PRELIMINARY 113401FL02

SHEET No: 2 OF 2
 REV. C

