

Life is best by far in...

Lochinvar Downs

LOCHINVAR DOWNS ESTATE STAGE 4

LOCHINVAR AREA PROPOSED MASTERPLAN EASTERN PRECINCT

- 1 AIRDS OF LOCHINVAR
- 2 ST. PATRICK'S PRIMARY SCHOOL
- 3 LOCHINVAR SPORTING COMPLEX
- 4 ST. JOSEPH'S COLLEGE
- 5 ST. PATRICK'S LOCHINVAR
- 6 HOLY TRINITY ANGLICAN CHURCH
- 7 ST. NICHOLAS EARLY EDUCATION LOCHINVAR
- 8 POLICE STATION
- 9 PROPOSED COMMERCIAL*
- 10 LOCHINVAR HOTEL
- 11 TRUE CAFÉ
- 12 LOCHINVAR POST OFFICE
- 13 LOCHINVAR PUBLIC SCHOOL
- 14 PROPOSED MEDIUM DENSITY RESIDENTIAL*
- 15 PROPOSED ENVIRONMENTAL PROTECTION*
- 16 PROPOSED PUBLIC RECREATION*
- 17 COMMUNITY FACILITIES
- STREET TREES - INDICATIVE ONLY

*Based on Maitland City Council 'Lochinvar Structure Plan' October 2007

We do not guarantee, warrant or represent that the information contained in this material is free from errors or omissions. Any interested parties should make their own enquiries, seek expert advice and review the contract terms.

Map courtesy of Lochinvar.com.au





DIMENSION AND AREAS
SUBJECT TO FINAL SURVEY
AND COUNCIL APPROVAL.
LEVELS SUBJECT TO FINAL
DESIGN AND APPROVAL.

- PROPOSED SEWER
- PROPOSED SEWER ACCESS CHAMBER
- PROPOSED STORMWATER
- PROPOSED STORMWATER PIT



STREET TREES

CONTOUR INTERVAL 0.5m

(A) - EASEMENT TO DRAIN WATER 1.5 WIDE
(AB) - EASEMENT TO DRAIN WATER 2.5 WIDE

STAGE 4

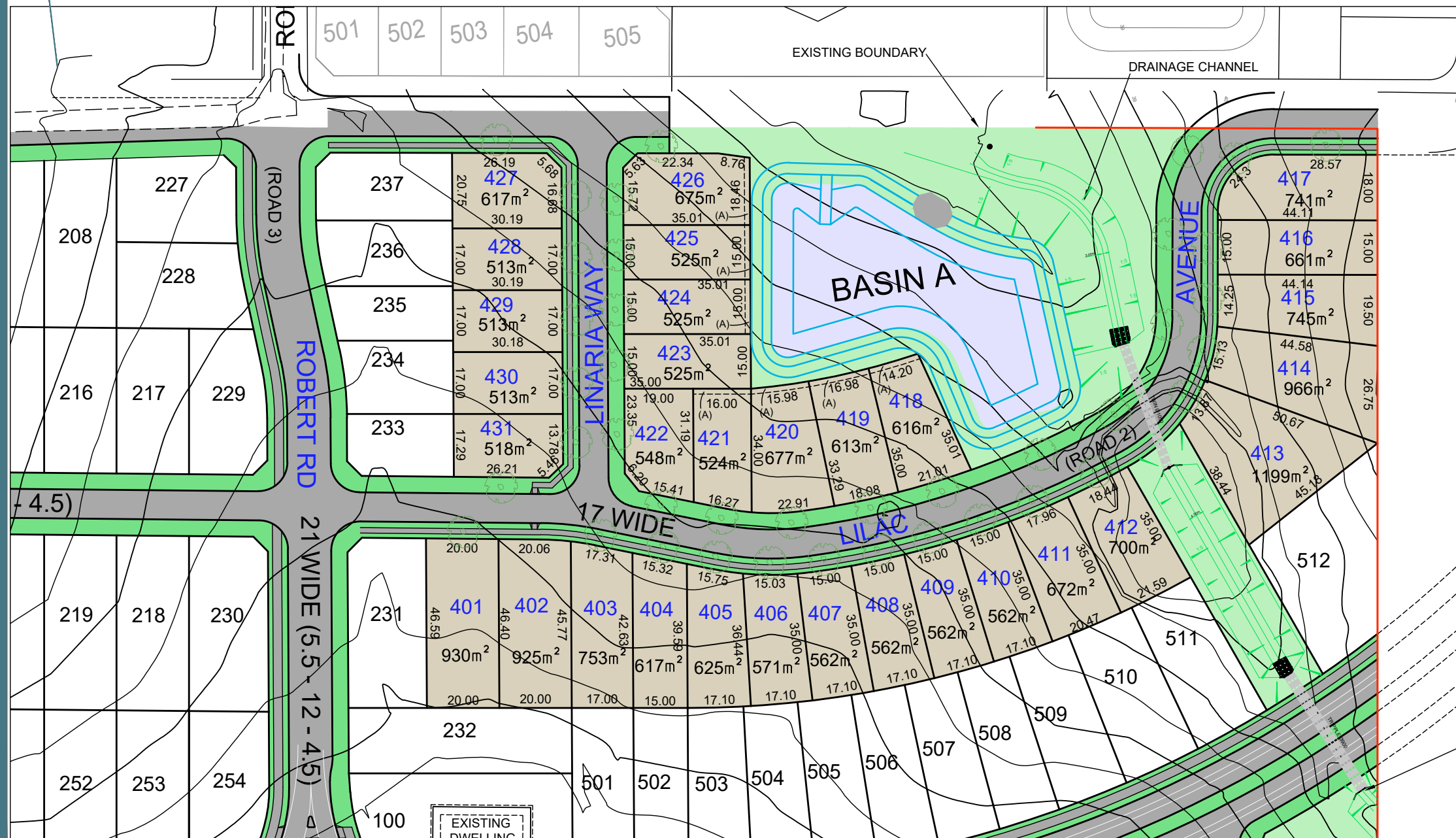

TITLE: PROPOSED SUBDIVISION
STATION LANE AND CHRISTOPHER ROAD
LOCHINVAR

LOCHINVAR DOWNS STAGE 4 SALES PLAN

KEVIN URANE 0412009891

High Definition
Design Pty Ltd

Date:	23.08.21	Scale:	1:1000 A3	Designed:	KU	Project No:	HD176
Cad Ref:	HD176 r15 stage 4 sales					Drawing No:	ST4
						Revision:	1
1	CLIENT ISSUE			KU	23.08.21		
No	Amendment			Drawn	Date		