

Westport



MODERN B

Spacious two storey, 4 bedroom townhome with double lock up garage. Open plan living and kitchen with island bench. Bathroom, ensuite and ground floor WC as well as ample storage space.

AREAS:

| | |
|-----------------------|----------------------------|
| Internal Living: | 130.5 m ² |
| Garage: | 39.4 m ² |
| Covered Outdoor Area: | 9.3 m ² |
| TOTAL | 179.2 m² |

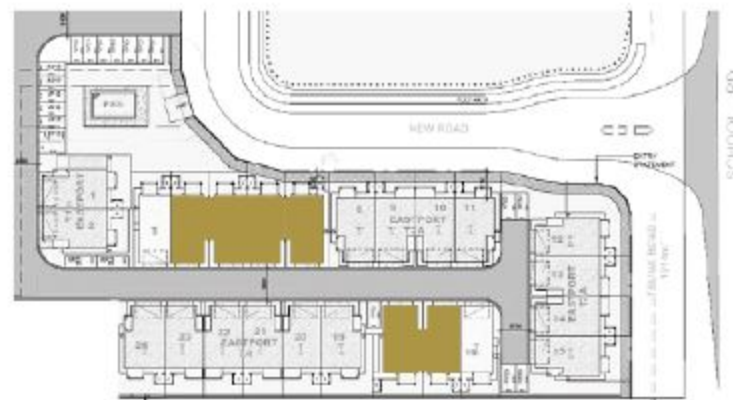

*Standard design shown, actual colours, facade, floor plans and townhome groupings may differ between units. Renders and floorplans are only indicative.