

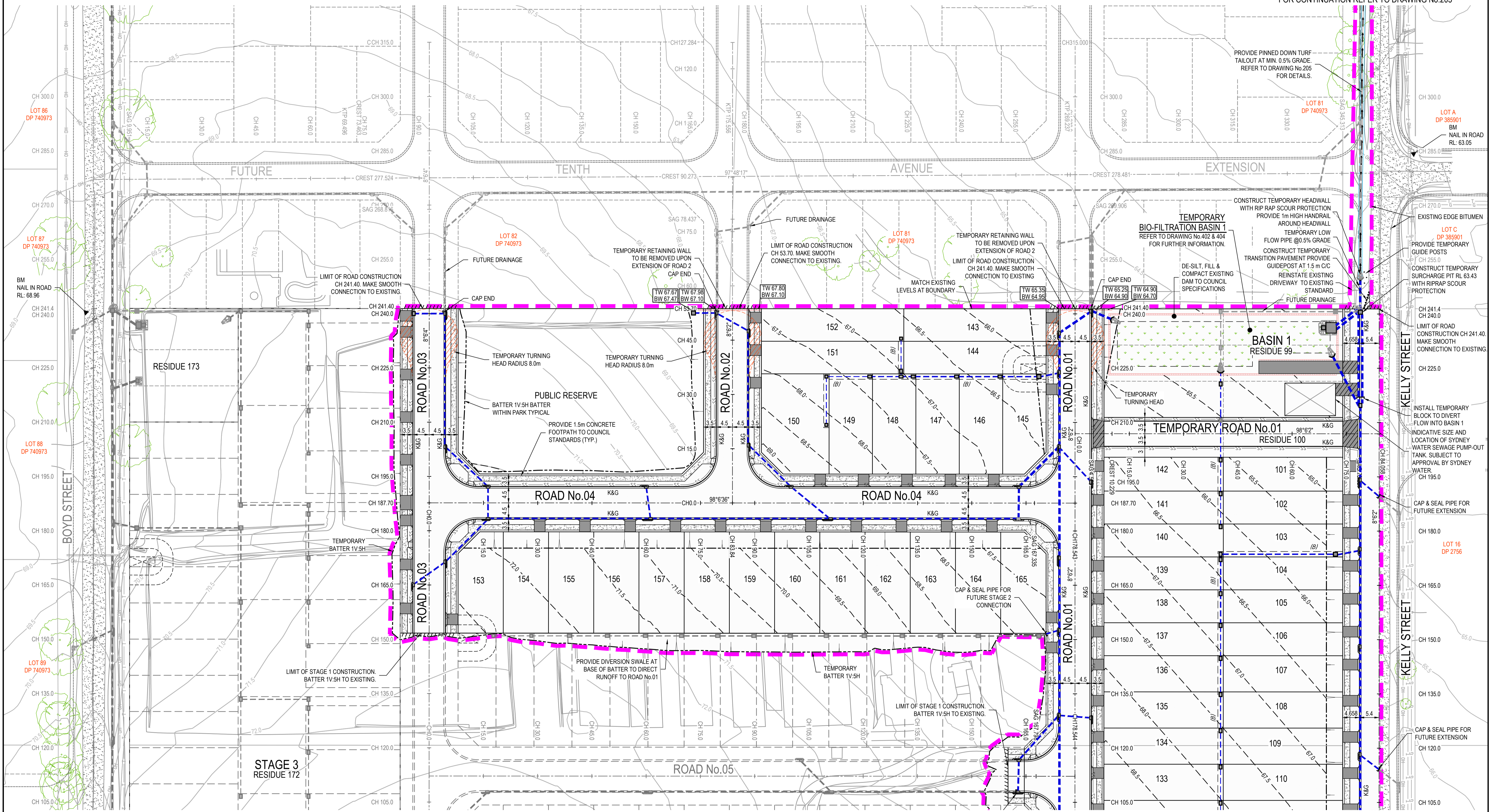

LEGEND

- (B) DENOTES 1.5m WIDE DRAINAGE EASEMENT
- (C) DENOTES 3.0m WIDE DRAINAGE EASEMENT
- FLOW PATH

FOR CONTINUATION REFER TO DRAWING No.205



FOR CONTINUATION REFER TO DRAWING No.202

ISSUED FOR **SECTION 4.55**
NOT FOR CONSTRUCTION

Revision	Issue	Drawn	Design	Appd.	Date	Revision Description
D	MS	JM	-	-	28/01/2020	ISSUED FOR SECTION 4.55
E	MS	JM	-	-	07/04/2020	ISSUED FOR SECTION 4.55
F	MS	JM	-	-	04/06/2020	ISSUED FOR SECTION 4.55
G	MS	JM	-	-	19/06/2020	ISSUED FOR SECTION 4.55
H	MS	JM	-	-	15/09/2020	ISSUED FOR SECTION 4.55
J	MS	JM	-	-	22/09/2020	ISSUED FOR SECTION 4.55
First Issue	CW	CW	PB	-	27/11/2017	

Disclaimer and Copyright:
 ALL DIMENSIONS TO BE CHECKED ON SITE BY THE CONTRACTOR PRIOR TO CONSTRUCTION.
 USE WRITTEN DIMENSIONS ONLY. DO NOT SCALE.
 THESE DRAWINGS, PLANS, AND SPECIFICATIONS AND THE COPYRIGHT ARE THE PROPERTY OF ORION CONSULTING ENGINEERS PTY LTD AND MUST NOT BE REPRODUCED OR COPIED WHOLLY OR IN PART WITHOUT THE PERMISSION OF ORION CONSULTING ENGINEERS PTY LTD

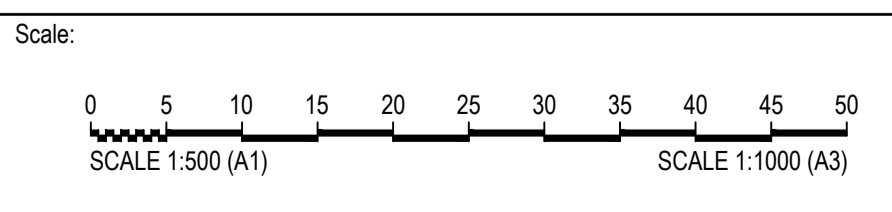

Project: 13 -19 KELLY STREET, AUSTRAL

Title: ENGINEERING PLAN
 STAGE 1 - SHEET 1 OF 2

Project No. 17-78
 Milestone S4.55
 Plan 201
 Revision J



LEGEND	
(B)	DENOTES 1.5m WIDE DRAINAGE EASEMENT
(C)	DENOTES 3.0m WIDE DRAINAGE EASEMENT
	FLOW PATH

FOR CONTINUATION REFER TO DRAWING No.201

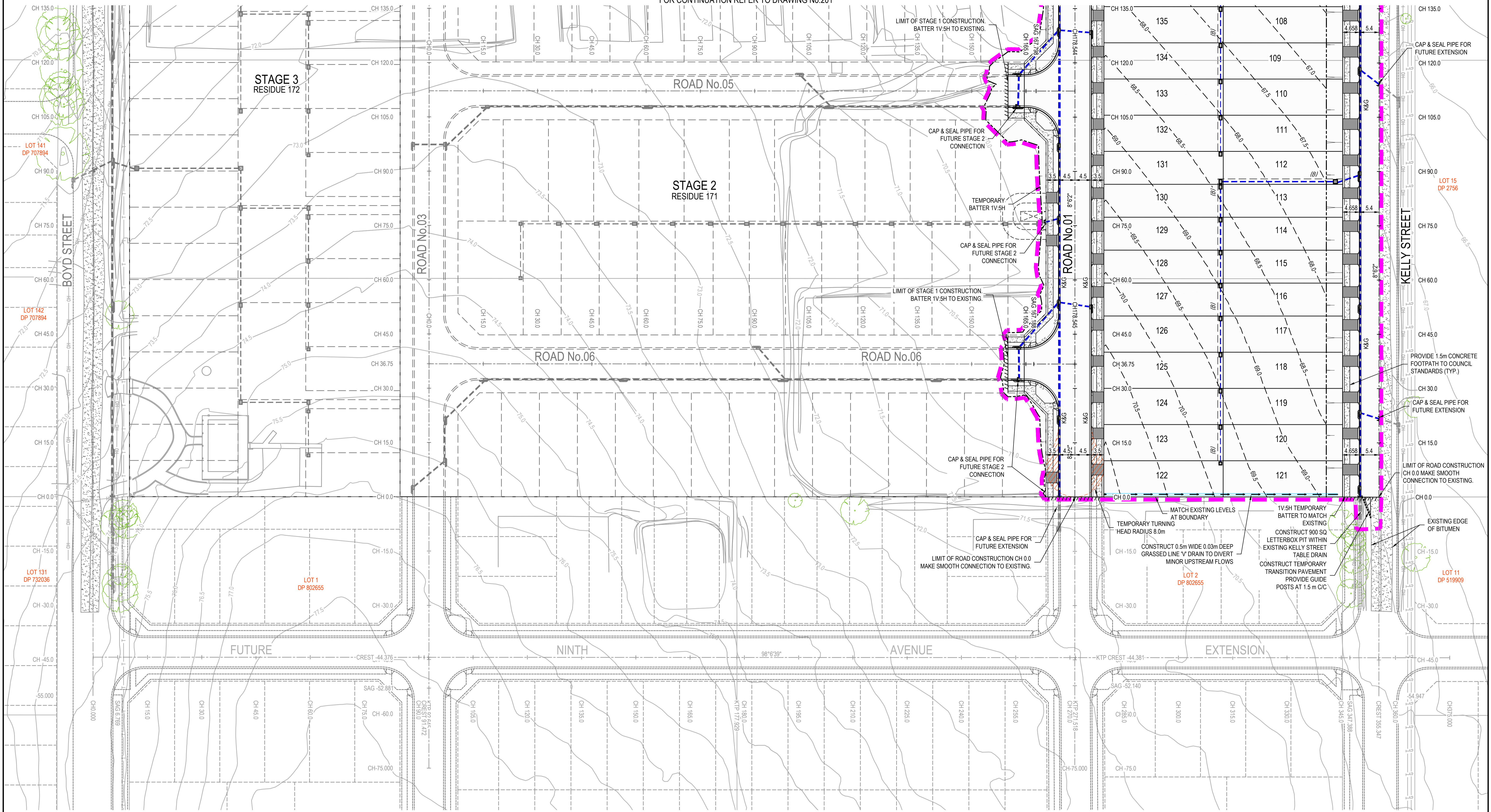

ISSUED FOR **SECTION 4.55**
NOT FOR CONSTRUCTION

Revision	Drawn	Design	Appd.	Date	Revision Description
D	MS	JM	-	28/01/2020	ISSUED FOR SECTION 4.55
E	MS	JM	-	07/04/2020	ISSUED FOR SECTION 4.55
F	MS	JM	-	04/06/2020	ISSUED FOR SECTION 4.55
G	MS	JM	-	19/06/2020	ISSUED FOR SECTION 4.55
H	MS	JM	-	15/09/2020	ISSUED FOR SECTION 4.55
J	MS	JM	-	22/09/2020	ISSUED FOR SECTION 4.55
First Issue	CW	CW	PB	27/11/2017	

Disclaimer and Copyright:
ALL DIMENSIONS TO BE CHECKED ON SITE BY THE CONTRACTOR PRIOR TO CONSTRUCTION. USE WRITTEN DIMENSIONS ONLY. DO NOT SCALE. THESE DRAWINGS, PLANS, AND SPECIFICATIONS AND THE COPYRIGHT ARE THE PROPERTY OF ORION CONSULTING ENGINEERS PTY LTD AND MUST NOT BE REPRODUCED OR COPIED WHOLLY OR IN PART WITHOUT THE PERMISSION OF ORION CONSULTING ENGINEERS PTY LTD

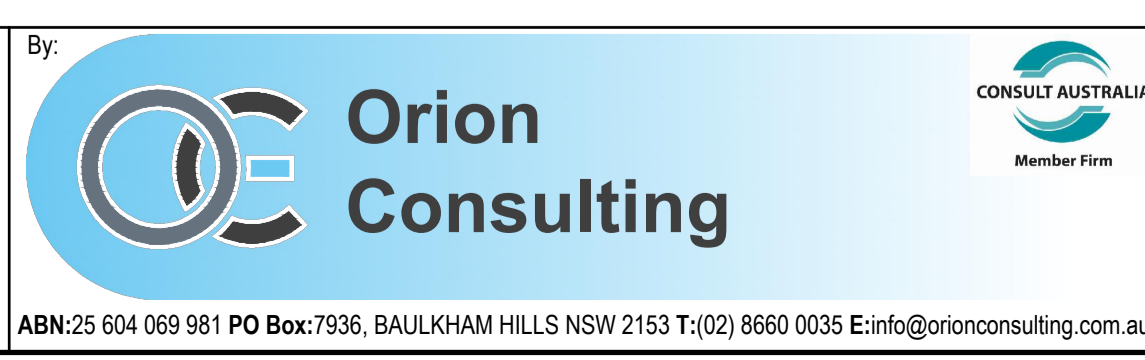
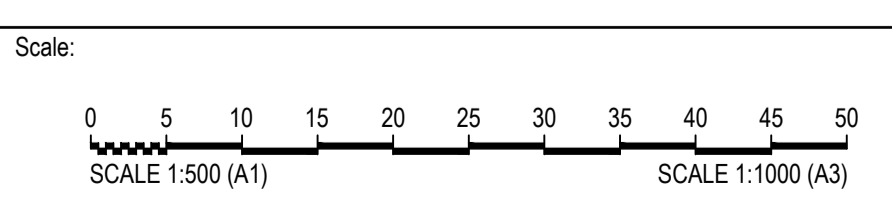

Project: 13 -19 KELLY STREET, AUSTRAL

Title: ENGINEERING PLAN STAGE 1 - SHEET 2 OF 2

Project No. 17-78
Milestone S4.55
Plan 202
Revision J



LEGEND

- (B) DENOTES 1.5m WIDE DRAINAGE EASEMENT
- (C) DENOTES 3.0m WIDE DRAINAGE EASEMENT
- FLOW PATH

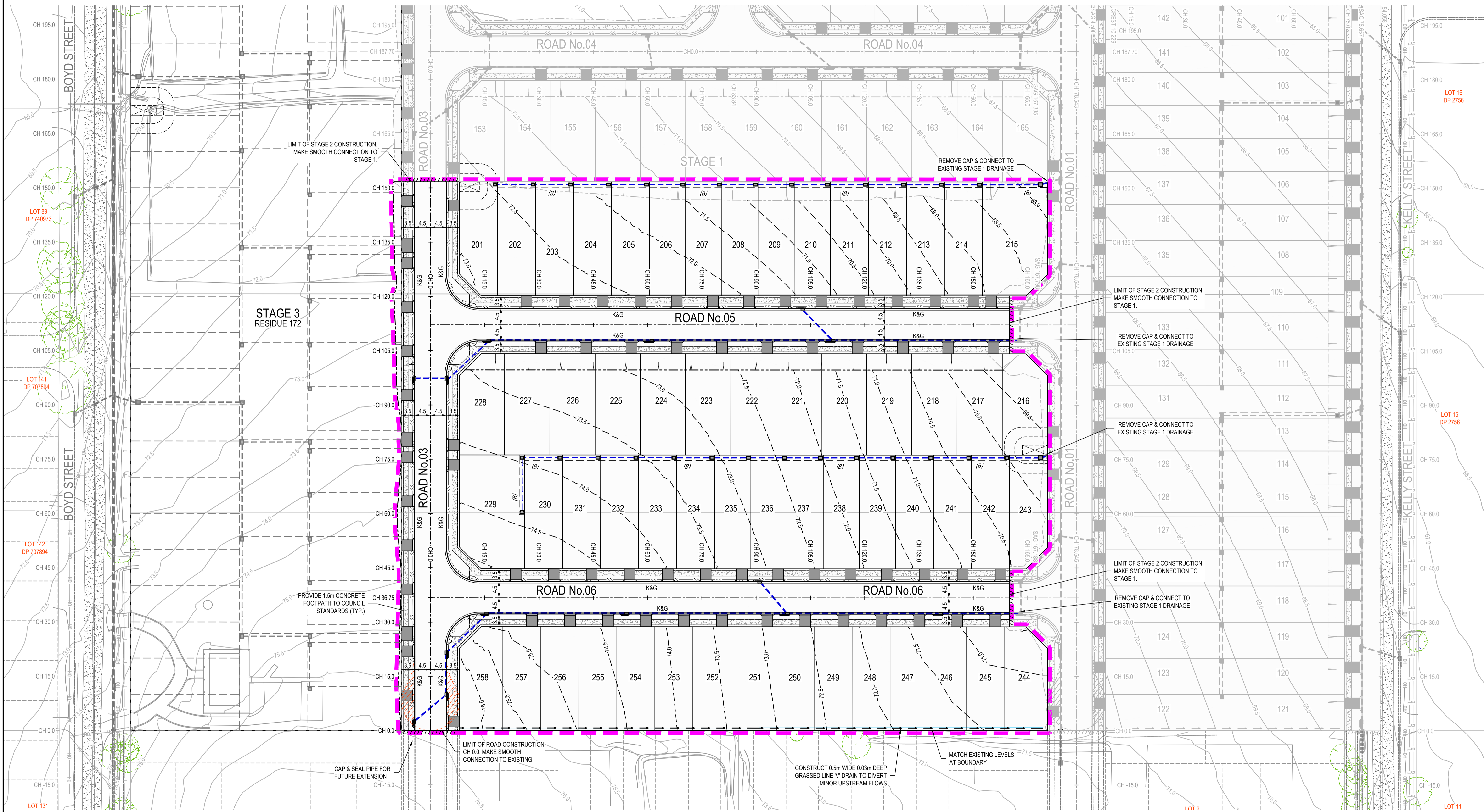

ISSUED FOR SECTION 4.55
NOT FOR CONSTRUCTION

Revision	Issue	Design	Appd.	Date	Revision Description
D	MS	JM	-	28/01/2020	ISSUED FOR SECTION 4.55
E	MS	JM	-	07/04/2020	ISSUED FOR SECTION 4.55
F	MS	JM	-	04/06/2020	ISSUED FOR SECTION 4.55
G	MS	JM	-	19/06/2020	ISSUED FOR SECTION 4.55
H	MS	JM	-	15/09/2020	ISSUED FOR SECTION 4.55
J	MS	JM	-	22/09/2020	ISSUED FOR SECTION 4.55
First Issue	CW	CW	PB	27/11/2017	

Disclaimer and Copyright:
ALL DIMENSIONS TO BE CHECKED ON SITE BY THE CONTRACTOR PRIOR TO CONSTRUCTION. USE WRITTEN DIMENSIONS ONLY. DO NOT SCALE. THESE DRAWINGS, PLANS, AND SPECIFICATIONS AND THE COPYRIGHT ARE THE PROPERTY OF ORION CONSULTING ENGINEERS PTY LTD AND MUST NOT BE REPRODUCED OR COPIED WHOLLY OR IN PART WITHOUT THE PERMISSION OF ORION CONSULTING ENGINEERS PTY LTD

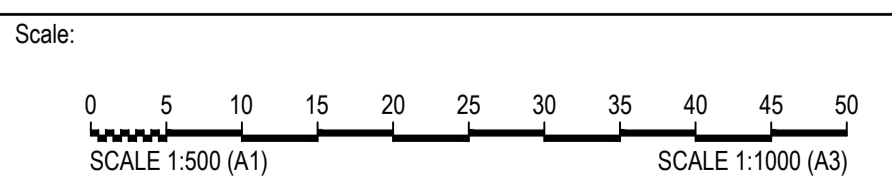

For: **CROWNLAND DEVELOPMENTS**

By: **Orion Consulting**
ABN:25 604 069 981 PO Box:7936, BAULKHAM HILLS NSW 2153 T:(02) 8660 0035 E:info@orionconsulting.com.au

Project: **13 -19 KELLY STREET, AUSTRAL**

Title: **ENGINEERING PLAN STAGE 2**

Project No. 17-78
Milestone S4.55
Plan 203
Revision J



LEGEND

- (B) DENOTES 1.5m WIDE DRAINAGE EASEMENT
- (C) DENOTES 3.0m WIDE DRAINAGE EASEMENT
- FLOW PATH

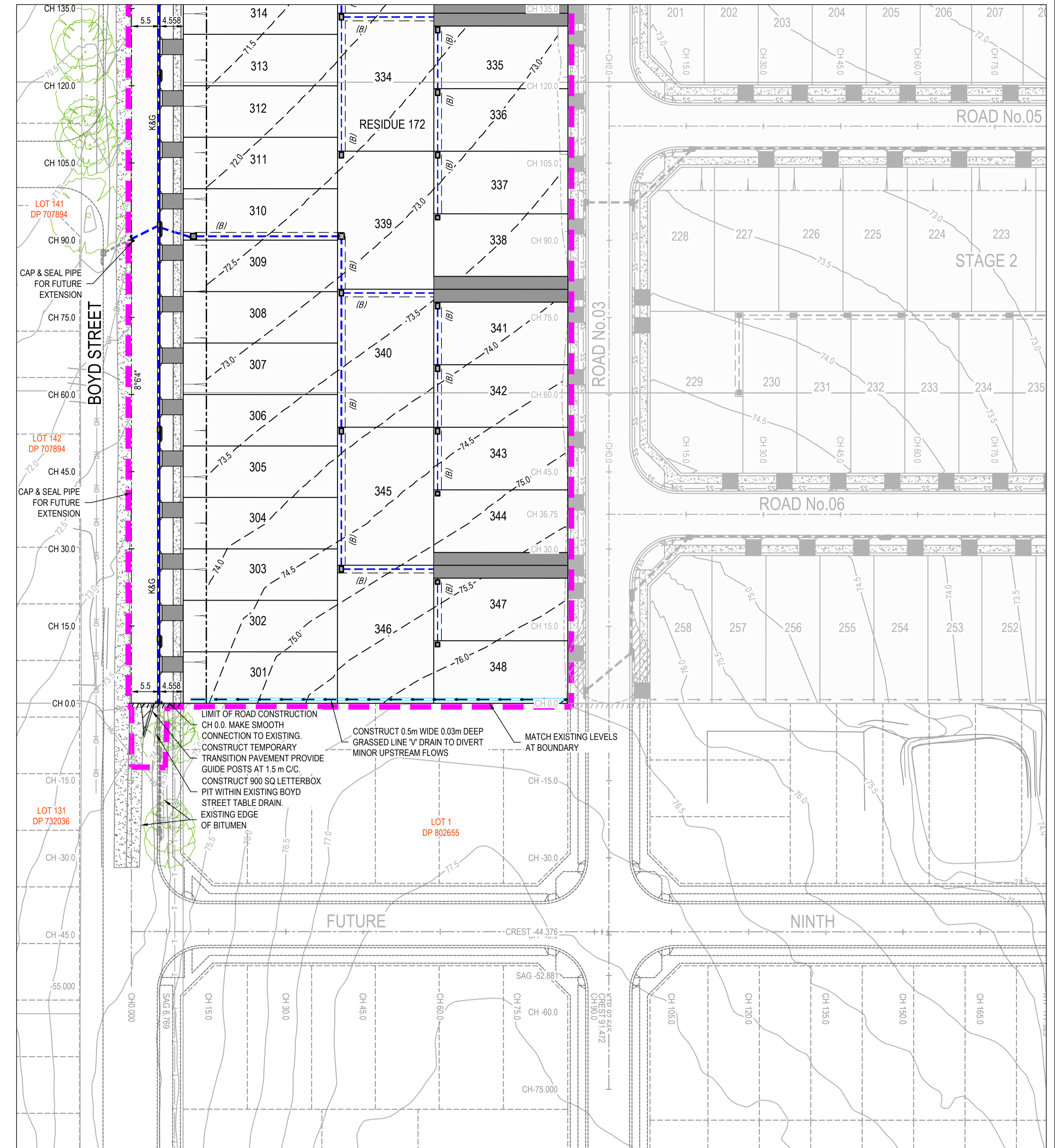
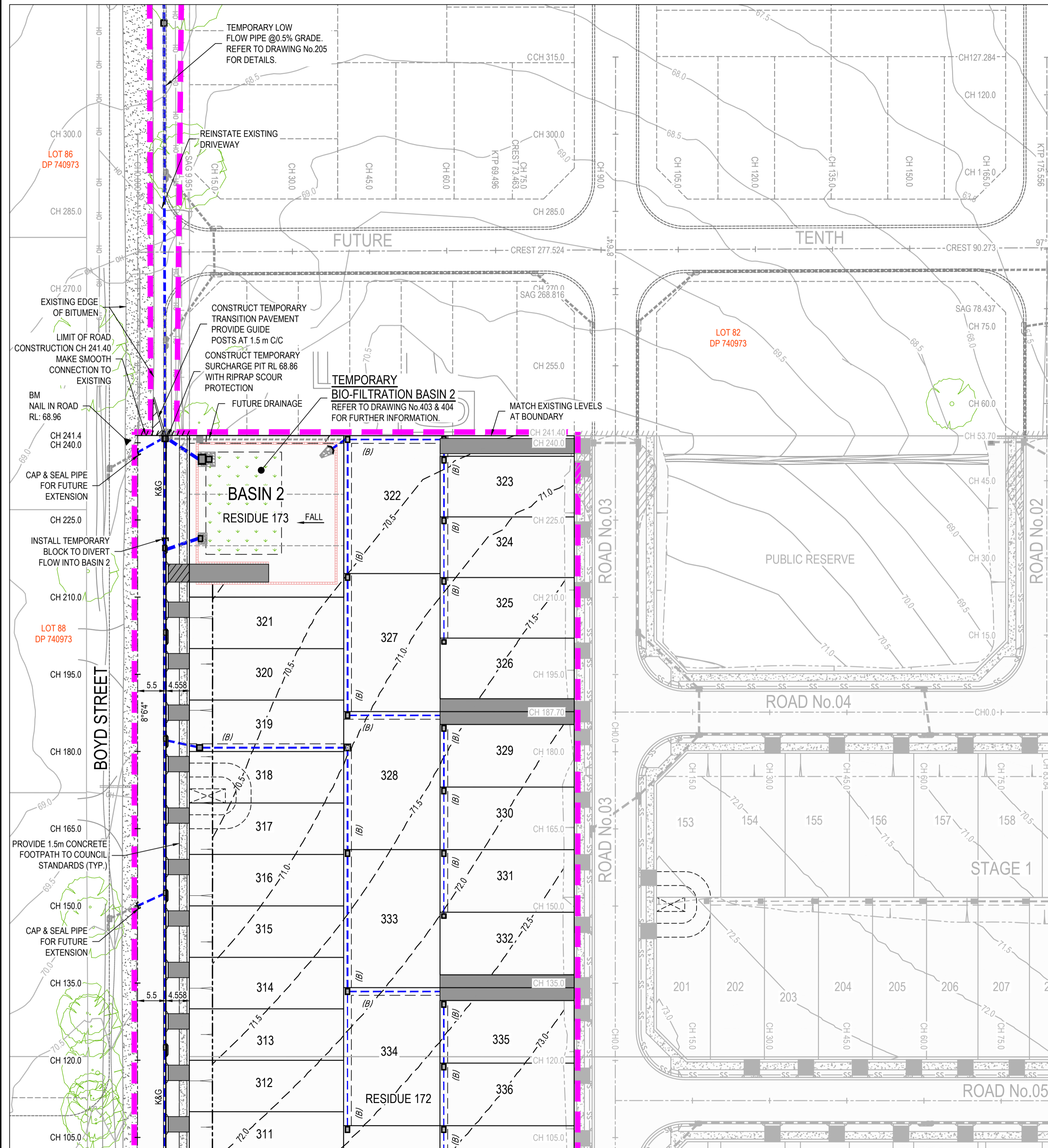

ISSUED FOR **SECTION 4.55**
NOT FOR CONSTRUCTION

Revision	Drawn	Design	Appd.	Date	Revision Description
D	MS	JM	-	28/01/2020	ISSUED FOR SECTION 4.55
E	MS	JM	-	07/04/2020	ISSUED FOR SECTION 4.55
F	MS	JM	-	04/06/2020	ISSUED FOR SECTION 4.55
G	MS	JM	-	19/06/2020	ISSUED FOR SECTION 4.55
H	MS	JM	-	15/09/2020	ISSUED FOR SECTION 4.55
J	MS	JM	-	22/09/2020	ISSUED FOR SECTION 4.55
First Issue	CW	CW	PB	27/11/2017	

Disclaimer and Copyright:
ALL DIMENSIONS TO BE CHECKED ON SITE BY THE CONTRACTOR PRIOR TO CONSTRUCTION. USE WRITTEN DIMENSIONS ONLY. DO NOT SCALE. THESE DRAWINGS, PLANS, AND SPECIFICATIONS AND THE COPYRIGHT ARE THE PROPERTY OF ORION CONSULTING ENGINEERS PTY LTD AND MUST NOT BE REPRODUCED OR COPIED WHOLLY OR IN PART WITHOUT THE PERMISSION OF ORION CONSULTING ENGINEERS PTY LTD

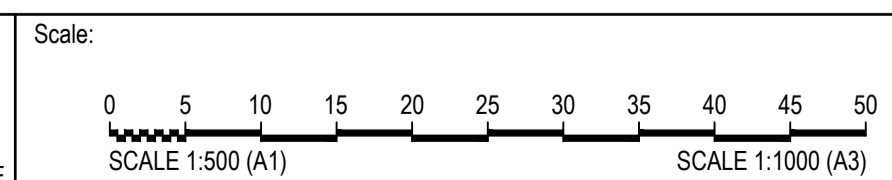

By: **Orion Consulting**
Member Firm
CONSULT AUSTRALIA
ABN:25 604 069 981 PO Box:7936, BAULKHAM HILLS NSW 2153 T:(02) 8660 0035 E:info@orionconsulting.com.au

Project: 13 -19 KELLY STREET, AUSTRAL

Title: ENGINEERING PLAN STAGE 3

Project No. 17-78
Milestone S4.55
Plan 204
Revision J