

© Mott MacDonald

This document should not be relied on or used in circumstances other than those for which it was originally prepared and for which Mott MacDonald was commissioned. Mott MacDonald accepts no responsibility for this document to any other party other than the person by whom it was commissioned.

Rev	Date	Drawn	Description	Ch'kd	App'd
A	19.07.2019	GAP	Issued for Review	DR	AC

0 12.5m 25m



M
MOTT
MACDONALD

Level 10, 383 Kent Street
Sydney, NSW 2000
Australia
PO Box Q1678, QVB Sydney
NSW 1230, Australia
T +61 (0)2 9098 6800
www.mottmac.com

Client

Crownland Leppington
Pty Ltd

CROWNLAND
DEVELOPMENTS

Title

Proposed Subdivision
1432 Camden Valley Way
Civil Works
Siteworks Grading Plan
Sheet 1

Designed

D Reilly

Drawn

GA Paciben

Dwg check

A Singh

Scale at A1

1:250

Drawing Number

385483-MMD-CC-XX-DR-C-1160

Status

APR

Rev

A

Sec

STD

Eng check

J Wukowic

Coordination

P Hosi

Approved

A Cameron

Issued for CC

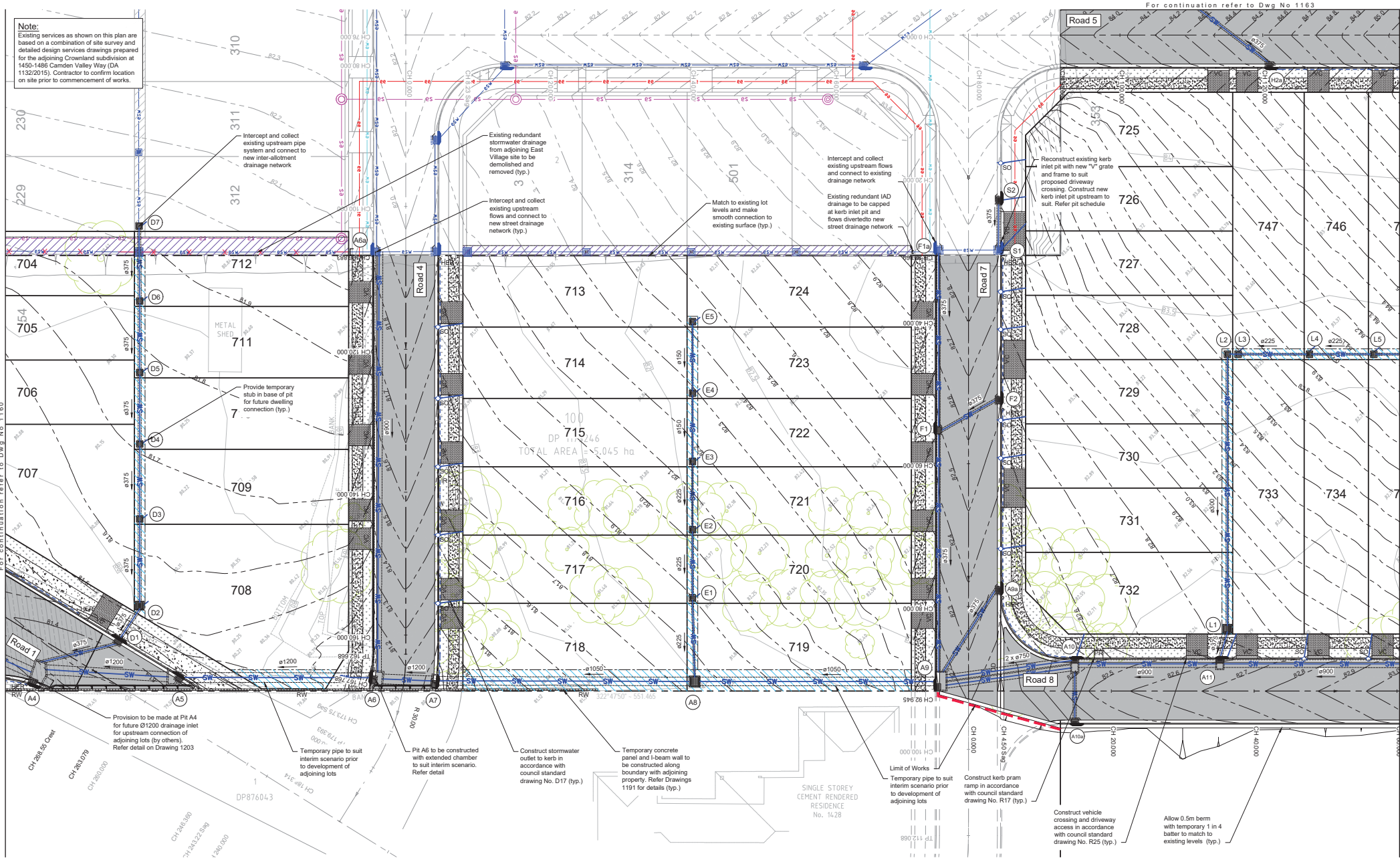

© Mott MacDonald
This document should not be relied on or used in circumstances other than those for which it was originally prepared and for which Mott MacDonald was commissioned. Mott MacDonald accepts no responsibility for this document to any other party other than the person by whom it was commissioned.

Rev	Date	Drawn	Description	Ch'kd	App'd
A	19.07.2019	GAP	Issued for Review	DR	AC



M
MOTT
MACDONALD

Level 10, 383 Kent Street
Sydney, NSW 2000
Australia
PO Box Q1678, QVB Syd
NSW 1230, Australia
T +61 (0)2 9098 6800
www.mottmac.com

Client
Crownland Leppington
Pty Ltd



Title
Proposed Subdivision
1432 Camden Valley Way
Civil Works
Siteworks Grading Plan
Sheet 2

Designed	D Reilly	Eng check	J Wukowic
Drawn	GA Paciben	Coordination	P Hosi
Dwg check	A Singh	Approved	A Cameron
Scale at A1	1:250	Status	APR
Rev	A	Sec	STD
Drawing Number 385483-MMD-CC-XX-DR-C-1161			

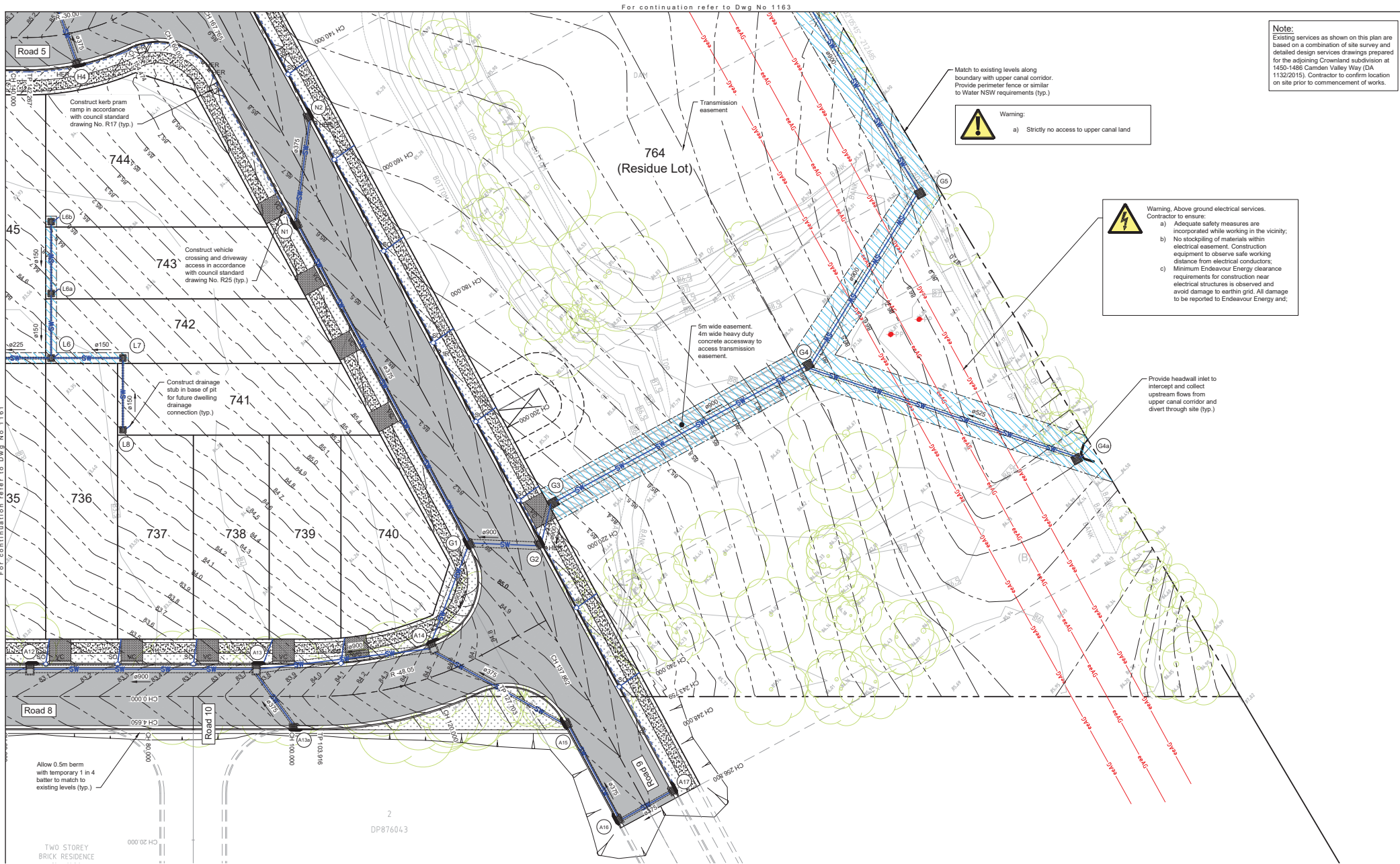

Note:
Existing services as shown on this plan are based on a combination of site survey and detailed design services drawings prepared for the adjoining Crownland subdivision at 1450-1486 Camden Valley Way (DA 1132/2015). Contractor to confirm location on site prior to commencement of works.

Warning:
a) Strictly no access to upper canal land

Warning. Above ground electrical services.
Contractor to ensure:
a) Adequate safety measures are incorporated while working in the vicinity;
b) No stockpiling of materials within electrical easement. Construction equipment to observe safe working distance from electrical conductors;
c) Minimum Endeavour Energy clearance requirements for construction near electrical structures is observed and avoid damage to earthen grid. All damage to be reported to Endeavour Energy and;

Provide headwall inlet to intercept and collect upstream flows from upper canal corridor and divert through site (typ.)

5m wide easement. 4m wide heavy duty concrete accessway to access transmission easement.

Match to existing levels along boundary with upper canal corridor. Provide perimeter fence or similar to Water NSW requirements (typ.)

764 (Residue Lot)

743

742

741

736

737

738

739

740

Road 8

Road 10

Allow 0.5m berm with temporary 1 in 4 batter to match to existing levels (typ.)

TWO STOREY BRICK RESIDENCE

© Mott MacDonald
This document should not be relied on or used in circumstances other than those for which it was originally prepared and for which Mott MacDonald was commissioned. Mott MacDonald accepts no responsibility for this document to any other party other than the person by whom it was commissioned.

0 12.5m 25m				
1:250				
A	19.07.2019	GAP	Issued for Review	DR AC
Rev	Date	Drawn	Description	Ch'kd App'd



Level 10, 383 Kent Street
Sydney, NSW 2000
Australia
PO Box Q1678, QVB Sydney
NSW 1230, Australia
T +61 (0)2 9098 6800
www.mottmac.com

Client
Crownland Leppington Pty Ltd

CROWNLAND DEVELOPMENTS

Title
**Proposed Subdivision
1432 Camden Valley Way
Civil Works
Siteworks Grading Plan
Sheet 3**

Designed	D Reilly	Eng check	J Wukowic
Drawn	GA Paciben	Coordination	P Hosi
Dwg check	A Singh	Approved	A Cameron
Scale at A1	Status	Rev	Sec
1:250	APR	A	STD
Drawing Number 385483-MMD-CC-XX-DR-C-1162			

Issued for CC

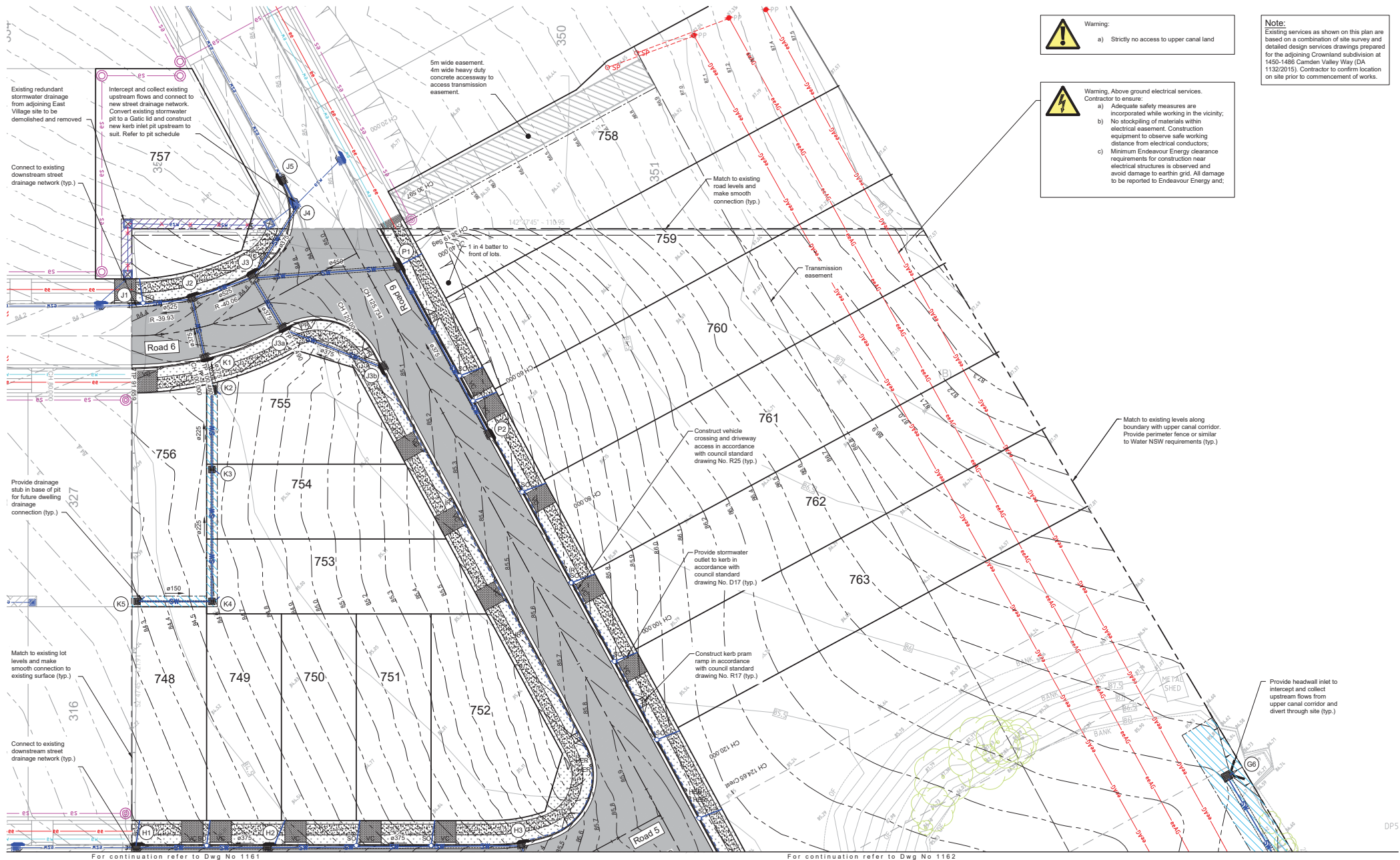

© Mott MacDonald
This document should not be relied on or used in circumstances other than those for which it was originally prepared and for which Mott MacDonald was commissioned. Mott MacDonald accepts no responsibility for this document to any other party other than the person by whom it was commissioned.

Rev	Date	Drawn	Description	Ch'kd	App'd
A	19.07.2019	GAP	Issued for Review	DR	AC

0 12.5m 25m



M
MOTT
MACDONALD

Level 10, 383 Kent Street
Sydney, NSW 2000
Australia
PO Box Q1678, QVB Sydney
NSW 1230, Australia
T +61 (0)2 9098 8800
www.mottmac.com

Client
**Crownland Leppington
Pty Ltd**

CROWNLAND
DEVELOPMENTS

Title
**Proposed Subdivision
1432 Camden Valley Way
Civil Works
Siteworks Grading Plan
Sheet 4**

Designed	D Reilly	Eng check	J Wukowic
Drawn	GA Paciben	Coordination	P Hoast
Dwg check	A Singh	Approved	A Cameron
Scale at A1	1:250	Status	APR
Drawing Number	385483-MMD-CC-XX-DR-C-1163	Rev	A
		Sec	STD