

(A) - EASEMENT FOR ACCESS 0.9 WIDE

**NOTE:**  
 - THIS PLAN IS NOT A PLAN OF SURVEY AND NO BOUNDARIES HAVE BEEN SURVEYED OR MARKED.  
 - THE RELATIONSHIP OF IMPROVEMENTS TO BOUNDARIES ARE DIAGRAMMATIC ONLY AND SHOULD BE CONFIRMED BY FURTHER SURVEY.  
 - DISTANCES AND AREAS ARE BY TITLE &/OR DEED ONLY AND ARE SUBJECT TO FINAL SURVEY AND COUNCIL APPROVAL.  
 - ONLY VISIBLE SERVICES HAVE BEEN LOCATED. IF ANY WORKS ARE PROPOSED THE SERVICE AUTHORITIES SHOULD BE CONTACTED.  
 - THIS SUBDIVISION LAYOUT IS A CONCEPT ONLY. EASEMENTS AND RESTRICTIONS MAY BE CREATED ON THE FINAL SUBDIVISION PLAN WHICH IS SUBJECT TO COUNCIL APPROVAL AND REGISTRATION.  
 - THIS SUBDIVISION LAYOUT SHOULD NOT BE USED FOR FINANCIAL PLANNING PRIOR TO COUNCIL APPROVAL.  
 - THIS DRAWING IS SUBJECT TO COPYRIGHT. IT MUST NOT BE REPRODUCED IN WHOLE OR PART WITHOUT PRIOR WRITTEN CONSENT OF NORTH WESTERN SURVEYS Pty. Ltd.  
 - THE TITLE BLOCK AND THESE NOTES FORM AN INTEGRAL PART OF THIS PLAN AND SHOULD NOT BE REMOVED WITHOUT CONSENT OF NORTH WESTERN SURVEYS Pty.Ltd.

SIXTH AVENUE

ROAD 1 - 16m WIDE

ROAD 2 - 16m WIDE

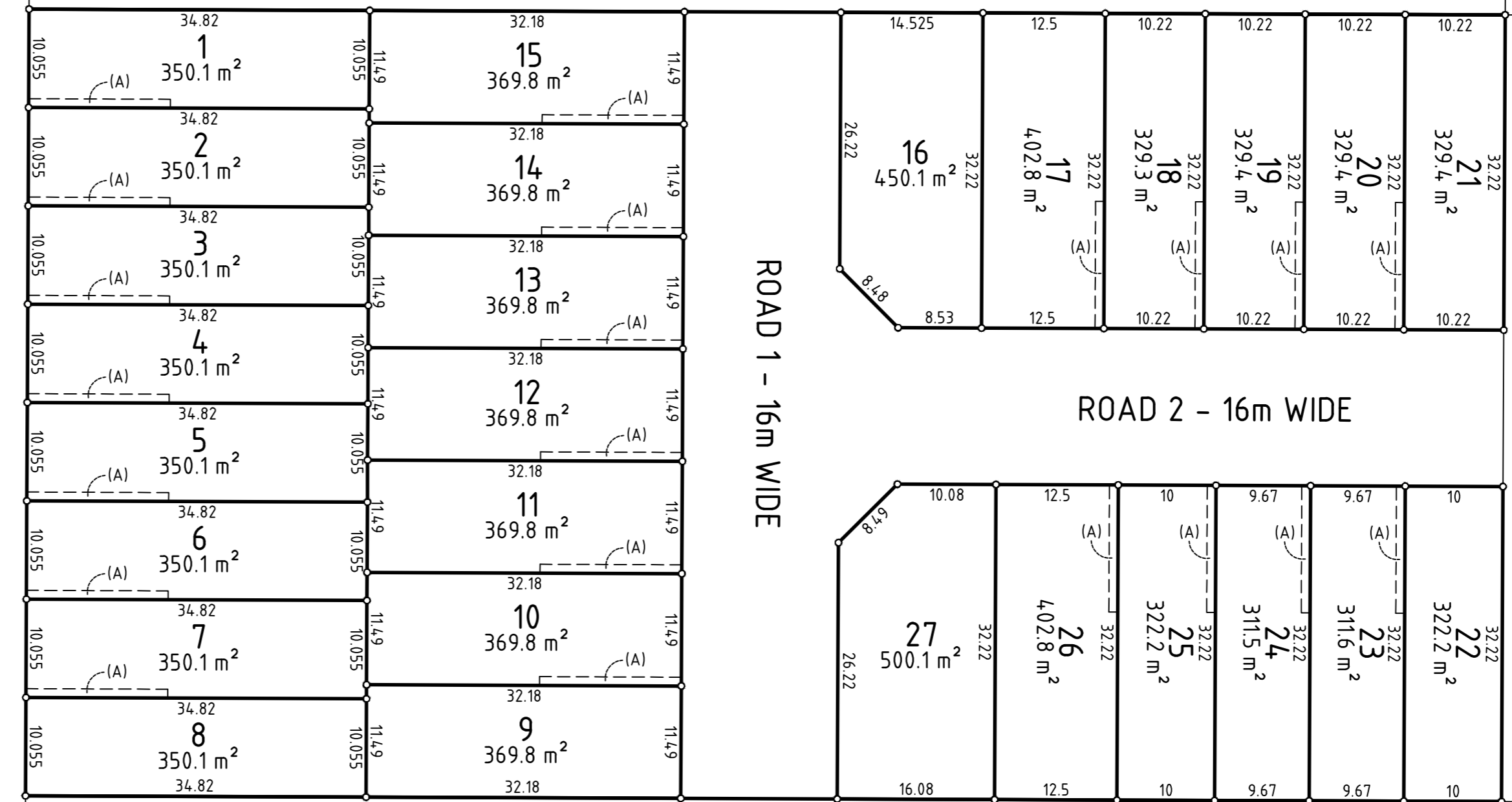

REV.	DESCRIPTION	DATE	APPR.
00	ORIGINAL ISSUE	10/08/2017	

**North Western Surveys**  
 Surveyors, Engineers & Water Servicing Coordinators  
 1/11 Romford Road, P.O. Box 1045, Blacktown N.S.W. 2148  
 Phone: 9831-2040 Fax: 9622-5716 Email: nws@nwsurveys.com.au

THIS DRAWING IS SUBJECT TO COPYRIGHT. IT MUST NOT BE REPRODUCED IN WHOLE OR PART WITHOUT PRIOR WRITTEN CONSENT OF NORTH WESTERN SURVEYS Pty. Ltd.

SURVEYED: G.C.	GRID: M.G.A.	DATUM: A.H.D.	TITLE PLAN OF PROPOSED SUBDIVISION FOR LOT 1037 IN DP 2475 AT SIXTH AVENUE, AUSTRAL L.G.A. LIVERPOOL				SHEET <b>1</b>
DRAWN: N.H.	DRAFTING CHECK: J.C.	HORIZONTAL RATIO: 1:500	PROJECT MANAGER: JOEL COTTER	DATE: 10/08/2017	REVISION: 00	PROJECT REFERENCE: 15375/206	OF 1 SHEETS
DESIGNED: J.C.	DESIGN CHECK: -	VERTICAL RATIO: -					