

74	30.81	277.8 m <sup>2</sup>	9.004	(A)	29.061	261.5 m <sup>2</sup>	61	9.004
73	30.92	278.4 m <sup>2</sup>	9.005	40'	29.061	261.6 m <sup>2</sup>	62	9.005
72	30.913	338.9 m <sup>2</sup>	11.005	(A)	29.061	319.7 m <sup>2</sup>	63	11.005
71	30.658	304 m <sup>2</sup>	9.911	(A)	29.061	290.2 m <sup>2</sup>	64	9.911
70	30.191	269.6 m <sup>2</sup>	9.004	(A)	29.061	261.5 m <sup>2</sup>	65	9.004
	29.739		4	(A)	29.061			4

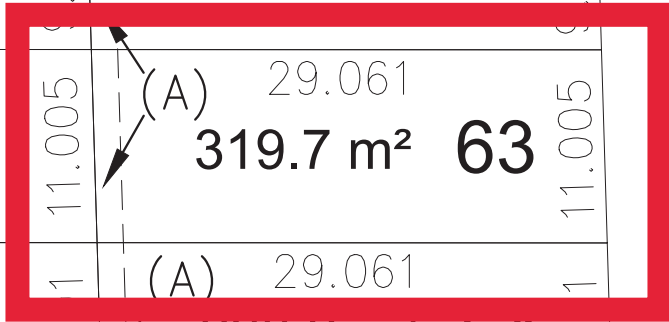

(18 WIDE)

40'	11.005	53	41.116	450.4 m <sup>2</sup>	(A)
40'	11.005	52	40.783	446.8 m <sup>2</sup>	(A)
					24'
	11.005	51	40.450	443.1 m <sup>2</sup>	(A)
	13.006	50	40.117	519 m <sup>2</sup>	(A)
	6		39.724		(A)