

**RAWSON  
COMMUNITIES**  
ASPECT at AUSTRAL

## Precinct 2B

Disclaimer: This lot plan is indicative only.  
Purchasers must rely on their own enquiries, the contract for sale of land and the building contract.  
Dimensions, contours and areas are subject to final survey and Council approval.  
Easements, sewer and street tree locations are indicative and are subject to change.  
Information shown is accurate as of 8th January 2020

### LEGEND:

- (A) EASEMENT FOR ACCESS AND MAINTENANCE 0.9 WIDE
- (B) EASEMENT FOR DRAINAGE OF WATER 1.5 WIDE
- (D) EASEMENT FOR PADMOUNT SUBSTATION 2.75m WIDE
- (B) RESTRICTION ON THE USE OF THE LAND

-S-S- SEWER



STREET TREES

TEMPORARY TURNING AREA

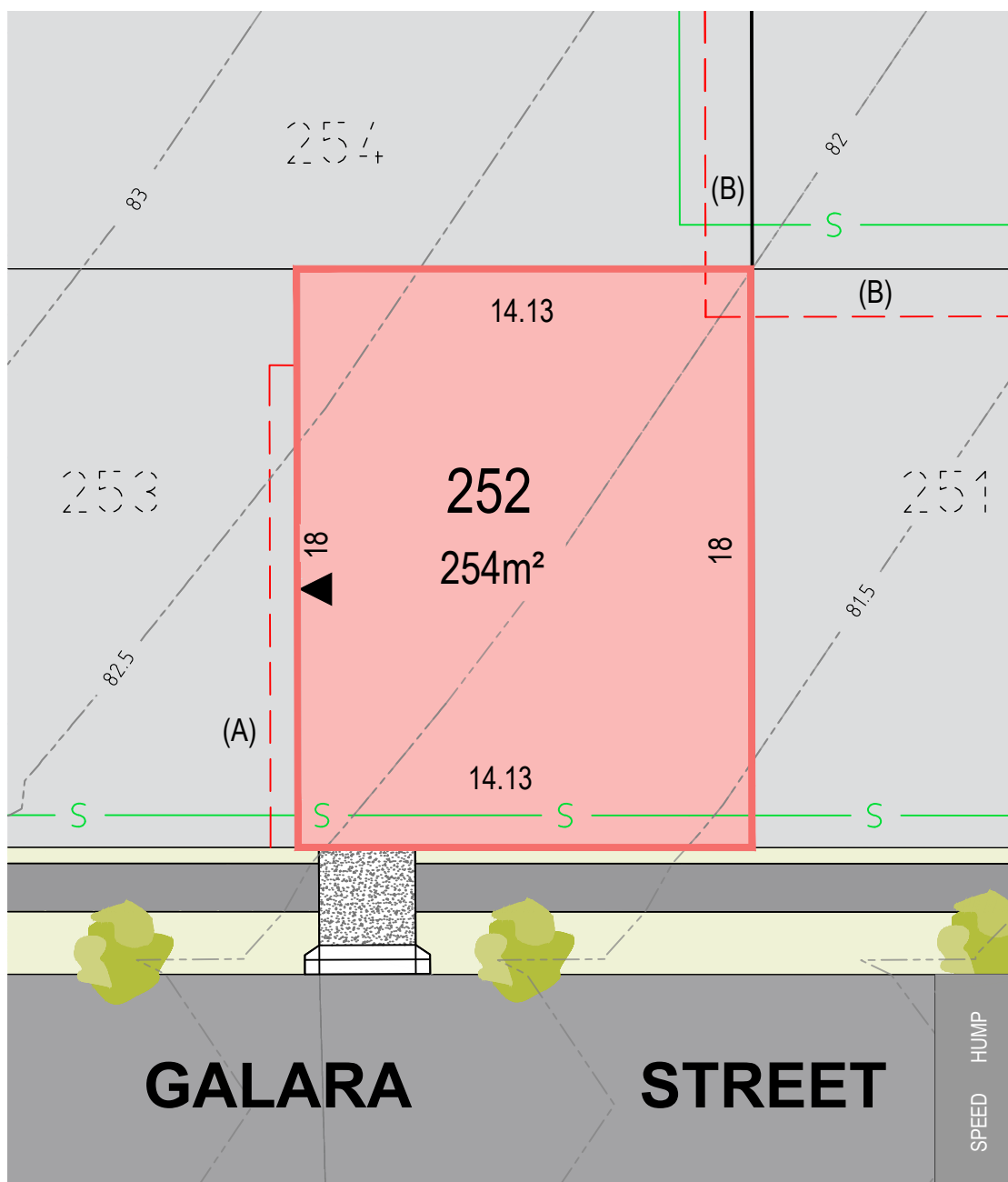

**RAWSON  
COMMUNITIES**  
Aspect - Austral

## Lot 252

Disclaimer: This lot plan is indicative only.  
Purchasers must rely on their own enquiries, the contract for sale of land and the building contract.  
Dimensions, contours and areas are subject to final survey and Council approval.  
Easements, sewer and street tree locations are indicative and are subject to change.  
Information shown is accurate as of 16 October 2019.

### LEGEND:

- (A) EASEMENT FOR ACCESS AND MAINTENANCE 0.9 WIDE
- (B) EASEMENT FOR DRAINAGE OF WATER 1.5 WIDE
- S SEWER
- 35 FINISHED SURFACE CONTOURS
- ▲ DENOTES ZERO LOT LINE
- STREET TREES

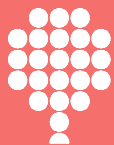
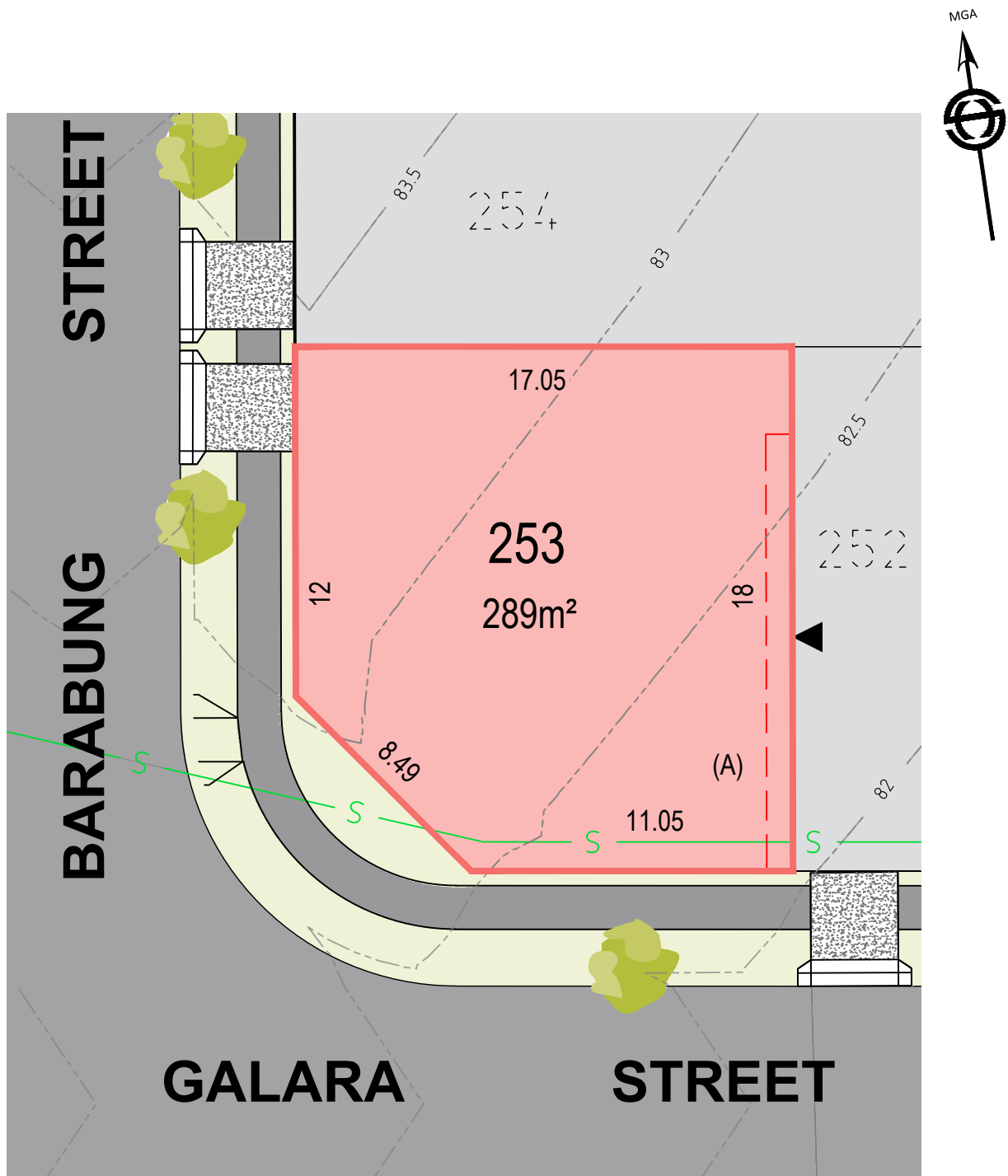

**RAWSON  
COMMUNITIES**  
Aspect - Austral

## Lot 253

Disclaimer: This lot plan is indicative only.  
Purchasers must rely on their own enquiries, the contract for sale of land and the building contract.  
Dimensions, contours and areas are subject to final survey and Council approval.  
Easements, sewer and street tree locations are indicative and are subject to change.  
Information shown is accurate as of 16 October 2019.

### LEGEND:

- (A) EASEMENT FOR ACCESS AND MAINTENANCE 0.9 WIDE
- (B) EASEMENT FOR DRAINAGE OF WATER 1.5 WIDE
- S SEWER
- 35 FINISHED SURFACE CONTOURS
- ▶ DENOTES ZERO LOT LINE
- STREET TREES

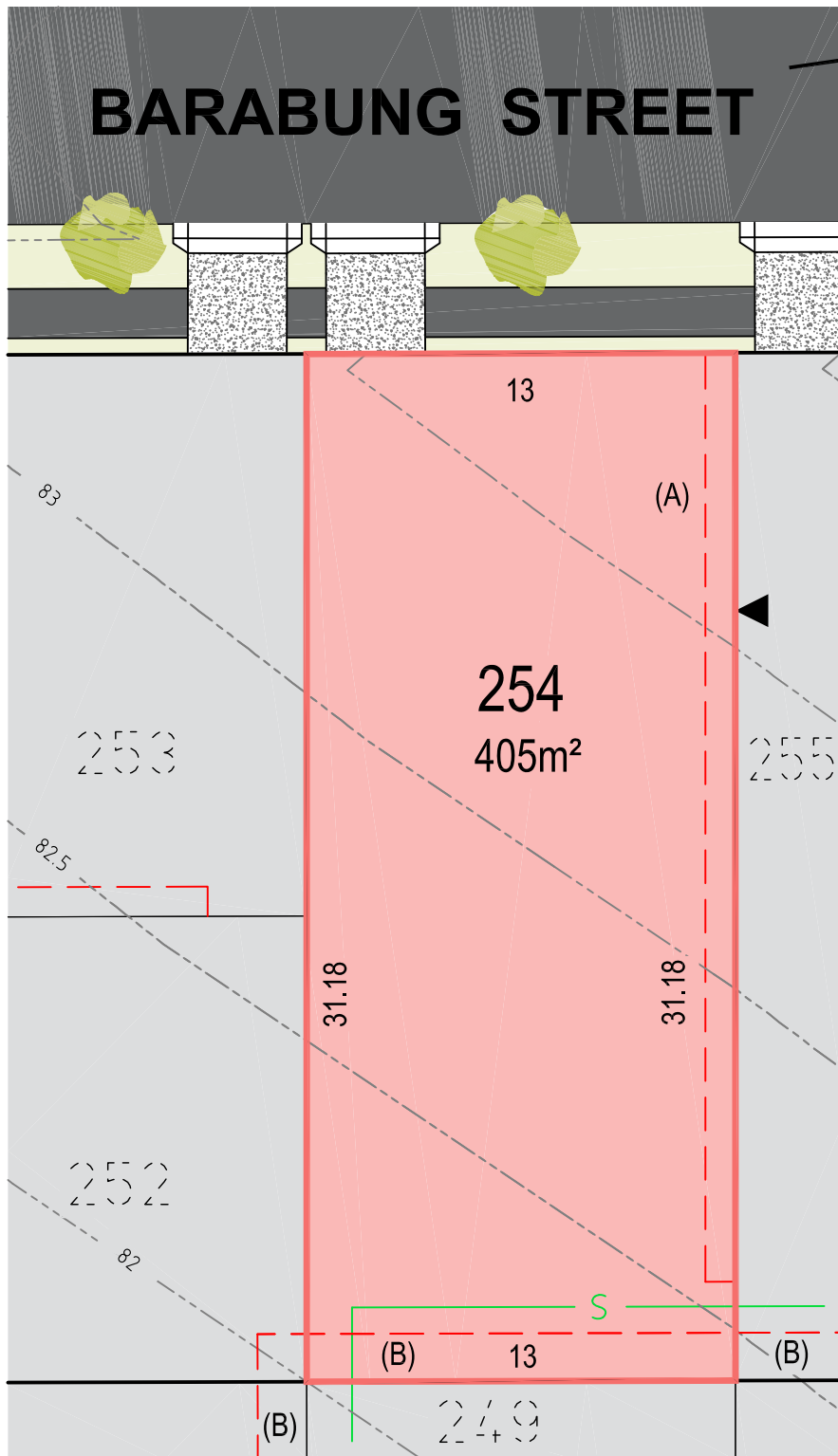

**BARABUNG STREET**

13

(A)

**254**  
405m²

253

255

82.5

31.18

31.18

252

82

(B)

13

(B)

(B)

249



**RAWSON  
COMMUNITIES**  
Aspect - Austral

**Lot 254**

Disclaimer: This lot plan is indicative only.  
Purchasers must rely on their own enquiries, the contract for sale of land and the building contract.  
Dimensions, contours and areas are subject to final survey and Council approval.  
Easements, sewer and street tree locations are indicative and are subject to change.  
Information shown is accurate as of 17 October 2019.

**LEGEND:**

- (A) --- EASEMENT FOR ACCESS AND MAINTENANCE 0.9 WIDE
- S — SEWER
- -35- --- FINISHED SURFACE CONTOURS
- ▶ ● DENOTES ZERO LOT LINE STREET TREES



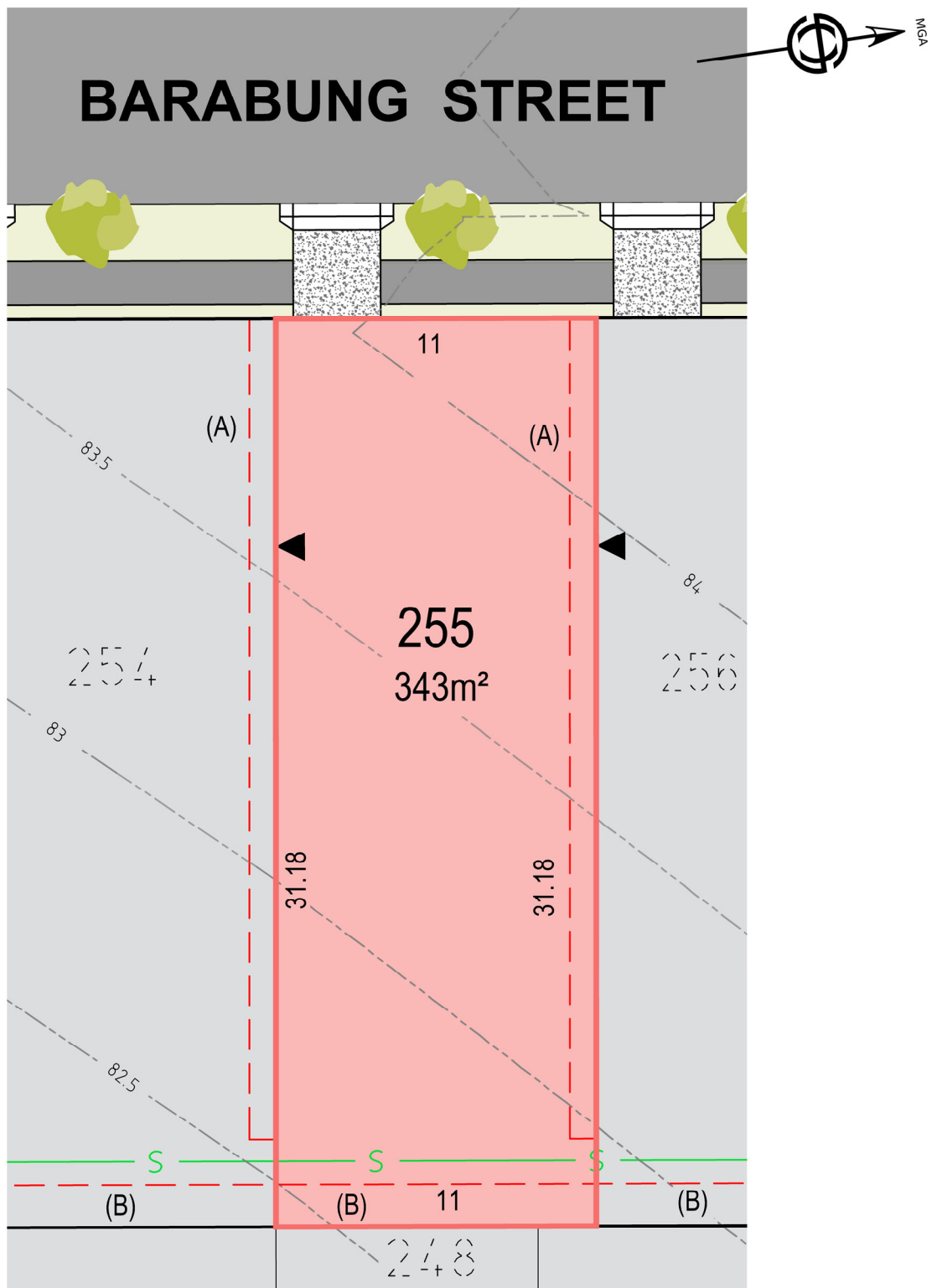

**RAWSON  
COMMUNITIES**  
Aspect - Austral

## Lot 255

Disclaimer: This lot plan is indicative only.  
Purchasers must rely on their own enquiries, the contract for sale of land and the building contract.  
Dimensions, contours and areas are subject to final survey and Council approval.  
Easements, sewer and street tree locations are indicative and are subject to change.  
Information shown is accurate as of 17 October 2019.

### LEGEND:

- (A) --- EASEMENT FOR ACCESS AND MAINTENANCE 0.9 WIDE
- S --- SEWER
- -35- --- FINISHED SURFACE CONTOURS
- ▶ ● DENOTES ZERO LOT LINE STREET TREES



# Lot 256

LEGEND:

- (A) — EASEMENT FOR ACCESS AND MAINTENANCE 0.9 WIDE
- S — SEWER
- 35- FINISHED SURFACE CONTOURS
- ◀ DENOTES ZERO LOT LINE
- STREET TREES

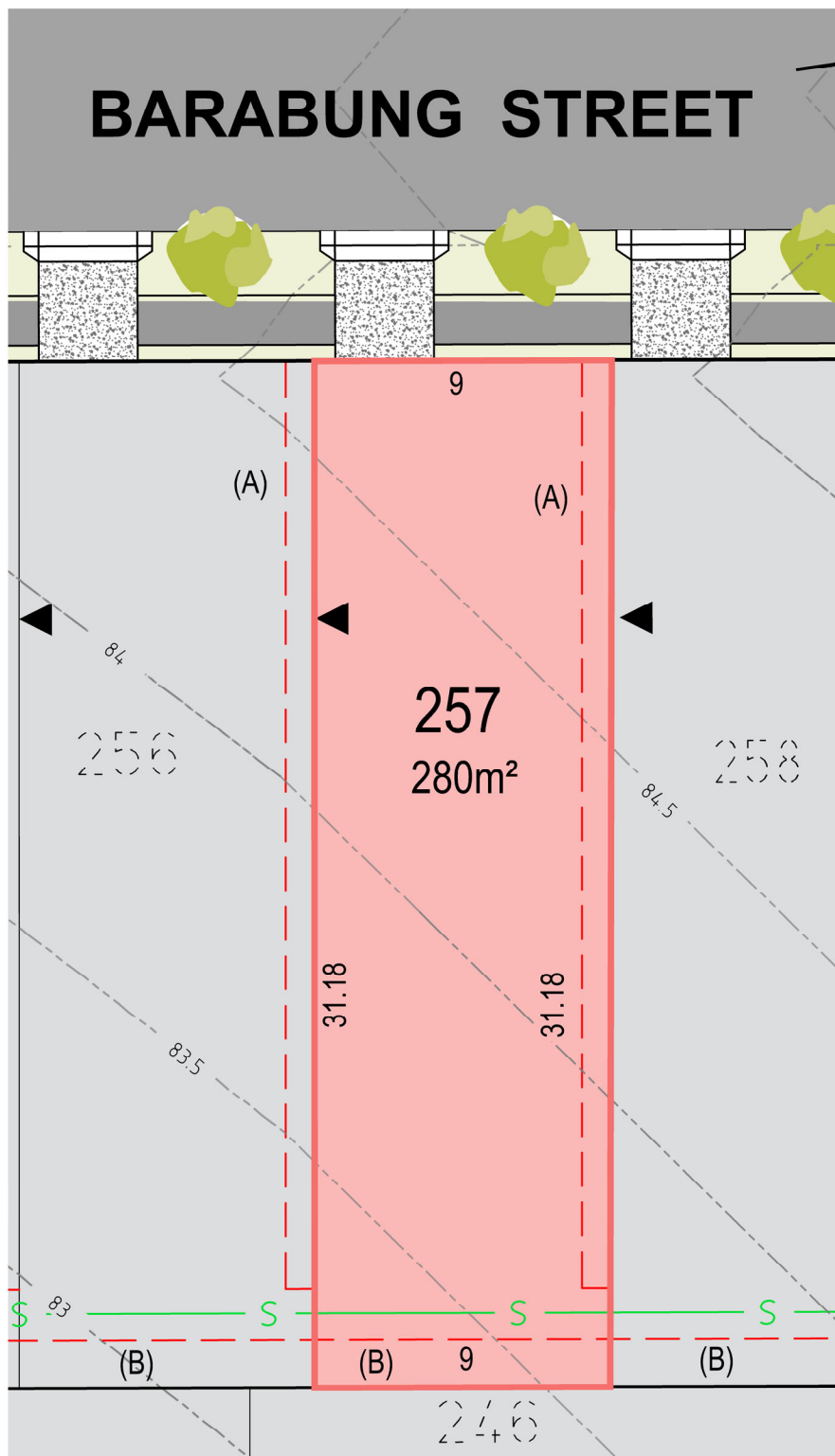

**RAWSON  
COMMUNITIES**  
Aspect - Austral

## Lot 257

Disclaimer: This lot plan is indicative only.  
Purchasers must rely on their own enquiries, the contract for sale of land and the building contract.  
Dimensions, contours and areas are subject to final survey and Council approval.  
Easements, sewer and street tree locations are indicative and are subject to change.  
Information shown is accurate as of 17 October 2019.

### LEGEND:

- (A) --- EASEMENT FOR ACCESS AND MAINTENANCE 0.9 WIDE
- S --- SEWER
- -35- --- FINISHED SURFACE CONTOURS
- ▲ DENOTES ZERO LOT LINE
- STREET TREES

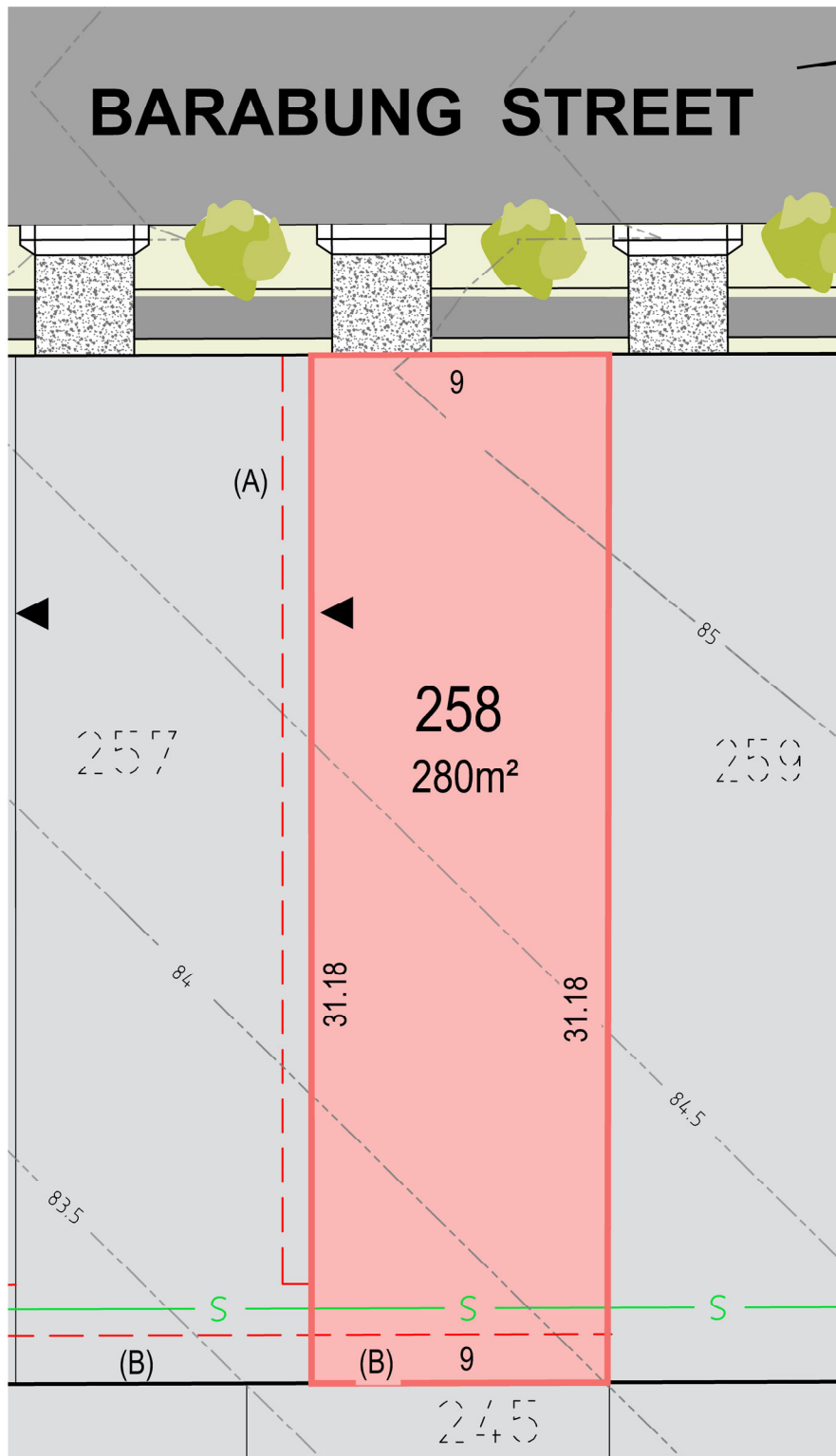

**RAWSON  
COMMUNITIES**  
Aspect - Austral

## Lot 258

Disclaimer: This lot plan is indicative only.  
Purchasers must rely on their own enquiries, the contract for sale of land and the building contract.  
Dimensions, contours and areas are subject to final survey and Council approval.  
Easements, sewer and street tree locations are indicative and are subject to change.  
Information shown is accurate as of 17 October 2019.

### LEGEND:

- (A) EASEMENT FOR ACCESS AND MAINTENANCE 0.9 WIDE
- S SEWER
- 84.5 FINISHED SURFACE CONTOURS
- ▲ DENOTES ZERO LOT LINE
- STREET TREES





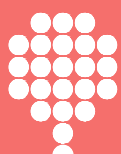
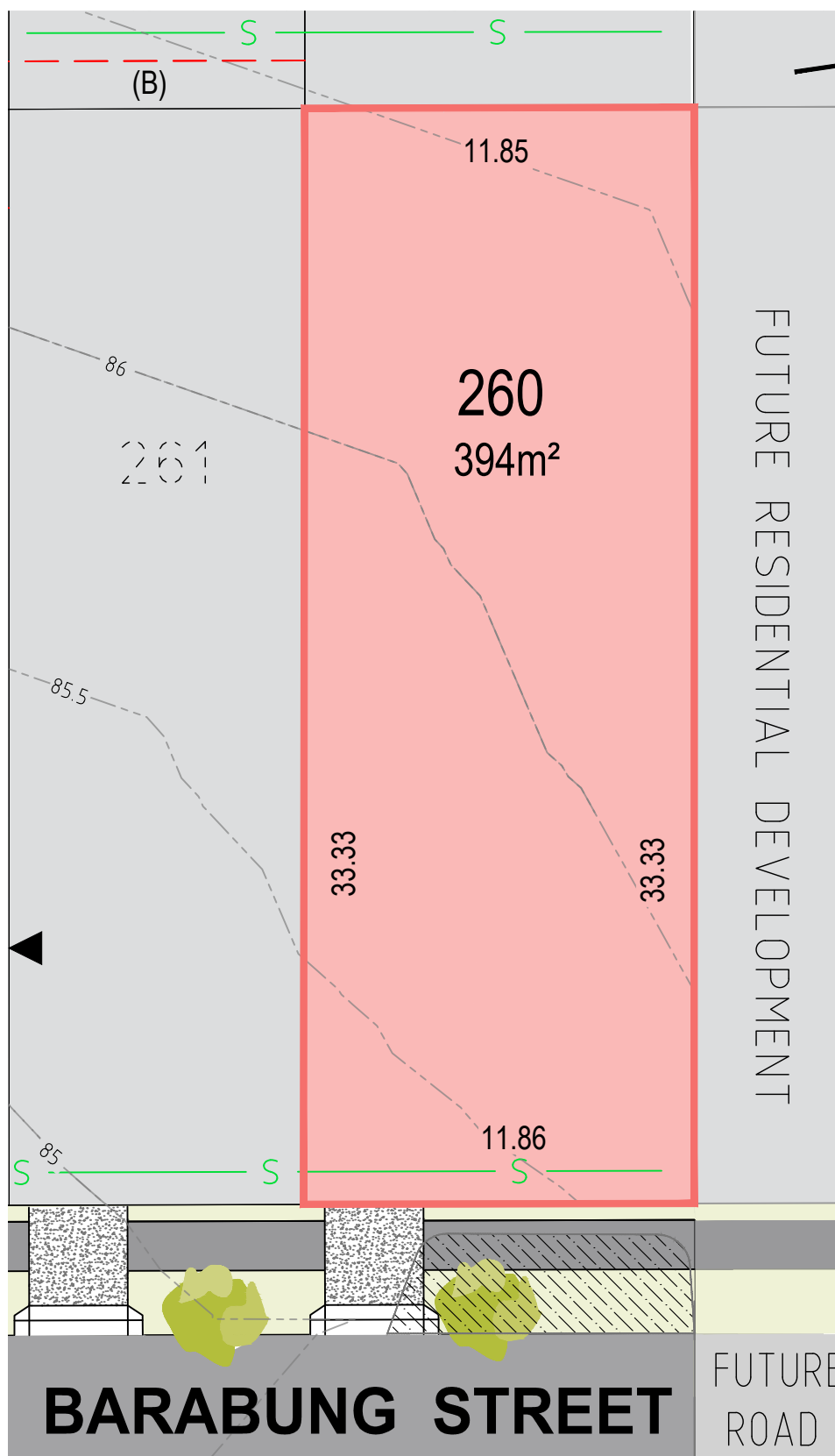

**RAWSON  
COMMUNITIES**  
Aspect - Austral

**Lot 260**

Disclaimer: This lot plan is indicative only.  
Purchasers must rely on their own enquiries, the contract for sale of land and the building contract.  
Dimensions, contours and areas are subject to final survey and Council approval.  
Easements, sewer and street tree locations are indicative and are subject to change.  
Information shown is accurate as of 17 October 2019.

**LEGEND:**

- (A) EASEMENT FOR ACCESS AND MAINTENANCE 0.9 WIDE
- (B) EASEMENT FOR DRAINAGE OF WATER 1.5 WIDE
- S SEWER
- 35- FINISHED SURFACE CONTOURS
- ▲ DENOTES ZERO LOT LINE
- STREET TREES
- TEMPORARY TURNING AREA

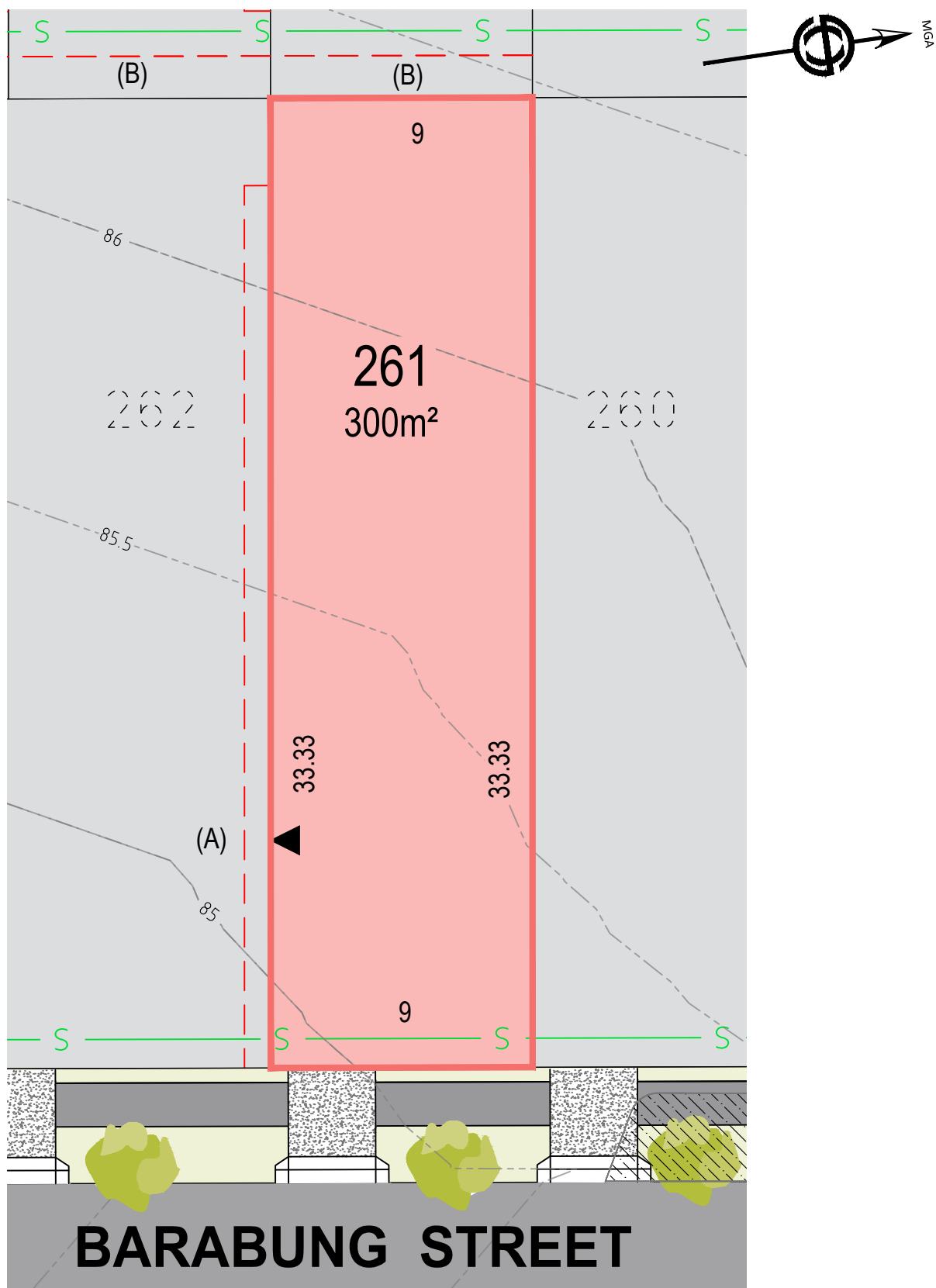

**RAWSON  
COMMUNITIES**  
Aspect - Austral

**Lot 261**

Disclaimer: This lot plan is indicative only.  
Purchasers must rely on their own enquiries, the contract for sale of land and the building contract.  
Dimensions, contours and areas are subject to final survey and Council approval.  
Easements, sewer and street tree locations are indicative and are subject to change.  
Information shown is accurate as of 17 October 2019.

**LEGEND:**

- (A) --- EASEMENT FOR ACCESS AND MAINTENANCE 0.9 WIDE
- (B) --- EASEMENT FOR DRAINAGE OF WATER 1.5 WIDE
- S --- SEWER
- 35 --- FINISHED SURFACE CONTOURS
- ▶ DENOTES ZERO LOT LINE
-  STREET TREES

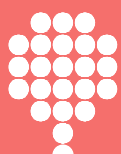
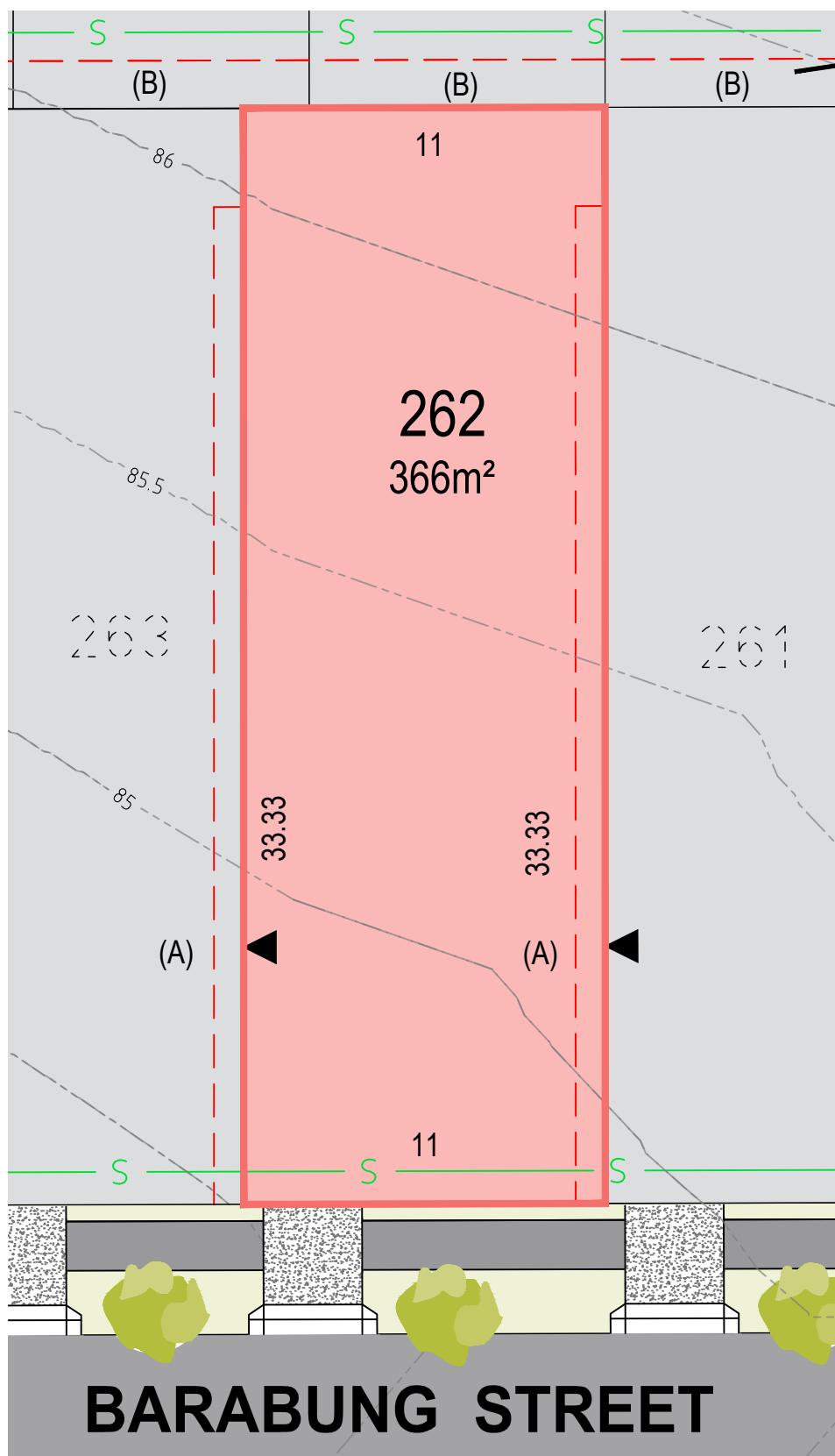

**RAWSON  
COMMUNITIES**  
Aspect - Austral

**Lot 262**

Disclaimer: This lot plan is indicative only.  
Purchasers must rely on their own enquiries, the contract for sale of land and the building contract.  
Dimensions, contours and areas are subject to final survey and Council approval.  
Easements, sewer and street tree locations are indicative and are subject to change.  
Information shown is accurate as of 17 October 2019.

**LEGEND:**

- (A) --- EASEMENT FOR ACCESS AND MAINTENANCE 0.9 WIDE
- (B) --- EASEMENT FOR DRAINAGE OF WATER 1.5 WIDE
- S — SEWER
- 35 --- FINISHED SURFACE CONTOURS
- ▶ ● DENOTES ZERO LOT LINE STREET TREES

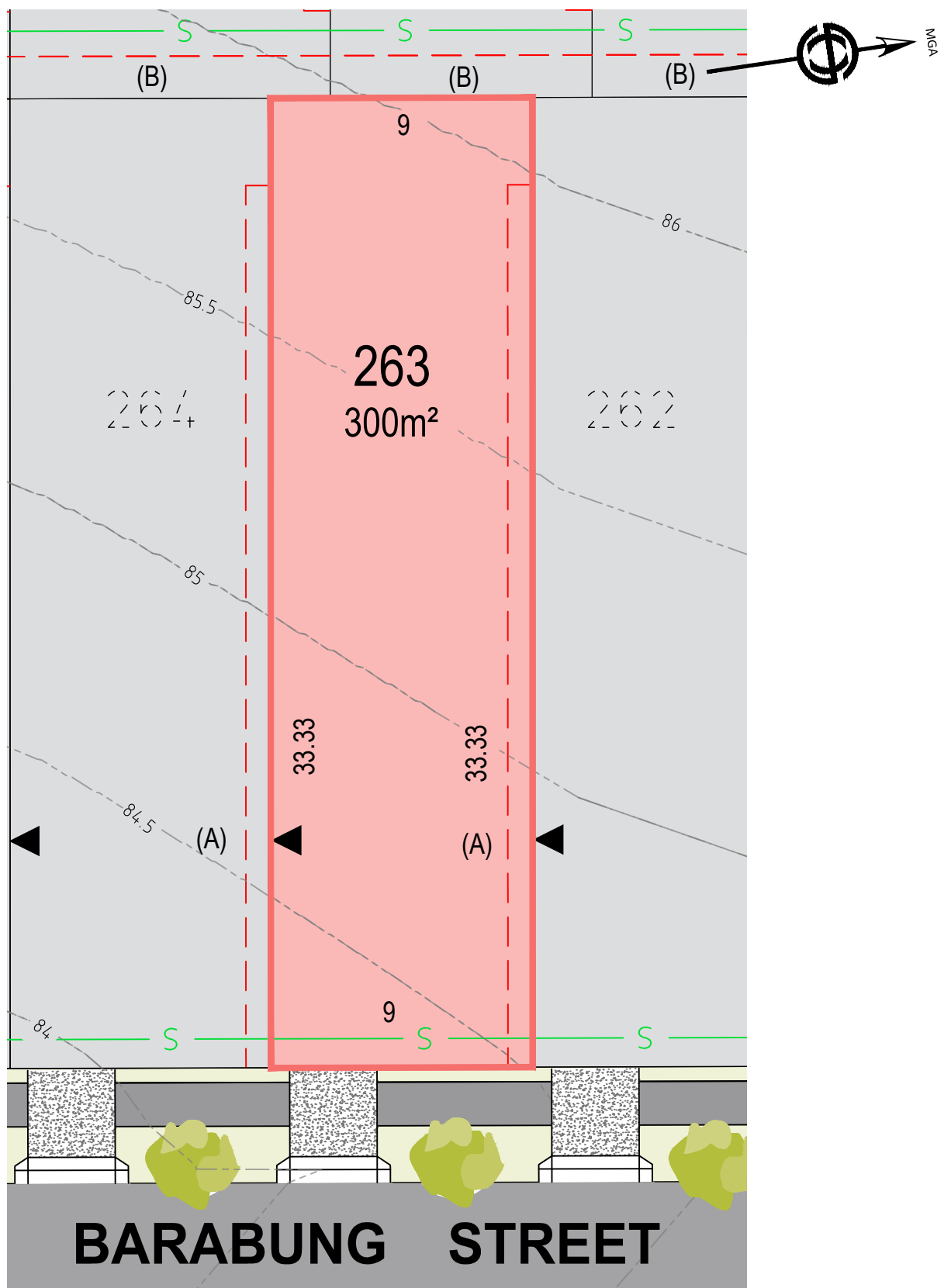

**RAWSON  
COMMUNITIES**  
Aspect - Austral

**Lot 263**

Disclaimer: This lot plan is indicative only.  
Purchasers must rely on their own enquiries, the contract for sale of land and the building contract.  
Dimensions, contours and areas are subject to final survey and Council approval.  
Easements, sewer and street tree locations are indicative and are subject to change.  
Information shown is accurate as of 17 October 2019.

**LEGEND:**

- (A) EASEMENT FOR ACCESS AND MAINTENANCE 0.9 WIDE
- (B) EASEMENT FOR DRAINAGE OF WATER 1.5 WIDE
- S SEWER
- 35 FINISHED SURFACE CONTOURS
- ▶ DENOTES ZERO LOT LINE
- STREET TREES

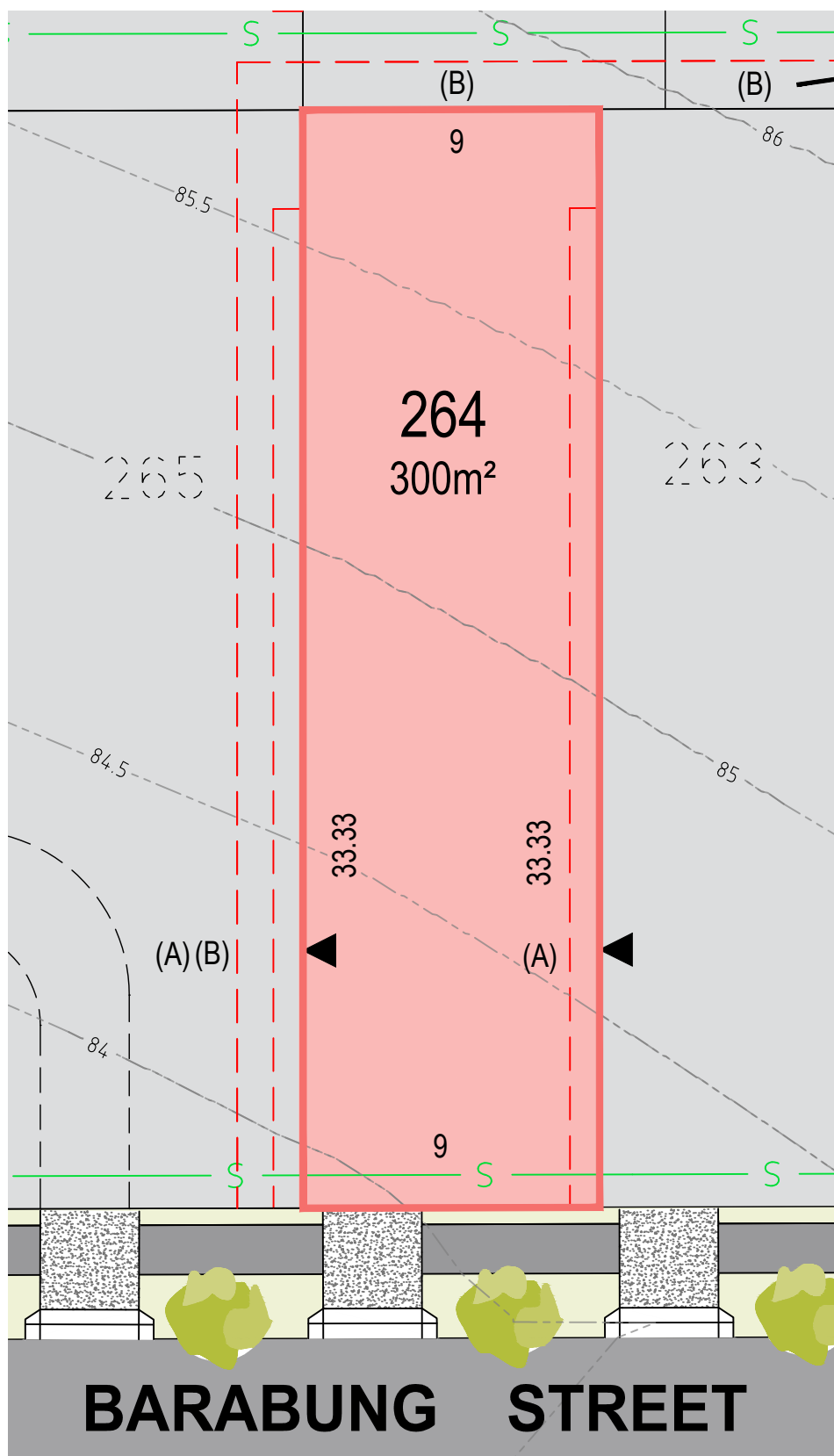

**RAWSON  
COMMUNITIES**  
Aspect - Austral

**Lot 264**

Disclaimer: This lot plan is indicative only.  
Purchasers must rely on their own enquiries, the contract for sale of land and the building contract.  
Dimensions, contours and areas are subject to final survey and Council approval.  
Easements, sewer and street tree locations are indicative and are subject to change.  
Information shown is accurate as of 17 October 2019.

**LEGEND:**

- (A) --- EASEMENT FOR ACCESS AND MAINTENANCE 0.9 WIDE
- (B) --- EASEMENT FOR DRAINAGE OF WATER 1.5 WIDE
- S — SEWER
- 35 --- FINISHED SURFACE CONTOURS
- ▶ DENOTES ZERO LOT LINE
- STREET TREES





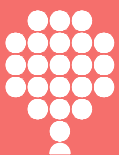
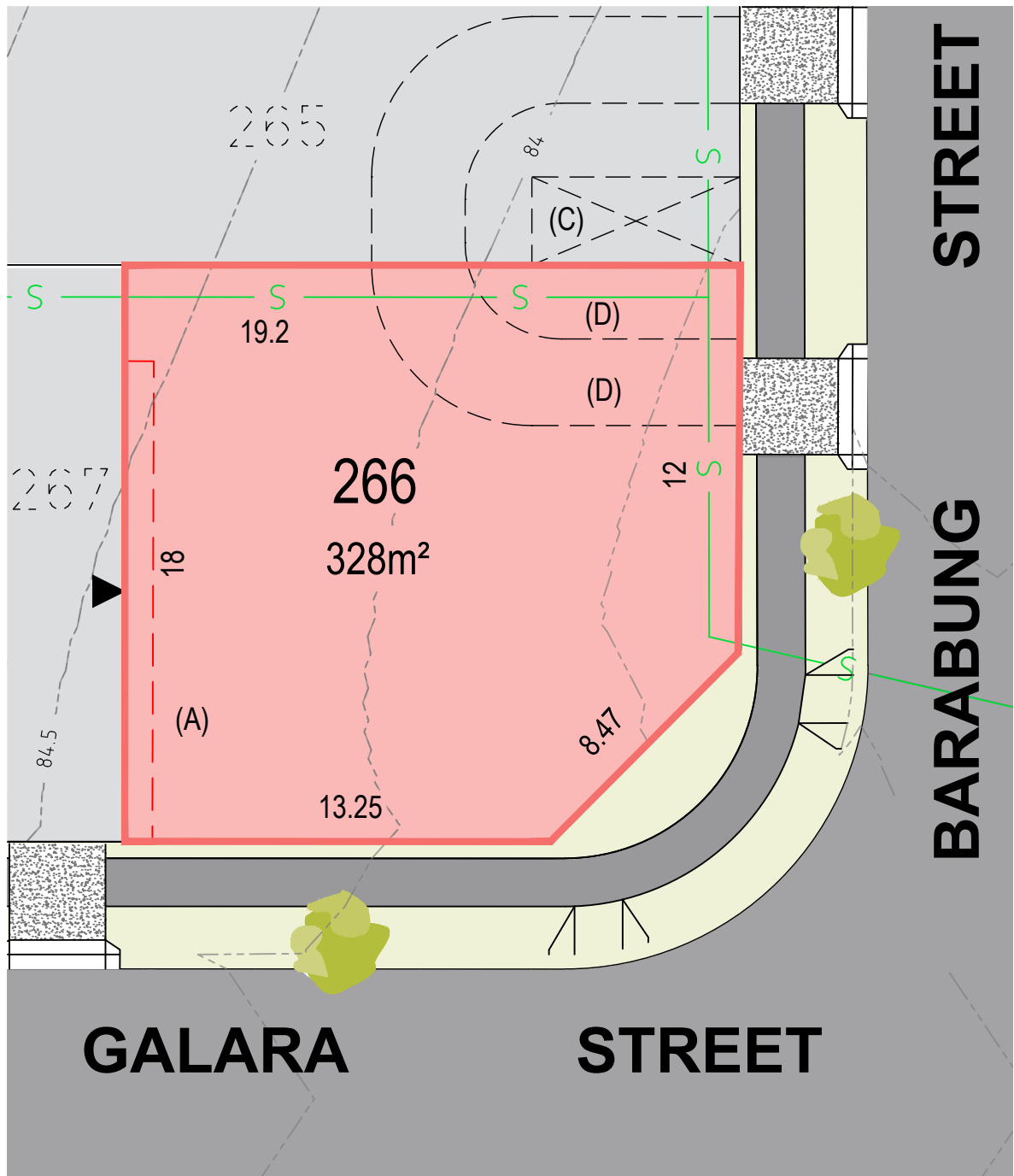

**RAWSON  
COMMUNITIES**  
Aspect - Austral

## Lot 266

Disclaimer: This lot plan is indicative only.  
Purchasers must rely on their own enquiries, the contract for sale of land and the building contract.  
Dimensions, contours and areas are subject to final survey and Council approval.  
Easements, sewer and street tree locations are indicative and are subject to change.  
Information shown is accurate as of 17 October 2019.

### LEGEND:

- (A) EASEMENT FOR ACCESS AND MAINTENANCE 0.9 WIDE
- (B) EASEMENT FOR DRAINAGE OF WATER 1.5 WIDE
- (C) EASEMENT FOR PADMOUNT SUBSTATION 2.75m WIDE
- (D) RESTRICTION ON THE USE OF THE LAND
- S SEWER
- STREET TREES
- 35 FINISHED SURFACE CONTOURS
- DENOTES ZERO LOT LINE

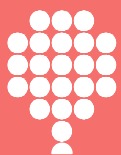
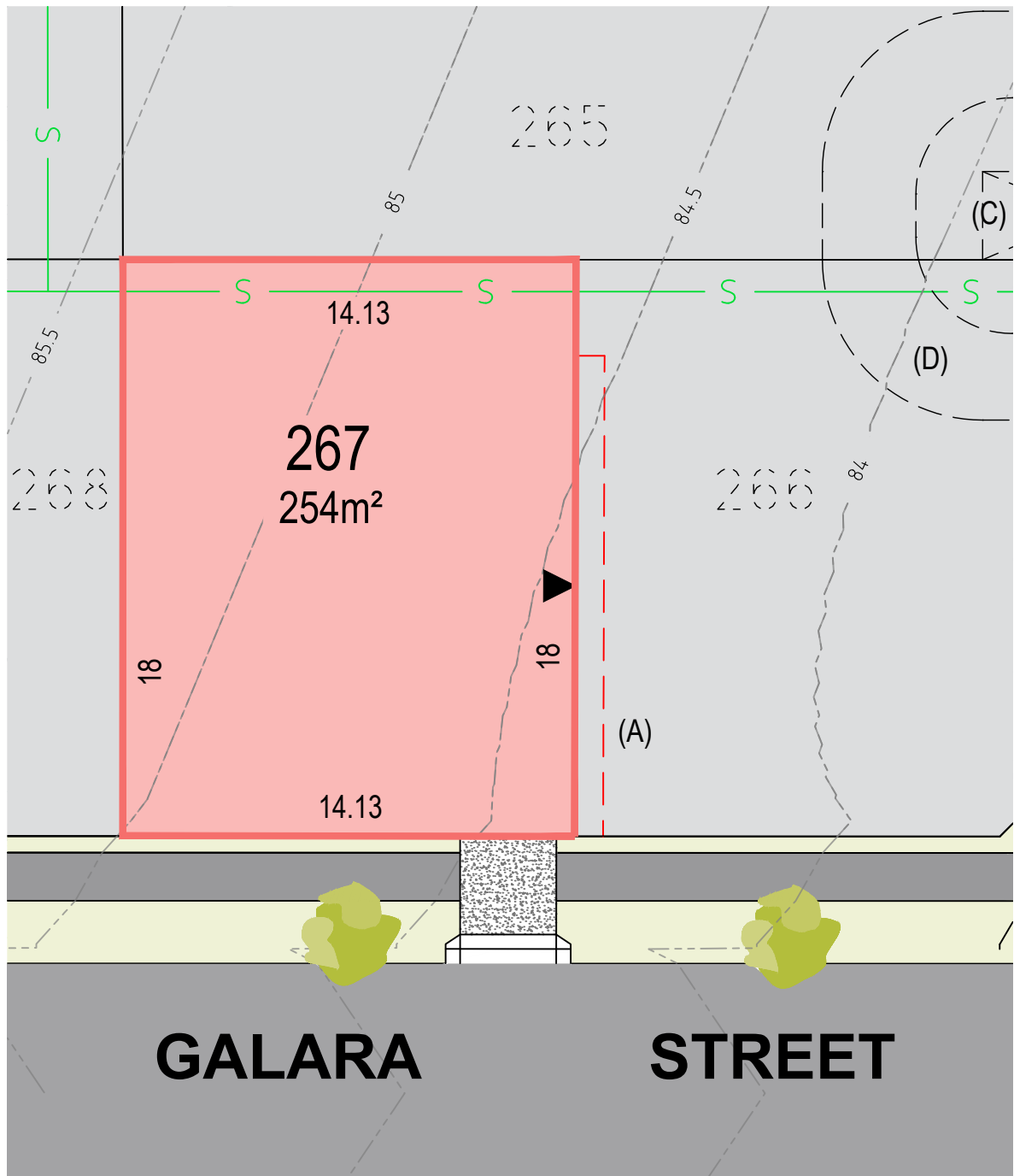

**RAWSON  
COMMUNITIES**  
Aspect - Austral

**Lot 267**

Disclaimer: This lot plan is indicative only.  
Purchasers must rely on their own enquiries, the contract for sale of land and the building contract.  
Dimensions, contours and areas are subject to final survey and Council approval.  
Easements, sewer and street tree locations are indicative and are subject to change.  
Information shown is accurate as of 17 October 2019.

**LEGEND:**

- (A) — EASEMENT FOR ACCESS AND MAINTENANCE 0.9 WIDE
- (B) — EASEMENT FOR DRAINAGE OF WATER 1.5 WIDE
- (C) — EASEMENT FOR PADMOUNT SUBSTATION 2.75m WIDE
- (D) — RESTRICTION ON THE USE OF THE LAND
- S—S— SEWER
-  STREET TREES
- 35- FINISHED SURFACE CONTOURS
- ◀ DENOTES ZERO LOT LINE

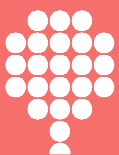
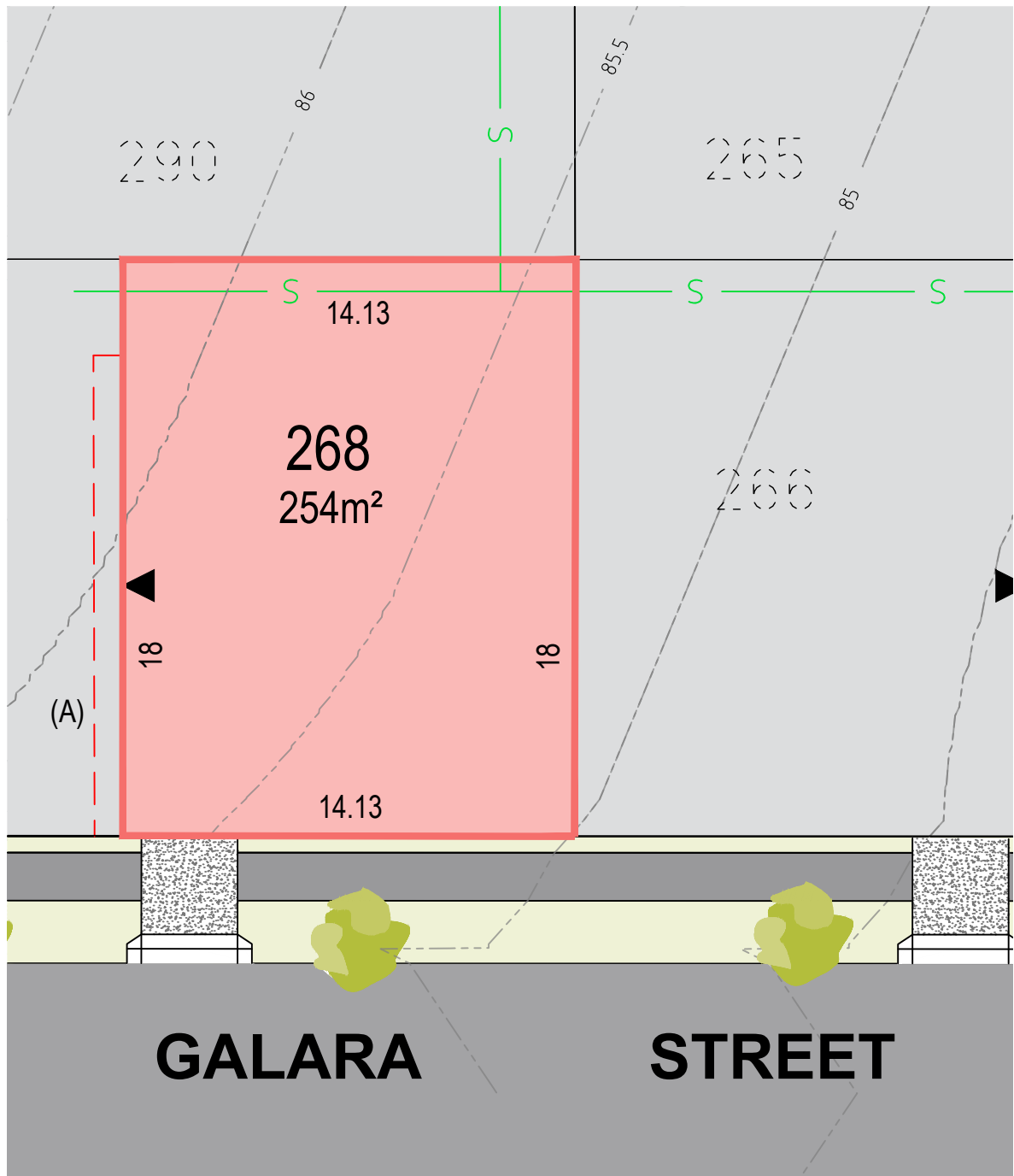





**RAWSON  
COMMUNITIES**  
Aspect - Austral

**Lot 268**

Disclaimer: This lot plan is indicative only.  
Purchasers must rely on their own enquiries, the contract for sale of land and the building contract.  
Dimensions, contours and areas are subject to final survey and Council approval.  
Easements, sewer and street tree locations are indicative and are subject to change.  
Information shown is accurate as of 17 October 2019.

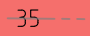
**LEGEND:**

-  (A) EASEMENT FOR ACCESS AND MAINTENANCE 0.9 WIDE
-  SEWER
-  STREET TREES
-  35 FINISHED SURFACE CONTOURS
-  DENOTES ZERO LOT LINE

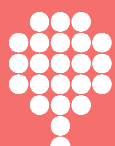
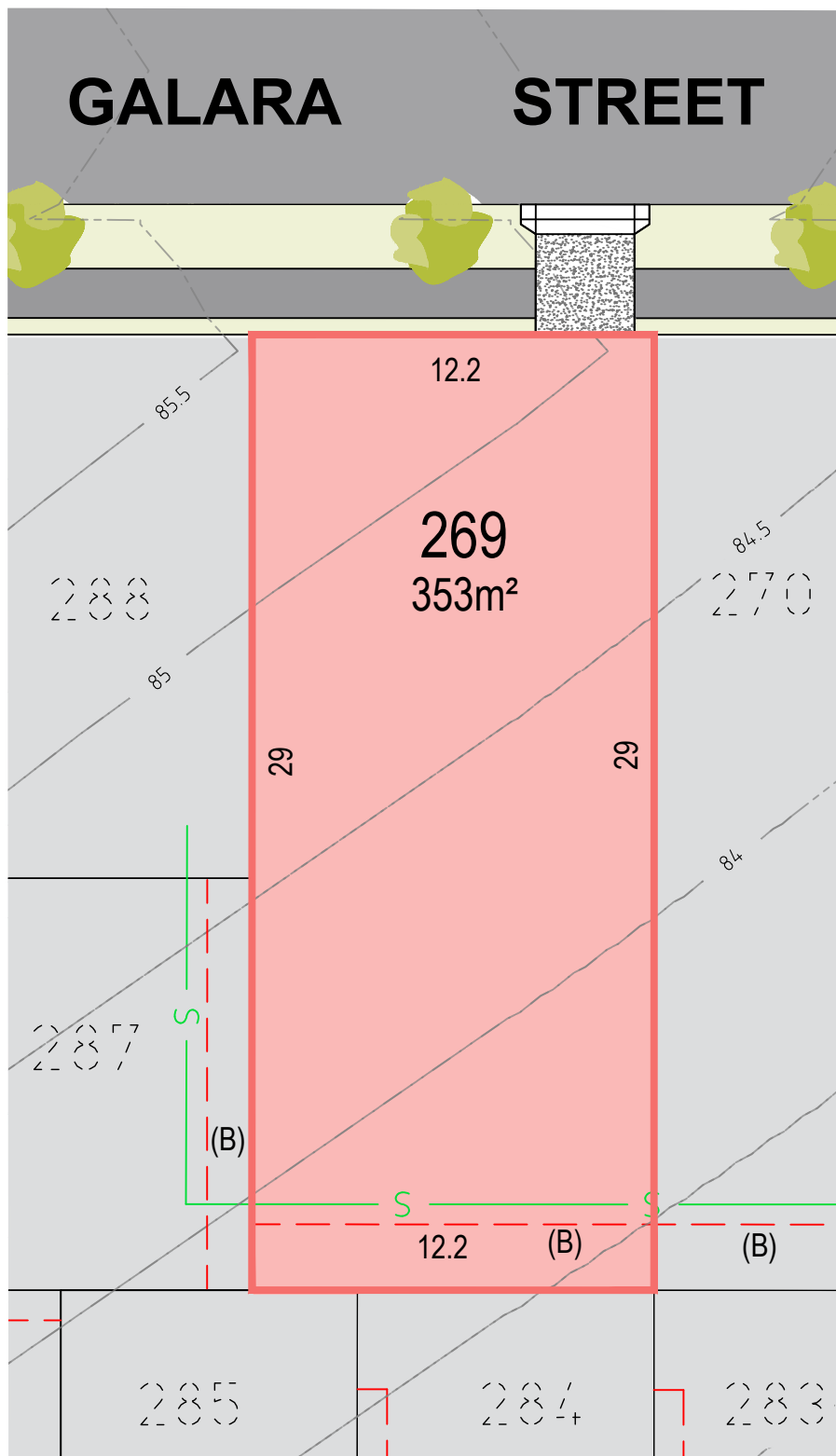

**RAWSON  
COMMUNITIES**  
Aspect - Austral

## Lot 269

Disclaimer: This lot plan is indicative only.  
Purchasers must rely on their own enquiries, the contract for sale of land and the building contract.  
Dimensions, contours and areas are subject to final survey and Council approval.  
Easements, sewer and street tree locations are indicative and are subject to change.  
Information shown is accurate as of 16 October 2019.

### LEGEND:

- (A) — EASEMENT FOR ACCESS AND MAINTENANCE 0.9 WIDE
- (B) — EASEMENT FOR DRAINAGE OF WATER 1.5 WIDE
- S — SEWER
- 35 — FINISHED SURFACE CONTOURS
- ▲ DENOTES ZERO LOT LINE
- STREET TREES



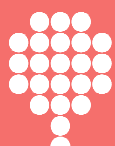
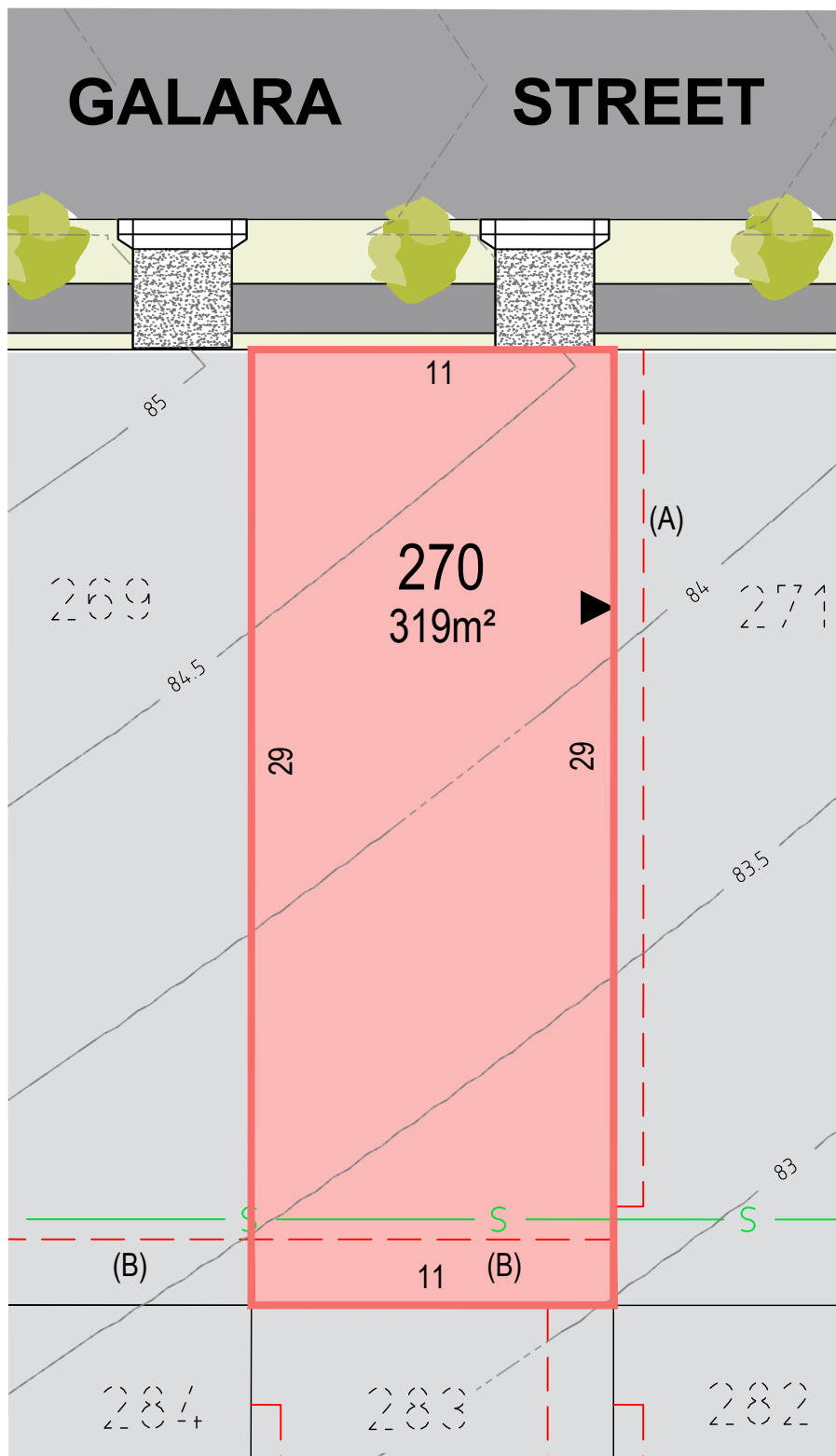

**RAWSON  
COMMUNITIES**  
Aspect - Austral

## Lot 270

Disclaimer: This lot plan is indicative only.  
Purchasers must rely on their own enquiries, the contract for sale of land and the building contract.  
Dimensions, contours and areas are subject to final survey and Council approval.  
Easements, sewer and street tree locations are indicative and are subject to change.  
Information shown is accurate as of 16 October 2019.

### LEGEND:

- (A) EASEMENT FOR ACCESS AND MAINTENANCE 0.9 WIDE
- (B) EASEMENT FOR DRAINAGE OF WATER 1.5 WIDE
- S SEWER
- 35 FINISHED SURFACE CONTOURS
- DENOTES ZERO LOT LINE
- STREET TREES

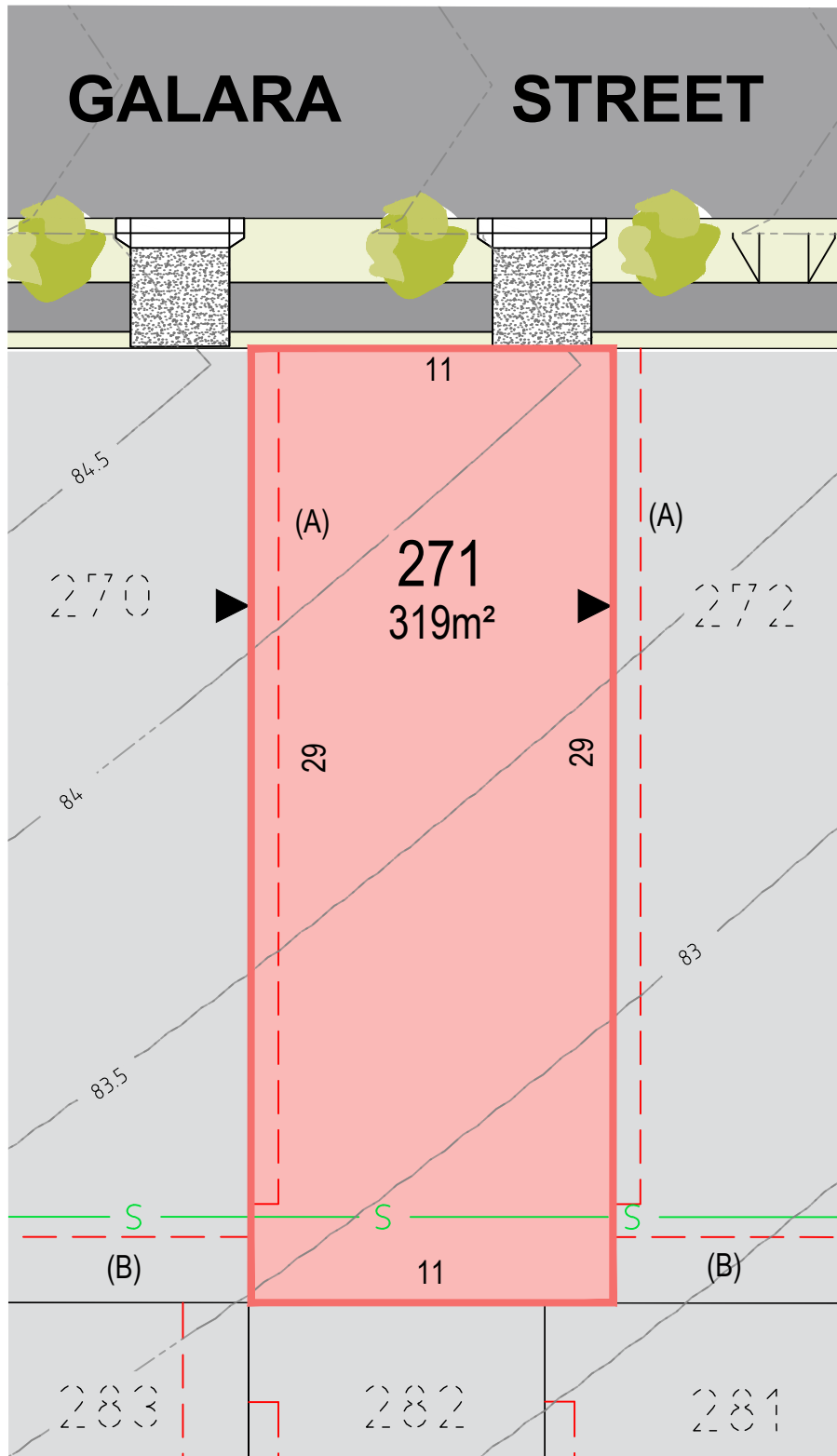

**RAWSON  
COMMUNITIES**  
Aspect - Austral

## Lot 271

Disclaimer: This lot plan is indicative only.  
Purchasers must rely on their own enquiries, the contract for sale of land and the building contract.  
Dimensions, contours and areas are subject to final survey and Council approval.  
Easements, sewer and street tree locations are indicative and are subject to change.  
Information shown is accurate as of 16 October 2019.

### LEGEND:

- (A) EASEMENT FOR ACCESS AND MAINTENANCE 0.9 WIDE
- (B) EASEMENT FOR DRAINAGE OF WATER 1.5 WIDE
- S SEWER
- 35 FINISHED SURFACE CONTOURS
- DENOTES ZERO LOT LINE
- STREET TREES

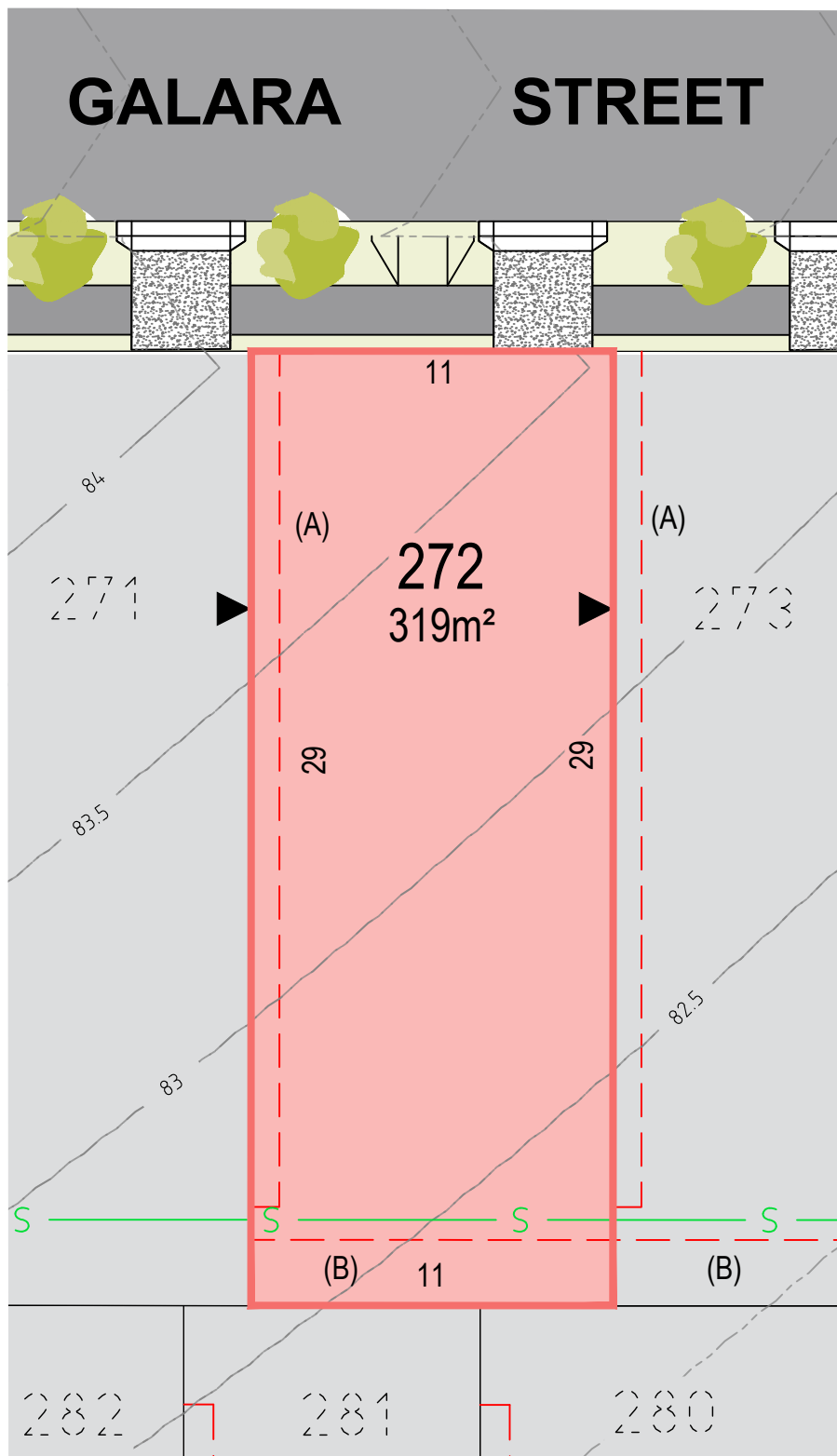

**RAWSON  
COMMUNITIES**  
Aspect - Austral

## Lot 272

Disclaimer: This lot plan is indicative only.  
Purchasers must rely on their own enquiries, the contract for sale of land and the building contract.  
Dimensions, contours and areas are subject to final survey and Council approval.  
Easements, sewer and street tree locations are indicative and are subject to change.  
Information shown is accurate as of 16 October 2019.

### LEGEND:

- (A) EASEMENT FOR ACCESS AND MAINTENANCE 0.9 WIDE
- (B) EASEMENT FOR DRAINAGE OF WATER 1.5 WIDE
- S SEWER
- 35 FINISHED SURFACE CONTOURS
- DENOTES ZERO LOT LINE
- STREET TREES

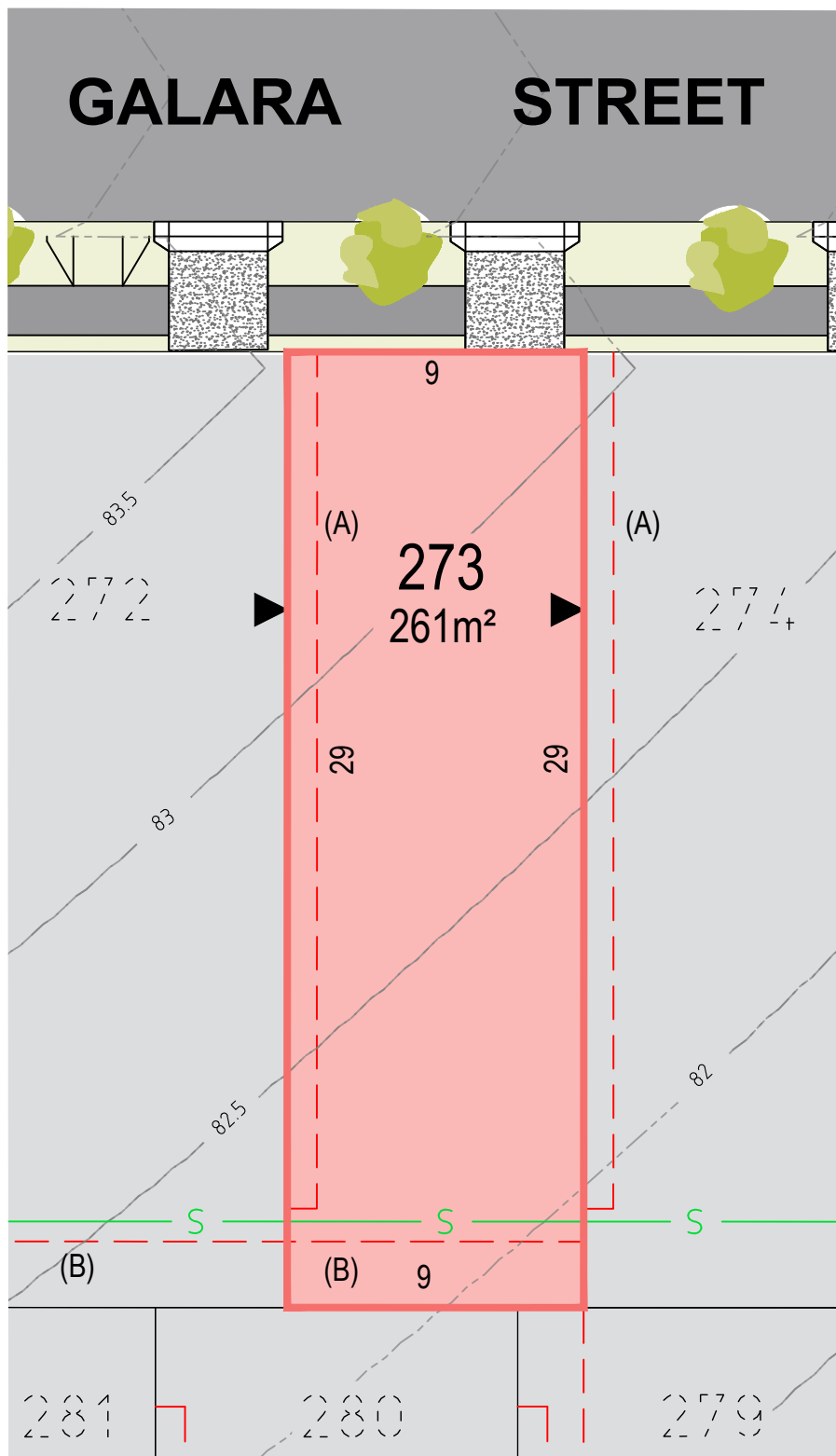

**RAWSON  
COMMUNITIES**  
Aspect - Austral

## Lot 273

Disclaimer: This lot plan is indicative only.  
Purchasers must rely on their own enquiries, the contract for sale of land and the building contract.  
Dimensions, contours and areas are subject to final survey and Council approval.  
Easements, sewer and street tree locations are indicative and are subject to change.  
Information shown is accurate as of 16 October 2019.

### LEGEND:

- (A) EASEMENT FOR ACCESS AND MAINTENANCE 0.9 WIDE
- (B) EASEMENT FOR DRAINAGE OF WATER 1.5 WIDE
- S SEWER
- 35 FINISHED SURFACE CONTOURS
- DENOTES ZERO LOT LINE
- STREET TREES

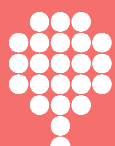
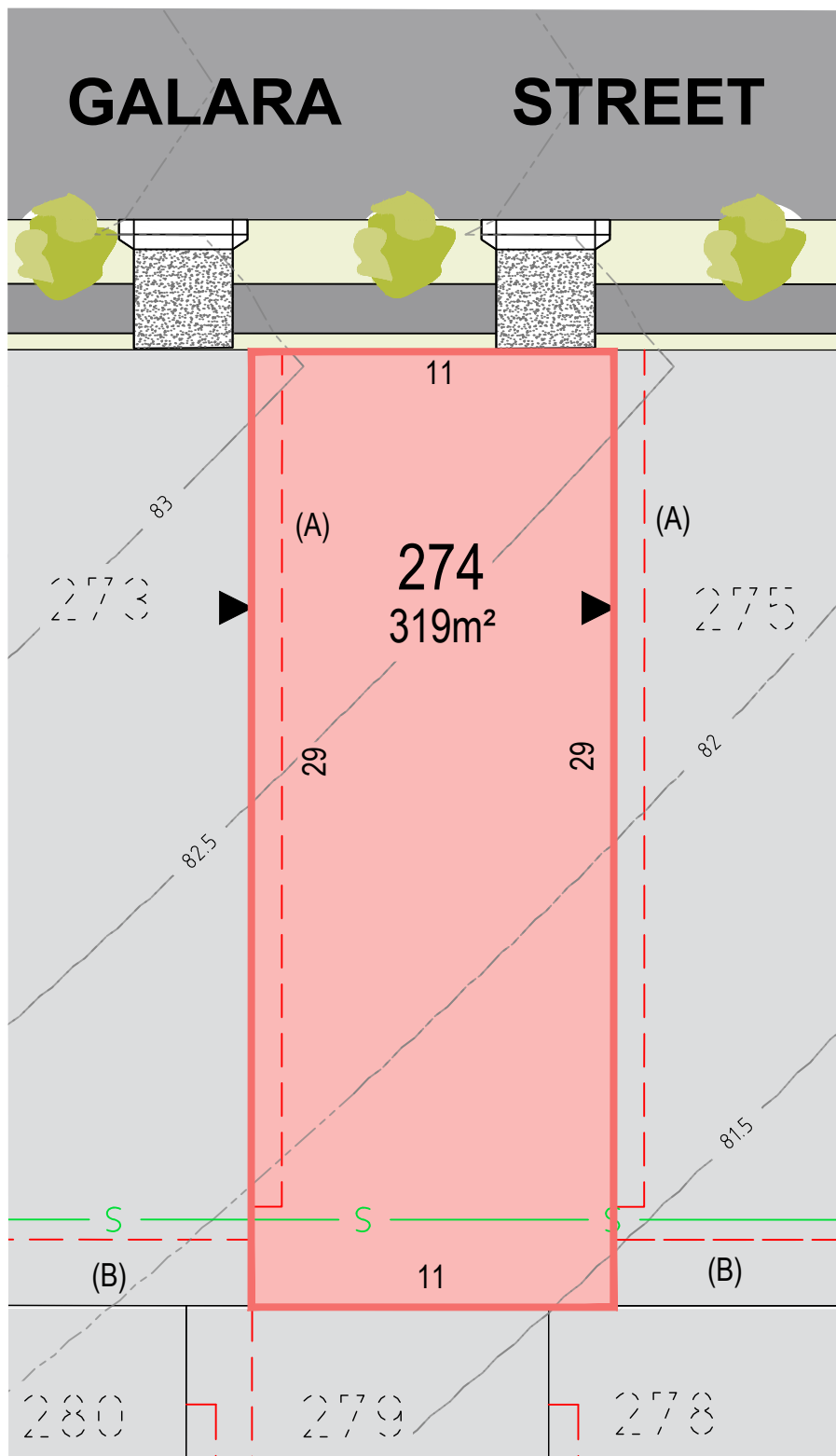

**RAWSON  
COMMUNITIES**  
Aspect - Austral

## Lot 274

Disclaimer: This lot plan is indicative only.  
Purchasers must rely on their own enquiries, the contract for sale of land and the building contract.  
Dimensions, contours and areas are subject to final survey and Council approval.  
Easements, sewer and street tree locations are indicative and are subject to change.  
Information shown is accurate as of 16 October 2019.

### LEGEND:

- (A) — EASEMENT FOR ACCESS AND MAINTENANCE 0.9 WIDE
- (B) — EASEMENT FOR DRAINAGE OF WATER 1.5 WIDE
- S — SEWER
- 35 — FINISHED SURFACE CONTOURS
- ▶ DENOTES ZERO LOT LINE
- 🌳 STREET TREES



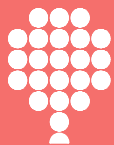
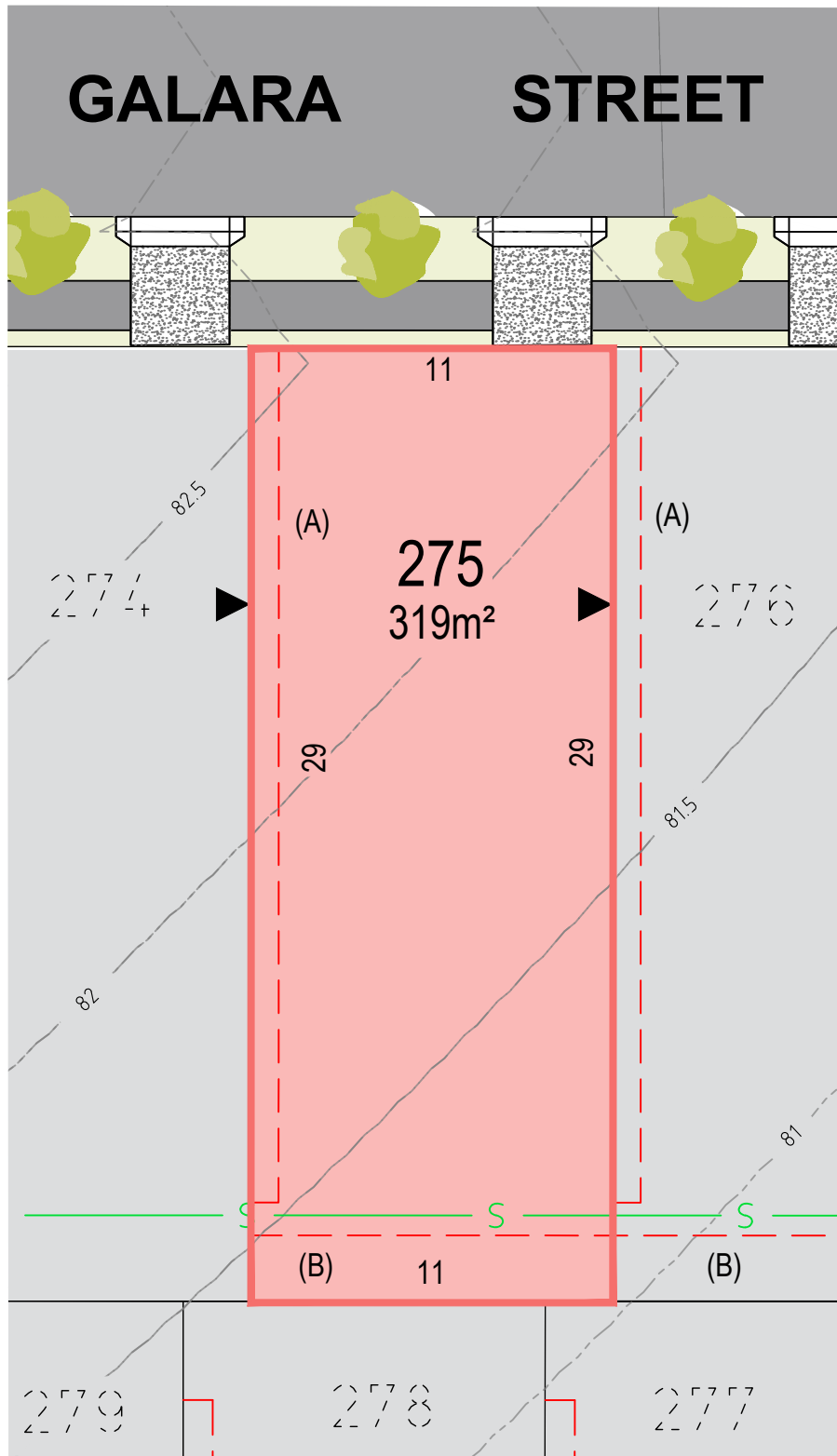

**RAWSON  
COMMUNITIES**  
Aspect - Austral

## Lot 275

Disclaimer: This lot plan is indicative only.  
Purchasers must rely on their own enquiries, the contract for sale of land and the building contract.  
Dimensions, contours and areas are subject to final survey and Council approval.  
Easements, sewer and street tree locations are indicative and are subject to change.  
Information shown is accurate as of 16 October 2019.

### LEGEND:

- (A) EASEMENT FOR ACCESS AND MAINTENANCE 0.9 WIDE
- (B) EASEMENT FOR DRAINAGE OF WATER 1.5 WIDE
- S SEWER
- 35 FINISHED SURFACE CONTOURS
- DENOTES ZERO LOT LINE
- STREET TREES

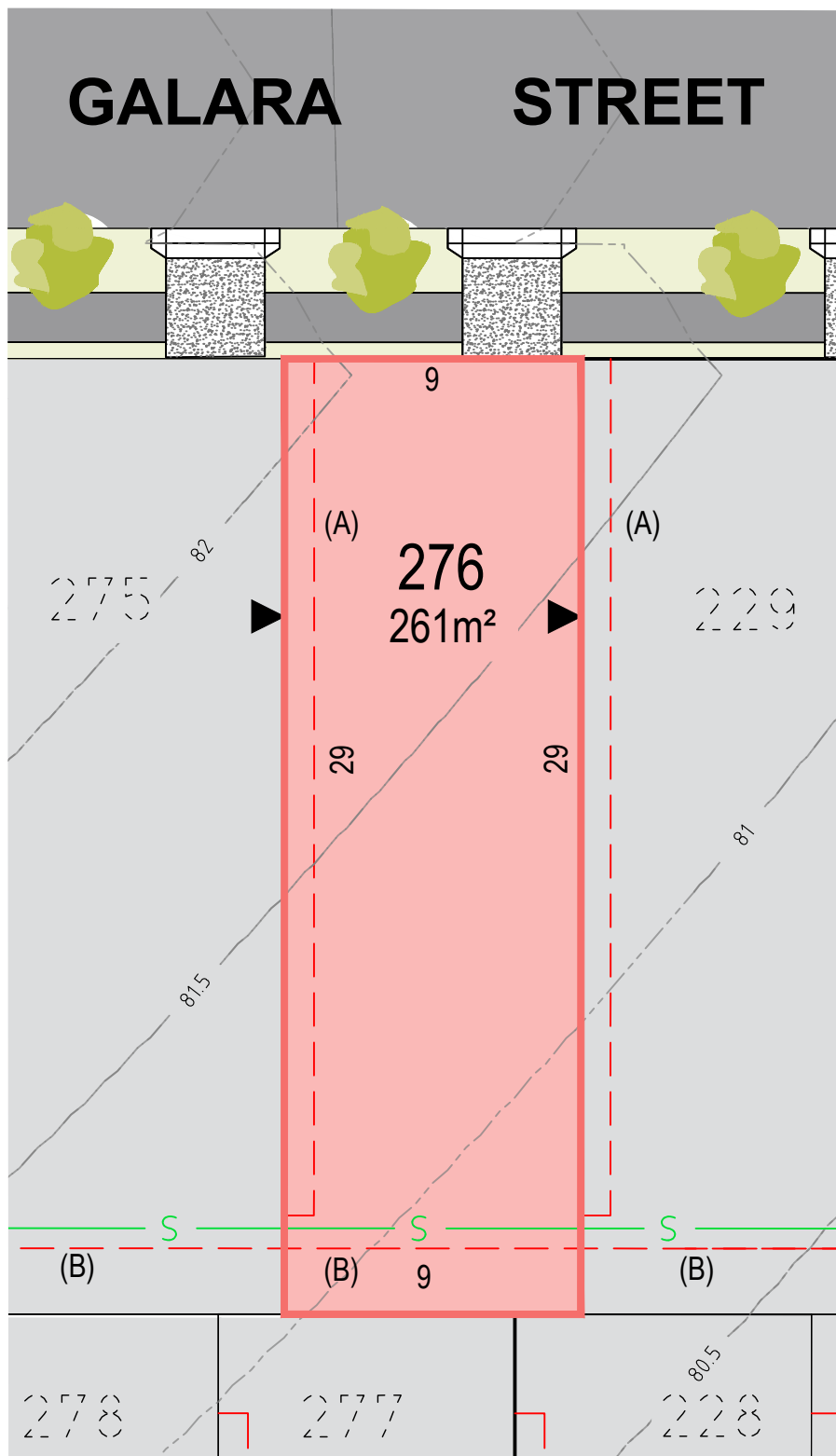

**RAWSON  
COMMUNITIES**  
Aspect - Austral

## Lot 276

Disclaimer: This lot plan is indicative only.  
Purchasers must rely on their own enquiries, the contract for sale of land and the building contract.  
Dimensions, contours and areas are subject to final survey and Council approval.  
Easements, sewer and street tree locations are indicative and are subject to change.  
Information shown is accurate as of 16 October 2019.

### LEGEND:

- (A) EASEMENT FOR ACCESS AND MAINTENANCE 0.9 WIDE
- (B) EASEMENT FOR DRAINAGE OF WATER 1.5 WIDE
- S SEWER
- 35 FINISHED SURFACE CONTOURS
- ▶ DENOTES ZERO LOT LINE
- STREET TREES

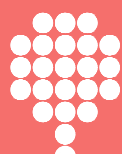
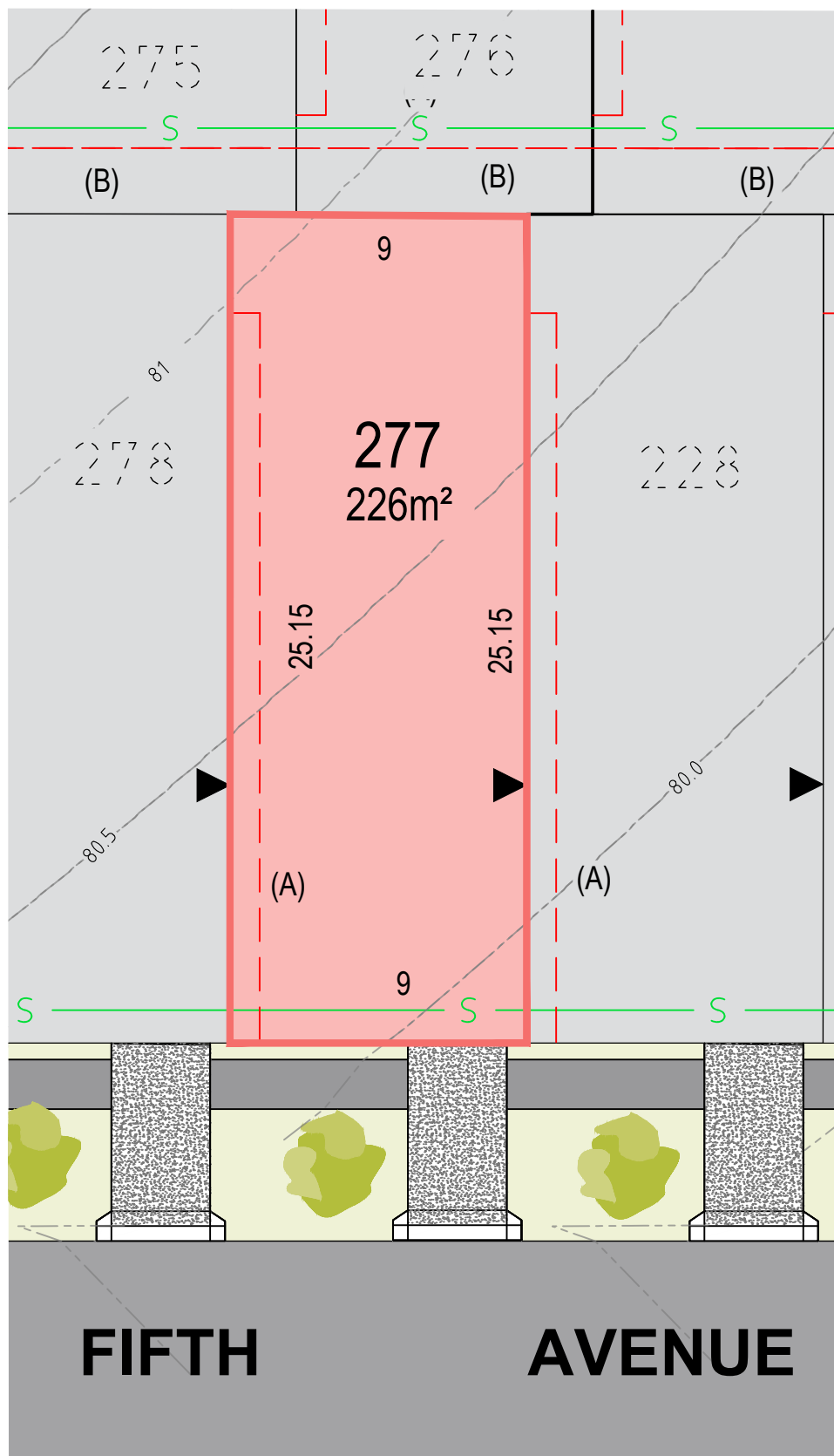

**RAWSON  
COMMUNITIES**  
Aspect - Austral

**Lot 277**

Disclaimer: This lot plan is indicative only.  
Purchasers must rely on their own enquiries, the contract for sale of land and the building contract.  
Dimensions, contours and areas are subject to final survey and Council approval.  
Easements, sewer and street tree locations are indicative and are subject to change.  
Information shown is accurate as of 16 October 2019.

**LEGEND:**

- (A) --- EASEMENT FOR ACCESS AND MAINTENANCE 0.9 WIDE
- (B) --- EASEMENT FOR DRAINAGE OF WATER 1.5 WIDE
- S --- SEWER
- 35 --- FINISHED SURFACE CONTOURS
- ▶ DENOTES ZERO LOT LINE
- STREET TREES

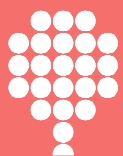
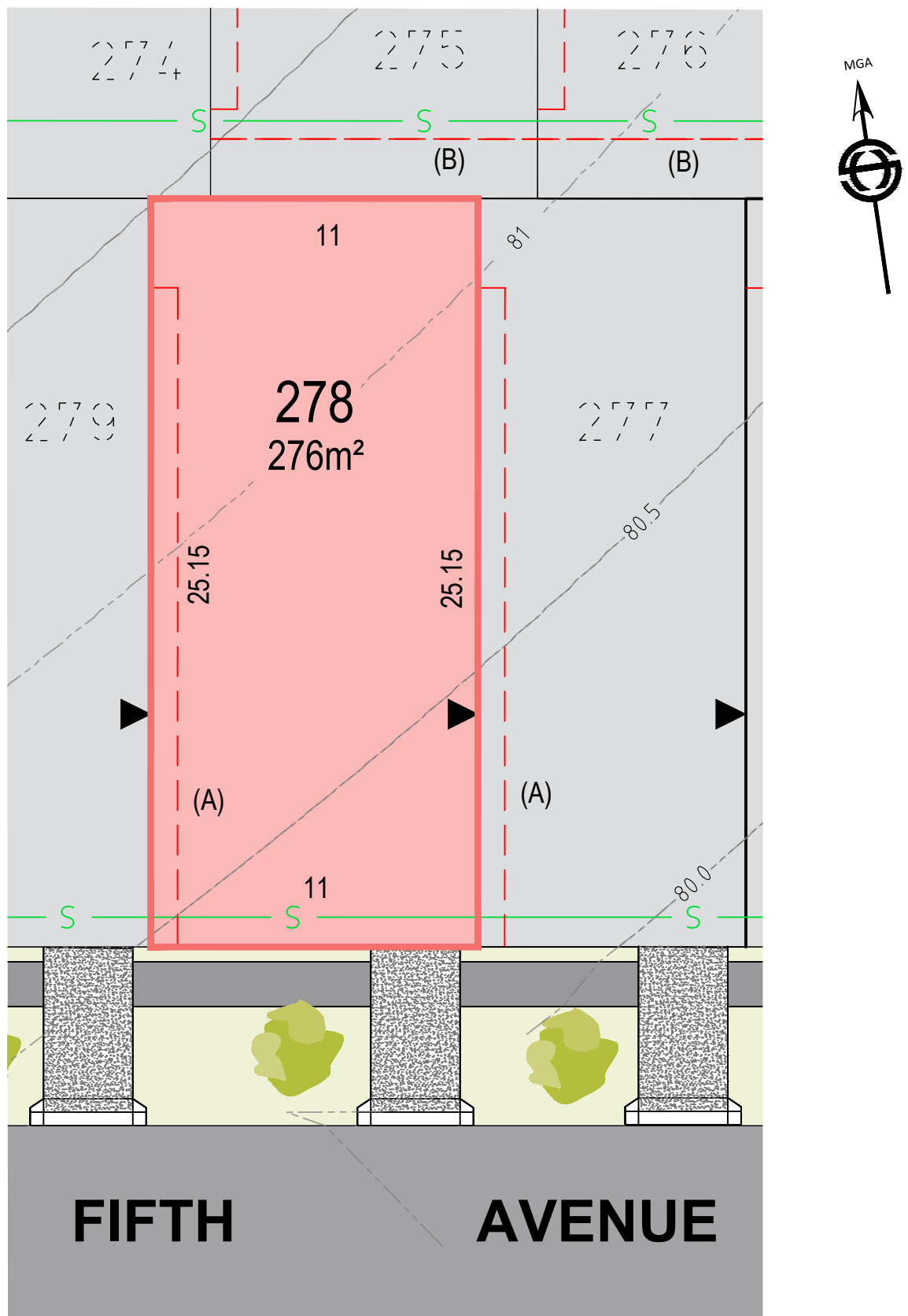

**RAWSON  
COMMUNITIES**  
Aspect - Austral

## Lot 278

Disclaimer: This lot plan is indicative only.  
Purchasers must rely on their own enquiries, the contract for sale of land and the building contract.  
Dimensions, contours and areas are subject to final survey and Council approval.  
Easements, sewer and street tree locations are indicative and are subject to change.  
Information shown is accurate as of 16 October 2019.

### LEGEND:

- (A) --- EASEMENT FOR ACCESS AND MAINTENANCE 0.9 WIDE
- (B) --- EASEMENT FOR DRAINAGE OF WATER 1.5 WIDE
- S— SEWER
- 35 --- FINISHED SURFACE CONTOURS
- ▶ DENOTES ZERO LOT LINE
- STREET TREES

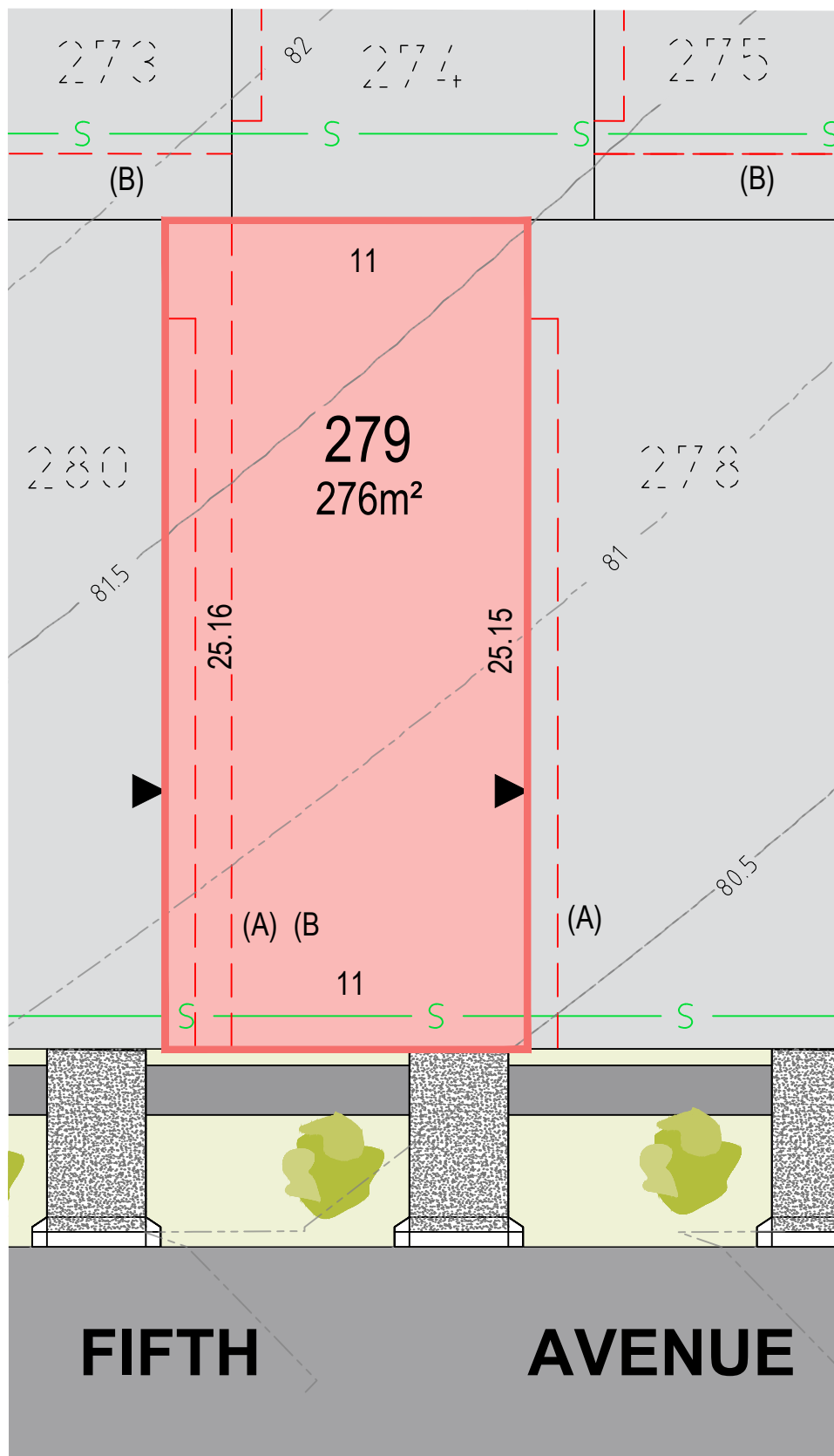

**RAWSON  
COMMUNITIES**  
Aspect - Austral

## Lot 279

Disclaimer: This lot plan is indicative only.  
Purchasers must rely on their own enquiries, the contract for sale of land and the building contract.  
Dimensions, contours and areas are subject to final survey and Council approval.  
Easements, sewer and street tree locations are indicative and are subject to change.  
Information shown is accurate as of 16 October 2019.

### LEGEND:

- (A) --- EASEMENT FOR ACCESS AND MAINTENANCE 0.9 WIDE
- (B) --- EASEMENT FOR DRAINAGE OF WATER 1.5 WIDE
- S— SEWER
- 35 --- FINISHED SURFACE CONTOURS
- ▶ DENOTES ZERO LOT LINE
- STREET TREES

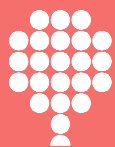
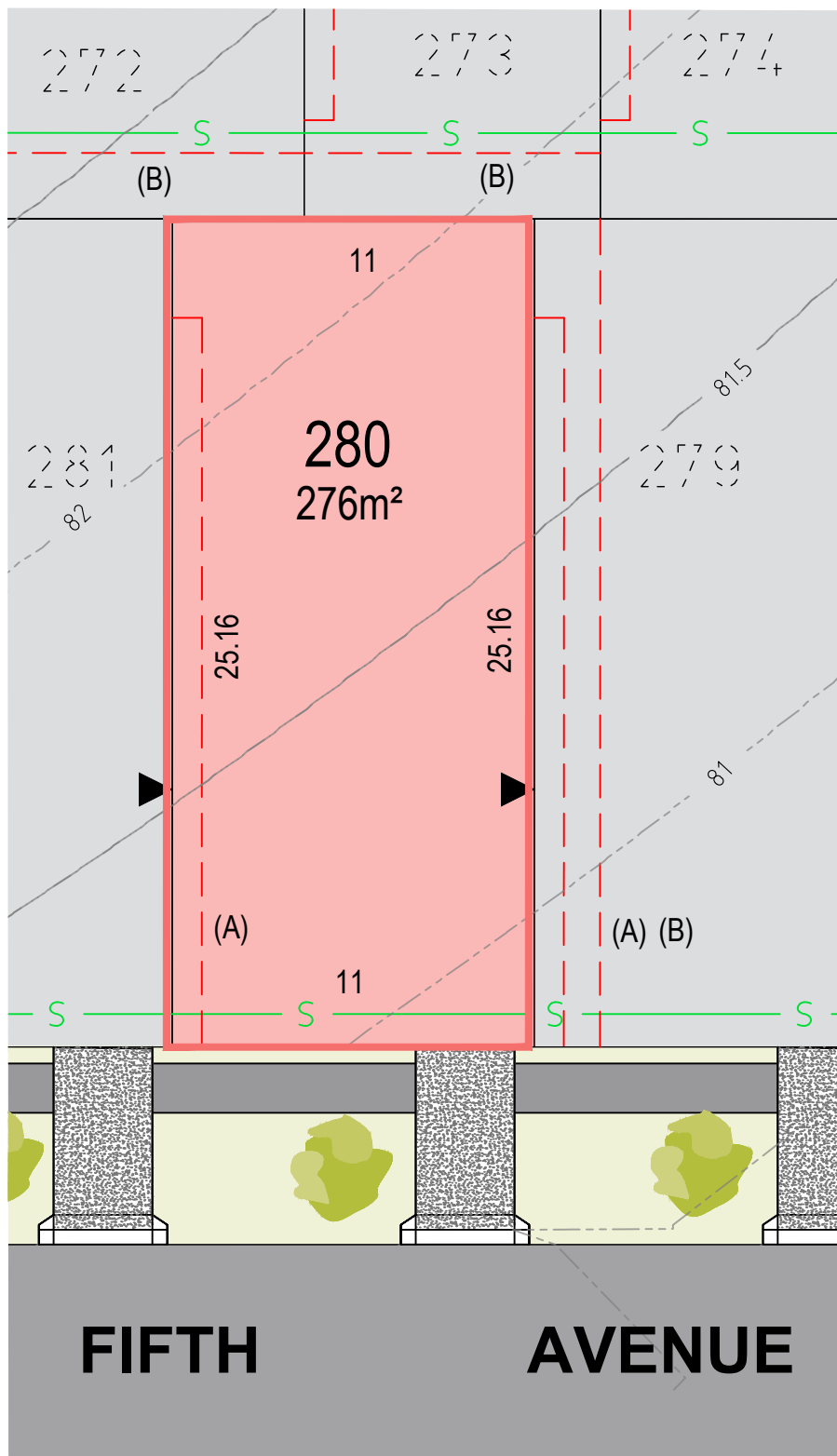

**RAWSON  
COMMUNITIES**  
Aspect - Austral

## Lot 280

Disclaimer: This lot plan is indicative only.  
Purchasers must rely on their own enquiries, the contract for sale of land and the building contract.  
Dimensions, contours and areas are subject to final survey and Council approval.  
Easements, sewer and street tree locations are indicative and are subject to change.  
Information shown is accurate as of 16 October 2019.

### LEGEND:

- (A) — EASEMENT FOR ACCESS AND MAINTENANCE 0.9 WIDE
- (B) — EASEMENT FOR DRAINAGE OF WATER 1.5 WIDE
- S — SEWER
- 35 — FINISHED SURFACE CONTOURS
- ▲ DENOTES ZERO LOT LINE
- STREET TREES



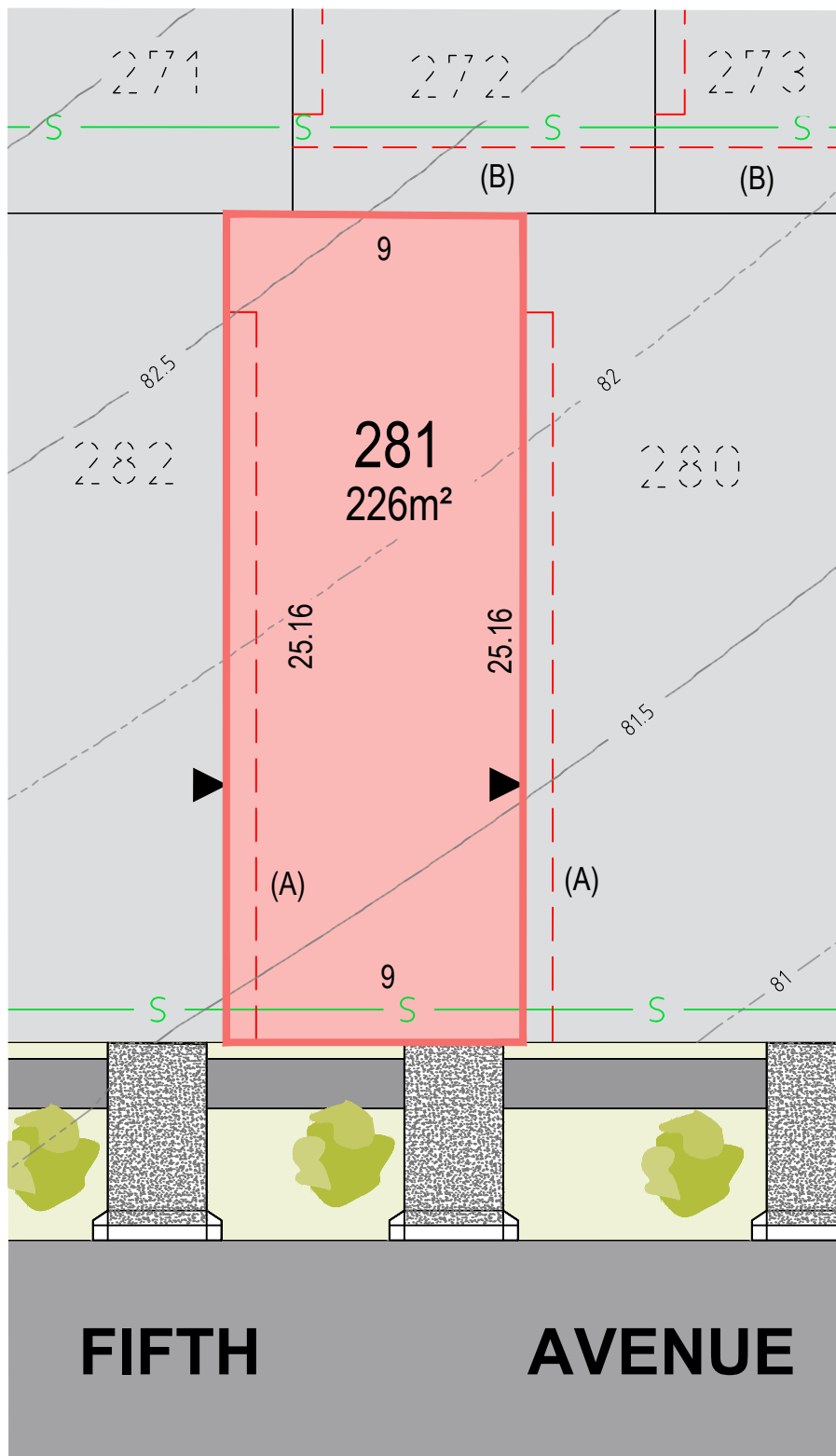

**RAWSON  
COMMUNITIES**  
Aspect - Austral

## Lot 281

Disclaimer: This lot plan is indicative only.  
Purchasers must rely on their own enquiries, the contract for sale of land and the building contract.  
Dimensions, contours and areas are subject to final survey and Council approval.  
Easements, sewer and street tree locations are indicative and are subject to change.  
Information shown is accurate as of 16 October 2019.

### LEGEND:

- (A) — EASEMENT FOR ACCESS AND MAINTENANCE 0.9 WIDE
- (B) — EASEMENT FOR DRAINAGE OF WATER 1.5 WIDE
- S — SEWER
- 35 — FINISHED SURFACE CONTOURS
- ▲ DENOTES ZERO LOT LINE
- STREET TREES

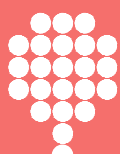
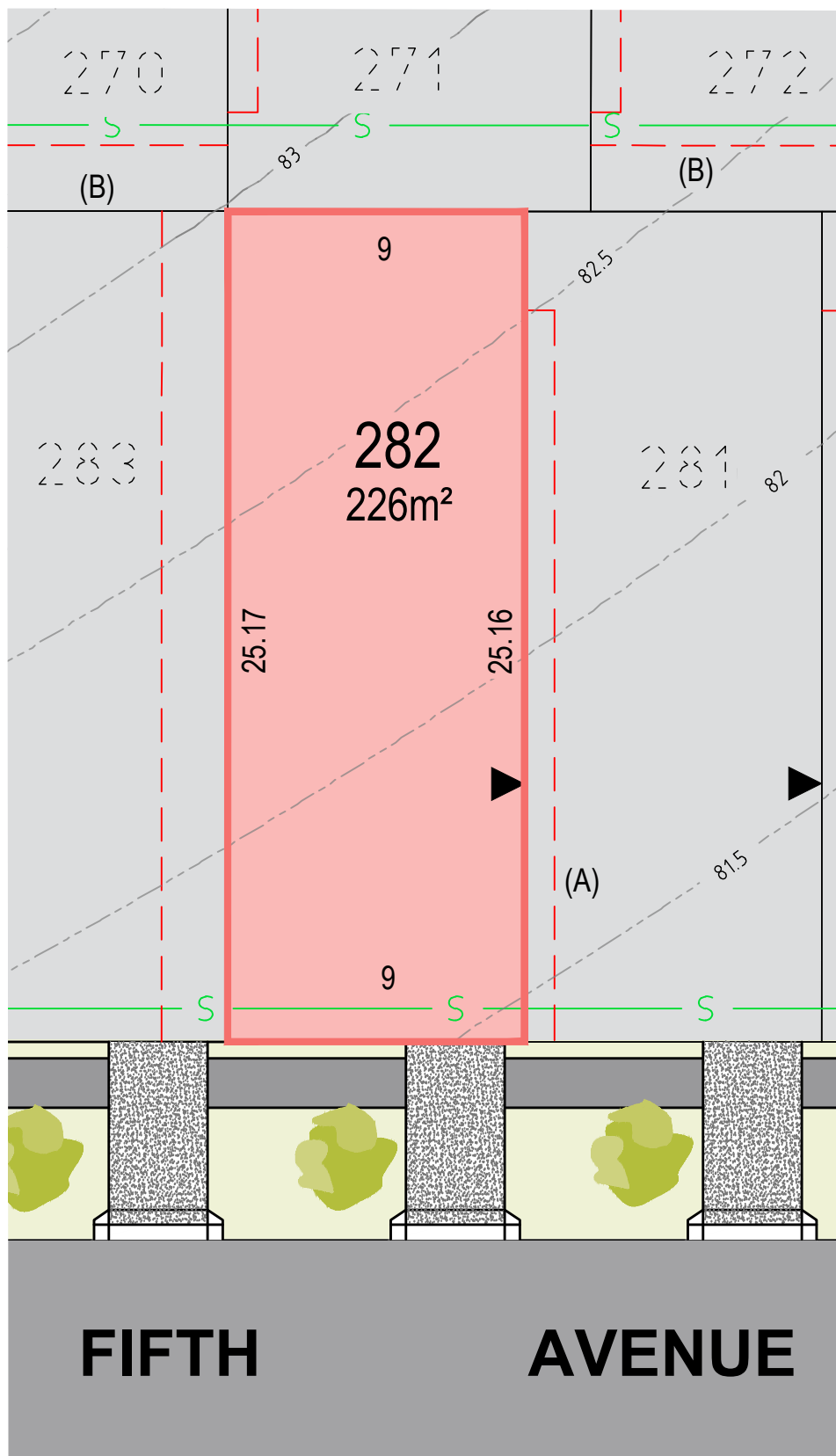

**RAWSON  
COMMUNITIES**  
Aspect - Austral

**Lot 282**

Disclaimer: This lot plan is indicative only.  
Purchasers must rely on their own enquiries, the contract for sale of land and the building contract.  
Dimensions, contours and areas are subject to final survey and Council approval.  
Easements, sewer and street tree locations are indicative and are subject to change.  
Information shown is accurate as of 8th January 2020

**LEGEND:**

- (A) --- EASEMENT FOR ACCESS AND MAINTENANCE 0.9 WIDE
- (B) --- EASEMENT FOR DRAINAGE OF WATER 1.5 WIDE
- S— SEWER
- 35 --- FINISHED SURFACE CONTOURS
- ▶ DENOTES ZERO LOT LINE
- STREET TREES

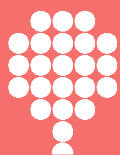
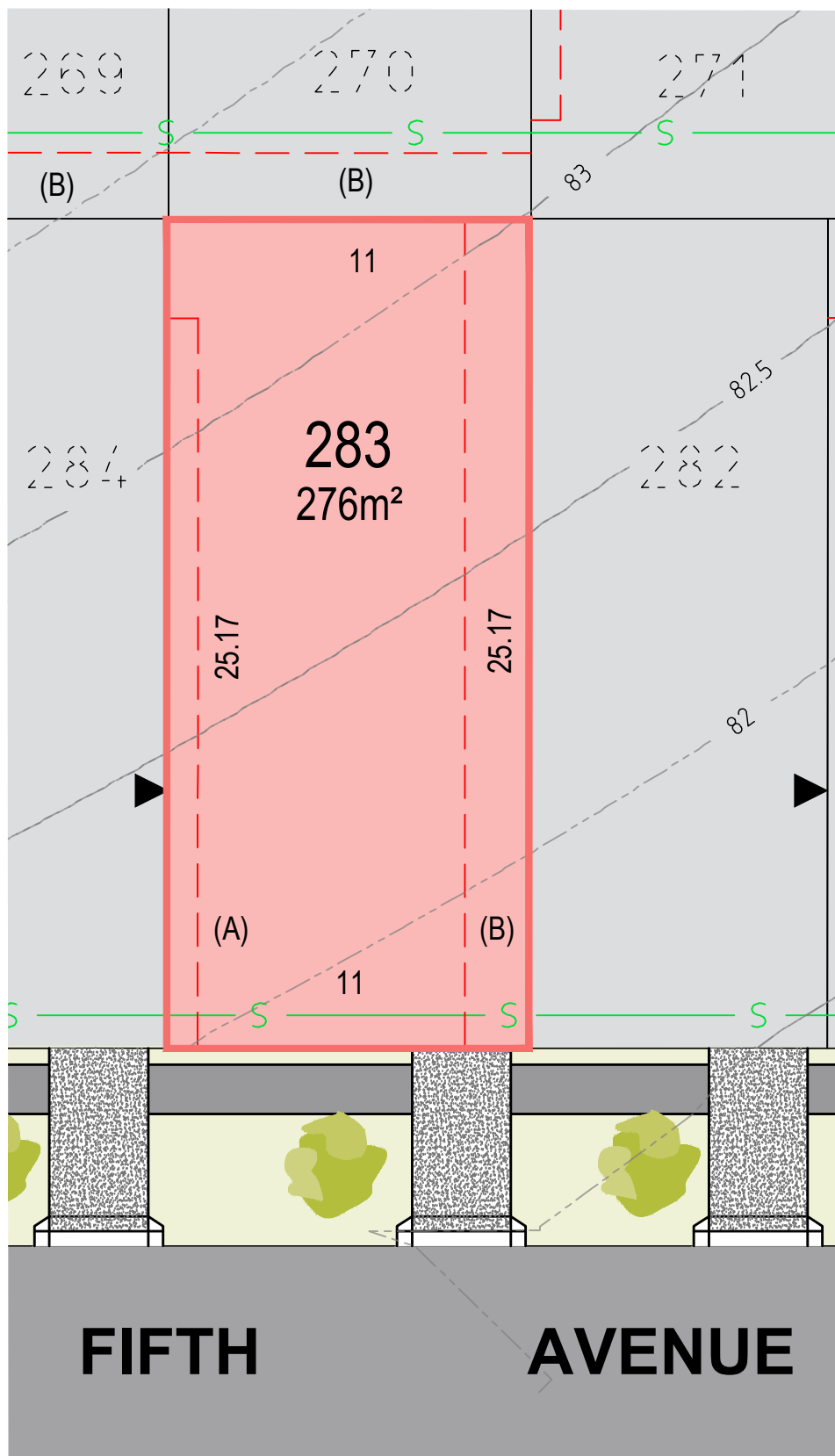

**RAWSON  
COMMUNITIES**  
Aspect - Austral

**Lot 283**

Disclaimer: This lot plan is indicative only.  
Purchasers must rely on their own enquiries, the contract for sale of land and the building contract.  
Dimensions, contours and areas are subject to final survey and Council approval.  
Easements, sewer and street tree locations are indicative and are subject to change.  
Information shown is accurate as of 8th January 2020.

**LEGEND:**

- (A) EASEMENT FOR ACCESS AND MAINTENANCE 0.9 WIDE
- (B) EASEMENT FOR DRAINAGE OF WATER 1.5 WIDE
- S SEWER
- 35 FINISHED SURFACE CONTOURS
- ▶ DENOTES ZERO LOT LINE
- STREET TREES

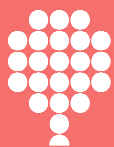
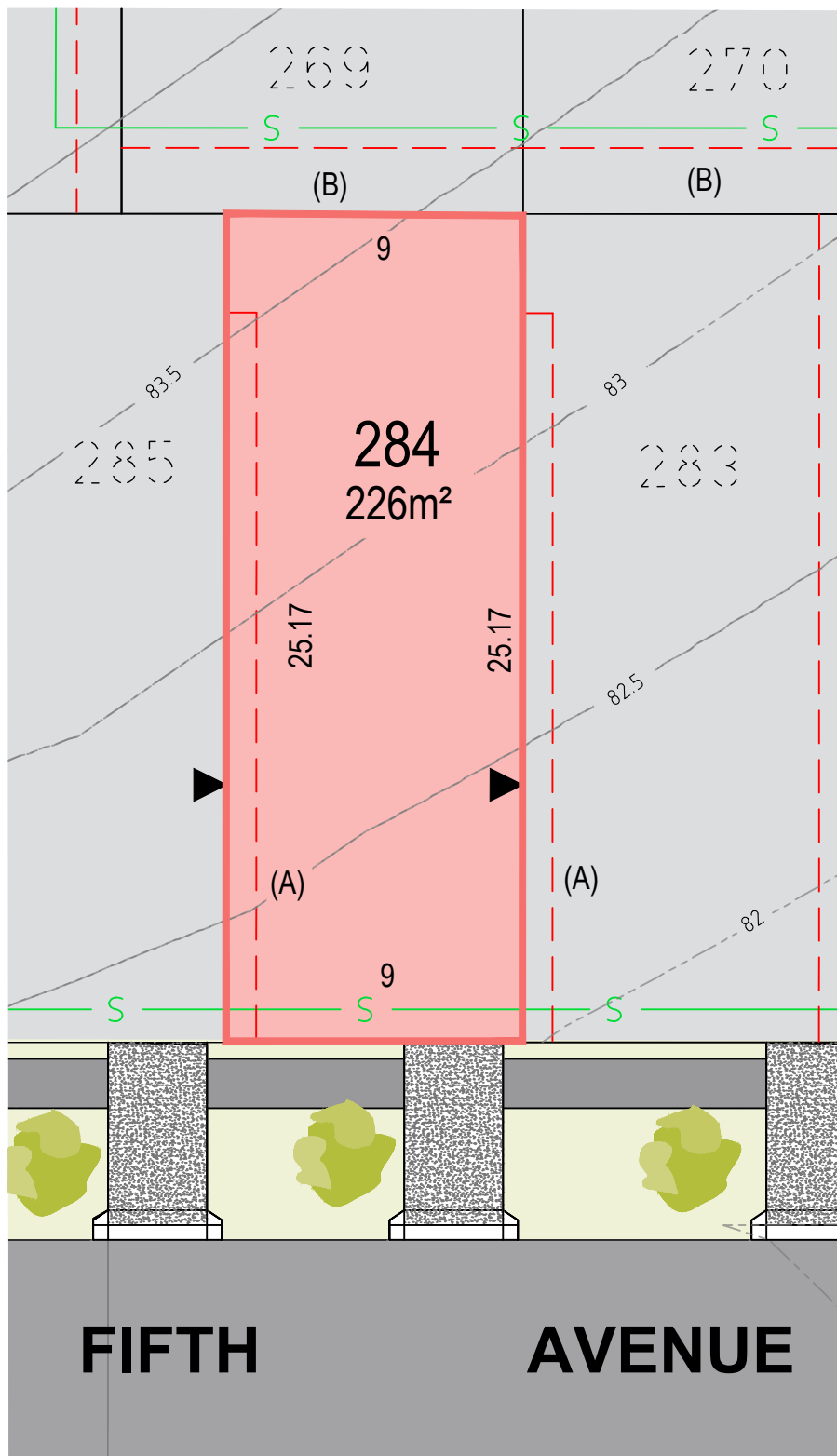

**RAWSON  
COMMUNITIES**  
Aspect - Austral

## Lot 284

Disclaimer: This lot plan is indicative only.  
Purchasers must rely on their own enquiries, the contract for sale of land and the building contract.  
Dimensions, contours and areas are subject to final survey and Council approval.  
Easements, sewer and street tree locations are indicative and are subject to change.  
Information shown is accurate as of 16 October 2019.

### LEGEND:

- (A) — EASEMENT FOR ACCESS AND MAINTENANCE 0.9 WIDE
- (B) — EASEMENT FOR DRAINAGE OF WATER 1.5 WIDE
- S — SEWER
- 35 — FINISHED SURFACE CONTOURS
- ▶ DENOTES ZERO LOT LINE
- 🌳 STREET TREES

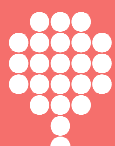
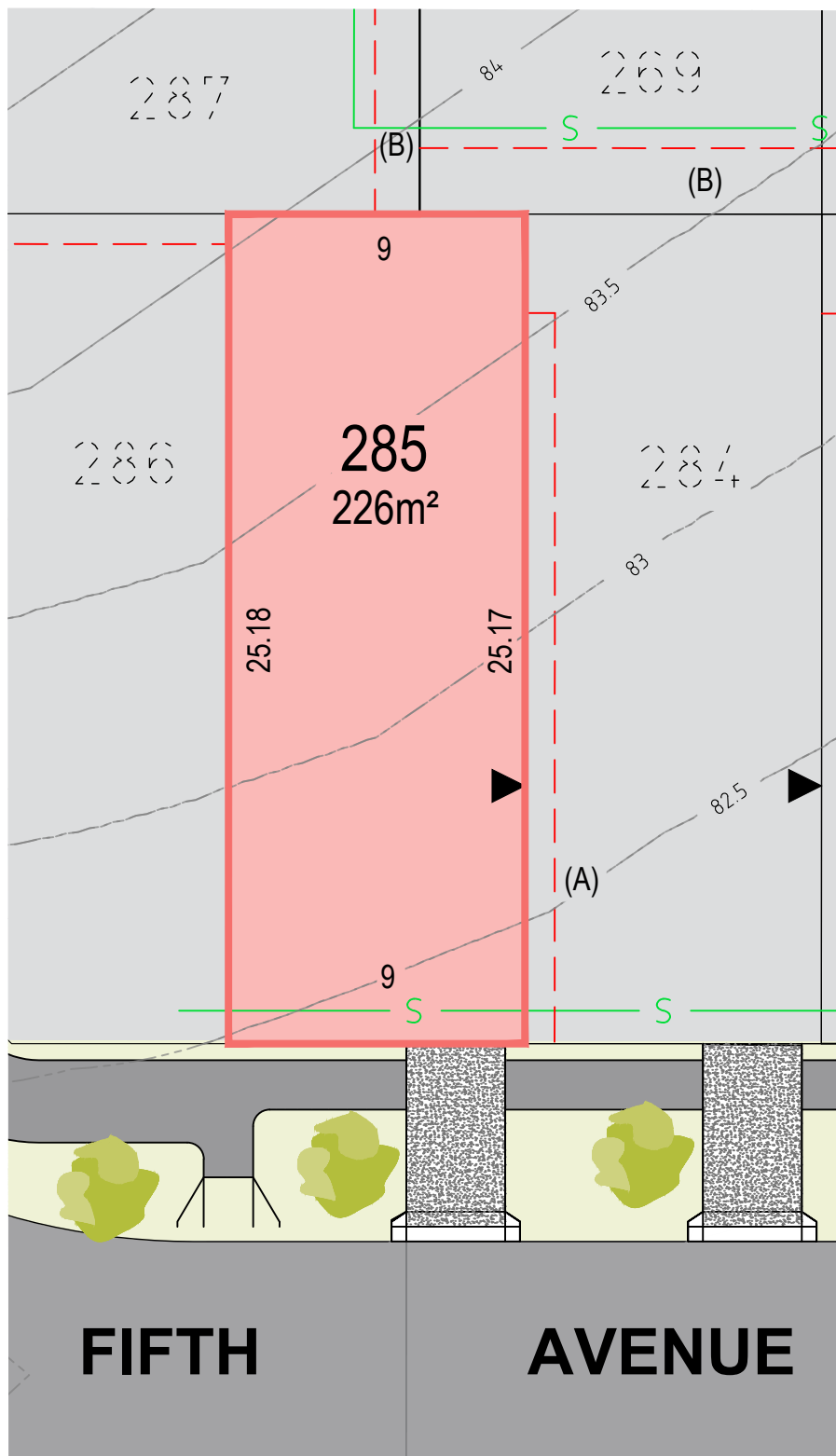

**RAWSON  
COMMUNITIES**  
Aspect - Austral

## Lot 285

Disclaimer: This lot plan is indicative only.  
Purchasers must rely on their own enquiries, the contract for sale of land and the building contract.  
Dimensions, contours and areas are subject to final survey and Council approval.  
Easements, sewer and street tree locations are indicative and are subject to change.  
Information shown is accurate as of 16 October 2019.

### LEGEND:

- (A) — EASEMENT FOR ACCESS AND MAINTENANCE 0.9 WIDE
- (B) — EASEMENT FOR DRAINAGE OF WATER 1.5 WIDE
- S — SEWER
- 35 — FINISHED SURFACE CONTOURS
- ▲ DENOTES ZERO LOT LINE
- STREET TREES