

Lot 105

Staten-Charlton

Type B1_C



Living (Ground Floor)	64.48 m2
Living (First Floor)	71.93 m2
Balcony	3.05 m2
Patio	8.41 m2
Porch	1.48 m2
Garage	37.08 m2
TOTAL	186.43 m2

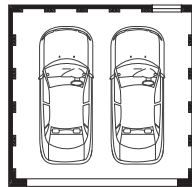

garage
(rear - loaded)



front facade



ground floor

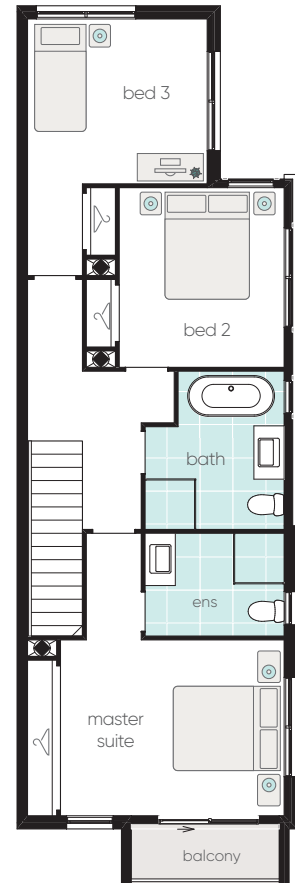

first floor