

NOTE: ALL EASEMENTS INDICATED HEREON ARE SUBJECT TO DEVELOPMENT APPROVAL AND ENGINEERING DESIGN; THEIR LOCATION AND EXTENT IS SUBJECT TO CHANGE. ADDITIONAL EASEMENTS AND/OR RESTRICTIONS MAY BE REQUIRED TO FACILITATE SUBDIVISION.

- (A) EASEMENT FOR ACCESS AND MAINTENANCE 0.9 WIDE
- (B) EASEMENT FOR DRAINAGE OF WATER 1.5 WIDE
- (C) EASEMENT FOR DRAINAGE OF WATER 2 WIDE
- (D) EASEMENT FOR ACCESS AND MAINTENANCE 0.9 WIDE
- (E) EASEMENT FOR FOOTINGS AND SUPPORT OF RETAINING WALL 0.5 WIDE

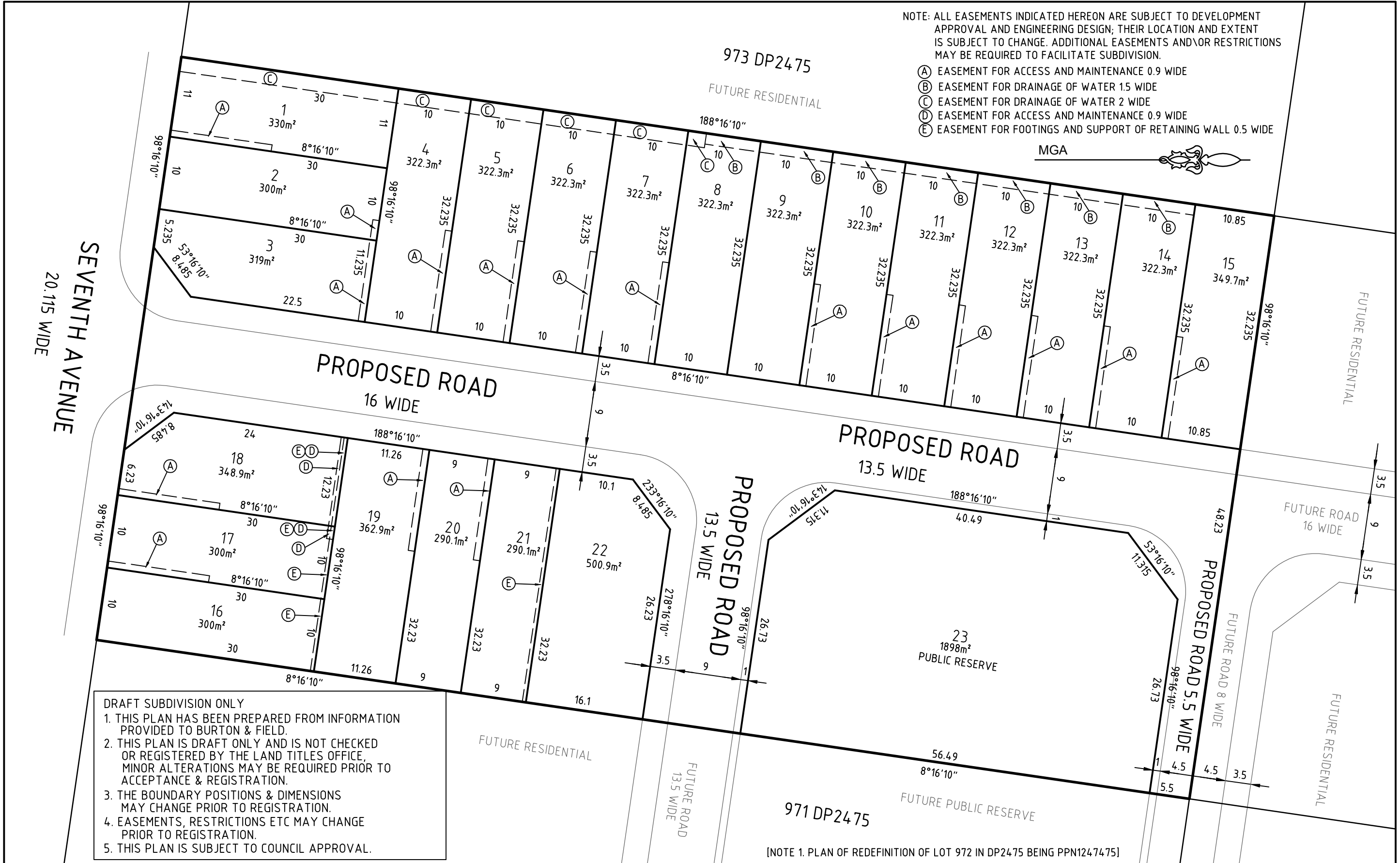
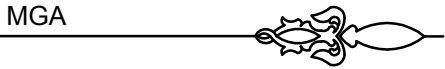

DRAFT SUBDIVISION ONLY

1. THIS PLAN HAS BEEN PREPARED FROM INFORMATION PROVIDED TO BURTON & FIELD.
2. THIS PLAN IS DRAFT ONLY AND IS NOT CHECKED OR REGISTERED BY THE LAND TITLES OFFICE. MINOR ALTERATIONS MAY BE REQUIRED PRIOR TO ACCEPTANCE & REGISTRATION.
3. THE BOUNDARY POSITIONS & DIMENSIONS MAY CHANGE PRIOR TO REGISTRATION.
4. EASEMENTS, RESTRICTIONS ETC MAY CHANGE PRIOR TO REGISTRATION.
5. THIS PLAN IS SUBJECT TO COUNCIL APPROVAL.

CAUTION:  
INFORMATION CONTAINED IN THIS PLAN IS THE COPYRIGHT OF BURTON AND FIELD PTY LIMITED. THE USE, DUPLICATION (WHETHER IN PART OR FULL) WITHOUT CONSENT OF BURTON AND FIELD PTY LIMITED CONSTITUTES AN INFRINGEMENT OF COPYRIGHT.

*"Liability limited by a scheme approved under Professional Standards Legislation"*

**BURTON & FIELD**  
surveying & land development

All Correspondence to:  
343 Hume Highway, Liverpool NSW 2170.  
P.O.Box 242 Liverpool NSW 1871.  
Tel: (02) 9602-1199 Fax: (02) 9821-2620  
Email: survey@burtonandfield.com.au

Suite 202, 2 Pembroke Street, Epping NSW 2151  
P.O.Box 1150 Epping NSW 1710  
Tel: (02) 9868-4660 Fax: (02) 9868-6035  
E-mail: epping.reception@burtonandfield.com.au  
Web: www.burtonandfield.com.au

PROJECT:  
**PLAN OF PROPOSED SUBDIVISION  
OVER LOT 972 IN DP2475  
AT SEVENTH AVENUE, AUSTRAL**

LGA: LIVERPOOL

COMP REF: J:\77608\...\77608-PS

REVISION		
I	050419 LOTS 7, 8, 9, 14 & 15 REVISED	
H	110319 UPDATE EASEMENTS, LOT NO	
G	070319 UPDATE EASEMENTS	
CLIENT: BURAQ AFFORDABLE HOMES		
DATE: 02/02/18	SCALE: 1:500	SHEET
REF: S2861\77608\GG	DATUM: AHD	1 of 1