

### Legend

- WATER
- SEWER MAIN & ACCESS POINT
- ELECTRICITY
- STORMWATER & PITS
- NBN
- RETAINING WALLS

- ZERO LOT EASEMENT
- BUILDING SETBACK (D.C.P.)
- EASEMENT FOR DRAINAGE & SERVICES
- SUBSTATION & SETBACKS
- (E1) EASEMENT TO DRAIN WATER 2.0 WIDE
- (E5) EASEMENT FOR ACCESS & MAINTENANCE 0.9 WIDE
- (E9) EASEMENT TO DRAIN WATER 1.5 WIDE

- (E11) EASEMENT TO DRAIN WATER 2 WIDE (D.P.1229231)
- (E51) EASEMENT FOR ACCESS AND MAINTENANCE 0.9 WIDE (D.P.1229231), (D.P.1201629)
- (R11) RESTRICTION ON THE USE OF LAND D.P.1229230 / D.P.1229231
- (R12) RESTRICTION ON THE USE OF LAND D.P.1229230 / D.P.1229231
- (R21) RESTRICTION ON THE USE OF LAND D.P.1229230 / D.P.1229231
- 'C' BENEFIT BY EASEMENT TO DRAIN WATER 2 WIDE (E1)
- 'E' BENEFIT BY EASEMENT FOR ACCESS & MAINTENANCE 0.9 WIDE



This plan is provided solely for the purpose of providing an impression of the concept relating to the proposed development called 'Caddens Hill', as well as the approximate location of existing and proposed third party facilities, services or destinations, and is not intended to be used for any other purpose. Legacy Group does not make any representation or give any warranty in relation to the future development of the site, the staging of any future development or the current or future location or existence of any facilities, services or destinations. The plan is based on the present intention of, and information available to, Legacy Group and the current known requirements of relevant authorities at the time of creation of the plan and details may change due to future circumstances. Any indications of distance or size are approximate and for indicative purposes only, and are not to scale. The plan and any matters shown on or inferred from it do not give rise to a legally binding obligation on or representation or warranty by Legacy Group. Legacy Group accepts no liability for any loss or damage arising as a result of any reliance on this plan or its contents.

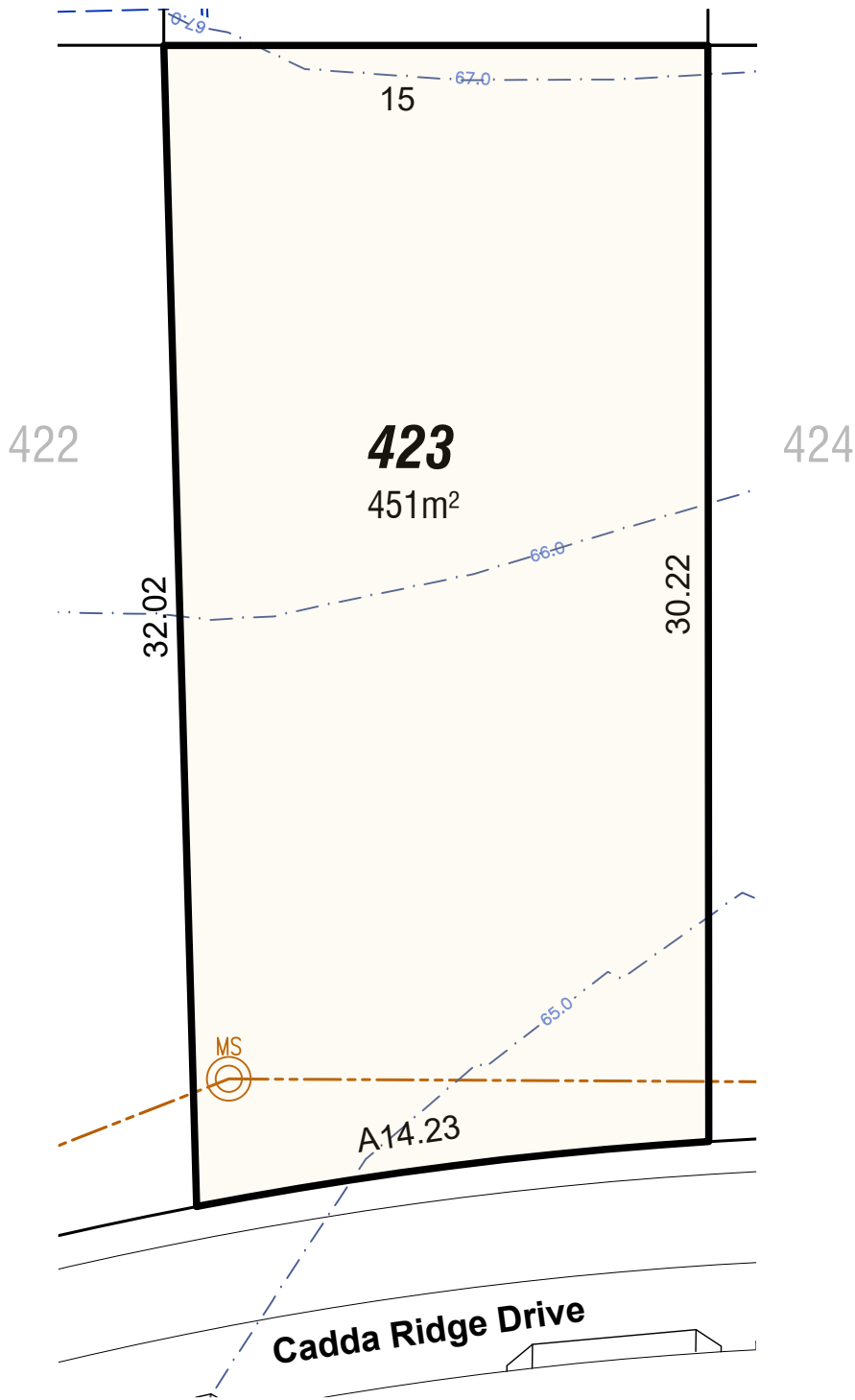

### Legend

- WATER
- SEWER MAIN & ACCESS POINT
- ELECTRICITY
- STORMWATER & PITS
- NBN
- RETAINING WALLS

- ZERO LOT EASEMENT
- BUILDING SETBACK (D.C.P.)
- EASEMENT FOR DRAINAGE & SERVICES
- SUBSTATION & SETBACKS
- (E1) EASEMENT TO DRAIN WATER 2.0 WIDE
- (E5) EASEMENT FOR ACCESS & MAINTENANCE 0.9 WIDE
- (E9) EASEMENT TO DRAIN WATER 1.5 WIDE

- (E11) EASEMENT TO DRAIN WATER 2 WIDE (D.P.1229231)
- (E51) EASEMENT FOR ACCESS AND MAINTENANCE 0.9 WIDE (D.P.1229231), (D.P.1201629)
- (R11) RESTRICTION ON THE USE OF LAND D.P.1229230 / D.P.1229231
- (R12) RESTRICTION ON THE USE OF LAND D.P.1229230 / D.P.1229231
- (R21) RESTRICTION ON THE USE OF LAND D.P.1229230 / D.P.1229231
- 'C' BENEFIT BY EASEMENT TO DRAIN WATER 2 WIDE (E1)
- 'E' BENEFIT BY EASEMENT FOR ACCESS & MAINTENANCE 0.9 WIDE



This plan is provided solely for the purpose of providing an impression of the concept relating to the proposed development called 'Caddens Hill', as well as the approximate location of existing and proposed third party facilities, services or destinations, and is not intended to be used for any other purpose. Legacy Group does not make any representation or give any warranty in relation to the future development of the site, the staging of any future development or the current or future location or existence of any facilities, services or destinations. The plan is based on the present intention of, and information available to, Legacy Group and the current known requirements of relevant authorities at the time of creation of the plan and details may change due to future circumstances. Any indications of distance or size are approximate and for indicative purposes only, and are not to scale. The plan and any matters shown on or inferred from it do not give rise to a legally binding obligation on or representation or warranty by Legacy Group. Legacy Group accepts no liability for any loss or damage arising as a result of any reliance on this plan or its contents.

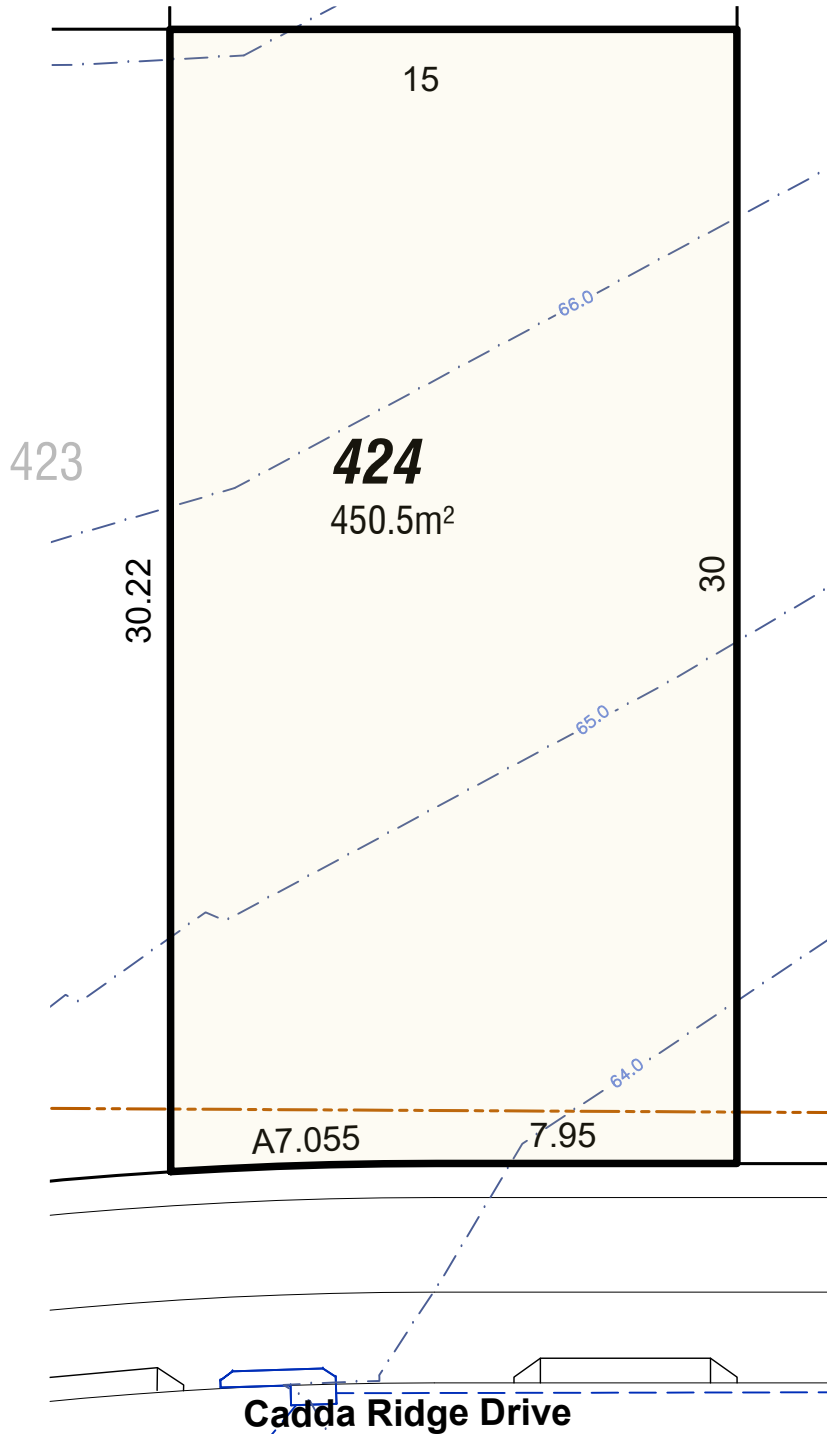

### Legend

- WATER
- SEWER MAIN & ACCESS POINT
- ELECTRICITY
- STORMWATER & PITS
- NBN
- RETAINING WALLS

- ZERO LOT EASEMENT
- BUILDING SETBACK (D.C.P.)
- EASEMENT FOR DRAINAGE & SERVICES
- SUBSTATION & SETBACKS
- (E1) EASEMENT TO DRAIN WATER 2.0 WIDE
- (E5) EASEMENT FOR ACCESS & MAINTENANCE 0.9 WIDE
- (E9) EASEMENT TO DRAIN WATER 1.5 WIDE

- (E11) EASEMENT TO DRAIN WATER 2 WIDE (D.P.1229231)
- (E51) EASEMENT FOR ACCESS AND MAINTENANCE 0.9 WIDE (D.P.1229231), (D.P.1201629)
- (R11) RESTRICTION ON THE USE OF LAND D.P.1229230 / D.P.1229231
- (R12) RESTRICTION ON THE USE OF LAND D.P.1229230 / D.P.1229231
- (R21) RESTRICTION ON THE USE OF LAND D.P.1229230 / D.P.1229231
- 'C' BENEFIT BY EASEMENT TO DRAIN WATER 2 WIDE (E1)
- 'E' BENEFIT BY EASEMENT FOR ACCESS & MAINTENANCE 0.9 WIDE



This plan is provided solely for the purpose of providing an impression of the concept relating to the proposed development called 'Caddens Hill', as well as the approximate location of existing and proposed third party facilities, services or destinations, and is not intended to be used for any other purpose. Legacy Group does not make any representation or give any warranty in relation to the future development of the site, the staging of any future development or the current or future location or existence of any facilities, services or destinations. The plan is based on the present intention of, and information available to, Legacy Group and the current known requirements of relevant authorities at the time of creation of the plan and details may change due to future circumstances. Any indications of distance or size are approximate and for indicative purposes only, and are not to scale. The plan and any matters shown on or inferred from it do not give rise to a legally binding obligation on or representation or warranty by Legacy Group. Legacy Group accepts no liability for any loss or damage arising as a result of any reliance on this plan or its contents.

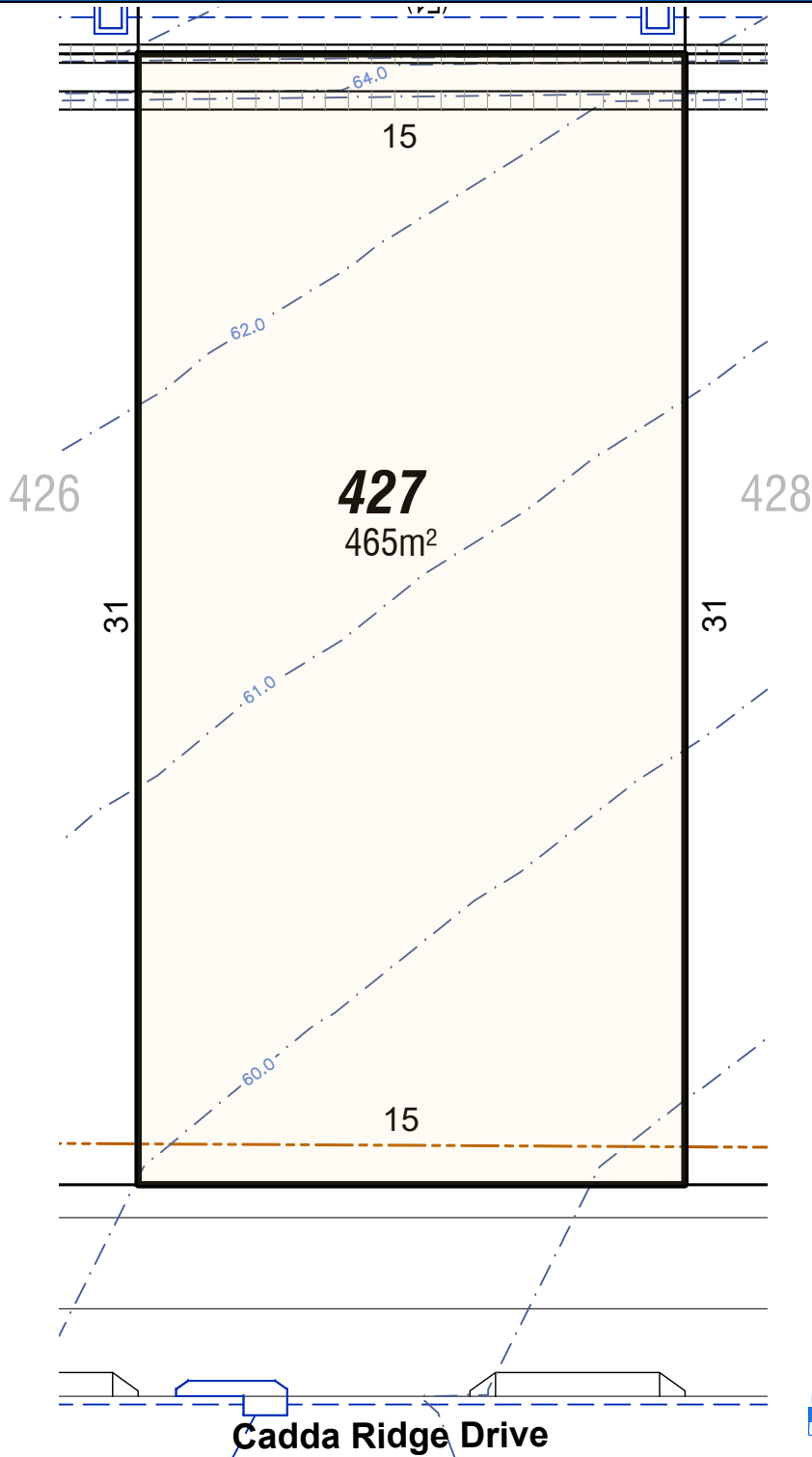

### Legend

- WATER
- SEWER MAIN & ACCESS POINT
- ELECTRICITY
- STORMWATER & PITS
- NBN
- RETAINING WALLS

- ZERO LOT EASEMENT
- BUILDING SETBACK (D.C.P.)
- EASEMENT FOR DRAINAGE & SERVICES
- SUBSTATION & SETBACKS
- (E1) EASEMENT TO DRAIN WATER 2.0 WIDE
- (E5) EASEMENT FOR ACCESS & MAINTENANCE 0.9 WIDE
- (E9) EASEMENT TO DRAIN WATER 1.5 WIDE

- (E11) EASEMENT TO DRAIN WATER 2 WIDE (D.P.1229231)
- (E51) EASEMENT FOR ACCESS AND MAINTENANCE 0.9 WIDE (D.P.1229231), (D.P.1201629)
- (R11) RESTRICTION ON THE USE OF LAND D.P.1229230 / D.P.1229231
- (R12) RESTRICTION ON THE USE OF LAND D.P.1229230 / D.P.1229231
- (R21) RESTRICTION ON THE USE OF LAND D.P.1229230 / D.P.1229231
- 'C' BENEFIT BY EASEMENT TO DRAIN WATER 2 WIDE (E1)
- 'E' BENEFIT BY EASEMENT FOR ACCESS & MAINTENANCE 0.9 WIDE



This plan is provided solely for the purpose of providing an impression of the concept relating to the proposed development called 'Caddens Hill', as well as the approximate location of existing and proposed third party facilities, services or destinations, and is not intended to be used for any other purpose. Legacy Group does not make any representation or give any warranty in relation to the future development of the site, the staging of any future development or the current or future location or existence of any facilities, services or destinations. The plan is based on the present intention of, and information available to, Legacy Group and the current known requirements of relevant authorities at the time of creation of the plan and details may change due to future circumstances. Any indications of distance or size are approximate and for indicative purposes only, and are not to scale. The plan and any matters shown on or inferred from it do not give rise to a legally binding obligation on or representation or warranty by Legacy Group. Legacy Group accepts no liability for any loss or damage arising as a result of any reliance on this plan or its contents.

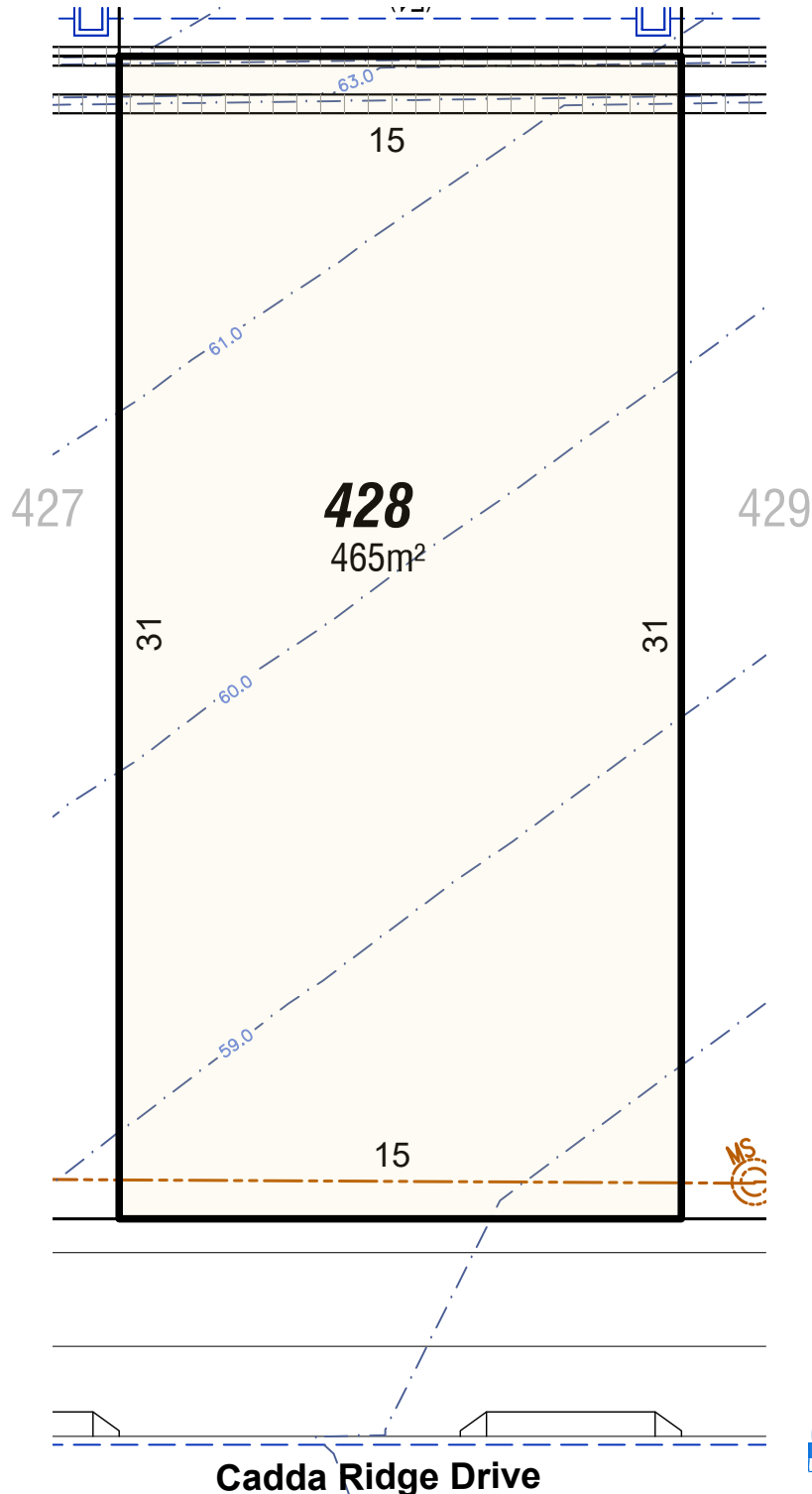

### Legend

- WATER
- SEWER MAIN & ACCESS POINT
- ELECTRICITY
- STORMWATER & PITS
- NBN
- RETAINING WALLS

- ZERO LOT EASEMENT
- BUILDING SETBACK (D.C.P.)
- EASEMENT FOR DRAINAGE & SERVICES
- SUBSTATION & SETBACKS
- (E1) EASEMENT TO DRAIN WATER 2.0 WIDE
- (E5) EASEMENT FOR ACCESS & MAINTENANCE 0.9 WIDE
- (E9) EASEMENT TO DRAIN WATER 1.5 WIDE

- (E11) EASEMENT TO DRAIN WATER 2 WIDE (D.P.1229231)
- (E51) EASEMENT FOR ACCESS AND MAINTENANCE 0.9 WIDE (D.P.1229231), (D.P.1201629)
- (R11) RESTRICTION ON THE USE OF LAND D.P.1229230 / D.P.1229231
- (R12) RESTRICTION ON THE USE OF LAND D.P.1229230 / D.P.1229231
- (R21) RESTRICTION ON THE USE OF LAND D.P.1229230 / D.P.1229231
- 'C' BENEFIT BY EASEMENT TO DRAIN WATER 2 WIDE (E1)
- 'E' BENEFIT BY EASEMENT FOR ACCESS & MAINTENANCE 0.9 WIDE



This plan is provided solely for the purpose of providing an impression of the concept relating to the proposed development called 'Caddens Hill', as well as the approximate location of existing and proposed third party facilities, services or destinations, and is not intended to be used for any other purpose. Legacy Group does not make any representation or give any warranty in relation to the future development of the site, the staging of any future development or the current or future location or existence of any facilities, services or destinations. The plan is based on the present intention of, and information available to, Legacy Group and the current known requirements of relevant authorities at the time of creation of the plan and details may change due to future circumstances. Any indications of distance or size are approximate and for indicative purposes only, and are not to scale. The plan and any matters shown on or inferred from it do not give rise to a legally binding obligation on or representation or warranty by Legacy Group. Legacy Group accepts no liability for any loss or damage arising as a result of any reliance on this plan or its contents.

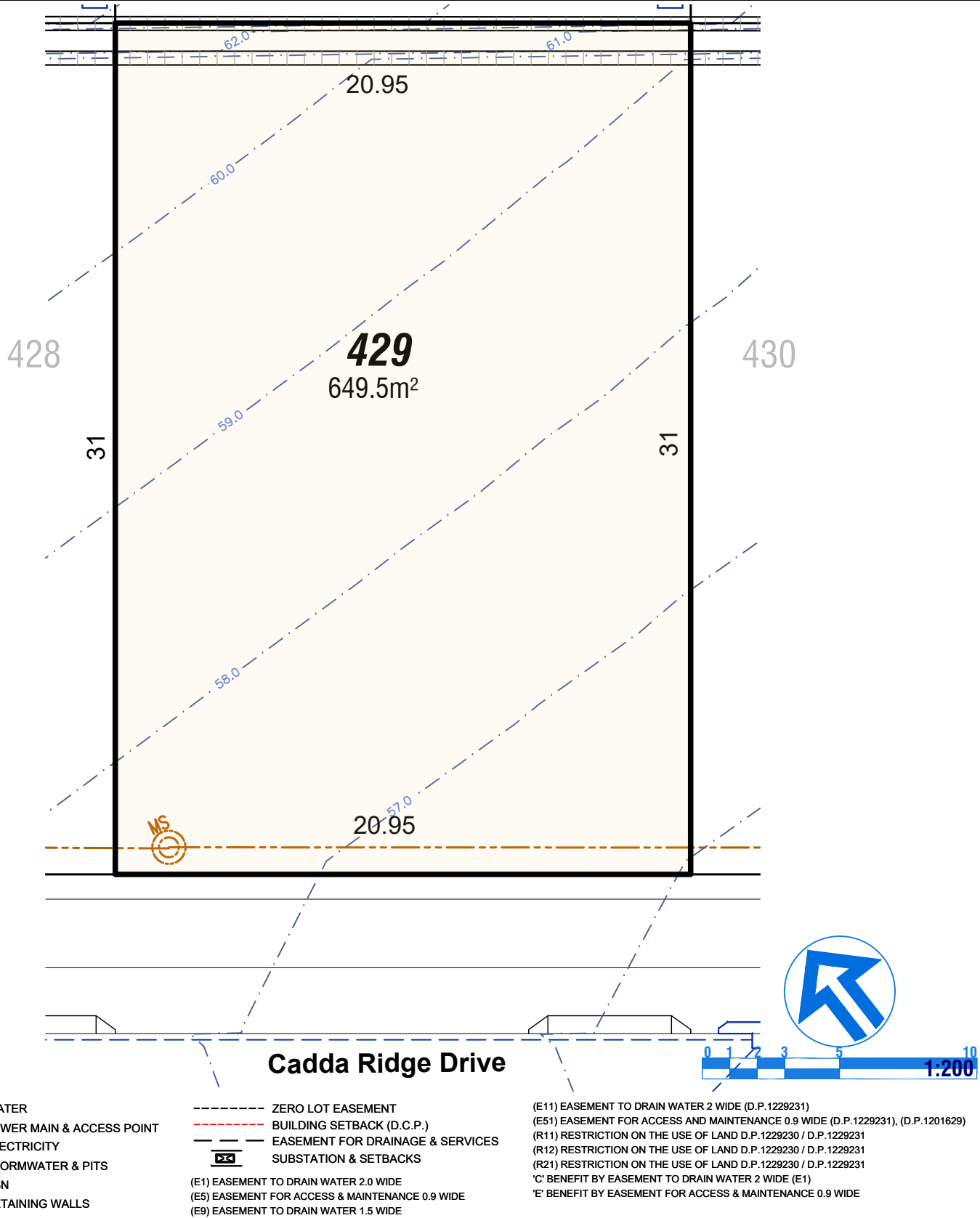

This plan is provided solely for the purpose of providing an impression of the concept relating to the proposed development called 'Caddens Hill', as well as the approximate location of existing and proposed third party facilities, services or destinations, and is not intended to be used for any other purpose. Legacy Group does not make any representation or give any warranty in relation to the future development of the site, the staging of any future development or the current or future location or existence of any facilities, services or destinations. The plan is based on the present intention of, and information available to, Legacy Group and the current known requirements of relevant authorities at the time of creation of the plan and details may change due to future circumstances. Any indications of distance or size are approximate and for indicative purposes only, and are not to scale. The plan and any matters shown on or inferred from it do not give rise to a legally binding obligation on or representation or warranty by Legacy Group. Legacy Group accepts no liability for any loss or damage arising as a result of any reliance on this plan or its contents.



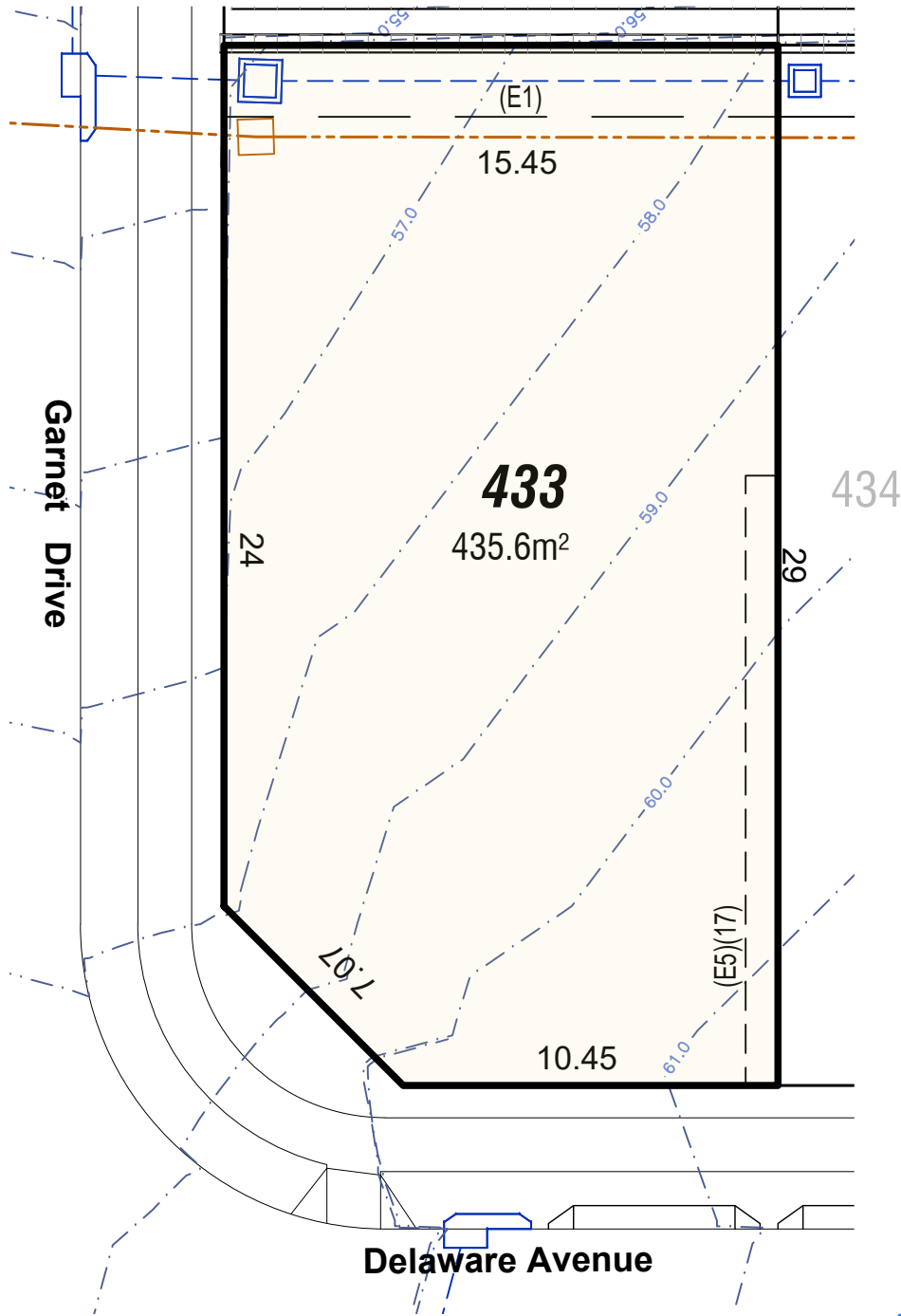

### Legend

- WATER
- SEWER MAIN & ACCESS POINT
- ELECTRICITY
- STORMWATER & PITS
- NBN
- RETAINING WALLS

- ZERO LOT EASEMENT
- BUILDING SETBACK (D.C.P.)
- EASEMENT FOR DRAINAGE & SERVICES
- SUBSTATION & SETBACKS

- (E1) EASEMENT TO DRAIN WATER 2.0 WIDE
- (E5) EASEMENT FOR ACCESS & MAINTENANCE 0.9 WIDE
- (E9) EASEMENT TO DRAIN WATER 1.5 WIDE

- (E11) EASEMENT TO DRAIN WATER 2 WIDE (D.P.1229231)
- (E51) EASEMENT FOR ACCESS AND MAINTENANCE 0.9 WIDE (D.P.1229231), (D.P.1201629)
- (R11) RESTRICTION ON THE USE OF LAND D.P.1229230 / D.P.1229231
- (R12) RESTRICTION ON THE USE OF LAND D.P.1229230 / D.P.1229231
- (R21) RESTRICTION ON THE USE OF LAND D.P.1229230 / D.P.1229231
- 'C' BENEFIT BY EASEMENT TO DRAIN WATER 2 WIDE (E1)
- 'E' BENEFIT BY EASEMENT FOR ACCESS & MAINTENANCE 0.9 WIDE



This plan is provided solely for the purpose of providing an impression of the concept relating to the proposed development called 'Caddens Hill', as well as the approximate location of existing and proposed third party facilities, services or destinations, and is not intended to be used for any other purpose. Legacy Group does not make any representation or give any warranty in relation to the future development of the site, the staging of any future development or the current or future location or existence of any facilities, services or destinations. The plan is based on the present intention of, and information available to, Legacy Group and the current known requirements of relevant authorities at the time of creation of the plan and details may change due to future circumstances. Any indications of distance or size are approximate and for indicative purposes only, and are not to scale. The plan and any matters shown on or inferred from it do not give rise to a legally binding obligation on or representation or warranty by Legacy Group. Legacy Group accepts no liability for any loss or damage arising as a result of any reliance on this plan or its contents.

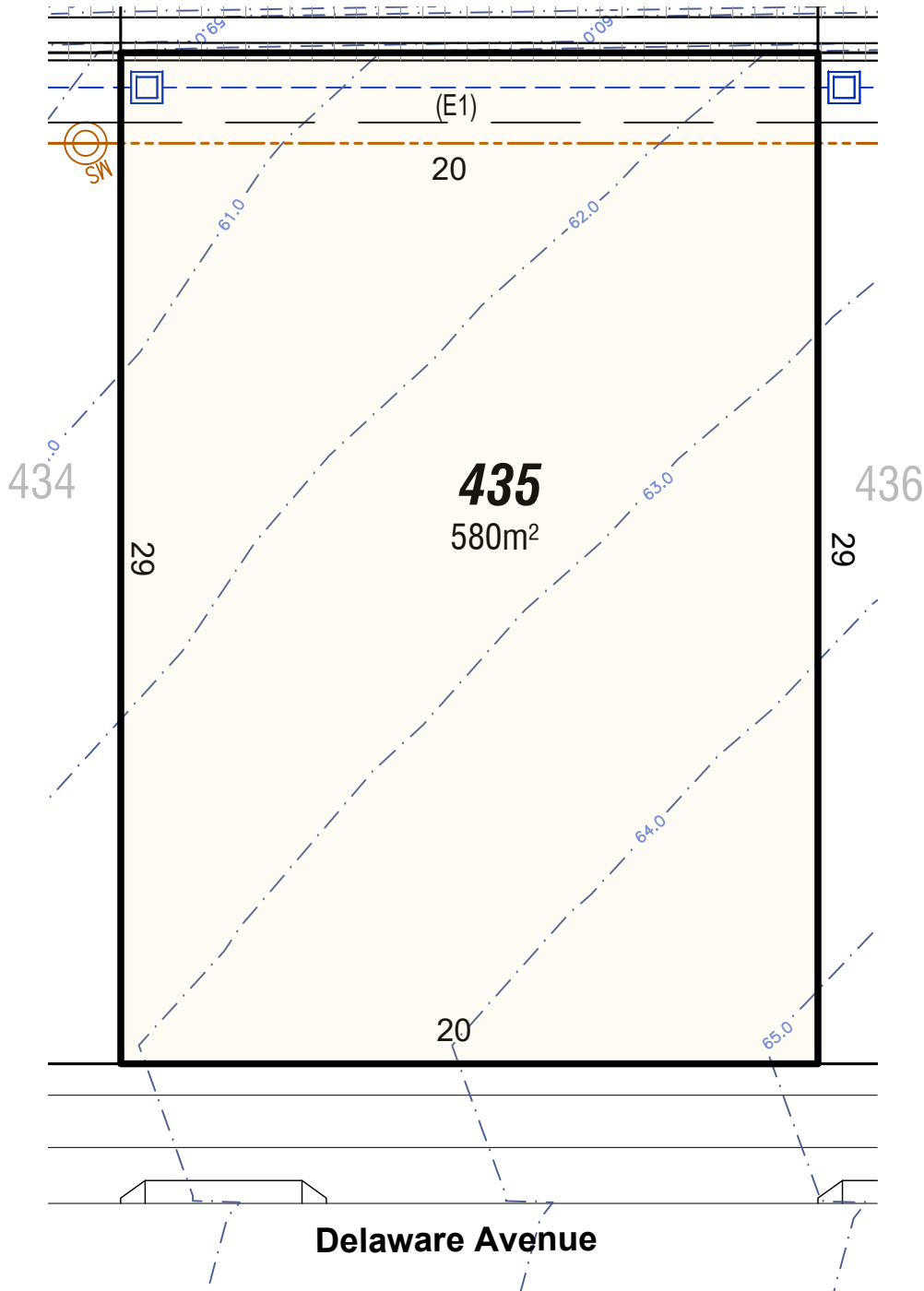

### Legend

- WATER
- SEWER MAIN & ACCESS POINT
- ELECTRICITY
- STORMWATER & PITS
- NBN
- RETAINING WALLS

- ZERO LOT EASEMENT
- BUILDING SETBACK (D.C.P.)
- EASEMENT FOR DRAINAGE & SERVICES
- SUBSTATION & SETBACKS
- (E1) EASEMENT TO DRAIN WATER 2.0 WIDE
- (E5) EASEMENT FOR ACCESS & MAINTENANCE 0.9 WIDE
- (E9) EASEMENT TO DRAIN WATER 1.5 WIDE

- (E11) EASEMENT TO DRAIN WATER 2 WIDE (D.P.1229231)
- (E51) EASEMENT FOR ACCESS AND MAINTENANCE 0.9 WIDE (D.P.1229231), (D.P.1201629)
- (R11) RESTRICTION ON THE USE OF LAND D.P.1229230 / D.P.1229231
- (R12) RESTRICTION ON THE USE OF LAND D.P.1229230 / D.P.1229231
- (R21) RESTRICTION ON THE USE OF LAND D.P.1229230 / D.P.1229231
- 'C' BENEFIT BY EASEMENT TO DRAIN WATER 2 WIDE (E1)
- 'E' BENEFIT BY EASEMENT FOR ACCESS & MAINTENANCE 0.9 WIDE



This plan is provided solely for the purpose of providing an impression of the concept relating to the proposed development called 'Caddens Hill', as well as the approximate location of existing and proposed third party facilities, services or destinations, and is not intended to be used for any other purpose. Legacy Group does not make any representation or give any warranty in relation to the future development of the site, the staging of any future development or the current or future location or existence of any facilities, services or destinations. The plan is based on the present intention of, and information available to, Legacy Group and the current known requirements of relevant authorities at the time of creation of the plan and details may change due to future circumstances. Any indications of distance or size are approximate and for indicative purposes only, and are not to scale. The plan and any matters shown on or inferred from it do not give rise to a legally binding obligation on or representation or warranty by Legacy Group. Legacy Group accepts no liability for any loss or damage arising as a result of any reliance on this plan or its contents.



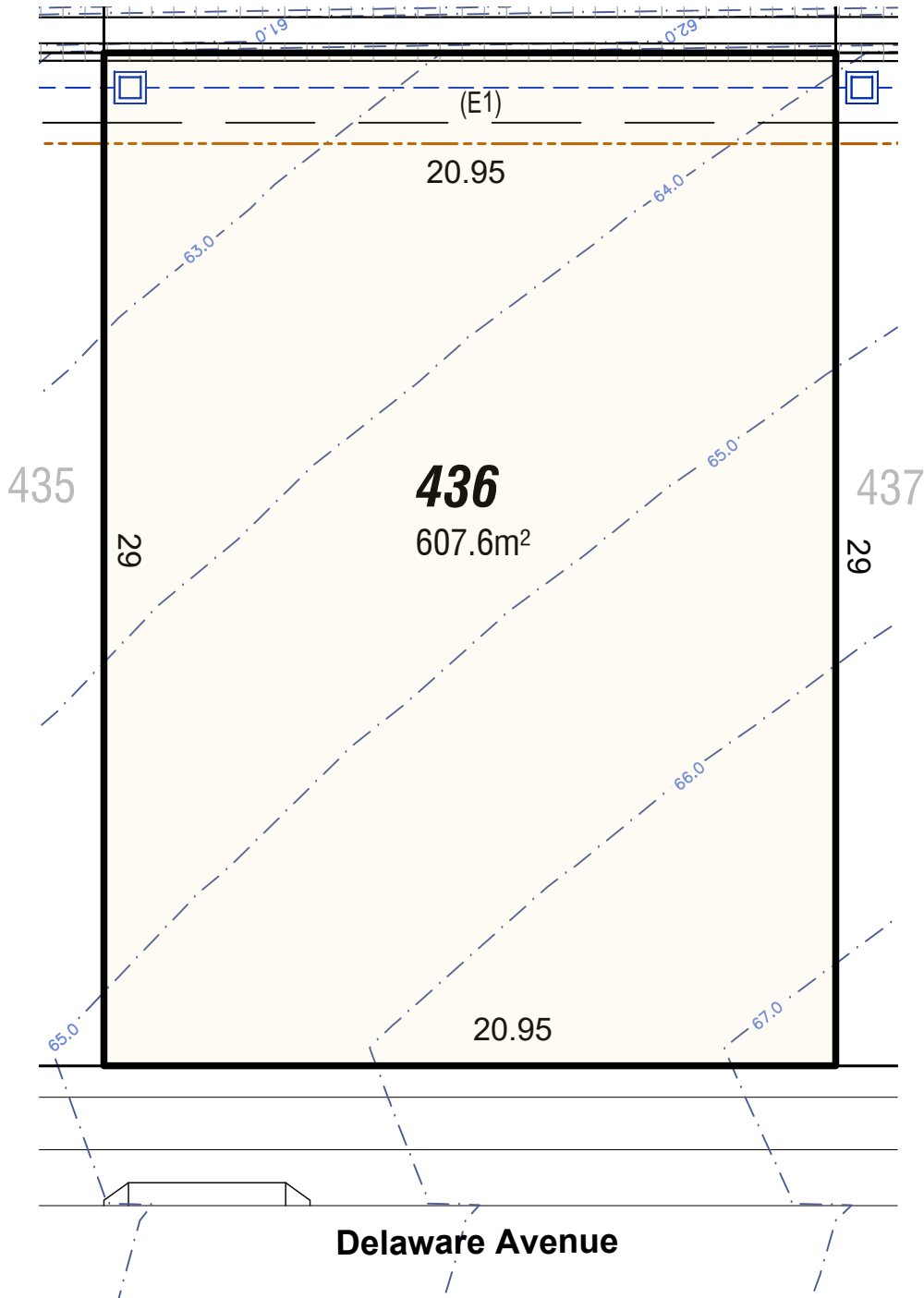

### Legend

- WATER
- SEWER MAIN & ACCESS POINT
- ELECTRICITY
- STORMWATER & PITS
- NBN
- RETAINING WALLS

- ZERO LOT EASEMENT
- BUILDING SETBACK (D.C.P.)
- EASEMENT FOR DRAINAGE & SERVICES
- SUBSTATION & SETBACKS
- (E1) EASEMENT TO DRAIN WATER 2.0 WIDE
- (E5) EASEMENT FOR ACCESS & MAINTENANCE 0.9 WIDE
- (E9) EASEMENT TO DRAIN WATER 1.5 WIDE

- (E11) EASEMENT TO DRAIN WATER 2 WIDE (D.P.1229231)
- (E51) EASEMENT FOR ACCESS AND MAINTENANCE 0.9 WIDE (D.P.1229231), (D.P.1201629)
- (R11) RESTRICTION ON THE USE OF LAND D.P.1229230 / D.P.1229231
- (R12) RESTRICTION ON THE USE OF LAND D.P.1229230 / D.P.1229231
- (R21) RESTRICTION ON THE USE OF LAND D.P.1229230 / D.P.1229231
- 'C' BENEFIT BY EASEMENT TO DRAIN WATER 2 WIDE (E1)
- 'E' BENEFIT BY EASEMENT FOR ACCESS & MAINTENANCE 0.9 WIDE



This plan is provided solely for the purpose of providing an impression of the concept relating to the proposed development called 'Caddens Hill', as well as the approximate location of existing and proposed third party facilities, services or destinations, and is not intended to be used for any other purpose. Legacy Group does not make any representation or give any warranty in relation to the future development of the site, the staging of any future development or the current or future location or existence of any facilities, services or destinations. The plan is based on the present intention of, and information available to, Legacy Group and the current known requirements of relevant authorities at the time of creation of the plan and details may change due to future circumstances. Any indications of distance or size are approximate and for indicative purposes only, and are not to scale. The plan and any matters shown on or inferred from it do not give rise to a legally binding obligation on or representation or warranty by Legacy Group. Legacy Group accepts no liability for any loss or damage arising as a result of any reliance on this plan or its contents.

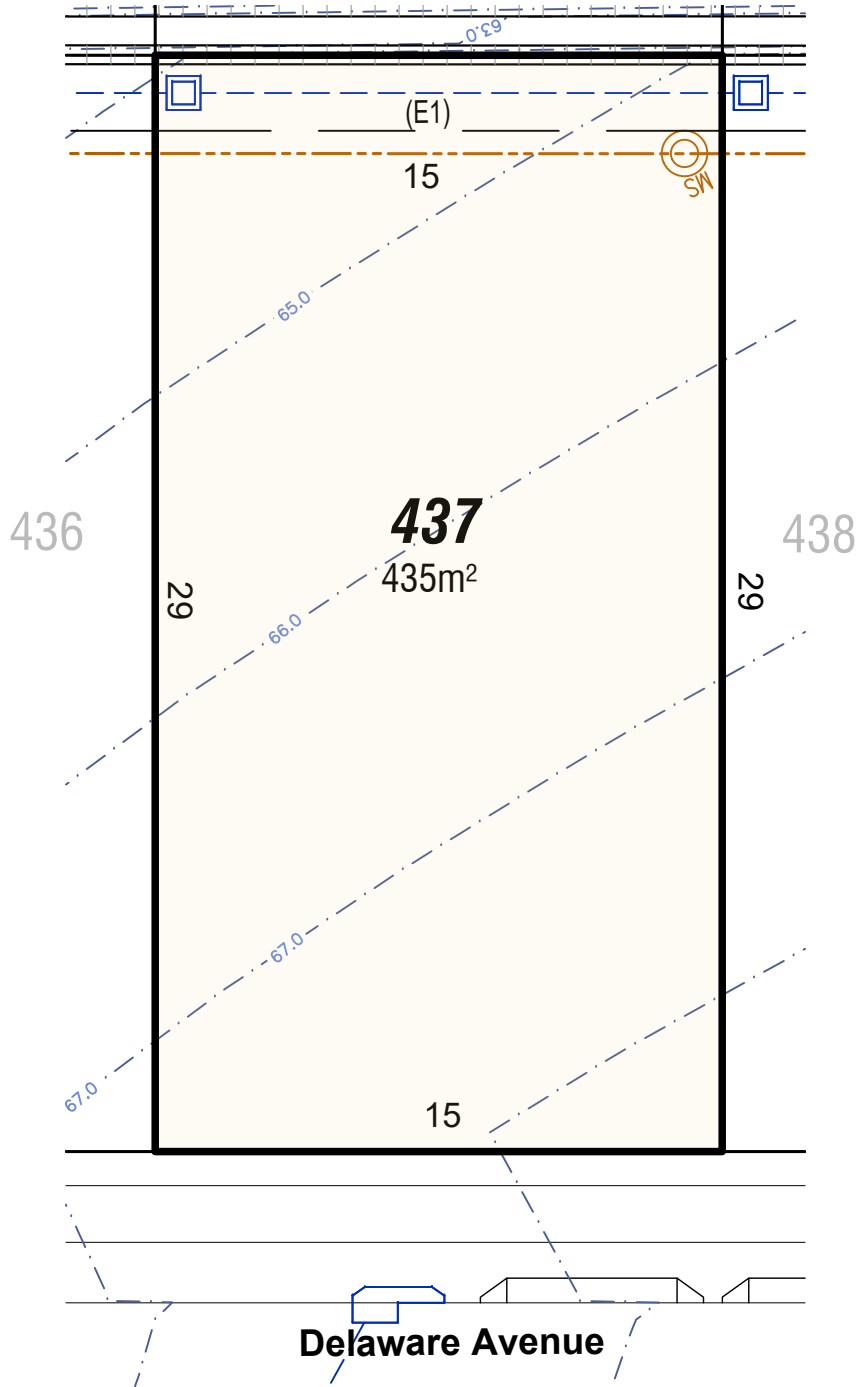

Delaware Avenue



### Legend

- WATER
- SEWER MAIN & ACCESS POINT
- ELECTRICITY
- STORMWATER & PITS
- NBN
- RETAINING WALLS

- ZERO LOT EASEMENT
- BUILDING SETBACK (D.C.P.)
- EASEMENT FOR DRAINAGE & SERVICES
- SUBSTATION & SETBACKS

- (E1) EASEMENT TO DRAIN WATER 2.0 WIDE
- (E5) EASEMENT FOR ACCESS & MAINTENANCE 0.9 WIDE
- (E9) EASEMENT TO DRAIN WATER 1.5 WIDE

- (E11) EASEMENT TO DRAIN WATER 2 WIDE (D.P.1229231)
- (E51) EASEMENT FOR ACCESS AND MAINTENANCE 0.9 WIDE (D.P.1229231), (D.P.1201629)
- (R11) RESTRICTION ON THE USE OF LAND D.P.1229230 / D.P.1229231
- (R12) RESTRICTION ON THE USE OF LAND D.P.1229230 / D.P.1229231
- (R21) RESTRICTION ON THE USE OF LAND D.P.1229230 / D.P.1229231
- 'C' BENEFIT BY EASEMENT TO DRAIN WATER 2 WIDE (E1)
- 'E' BENEFIT BY EASEMENT FOR ACCESS & MAINTENANCE 0.9 WIDE



This plan is provided solely for the purpose of providing an impression of the concept relating to the proposed development called 'Caddens Hill', as well as the approximate location of existing and proposed third party facilities, services or destinations, and is not intended to be used for any other purpose. Legacy Group does not make any representation or give any warranty in relation to the future development of the site, the staging of any future development or the current or future location or existence of any facilities, services or destinations. The plan is based on the present intention of, and information available to, Legacy Group and the current known requirements of relevant authorities at the time of creation of the plan and details may change due to future circumstances. Any indications of distance or size are approximate and for indicative purposes only, and are not to scale. The plan and any matters shown on or inferred from it do not give rise to a legally binding obligation on or representation or warranty by Legacy Group. Legacy Group accepts no liability for any loss or damage arising as a result of any reliance on this plan or its contents.

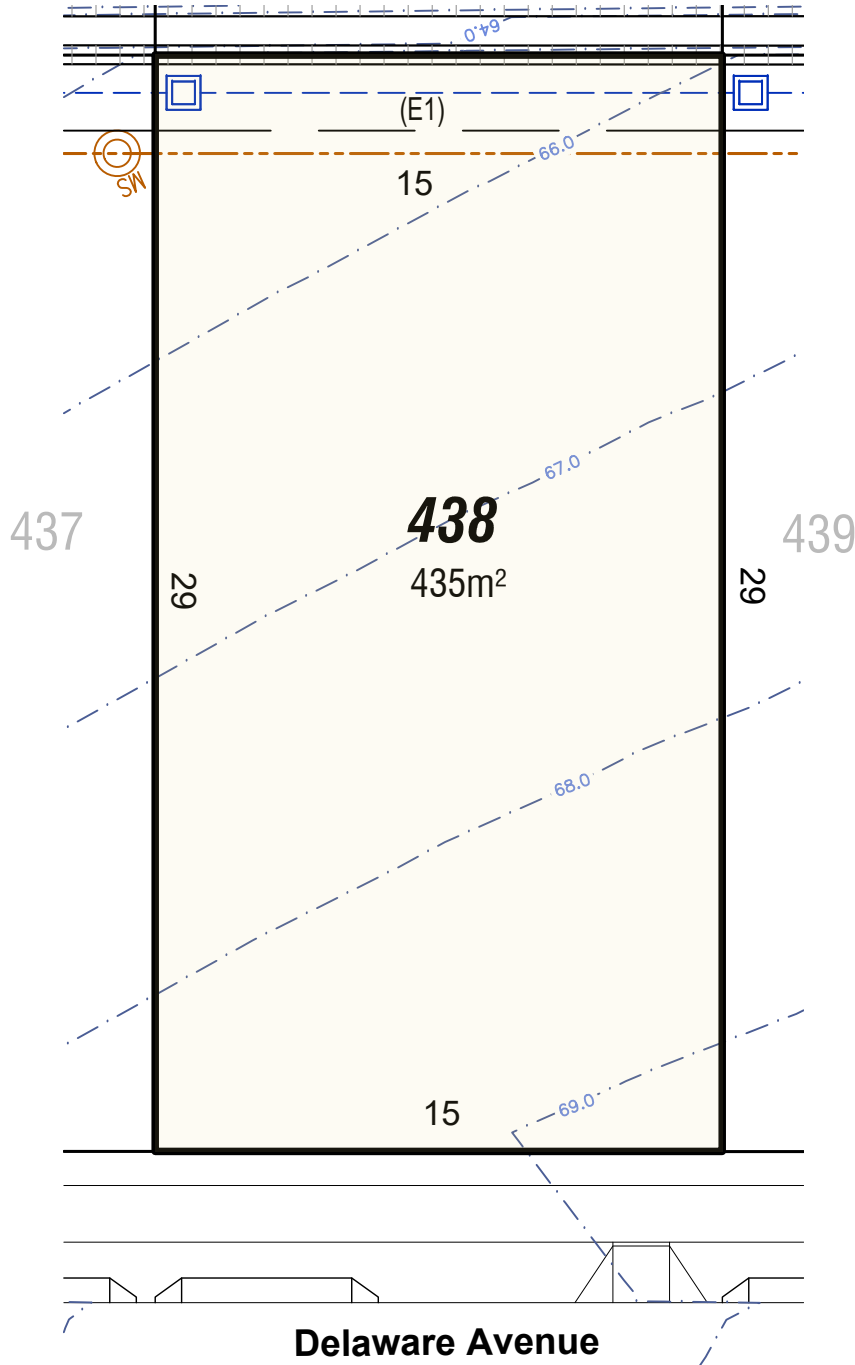

### Legend

- WATER
- SEWER MAIN & ACCESS POINT
- ELECTRICITY
- STORMWATER & PITS
- NBN
- RETAINING WALLS

- ZERO LOT EASEMENT
- BUILDING SETBACK (D.C.P.)
- EASEMENT FOR DRAINAGE & SERVICES
- SUBSTATION & SETBACKS

- (E1) EASEMENT TO DRAIN WATER 2.0 WIDE
- (E5) EASEMENT FOR ACCESS & MAINTENANCE 0.9 WIDE
- (E9) EASEMENT TO DRAIN WATER 1.5 WIDE

- (E11) EASEMENT TO DRAIN WATER 2 WIDE (D.P.1229231)
- (E51) EASEMENT FOR ACCESS AND MAINTENANCE 0.9 WIDE (D.P.1229231), (D.P.1201629)
- (R11) RESTRICTION ON THE USE OF LAND D.P.1229230 / D.P.1229231
- (R12) RESTRICTION ON THE USE OF LAND D.P.1229230 / D.P.1229231
- (R21) RESTRICTION ON THE USE OF LAND D.P.1229230 / D.P.1229231
- 'C' BENEFIT BY EASEMENT TO DRAIN WATER 2 WIDE (E1)
- 'E' BENEFIT BY EASEMENT FOR ACCESS & MAINTENANCE 0.9 WIDE



This plan is provided solely for the purpose of providing an impression of the concept relating to the proposed development called 'Caddens Hill', as well as the approximate location of existing and proposed third party facilities, services or destinations, and is not intended to be used for any other purpose. Legacy Group does not make any representation or give any warranty in relation to the future development of the site, the staging of any future development or the current or future location or existence of any facilities, services or destinations. The plan is based on the present intention of, and information available to, Legacy Group and the current known requirements of relevant authorities at the time of creation of the plan and details may change due to future circumstances. Any indications of distance or size are approximate and for indicative purposes only, and are not to scale. The plan and any matters shown on or inferred from it do not give rise to a legally binding obligation on or representation or warranty by Legacy Group. Legacy Group accepts no liability for any loss or damage arising as a result of any reliance on this plan or its contents.

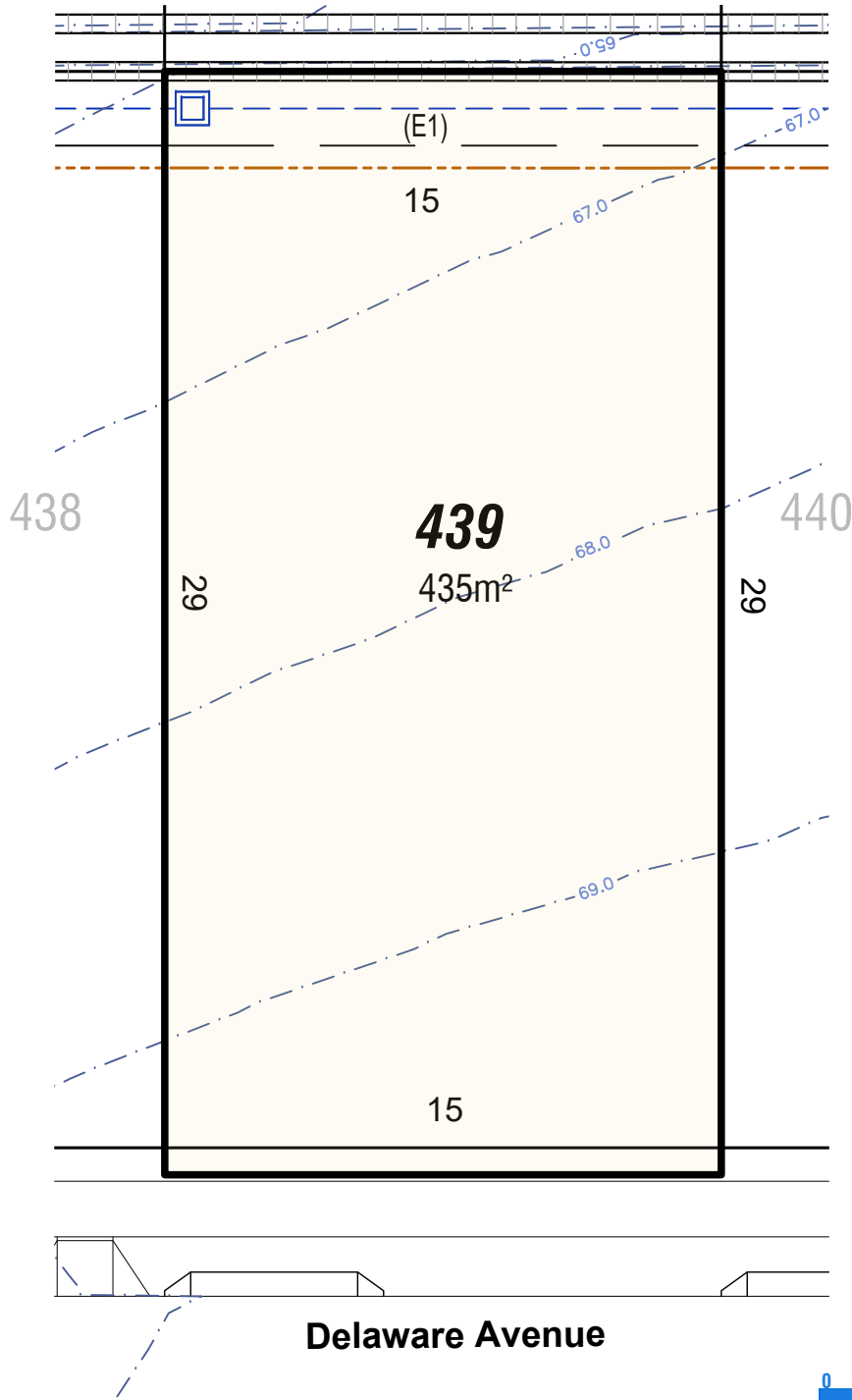

### Delaware Avenue



#### Legend

- WATER
- SEWER MAIN & ACCESS POINT
- ELECTRICITY
- STORMWATER & PITS
- NBN
- RETAINING WALLS

- ZERO LOT EASEMENT
- BUILDING SETBACK (D.C.P.)
- EASEMENT FOR DRAINAGE & SERVICES
- SUBSTATION & SETBACKS
- (E1) EASEMENT TO DRAIN WATER 2.0 WIDE
- (E5) EASEMENT FOR ACCESS & MAINTENANCE 0.9 WIDE
- (E9) EASEMENT TO DRAIN WATER 1.5 WIDE

- (E11) EASEMENT TO DRAIN WATER 2 WIDE (D.P.1229231)
- (E51) EASEMENT FOR ACCESS AND MAINTENANCE 0.9 WIDE (D.P.1229231), (D.P.1201629)
- (R11) RESTRICTION ON THE USE OF LAND D.P.1229230 / D.P.1229231
- (R12) RESTRICTION ON THE USE OF LAND D.P.1229230 / D.P.1229231
- (R21) RESTRICTION ON THE USE OF LAND D.P.1229230 / D.P.1229231
- 'C' BENEFIT BY EASEMENT TO DRAIN WATER 2 WIDE (E1)
- 'E' BENEFIT BY EASEMENT FOR ACCESS & MAINTENANCE 0.9 WIDE



This plan is provided solely for the purpose of providing an impression of the concept relating to the proposed development called 'Caddens Hill', as well as the approximate location of existing and proposed third party facilities, services or destinations, and is not intended to be used for any other purpose. Legacy Group does not make any representation or give any warranty in relation to the future development of the site, the staging of any future development or the current or future location or existence of any facilities, services or destinations. The plan is based on the present intention of, and information available to, Legacy Group and the current known requirements of relevant authorities at the time of creation of the plan and details may change due to future circumstances. Any indications of distance or size are approximate and for indicative purposes only, and are not to scale. The plan and any matters shown on or inferred from it do not give rise to a legally binding obligation on or representation or warranty by Legacy Group. Legacy Group accepts no liability for any loss or damage arising as a result of any reliance on this plan or its contents.

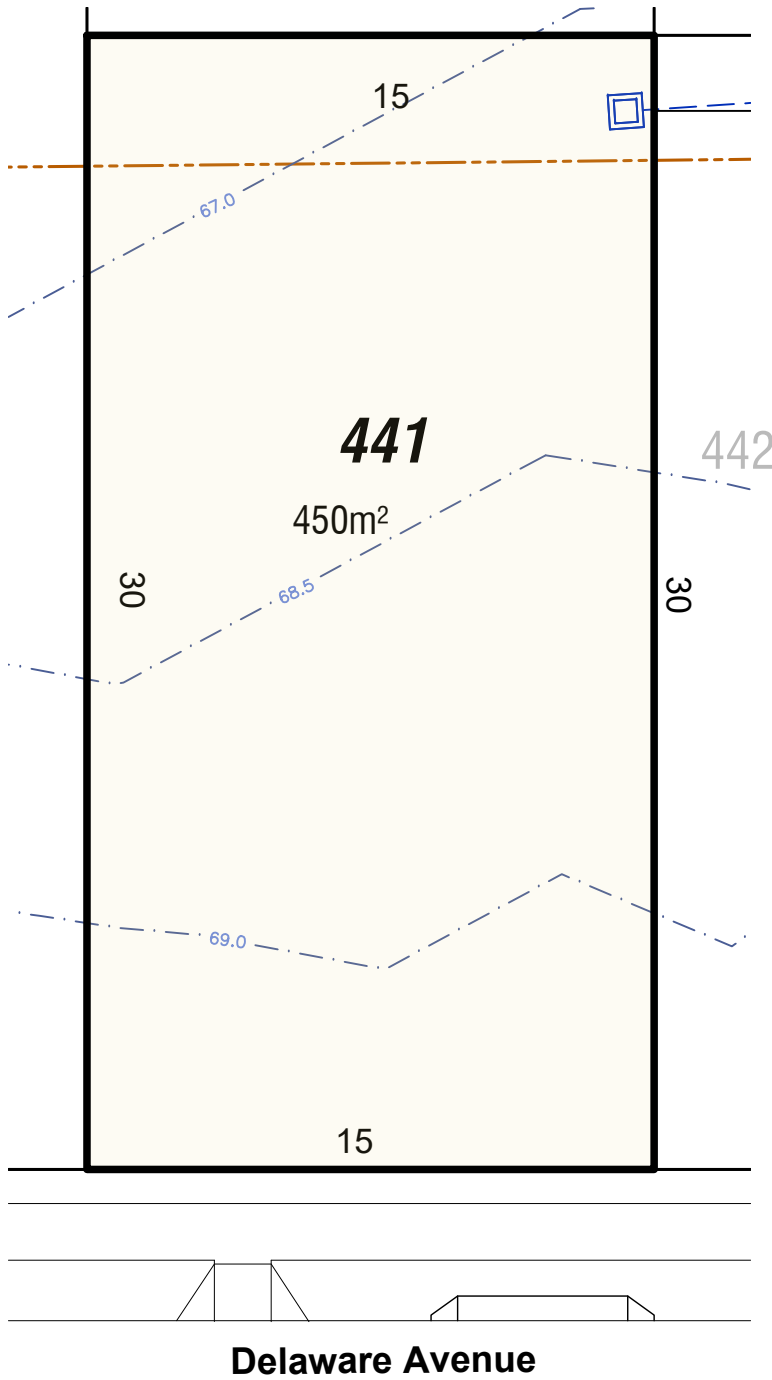

### Legend

- WATER
- SEWER MAIN & ACCESS POINT
- ELECTRICITY
- STORMWATER & PITS
- NBN
- RETAINING WALLS

- ZERO LOT EASEMENT
- BUILDING SETBACK (D.C.P.)
- EASEMENT FOR DRAINAGE & SERVICES
- SUBSTATION & SETBACKS
- (E1) EASEMENT TO DRAIN WATER 2.0 WIDE
- (E5) EASEMENT FOR ACCESS & MAINTENANCE 0.9 WIDE
- (E9) EASEMENT TO DRAIN WATER 1.5 WIDE

- (E11) EASEMENT TO DRAIN WATER 2 WIDE (D.P.1229231)
- (E51) EASEMENT FOR ACCESS AND MAINTENANCE 0.9 WIDE (D.P.1229231), (D.P.1201629)
- (R11) RESTRICTION ON THE USE OF LAND D.P.1229230 / D.P.1229231
- (R12) RESTRICTION ON THE USE OF LAND D.P.1229230 / D.P.1229231
- (R21) RESTRICTION ON THE USE OF LAND D.P.1229230 / D.P.1229231
- 'C' BENEFIT BY EASEMENT TO DRAIN WATER 2 WIDE (E1)
- 'E' BENEFIT BY EASEMENT FOR ACCESS & MAINTENANCE 0.9 WIDE



This plan is provided solely for the purpose of providing an impression of the concept relating to the proposed development called 'Caddens Hill', as well as the approximate location of existing and proposed third party facilities, services or destinations, and is not intended to be used for any other purpose. Legacy Group does not make any representation or give any warranty in relation to the future development of the site, the staging of any future development or the current or future location or existence of any facilities, services or destinations. The plan is based on the present intention of, and information available to, Legacy Group and the current known requirements of relevant authorities at the time of creation of the plan and details may change due to future circumstances. Any indications of distance or size are approximate and for indicative purposes only, and are not to scale. The plan and any matters shown on or inferred from it do not give rise to a legally binding obligation on or representation or warranty by Legacy Group. Legacy Group accepts no liability for any loss or damage arising as a result of any reliance on this plan or its contents.

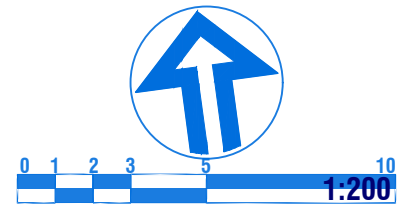
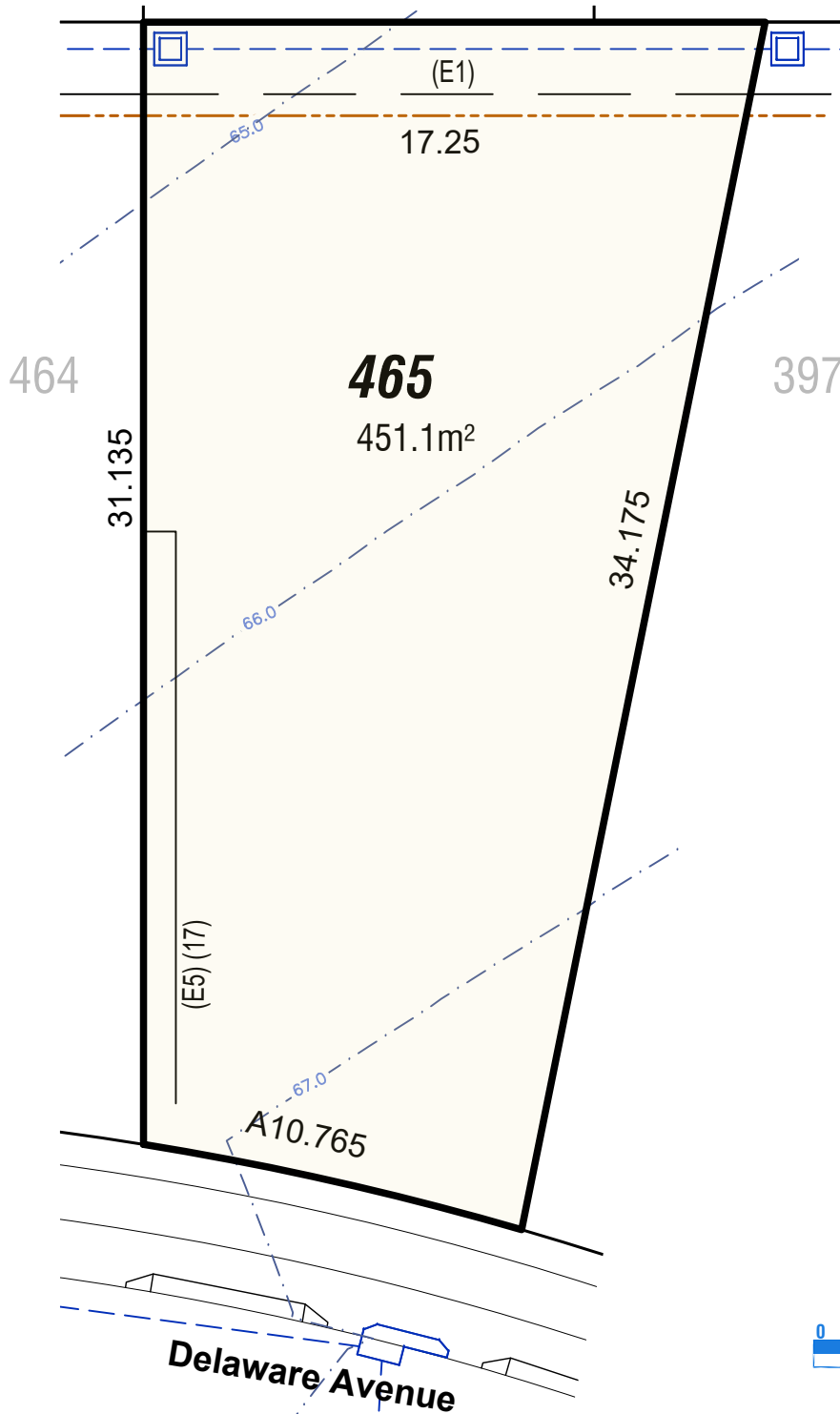

### Legend

- WATER
- SEWER MAIN & ACCESS POINT
- ELECTRICITY
- STORMWATER & PITS
- NBN
- RETAINING WALLS
- ZERO LOT EASEMENT
- BUILDING SETBACK (D.C.P.)
- EASEMENT FOR DRAINAGE & SERVICES
- SUBSTATION & SETBACKS
- (E1) EASEMENT TO DRAIN WATER 2.0 WIDE
- (E5) EASEMENT FOR ACCESS & MAINTENANCE 0.9 WIDE
- (E9) EASEMENT TO DRAIN WATER 1.5 WIDE

- (E11) EASEMENT TO DRAIN WATER 2 WIDE (D.P.1229231)
- (E51) EASEMENT FOR ACCESS AND MAINTENANCE 0.9 WIDE (D.P.1229231), (D.P.1201629)
- (R11) RESTRICTION ON THE USE OF LAND D.P.1229230 / D.P.1229231
- (R12) RESTRICTION ON THE USE OF LAND D.P.1229230 / D.P.1229231
- (R21) RESTRICTION ON THE USE OF LAND D.P.1229230 / D.P.1229231
- 'C' BENEFIT BY EASEMENT TO DRAIN WATER 2 WIDE (E1)
- 'E' BENEFIT BY EASEMENT FOR ACCESS & MAINTENANCE 0.9 WIDE



This plan is provided solely for the purpose of providing an impression of the concept relating to the proposed development called 'Caddens Hill', as well as the approximate location of existing and proposed third party facilities, services or destinations, and is not intended to be used for any other purpose. Legacy Group does not make any representation or give any warranty in relation to the future development of the site, the staging of any future development or the current or future location or existence of any facilities, services or destinations. The plan is based on the present intention of, and information available to, Legacy Group and the current known requirements of relevant authorities at the time of creation of the plan and details may change due to future circumstances. Any indications of distance or size are approximate and for indicative purposes only, and are not to scale. The plan and any matters shown on or inferred from it do not give rise to a legally binding obligation on or representation or warranty by Legacy Group. Legacy Group accepts no liability for any loss or damage arising as a result of any reliance on this plan or its contents.

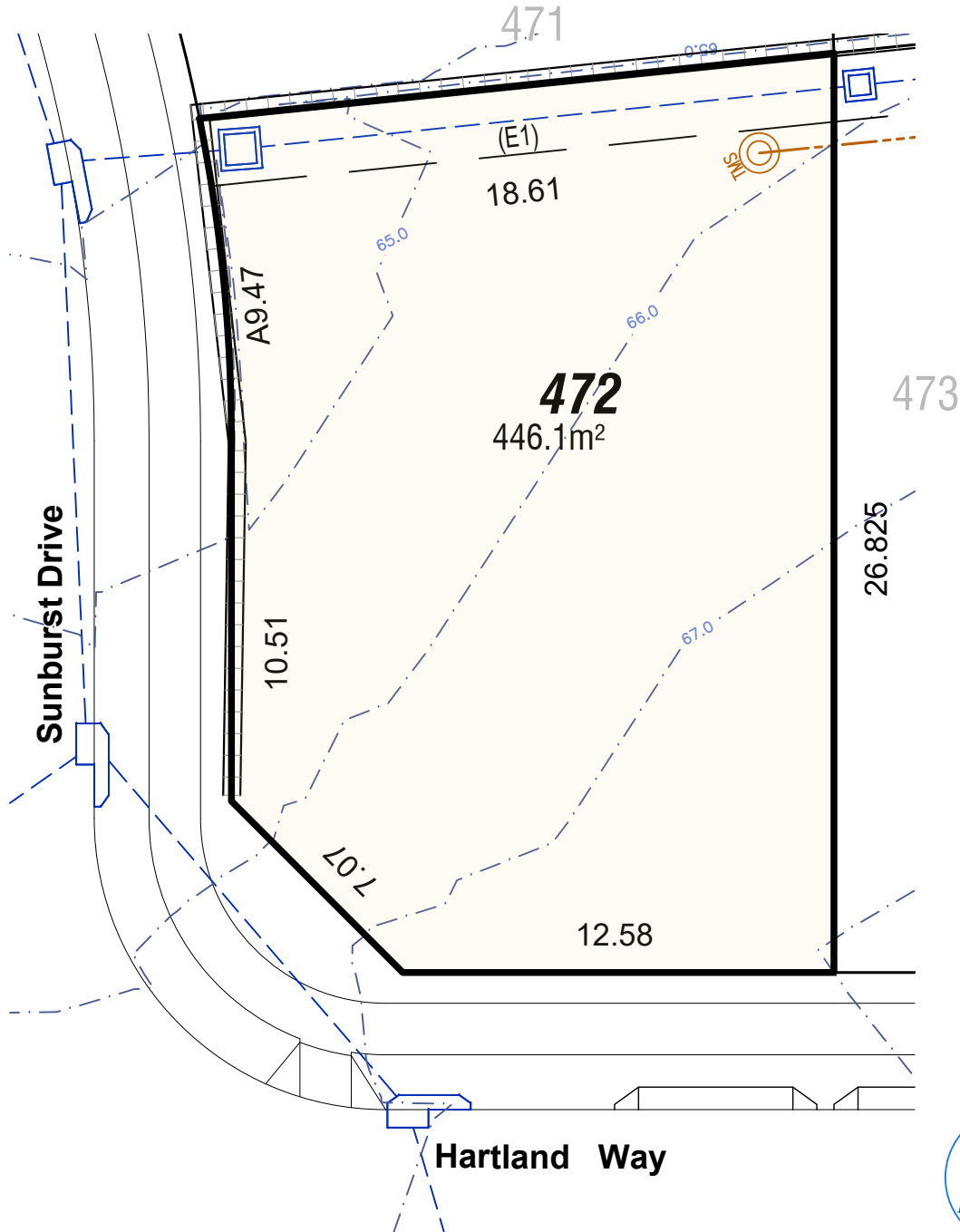

### Legend

- WATER
- SEWER MAIN & ACCESS POINT
- ELECTRICITY
- STORMWATER & PITS
- NBN
- RETAINING WALLS

- ZERO LOT EASEMENT
- BUILDING SETBACK (D.C.P.)
- EASEMENT FOR DRAINAGE & SERVICES
- SUBSTATION & SETBACKS

- (E1) EASEMENT TO DRAIN WATER 2.0 WIDE
- (E5) EASEMENT FOR ACCESS & MAINTENANCE 0.9 WIDE
- (E9) EASEMENT TO DRAIN WATER 1.5 WIDE

- (E11) EASEMENT TO DRAIN WATER 2 WIDE (D.P.1229231)
- (E51) EASEMENT FOR ACCESS AND MAINTENANCE 0.9 WIDE (D.P.1229231), (D.P.1201629)
- (R11) RESTRICTION ON THE USE OF LAND D.P.1229230 / D.P.1229231
- (R12) RESTRICTION ON THE USE OF LAND D.P.1229230 / D.P.1229231
- (R21) RESTRICTION ON THE USE OF LAND D.P.1229230 / D.P.1229231
- 'C' BENEFIT BY EASEMENT TO DRAIN WATER 2 WIDE (E1)
- 'E' BENEFIT BY EASEMENT FOR ACCESS & MAINTENANCE 0.9 WIDE



This plan is provided solely for the purpose of providing an impression of the concept relating to the proposed development called 'Caddens Hill', as well as the approximate location of existing and proposed third party facilities, services or destinations, and is not intended to be used for any other purpose. Legacy Group does not make any representation or give any warranty in relation to the future development of the site, the staging of any future development or the current or future location or existence of any facilities, services or destinations. The plan is based on the present intention of, and information available to, Legacy Group and the current known requirements of relevant authorities at the time of creation of the plan and details may change due to future circumstances. Any indications of distance or size are approximate and for indicative purposes only, and are not to scale. The plan and any matters shown on or inferred from it do not give rise to a legally binding obligation on or representation or warranty by Legacy Group. Legacy Group accepts no liability for any loss or damage arising as a result of any reliance on this plan or its contents.

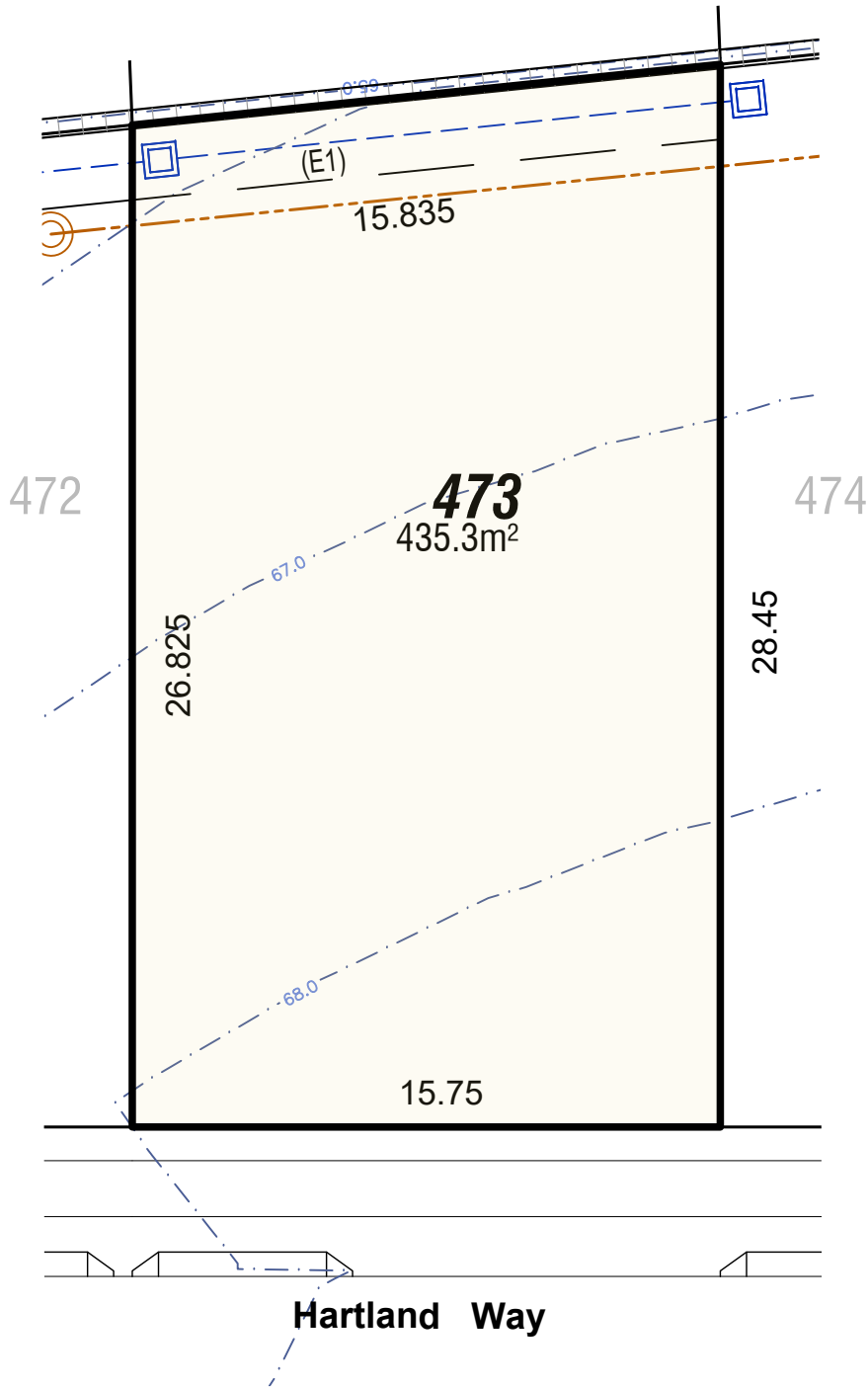

### Legend

- WATER
- SEWER MAIN & ACCESS POINT
- ELECTRICITY
- STORMWATER & PITS
- NBN
- RETAINING WALLS

- ZERO LOT EASEMENT
- BUILDING SETBACK (D.C.P.)
- EASEMENT FOR DRAINAGE & SERVICES
- SUBSTATION & SETBACKS
- (E1) EASEMENT TO DRAIN WATER 2.0 WIDE
- (E5) EASEMENT FOR ACCESS & MAINTENANCE 0.9 WIDE
- (E9) EASEMENT TO DRAIN WATER 1.5 WIDE

- (E11) EASEMENT TO DRAIN WATER 2 WIDE (D.P.1229231)
- (E51) EASEMENT FOR ACCESS AND MAINTENANCE 0.9 WIDE (D.P.1229231), (D.P.1201629)
- (R11) RESTRICTION ON THE USE OF LAND D.P.1229230 / D.P.1229231
- (R12) RESTRICTION ON THE USE OF LAND D.P.1229230 / D.P.1229231
- (R21) RESTRICTION ON THE USE OF LAND D.P.1229230 / D.P.1229231
- 'C' BENEFIT BY EASEMENT TO DRAIN WATER 2 WIDE (E1)
- 'E' BENEFIT BY EASEMENT FOR ACCESS & MAINTENANCE 0.9 WIDE



This plan is provided solely for the purpose of providing an impression of the concept relating to the proposed development called 'Caddens Hill', as well as the approximate location of existing and proposed third party facilities, services or destinations, and is not intended to be used for any other purpose. Legacy Group does not make any representation or give any warranty in relation to the future development of the site, the staging of any future development or the current or future location or existence of any facilities, services or destinations. The plan is based on the present intention of, and information available to, Legacy Group and the current known requirements of relevant authorities at the time of creation of the plan and details may change due to future circumstances. Any indications of distance or size are approximate and for indicative purposes only, and are not to scale. The plan and any matters shown on or inferred from it do not give rise to a legally binding obligation on or representation or warranty by Legacy Group. Legacy Group accepts no liability for any loss or damage arising as a result of any reliance on this plan or its contents.



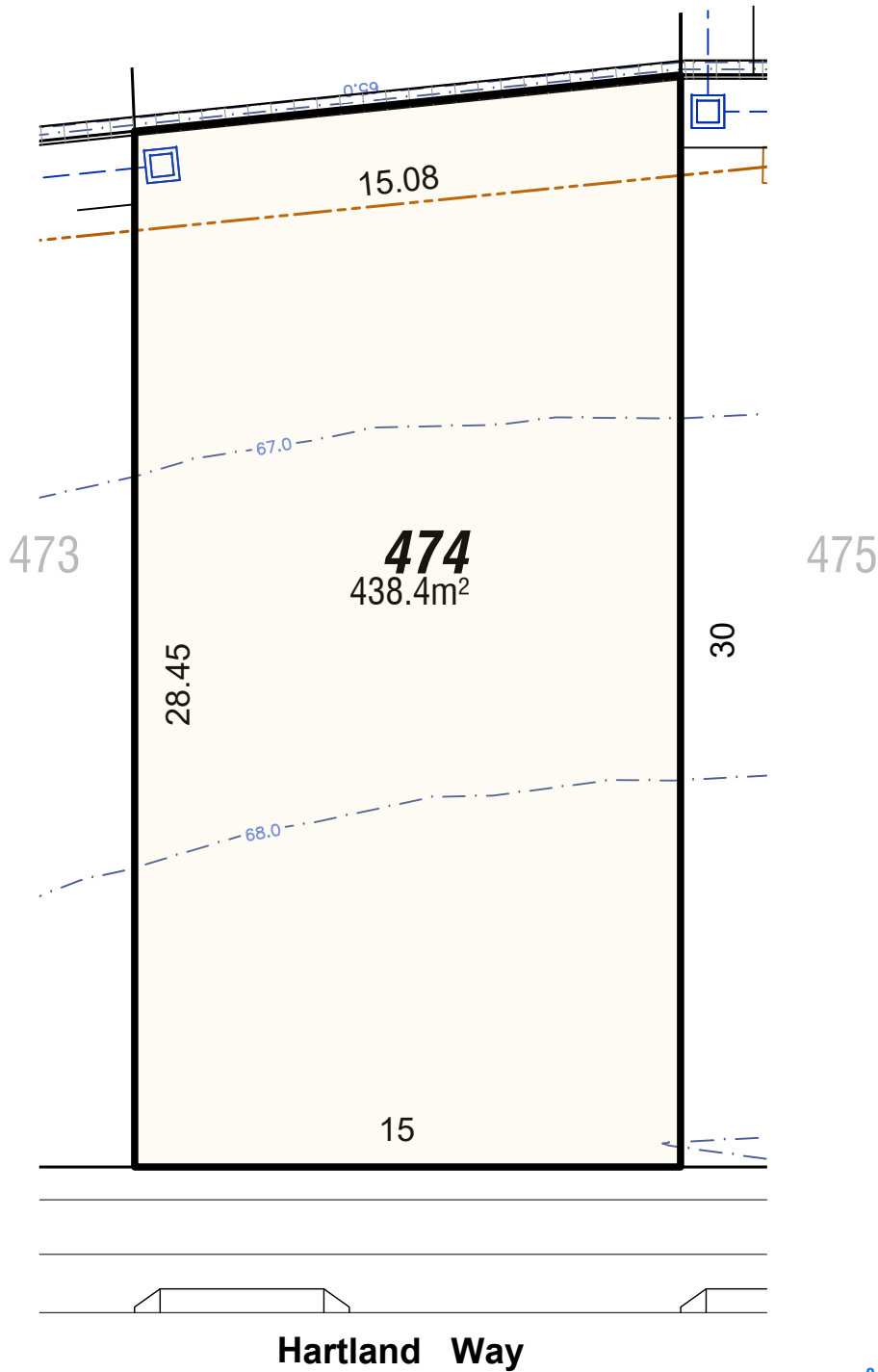

### Legend

- WATER
- SEWER MAIN & ACCESS POINT
- ELECTRICITY
- STORMWATER & PITS
- NBN
- RETAINING WALLS

- ZERO LOT EASEMENT
- BUILDING SETBACK (D.C.P.)
- EASEMENT FOR DRAINAGE & SERVICES
- SUBSTATION & SETBACKS
- (E1) EASEMENT TO DRAIN WATER 2.0 WIDE
- (E5) EASEMENT FOR ACCESS & MAINTENANCE 0.9 WIDE
- (E9) EASEMENT TO DRAIN WATER 1.5 WIDE

- (E11) EASEMENT TO DRAIN WATER 2 WIDE (D.P.1229231)
- (E51) EASEMENT FOR ACCESS AND MAINTENANCE 0.9 WIDE (D.P.1229231), (D.P.1201629)
- (R11) RESTRICTION ON THE USE OF LAND D.P.1229230 / D.P.1229231
- (R12) RESTRICTION ON THE USE OF LAND D.P.1229230 / D.P.1229231
- (R21) RESTRICTION ON THE USE OF LAND D.P.1229230 / D.P.1229231
- 'C' BENEFIT BY EASEMENT TO DRAIN WATER 2 WIDE (E1)
- 'E' BENEFIT BY EASEMENT FOR ACCESS & MAINTENANCE 0.9 WIDE



This plan is provided solely for the purpose of providing an impression of the concept relating to the proposed development called 'Caddens Hill', as well as the approximate location of existing and proposed third party facilities, services or destinations, and is not intended to be used for any other purpose. Legacy Group does not make any representation or give any warranty in relation to the future development of the site, the staging of any future development or the current or future location or existence of any facilities, services or destinations. The plan is based on the present intention of, and information available to, Legacy Group and the current known requirements of relevant authorities at the time of creation of the plan and details may change due to future circumstances. Any indications of distance or size are approximate and for indicative purposes only, and are not to scale. The plan and any matters shown on or inferred from it do not give rise to a legally binding obligation on or representation or warranty by Legacy Group. Legacy Group accepts no liability for any loss or damage arising as a result of any reliance on this plan or its contents.

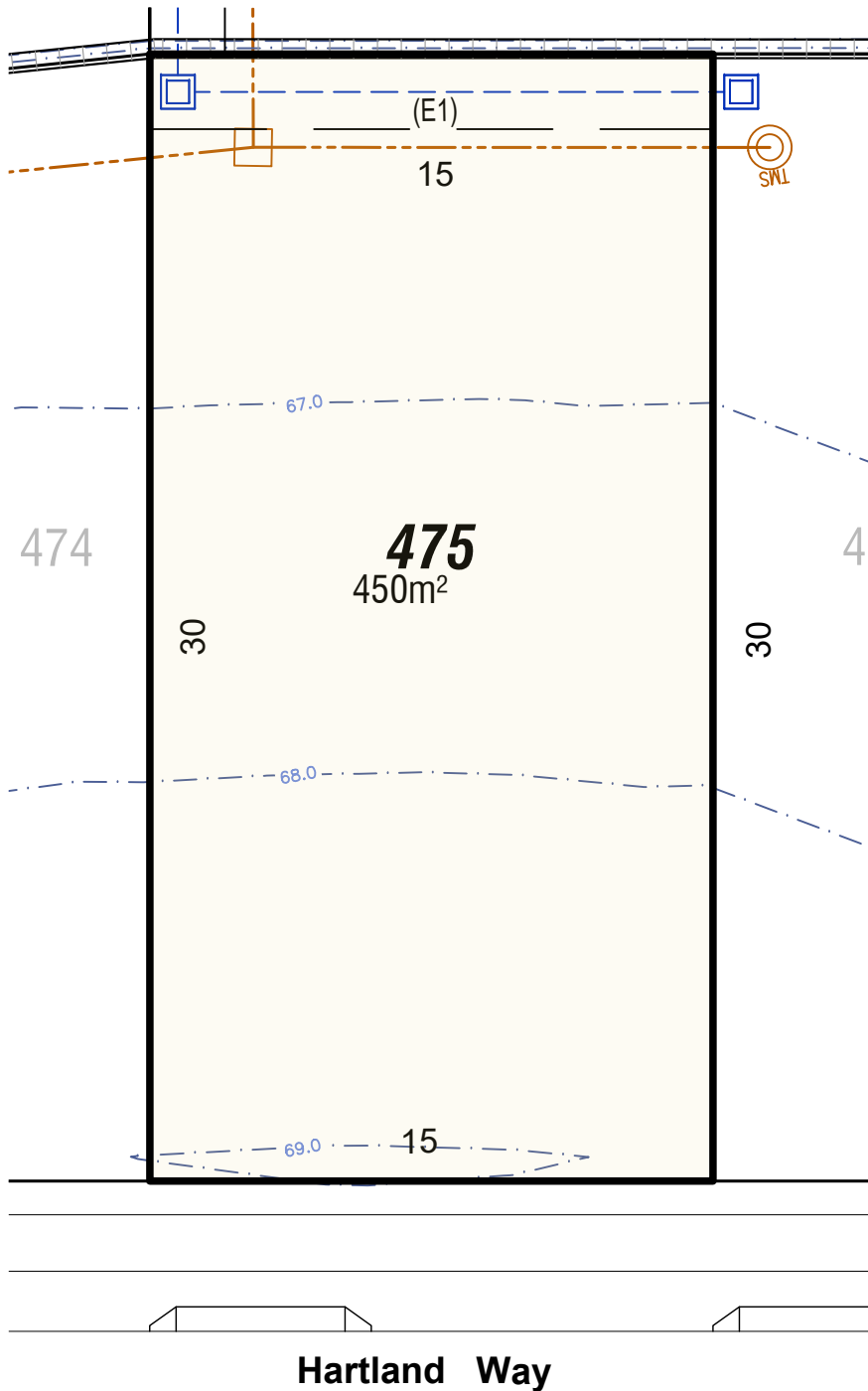

### Legend

- WATER
- SEWER MAIN & ACCESS POINT
- ELECTRICITY
- STORMWATER & PITS
- NBN
- RETAINING WALLS

- ZERO LOT EASEMENT
- BUILDING SETBACK (D.C.P.)
- EASEMENT FOR DRAINAGE & SERVICES
- SUBSTATION & SETBACKS
- (E1) EASEMENT TO DRAIN WATER 2.0 WIDE
- (E5) EASEMENT FOR ACCESS & MAINTENANCE 0.9 WIDE
- (E9) EASEMENT TO DRAIN WATER 1.5 WIDE

- (E11) EASEMENT TO DRAIN WATER 2 WIDE (D.P.1229231)
- (E51) EASEMENT FOR ACCESS AND MAINTENANCE 0.9 WIDE (D.P.1229231), (D.P.1201629)
- (R11) RESTRICTION ON THE USE OF LAND D.P.1229230 / D.P.1229231
- (R12) RESTRICTION ON THE USE OF LAND D.P.1229230 / D.P.1229231
- (R21) RESTRICTION ON THE USE OF LAND D.P.1229230 / D.P.1229231
- 'C' BENEFIT BY EASEMENT TO DRAIN WATER 2 WIDE (E1)
- 'E' BENEFIT BY EASEMENT FOR ACCESS & MAINTENANCE 0.9 WIDE



This plan is provided solely for the purpose of providing an impression of the concept relating to the proposed development called 'Caddens Hill', as well as the approximate location of existing and proposed third party facilities, services or destinations, and is not intended to be used for any other purpose. Legacy Group does not make any representation or give any warranty in relation to the future development of the site, the staging of any future development or the current or future location or existence of any facilities, services or destinations. The plan is based on the present intention of, and information available to, Legacy Group and the current known requirements of relevant authorities at the time of creation of the plan and details may change due to future circumstances. Any indications of distance or size are approximate and for indicative purposes only, and are not to scale. The plan and any matters shown on or inferred from it do not give rise to a legally binding obligation on or representation or warranty by Legacy Group. Legacy Group accepts no liability for any loss or damage arising as a result of any reliance on this plan or its contents.

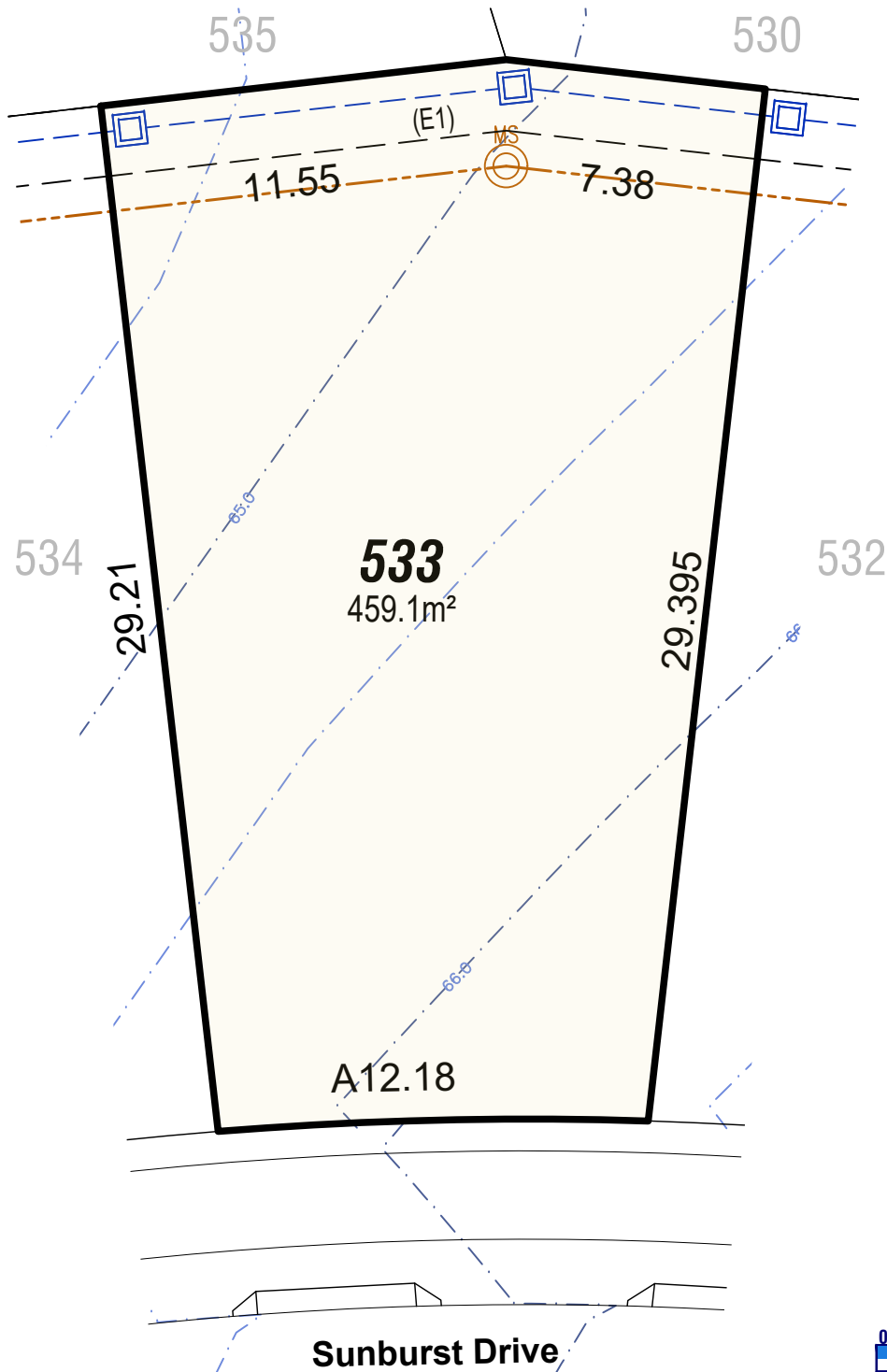

### Legend

- WATER
- SEWER MAIN & ACCESS POINT
- ELECTRICITY
- STORMWATER & PITS
- NBN
- RETAINING WALLS
- ZERO LOT EASEMENT
- BUILDING SETBACK (D.C.P.)
- EASEMENT FOR DRAINAGE & SERVICES
- SUBSTATION & SETBACKS
- (E1) EASEMENT TO DRAIN WATER 2.0 WIDE
- (E4) EASEMENT FOR PADMOUNT SUBSTATION 2.75 WIDE
- (E5) EASEMENT FOR ACCESS & MAINTENANCE 0.9 WIDE
- (E5.1) EASEMENT FOR ACCESS AND MAINTENANCE 0.9 WIDE
- (R1) RESTRICTION ON THE USE OF LAND
- (R2) RESTRICTION ON THE USE OF LAND
- (R11) RESTRICTION ON THE USE OF LAND (D.P.1229230)
- (R12) RESTRICTION ON THE USE OF LAND (D.P.1229230)
- (R51) EASEMENT FOR ACCESS AND MAINTENANCE 0.9 WIDE (D.P.1229230)
- (E52) EASEMENT FOR ACCESS AND MAINTENANCE 0.9 WIDE (D.P.1229230)
- (E53) EASEMENT FOR ACCESS AND MAINTENANCE 0.9 WIDE (D.P.1229230)
- 'C' BENEFIT BY EASEMENT TO DRAIN WATER 2 WIDE (E1)
- 'E' BENEFIT BY EASEMENT FOR ACCESS & MAINTENANCE 0.9 WIDE

This plan is provided solely for the purpose of providing an impression of the concept relating to the proposed development called 'Caddens Hill', as well as the approximate location of existing and proposed third party facilities, services or destinations, and is not intended to be used for any other purpose. Legacy Group does not make any representation or give any warranty in relation to the future development of the site, the staging of any future development or the current or future location or existence of any facilities, services or destinations. The plan is based on the present intention of, and information available to, Legacy Group and the current known requirements of relevant authorities at the time of creation of the plan and details may change due to future circumstances. Any indications of distance or size are approximate and for indicative purposes only, and are not to scale. The plan and any matters shown on or inferred from it do not give rise to a legally binding obligation on or representation or warranty by Legacy Group. Legacy Group accepts no liability for any loss or damage arising as a result of any reliance on this plan or its contents.



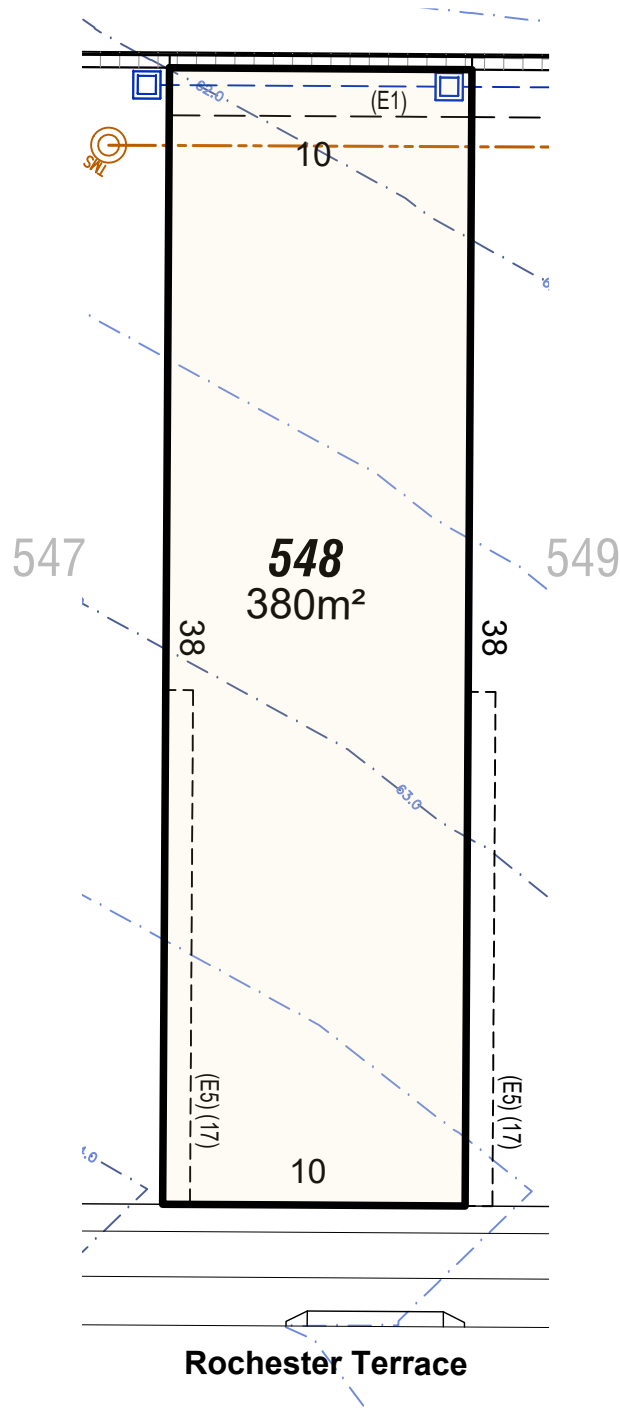

### Legend

- WATER
- SEWER MAIN & ACCESS POINT
- ELECTRICITY
- STORMWATER & PITS
- NBN
- RETAINING WALLS

- ZERO LOT EASEMENT
- BUILDING SETBACK (D.C.P.)
- EASEMENT FOR DRAINAGE & SERVICES
- SUBSTATION & SETBACKS
- (E1) EASEMENT TO DRAIN WATER 2.0 WIDE
- (E4) EASEMENT FOR PADMOUNT SUBSTATION 2.75 WIDE
- (E5) EASEMENT FOR ACCESS & MAINTENANCE 0.9 WIDE
- (E51) EASEMENT FOR ACCESS AND MAINTENANCE 0.9 WIDE

- (R1) RESTRICTION ON THE USE OF LAND
- (R2) RESTRICTION ON THE USE OF LAND
- (R11) RESTRICTION ON THE USE OF LAND (D.P.1229230)
- (R12) RESTRICTION ON THE USE OF LAND (D.P.1229230)
- (R51) EASEMENT FOR ACCESS AND MAINTENANCE 0.9 WIDE (D.P.1229230)
- (E52) EASEMENT FOR ACCESS AND MAINTENANCE 0.9 WIDE (D.P.1229230)
- (E53) EASEMENT FOR ACCESS AND MAINTENANCE 0.9 WIDE (D.P.1229230)
- 'C' BENEFIT BY EASEMENT TO DRAIN WATER 2 WIDE (E1)
- 'E' BENEFIT BY EASEMENT FOR ACCESS & MAINTENANCE 0.9 WIDE



This plan is provided solely for the purpose of providing an impression of the concept relating to the proposed development called 'Caddens Hill', as well as the approximate location of existing and proposed third party facilities, services or destinations, and is not intended to be used for any other purpose. Legacy Group does not make any representation or give any warranty in relation to the future development of the site, the staging of any future development or the current or future location or existence of any facilities, services or destinations. The plan is based on the present intention of, and information available to, Legacy Group and the current known requirements of relevant authorities at the time of creation of the plan and details may change due to future circumstances. Any indications of distance or size are approximate and for indicative purposes only, and are not to scale. The plan and any matters shown on or inferred from it do not give rise to a legally binding obligation on or representation or warranty by Legacy Group. Legacy Group accepts no liability for any loss or damage arising as a result of any reliance on this plan or its contents.

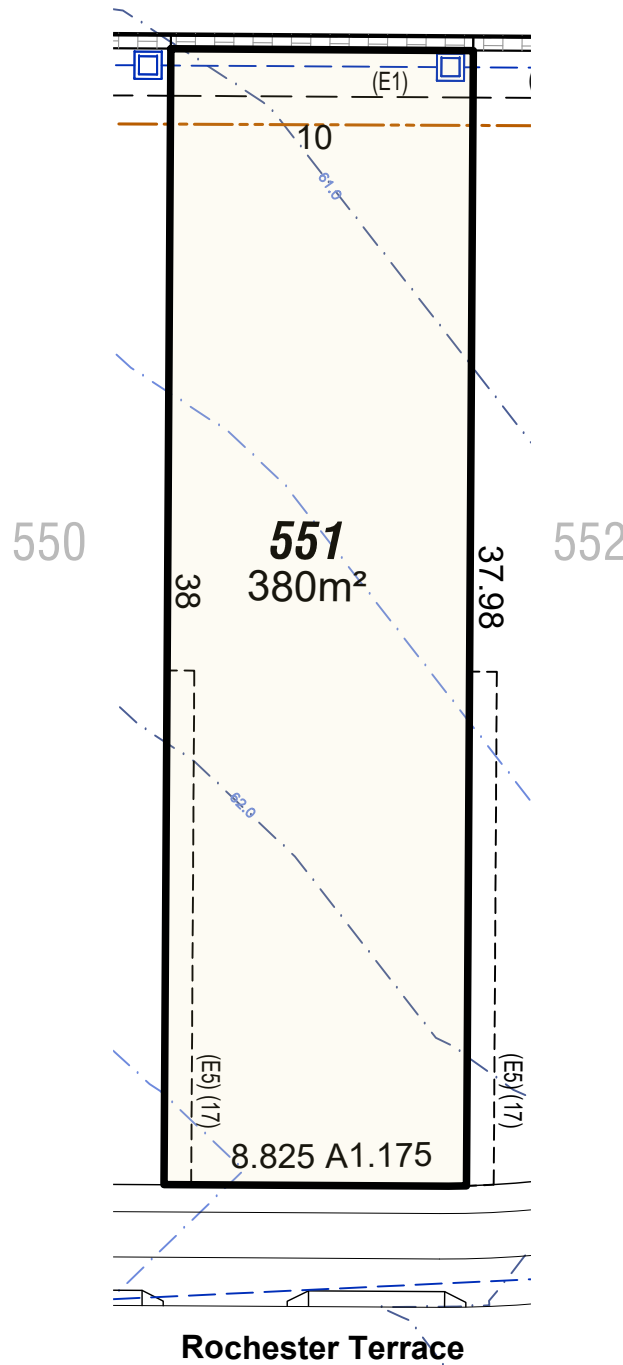

### Legend

- WATER
- SEWER MAIN & ACCESS POINT
- ELECTRICITY
- STORMWATER & PITS
- NBN
- RETAINING WALLS

- ZERO LOT EASEMENT
- BUILDING SETBACK (D.C.P.)
- EASEMENT FOR DRAINAGE & SERVICES
- SUBSTATION & SETBACKS
- (E1) EASEMENT TO DRAIN WATER 2.0 WIDE
- (E4) EASEMENT FOR PADMOUNT SUBSTATION 2.75 WIDE
- (E5) EASEMENT FOR ACCESS & MAINTENANCE 0.9 WIDE
- (E51) EASEMENT FOR ACCESS AND MAINTENANCE 0.9 WIDE

- (R1) RESTRICTION ON THE USE OF LAND
- (R2) RESTRICTION ON THE USE OF LAND
- (R11) RESTRICTION ON THE USE OF LAND (D.P.1229230)
- (R12) RESTRICTION ON THE USE OF LAND (D.P.1229230)
- (R51) EASEMENT FOR ACCESS AND MAINTENANCE 0.9 WIDE (D.P.1229230)
- (E52) EASEMENT FOR ACCESS AND MAINTENANCE 0.9 WIDE (D.P.1229230)
- (E53) EASEMENT FOR ACCESS AND MAINTENANCE 0.9 WIDE (D.P.1229230)
- 'C' BENEFIT BY EASEMENT TO DRAIN WATER 2 WIDE (E1)
- 'E' BENEFIT BY EASEMENT FOR ACCESS & MAINTENANCE 0.9 WIDE



This plan is provided solely for the purpose of providing an impression of the concept relating to the proposed development called 'Caddens Hill', as well as the approximate location of existing and proposed third party facilities, services or destinations, and is not intended to be used for any other purpose. Legacy Group does not make any representation or give any warranty in relation to the future development of the site, the staging of any future development or the current or future location or existence of any facilities, services or destinations. The plan is based on the present intention of, and information available to, Legacy Group and the current known requirements of relevant authorities at the time of creation of the plan and details may change due to future circumstances. Any indications of distance or size are approximate and for indicative purposes only, and are not to scale. The plan and any matters shown on or inferred from it do not give rise to a legally binding obligation on or representation or warranty by Legacy Group. Legacy Group accepts no liability for any loss or damage arising as a result of any reliance on this plan or its contents.