

'A' - RIGHT OF WAY 6 WIDE
 LOTS 109, 115, 121, 132, 138 & 139 TO PROVIDE TEMPORARY VEHICULAR ACCESS - DA CONDITION 11.4.2

STAGE 1

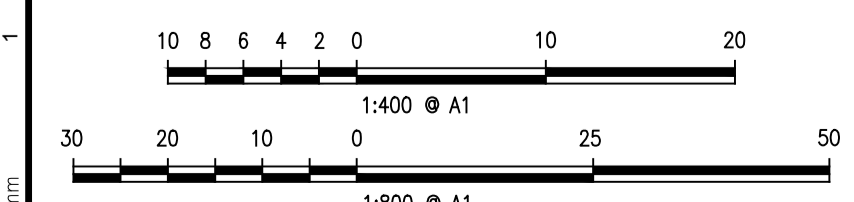

AMEND. NO. 00 DATE 17/10/2017 DETAILS ORIGINAL ISSUE



Project:
**STAGE 1
 SUBDIVISION OF LOT 1 D.P.1208526
 FOR STAGED DEVELOPMENT**

Principal: LB SCHOFIELDS ONE PTY LTD		Council Ref: DA-15-02283	
Scale: 1:800	Date: 10/10/2017	L.G.A. BLACKTOWN	
Calc's: A.T.	Drawn: F.G.	Proj.Man: A.T.	Client Ref:



ABN 77 050 209 991
 Level 4, Suite 400
 16-18 Cambridge St
 EPPING NSW 2121
 PO Box 233
 EPPING NSW 1710



Our Ref. **1788**
 Dwg File Ref. [Rev] - Sheet Ref.
1788G L01 [00]
 - STAGE 1

PRELIMINARY

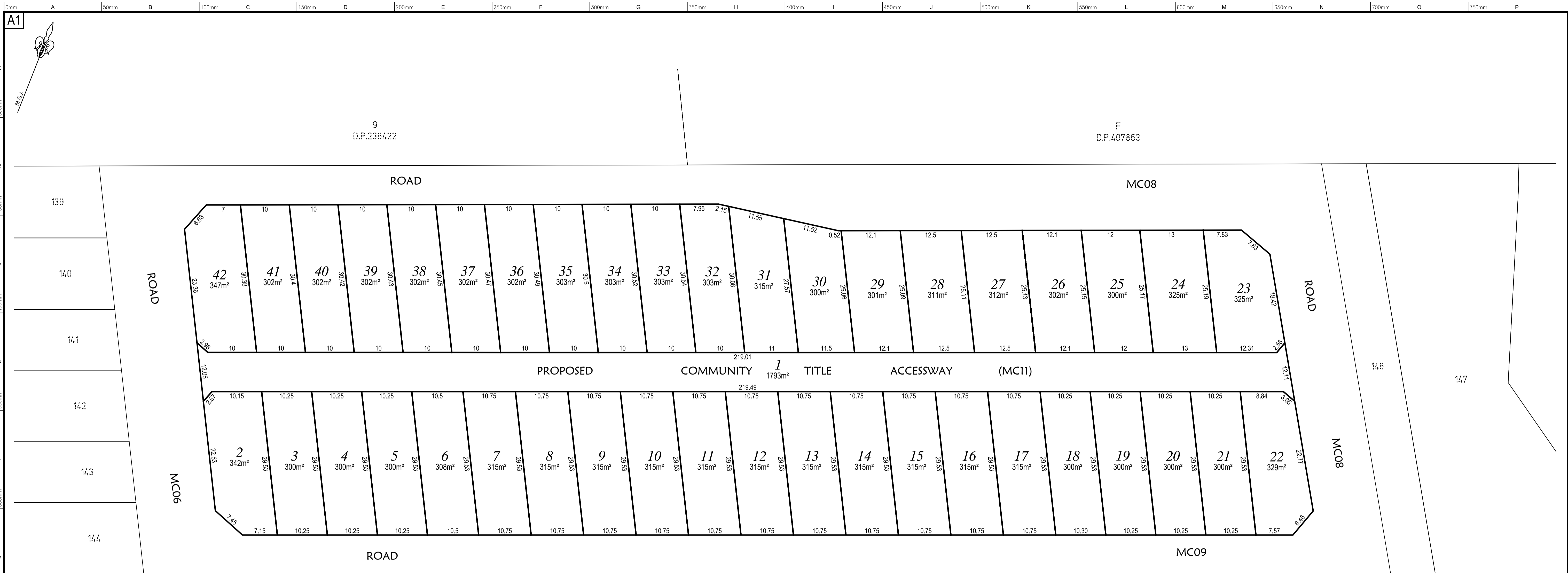

A1

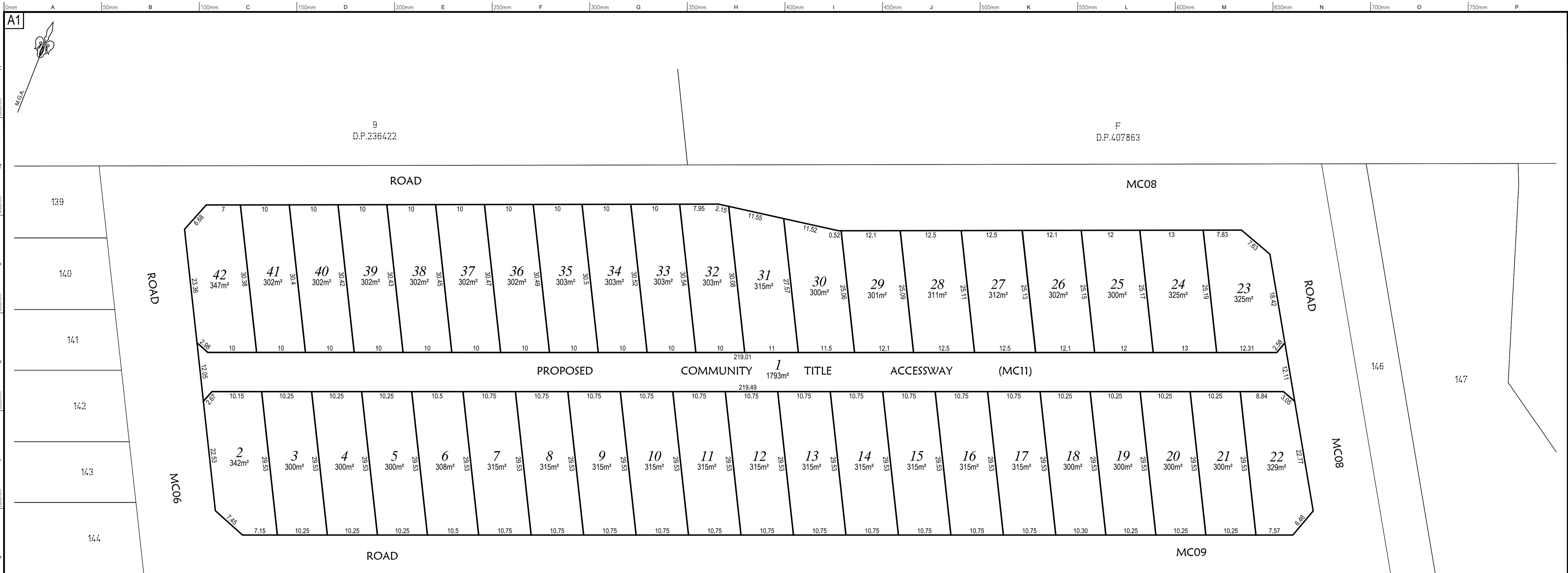

STAGE 2



Project:
**STAGE 2
 SUBDIVISION OF LOT 145 IN PROPOSED
 SUBDIVISION OF LOT 1 D.P.1208526
 FOR STAGED DEVELOPMENT**

Principal: LB SCHOFIELDS ONE PTY LTD	
Scale: 1:800	Date: 10/10/2017
Calc's: A.T.	Datum: L.G.A. BLACKTOWN
Drawn: F.G.	Proj.Man: A.T.
Client Ref:	



ABN 77 050 209 991
 Level 4, Suite 400
 16-18 Cambridge St
 EPPING NSW 2121
 PO Box 233
 EPPING NSW 1710
 www.craigandrhodes.com.au
 © Craig & Rhodes



Our Ref. **1788**
 Dwg File Ref. [Rev] - Sheet Ref.
1788G L01 [00]
 - STAGE 2

PRELIMINARY