

ARDENNES AVENUE

LIVERPOOL CITY COUNCIL

Endorsed document in relation to:

DA-680/2017

In accordance with the Environmental Planning and Assessment Act 1979

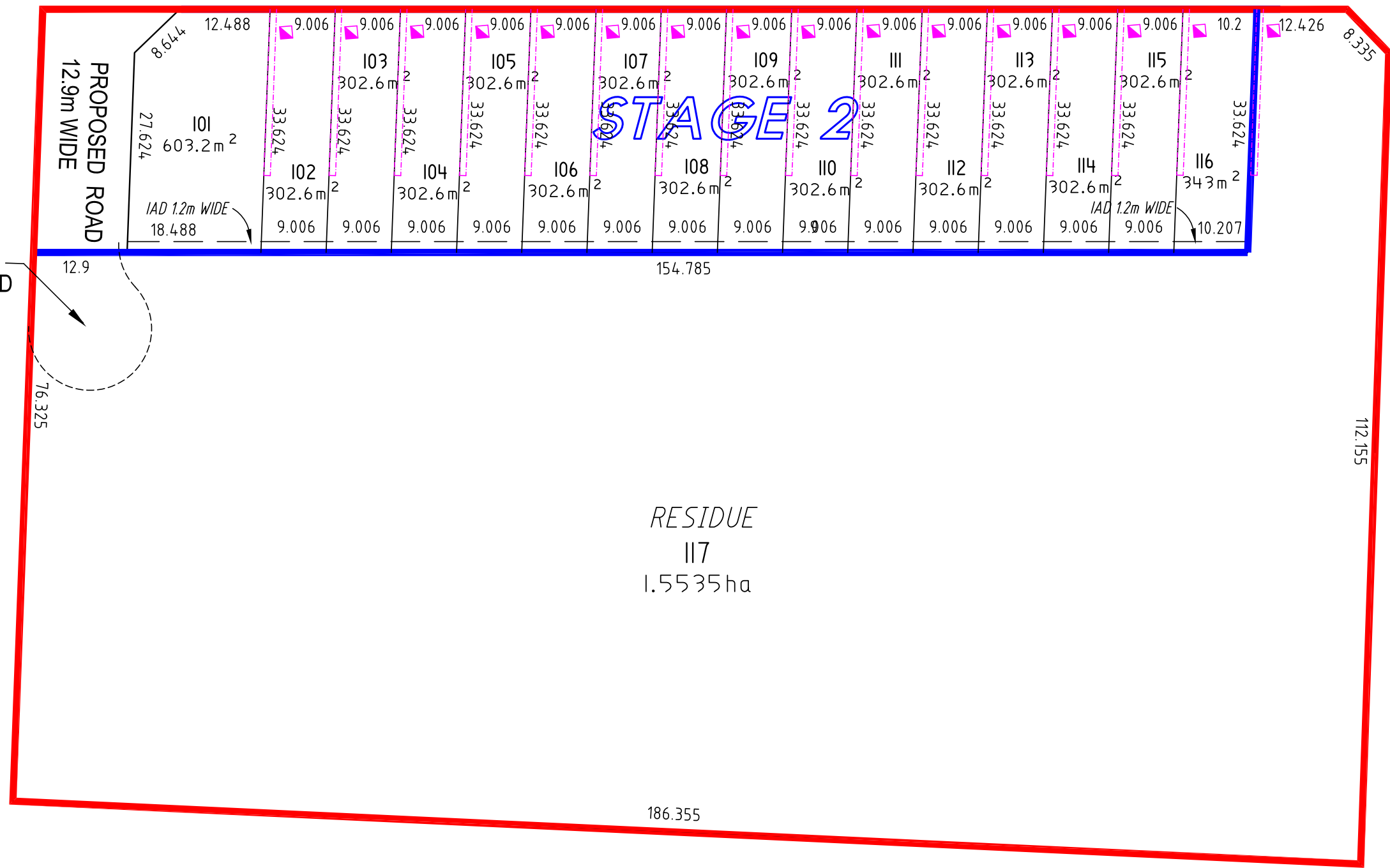
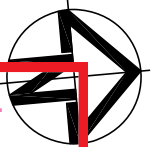

TEMPORARY TURNING HEAD

LOT 7 DP 1227088

FUTURE ROAD BY OTHERS

LOT 5 DP 1227088

RESIDUE 117 1.5535 ha

LOT 2 DP 240946

SUMMARY OF LOTS

LOT RANGE	303 TO 604
TOTAL LOTS	16
TOTAL AREA	5189
AVERAGE SIZE	324

NOTE

AREAS AND DIMENSIONS CONTAINED WITHIN THIS PLAN ARE FOR D.A. PURPOSES ONLY & MAY VARY SUBJECT TO FINAL SURVEY.

ROAD DESIGNS TO BE FINALISED ON ENGINEERING DESIGN.

FUTURE ROAD ON LOT 5 TO BE CONSTRUCTED BY OWNER OF PROPERTY

FUTURE ROAD ON LOT 6 TO BE CONSTRUCTED BY OWNER OF PROPERTY

Save as: 23-04-2018, B:\c:\p\p\p\c\calibre\16161616-003542 - Lot 16 Ardenne Ave Edmondson Park DA Stage - UD06_Model\AutoCAD\Planning\Drawings\16-003542-ST1.dwg

REDUCTION RATIO					
PLAN	1:300	A1			
	1:600	A3			
DATUM	A.H.D.	DESIGN	P.L.	CHECKED	P.L.
SURVEY	TRACED	A.C.	DATE	16-6-2017	

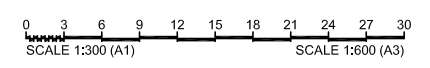

Disclaimer and Copyright:
ALL DIMENSIONS TO BE CHECKED ON SITE BY CONTRACTOR PRIOR TO CONSTRUCTION, USE WRITTEN DIMENSIONS ONLY, DO NOT SCALE.



ARDENNES AVENUE
EDMONDSON PARK
PROPOSED SUBDIVISION OF
LOT 1 IN STAGE 1

3	REVISION	23-4-2018
2	ZERO LOT LINE ADDED	19-9-2017
1	SURVEY CALCULATION	26-6-2017
0	ORIGINAL ISSUE	16-6-2017
ISSUE	DESCRIPTION	DATE
DRAWING No.	16-003542-ST1	AMEND.
SHEET	2 OF 3 SHEETS	3