

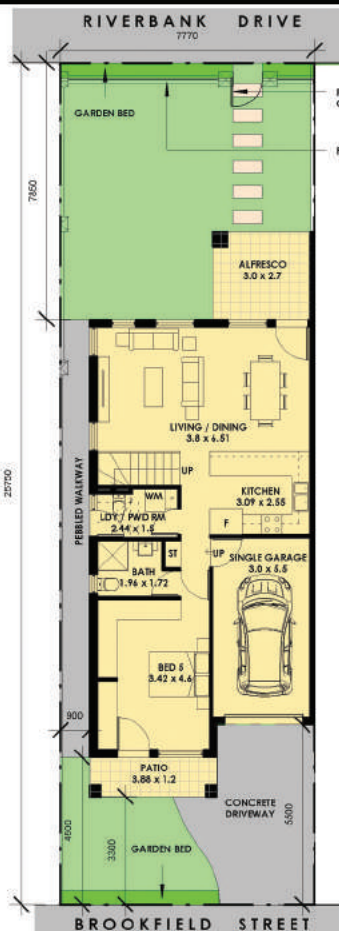

HOME & LAND PACKAGE

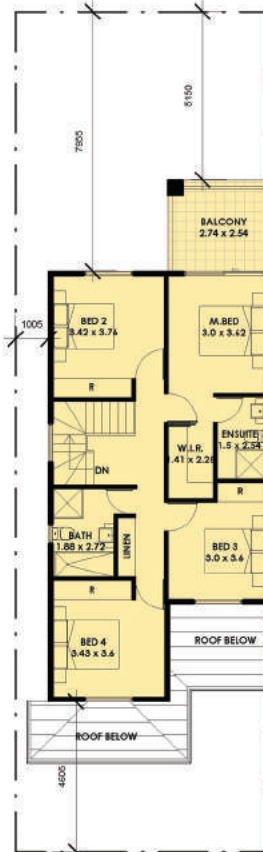

Ground Floor



First Floor

HOUSE

4BR With Alfresco	
Ground Floor	- 102.17m ²
First Floor	- 84.45m ²
Total	- 186.62m ²
Squares	- 20.08

NORTH

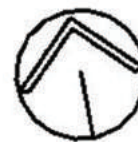

KEY FEATURES

- Premium 'The Ponds' location
- Torrens title home and land package
- North facing living areas and yards (approx. 8m X 8m)
- Directly opposite 2 schools
- Vehicular access through quiet Brookfield Street
- Bus stop approx. within 100m
- Direct pedestrian access to Riverbank drive
- Full turn-key inclusions including 2.7m high ceilings; refer to brochure

Call: 0488 026 556

CORNER OF RIVERBANK DRIVE
& HAMBLEDON ROAD, THE PONDS

Disclaimer: Information provided herein does not form part of a legal contract and is subject to change without notice. Artists impression is used for illustrative purposes only. The actual materials, finishes and colours may vary. Fencing around house as per the requirements of the local authority. Buyers should refer to the contract for sale. Bedroom sizes include the depth of the robes.

Signature
AT THE PONDS

www.signatureattheponds.com.au

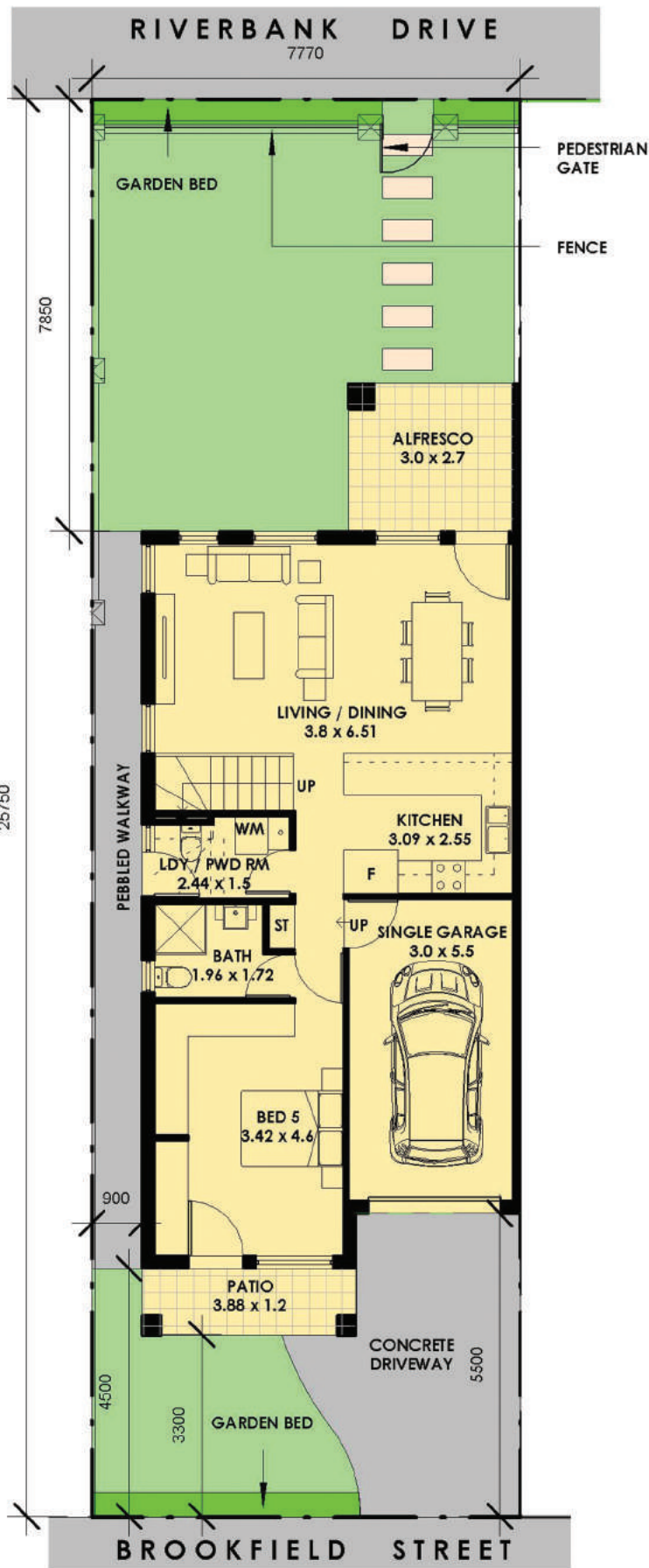

Ground Floor

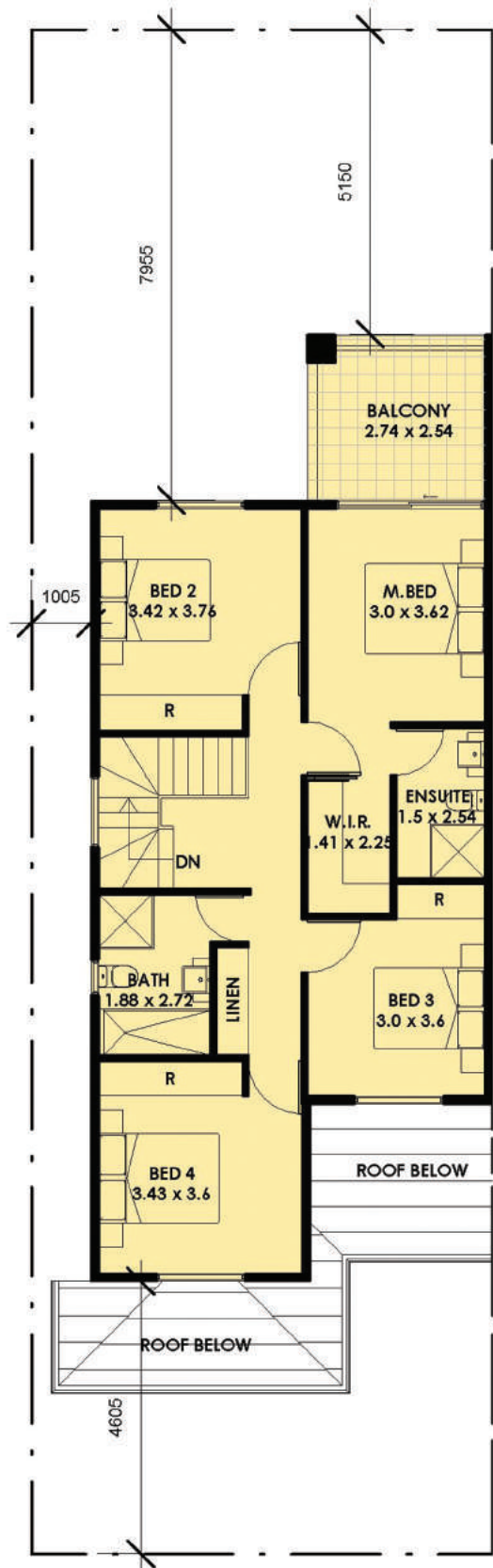

First Floor

NORTH

