

WD Surveys

LICENSED SURVEYORS and
DEVELOPMENT CONSULTANTS

Level 1/27 ANZAC AVE
REDCLIFFE 4020
P.O.Box 2327
REDCLIFFE NTH 4020



Ph: (07) 32841466
Fax: (07) 32847062
Email mail@wdsurveys.com.au

THIS PLAN SHOWS DETAILS OF PROPOSED ALLOTMENT 114 ON THE PROPOSAL PLAN I2/PSI0731/8G WHICH WAS APPROVED BY THE MORETON BAY REGIONAL COUNCIL – PINE RIVERS PLAN SUBJECT TO CONDITIONS ON 03/09/2013 .

THE METES AND BOUNDS DESCRIPTION OF THE AREA OF LAND BEING PROPOSED ALLOTMENT 114 DESCRIBED AS PART OF LOT 93 ON SP281372 PARISH OF REDCLIFFE, COUNTY OF STANLEY.

COMMENCING AT THE SOUTH WEST CORNER OF LOT 93 ON SP281372 THENCE FOR A BEARING OF 101°25'45" FOR A DISTANCE OF 315.290m THENCE FOR A BEARING 11°25'35" FOR A DISTANCE OF 20.130m TO THE POINT OF COMMENCEMENT. THENCE A

BEARING 11°25'35" FOR A DISTANCE OF 11.648m
BEARING 101°25'35" FOR A DISTANCE OF 22.586m
BEARING 191°25'30" FOR A DISTANCE OF 11.649m
BEARING 281°25'35" FOR A DISTANCE OF 22.584m

TO THE POINT OF COMMENCEMENT AND CONTAINING AN AREA OF 263 SQUARE METRES MORE OR LESS.

LEGEND:

	PROPOSED KERB & CHANNEL and GULLY PIT
	PROPOSED SEWER MH / SEWER LINE
	PROPOSED WATERMAIN / HYDRANT
	PROPOSED WATER CONDUIT / WATER CONNECTION
	PROPOSED STORMWATER MH / STORMWATER LINE
	POWER LINES
	RETAINING WALL
	NATURAL SURFACE CONTOURS BASED ON AHD(DER) AT AN INTERVAL OF 0.20m
	PROPOSED FINAL SURFACE CONTOURS BASED ON AHD(DER) AT AN INTERVAL OF 0.20m
	AREAS TO BE FILLED
	AREAS TO BE CUT

DRAWING TITLE

DISCLOSURE PLAN

FOR PROPOSED ALLOTMENT 114

Sheet 2 of 2 Sheets

DATE: 15/12/15

SCALE: 1:200

DRAWING NUMBER

15/DPI0731/114

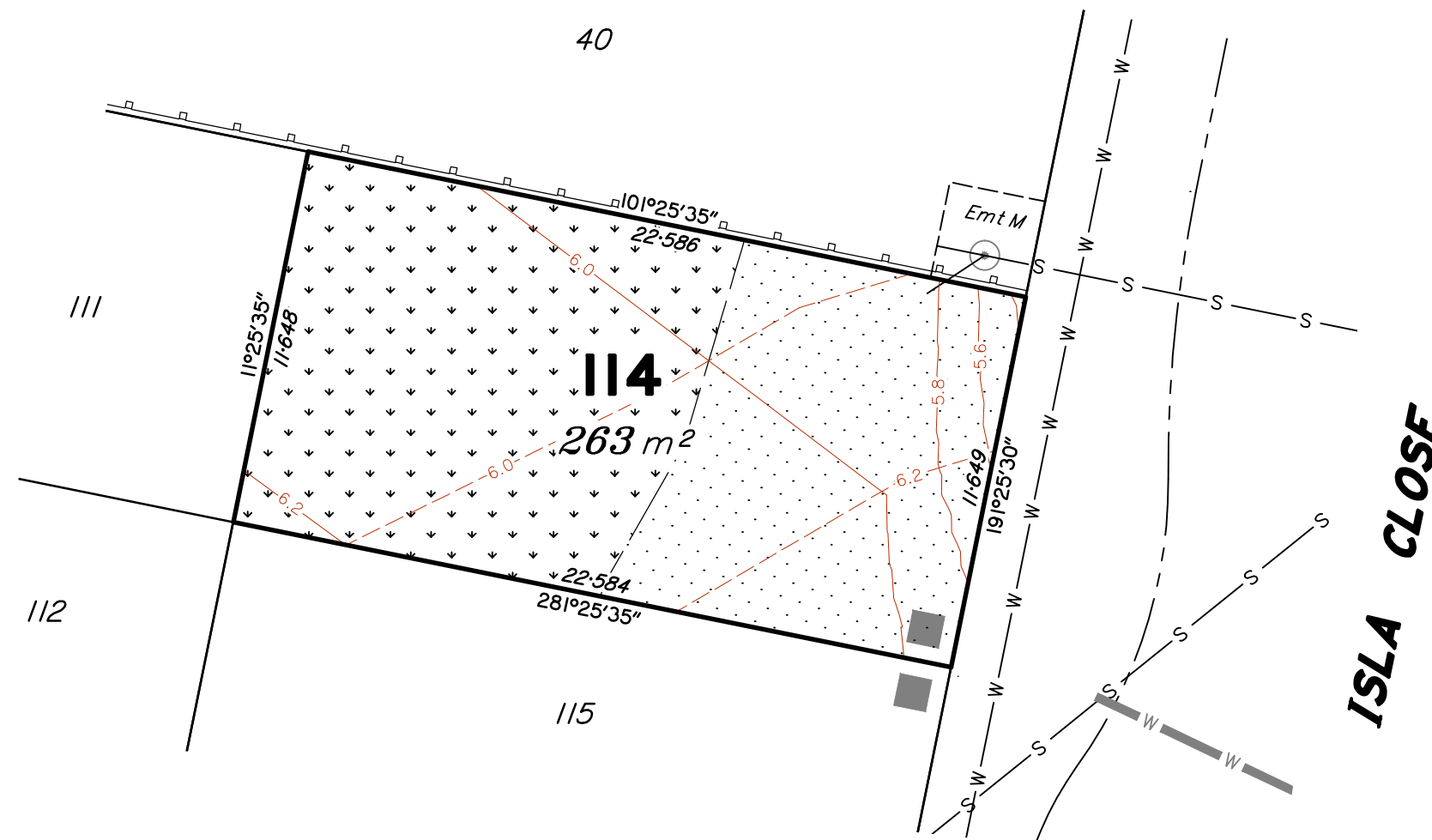

Scale 1:200 @ A3 – Lengths are in Metres.

